

Gc
977.701
HIGH

GENEALOGY COLLECTION





Digitized by the Internet Archive
in 2010 with funding from
Allen County Public Library Genealogy Center

<http://www.archive.org/details/hancockcountyiow00mars>

152
HANCOCK COUNTY

ATLAS



INDEX

	PAGE		PAGE
Bingham Township.....	5	Boone Township	21
Crystal "	7	Erin "	23
Madison "	9	German "	25
Ellington "	11	Ell "	27
Orthel "	13	Magor "	29
Hancock County's People	14	Farm Statistics.....	30
Britt Township.....	15	Amsterdam Township.....	31
Garfield "	17	Twin Lake "	33
Concord "	19	Avery "	35



PRESENTED BY
THE TIMES-REPUBLICAN
MARSHALLTOWN, IOWA

OUTLINE MAP OF

1198477

HANCOCK COUNTY, IOWA

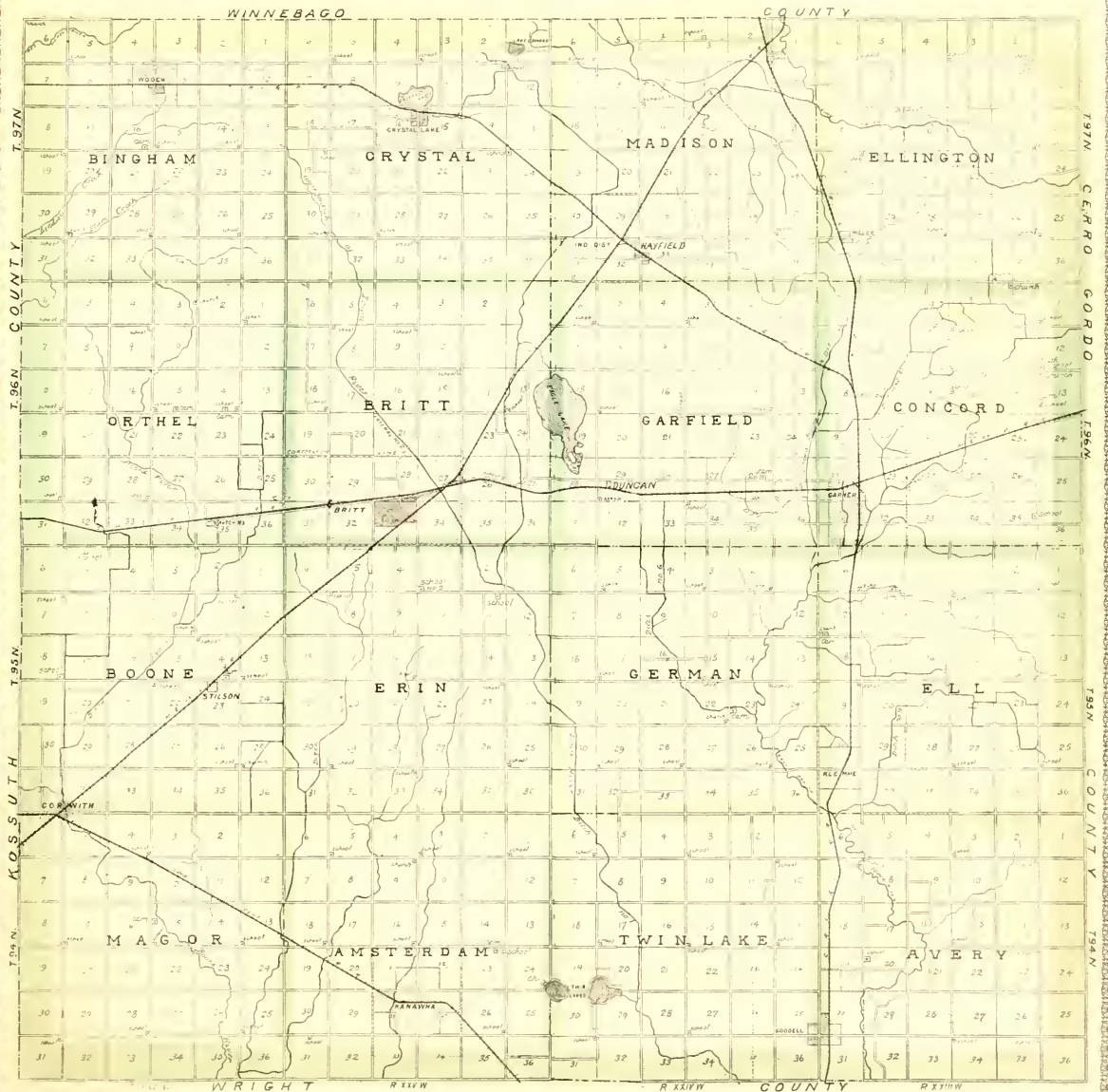

BINGHAM

Township 97 North, Range 26 West, of the 5th Principal Meridian.

Scale 1/2 Inches to the Mile

WINNEBAGO

COUNTY

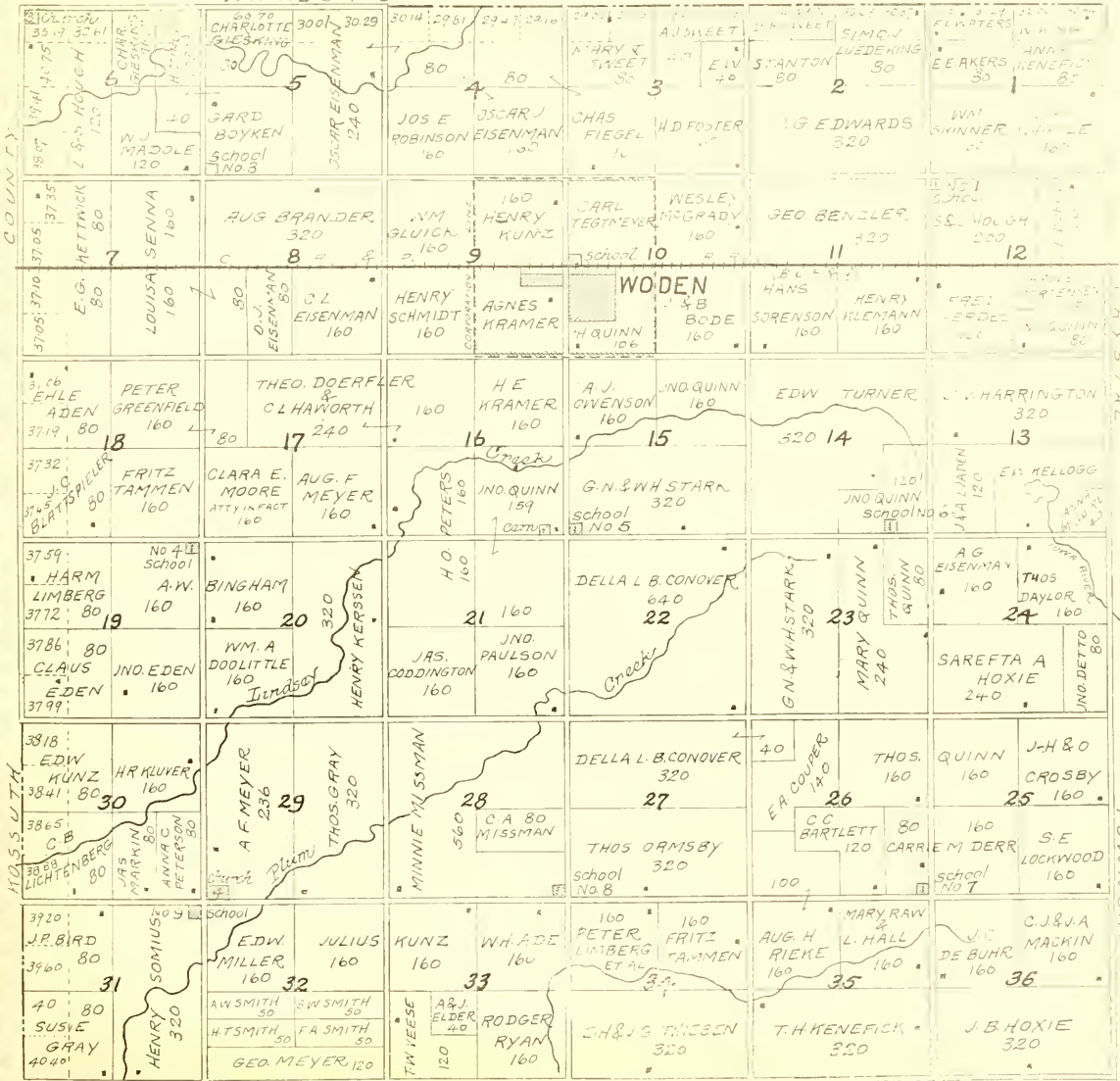

HASSETT

TOWNSHIP

=====
O. A. Olson Dealer in

Real Estate

Forest City, Ia.
=====

Oldest Bank in the County by Nine Years

ESTABLISHED 1868
WINNEBAGO COUNTY STATE BANK
CAPITAL \$50,000

J. F. Thompson, Pres. B. J. Thompson, Vice-Pres.
John Olson, Cashier M. M. Thompson, Asst. Cashier

A General Banking Business Transacted

Money to loan on long or short time at lowest current rates.
Farm loans made at 5 and 5½ per cent annual interest. No
commission or other expense.

F O R E S T C I T Y , I O W A

=====
1876
=====

B. A. PLUMMER'S
First National Bank

In Northern Iowa

== FOREST CITY, IOWA ==

G. S. Gilbertson, President W. O. Hanson, Vice-President
C. H. Kelley, Vice-President
C. A. Isaacs, Cashier M. I. Johnson, Assistant Cashier

Forest City National Bank
CAPITAL AND SURPLUS - - - \$65,000.

General Banking Business Collections
Farm Loans
Interest on Time Deposits Abstracts

Extra Copies of the
HANCOCK COUNTY ATLAS
May be had at \$5.00 apiece



TIMES-REPUBLICAN, Marshalltown, Ia.

ELLINGTON

Township 97 North, Range 23 West, of the 5th Principal Meridian.

Scale 1 1/2 Inches to the Mile.

WINNEBAGO

COUNTY

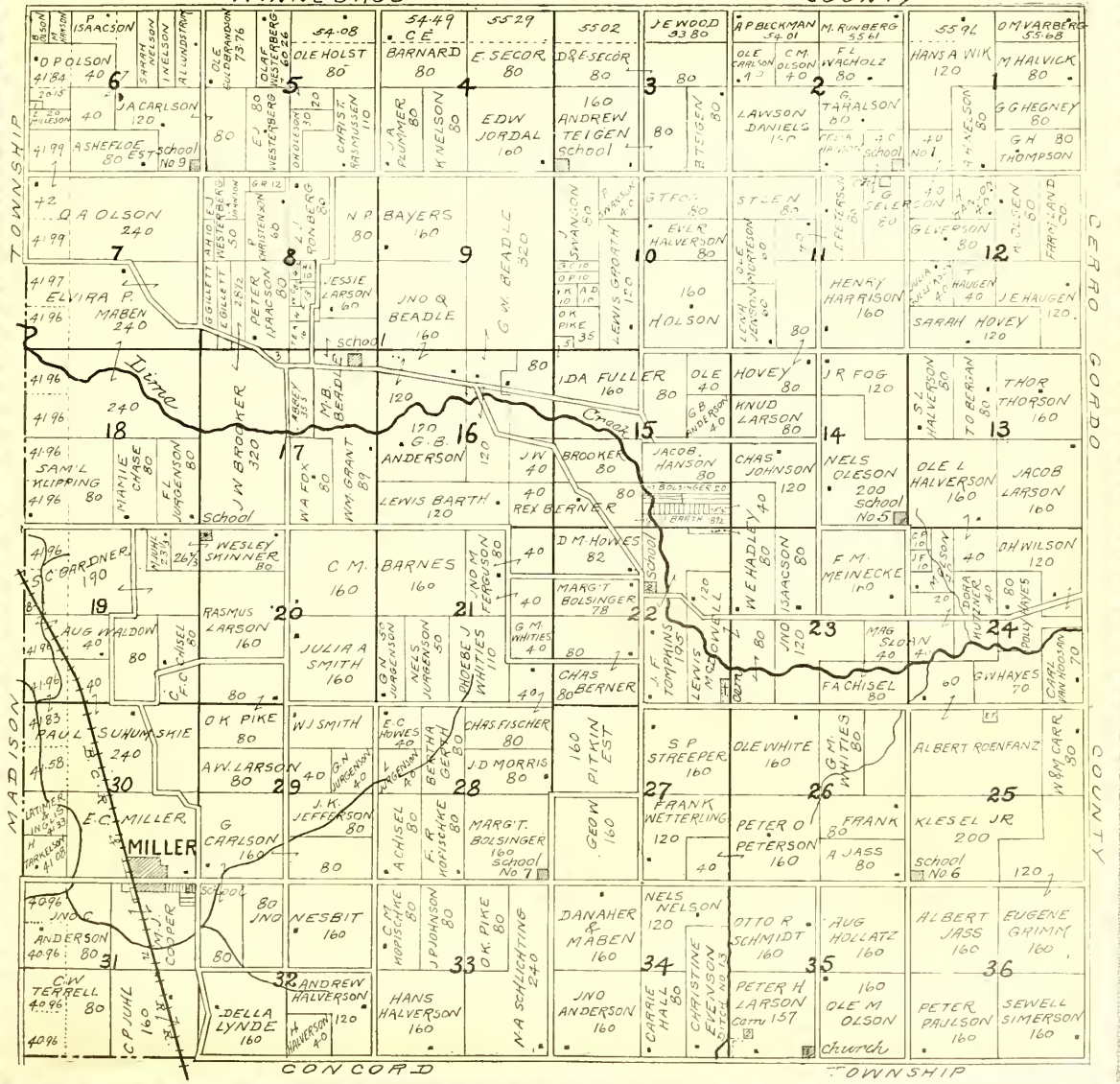

TOWNSHIP

CORRADO

MADISON

COUNTY

CONCORD

TOWNSHIP



The Leading Hotel in Britt

ALLISON HOUSE

BRITT, IOWA

GOOD STEAM HEATED ROOMS
GOOD TABLE

Comfort of the Traveling Public Carefully
Looked After

NOONAN'S LIVERY BARN

BRITT, IOWA

NOONAN'S HARNESS SHOP

NEXT DOOR TO LIVERY

Regulates Prices
for Hancock County

WM. NOONAN, Prop'r

HANCOCK COUNTY'S PEOPLE

[FROM STATE CENSUS OF 1905]

The greater portion was purchased from the Indians in 1830 at 3 cents an acre.

Population		Sex and Nativity		Conjugal Relation	
1860	179	Native born white from native parents—	Single—1287 males, 3194 females.		
1863	210	2458 males and 2400 females.	Married—2398 males, 2388 females.		
1865	292	Native born white from foreign born par-	Widowed—215 males, 229 females.		
1867	357	ents—2871 males and 2614 females.	Divorced—13 males, 17 females.		
1870	909	Foreign born—1506 males and 1099 females.	Separated—16 males, 20 females.		
1875	1182	Colored—4 male, 5 females.			
1880	3153	Total—6839 males, 6118 females.			
1885	5089				
1890	7621				
1895	11141				
1900	13752				
1905	12987				

Occupations		Church Record		Urban Population	
Agricultural pursuits—2318 males, 167 females.		Churches	25	1895	3192
Professional service—173 males, 152 females		Congregations	27	1900	3241
Domestic and personal service—531 males, 424 females.		Value of churches	\$87,200	1905	4363
Trades and transportation—465 males, 51 females.		Seating capacity	5185		
Manufacturing and mechanical pursuits—212 males, 61 females		Number of members	2502		
Unclassified labor—341 males, 7 females.		Number of parsonages	13		
		Value of parsonages	\$17,300		

GARFIELD

Township 96 North, Range 24 West, of 5th Principal Meridian

Scale 1/2 Inches to the Mile.

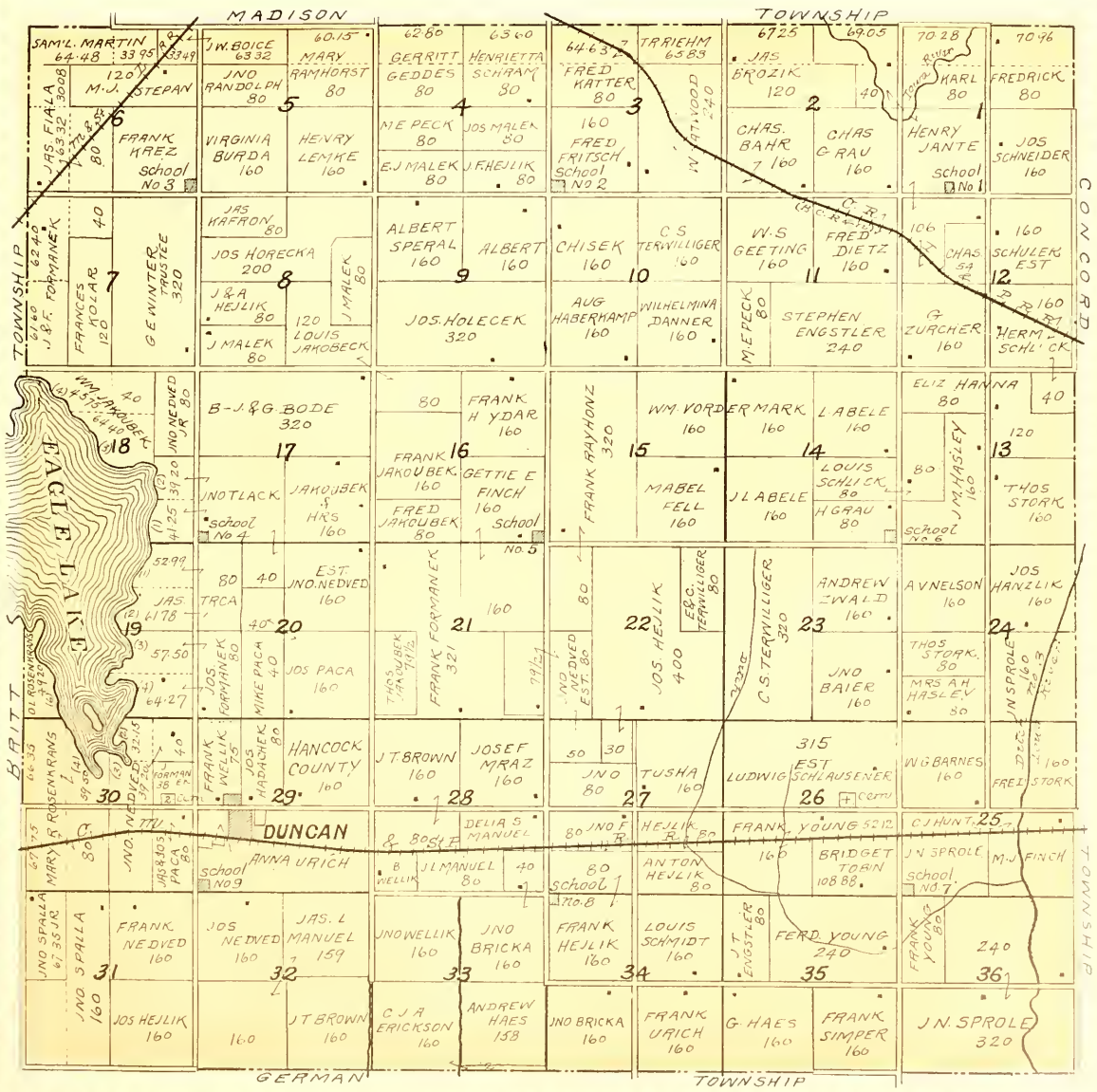

Wm. Shattuck, Pres. A. C. Ripley, Vice Pres.
E. M. Hanson, Cashier

Capital Stock, \$50,000
Surplus and Profits, \$12,500

THE FIRST NATIONAL BANK

480 United States Depository

GARNER, IOWA

A General Banking Business Transacted

DIRECTORS: Wm. Shattuck, A. C. Ripley, J. E. Wichman,
R. Valentine, W. C. Dorow, Royal Lovell, F. M. Hanson

A. C. RIPLEY & CO.

Attorneys

REAL ESTATE AND ABSTRACT OFFICE

Examine and Make Abstract of Title
Land and Mortgage Brokers

First National Bank Building, Phone 52
Garner, Hancock County, Iowa

C. K. Moe, Pres. I. Svegaard, Cashier
C. S. Terwilliger, V. Pres. M. R. Pollock, Asst. Cash.

FARMERS NATIONAL BANK

GARNER, IOWA

Capital and Surplus, \$35,000

Farm Loans a Specialty

Interest Paid on Time Deposits

W. H. Ramsay F. E. Blackstone

RAMSAY & BLACKSTONE

Lawyers

General Practice. Special Attention given
to Commercial, Real Estate and Probate
Law.

Rooms 1-5 Bell Block
GARNER, IOWA

STATE STREET LIVERY

GARNER, IOWA

C. S. GIVAN, Proprietor

Best Service Good Horses
Clean, Easy Carriages Honest Rates

Special Attention Paid to
Commercial Travelers

Established 1865 Successor to Brockway & Elder

J. N. SPROLE

GARNER, IOWA

ABSTRACTS AND LOANS

REAL ESTATE BOUGHT
AND SOLD

Responsibility \$30,000

GARNER HOUSE

A. J. CLEAVES, Prop'r

GARNER, IOWA

CONCORD

Township 96 North, Range 23 West, of the 5th Principal Meridian.

Scale 1" Inches to the Mile

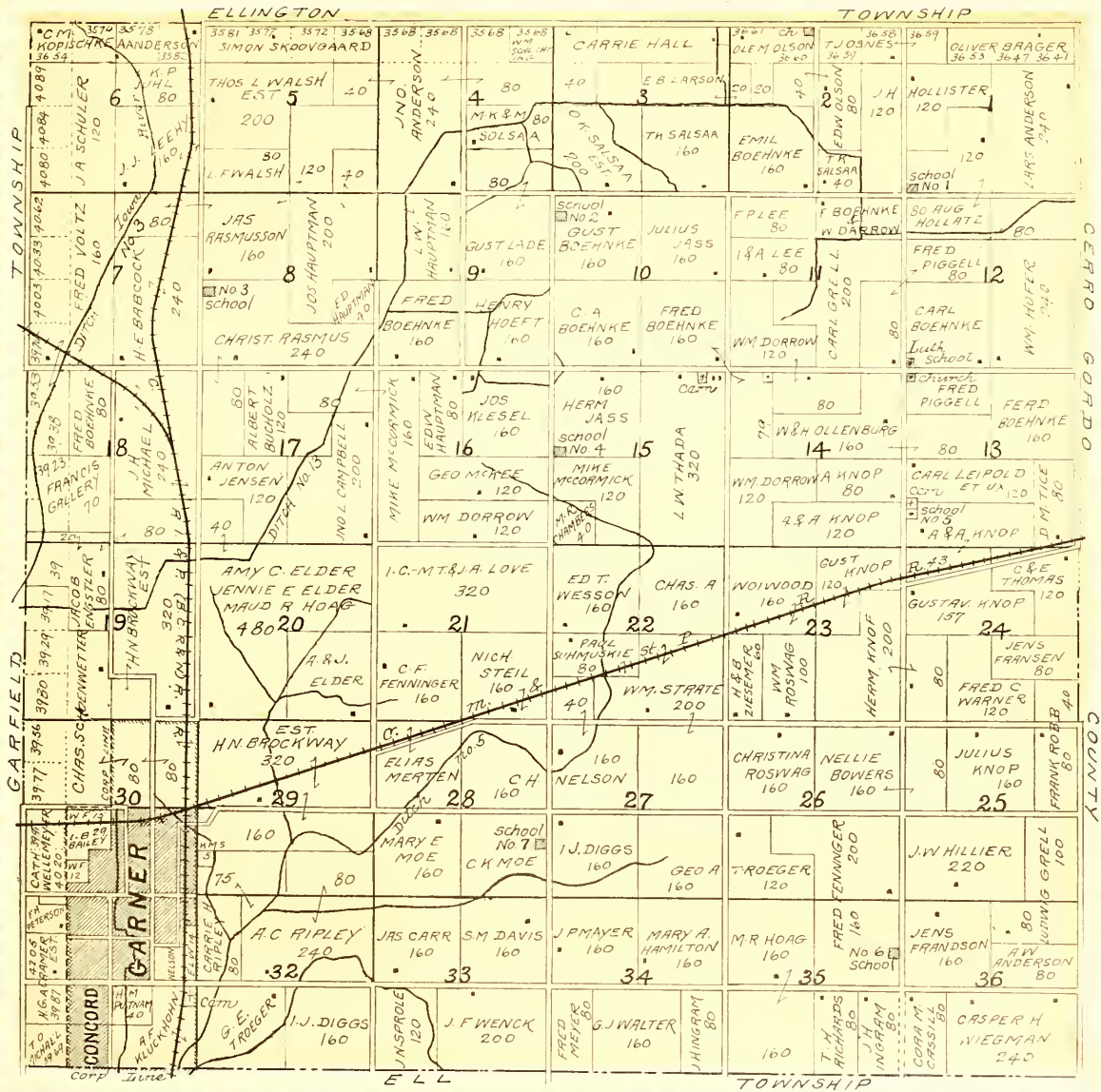

O. H. Stilson, Pres. E. L. Stilson, Vice-Pres.
J. H. Standing, Cashier E. Lovell Stilson, Asst. Cashier

FIRST STATE BANK OF CORWITH

Capital \$50,000

Pay Interest on Time Deposits. Clerk
Public Sales and Buy the Notes.

Money Always on Hand for Farm Loans
at Lowest Current Rates

O. H. STILSON E. L. STILSON M. C. DUNLAP

E. L. STILSON & CO. CORWITH, IOWA

Real Estate. Good line of Insurance Companies.
Are in Flowing Well District of Hancock
County. Owners of Stilson's 1st & 2d
Additions to Corwith

Immigration Agents for Iowa Central and Miss-
ouri Pacific Railways Iowa, Minnesota
and South-Western Lands for Sale

THOS. A. WAY, Pres. P. HATTEPSCHIED, Vice-Pres. H. C. HATTEPSCHIED, Cashier E. B. APPLIGATE, Asst. Cashier

FIRST NATIONAL BANK CORWITH, IOWA

General Banking Business
Transacted

We Solicit a Share of Your Banking Business

We Write Insurance and
Make Farm Loans

Interest Paid on Time Deposits

Safety Deposit Boxes for Rent, \$1.00 a Year

Phone 22

Special Livestock Market Reports

Farmers will find in the
Daily Times-Republican
special livestock market
reports equal to any
stockyards paper and
far more complete than
are published in any
other newspaper.

TIMES-REPUBLICAN,

Marshallown, Iowa

BOONE

Township 95 North, Range 26 West, of the 5th Principal Meridian.

Scale 1" = 1/4 Miles

ORTHEL

TOWNSHIP

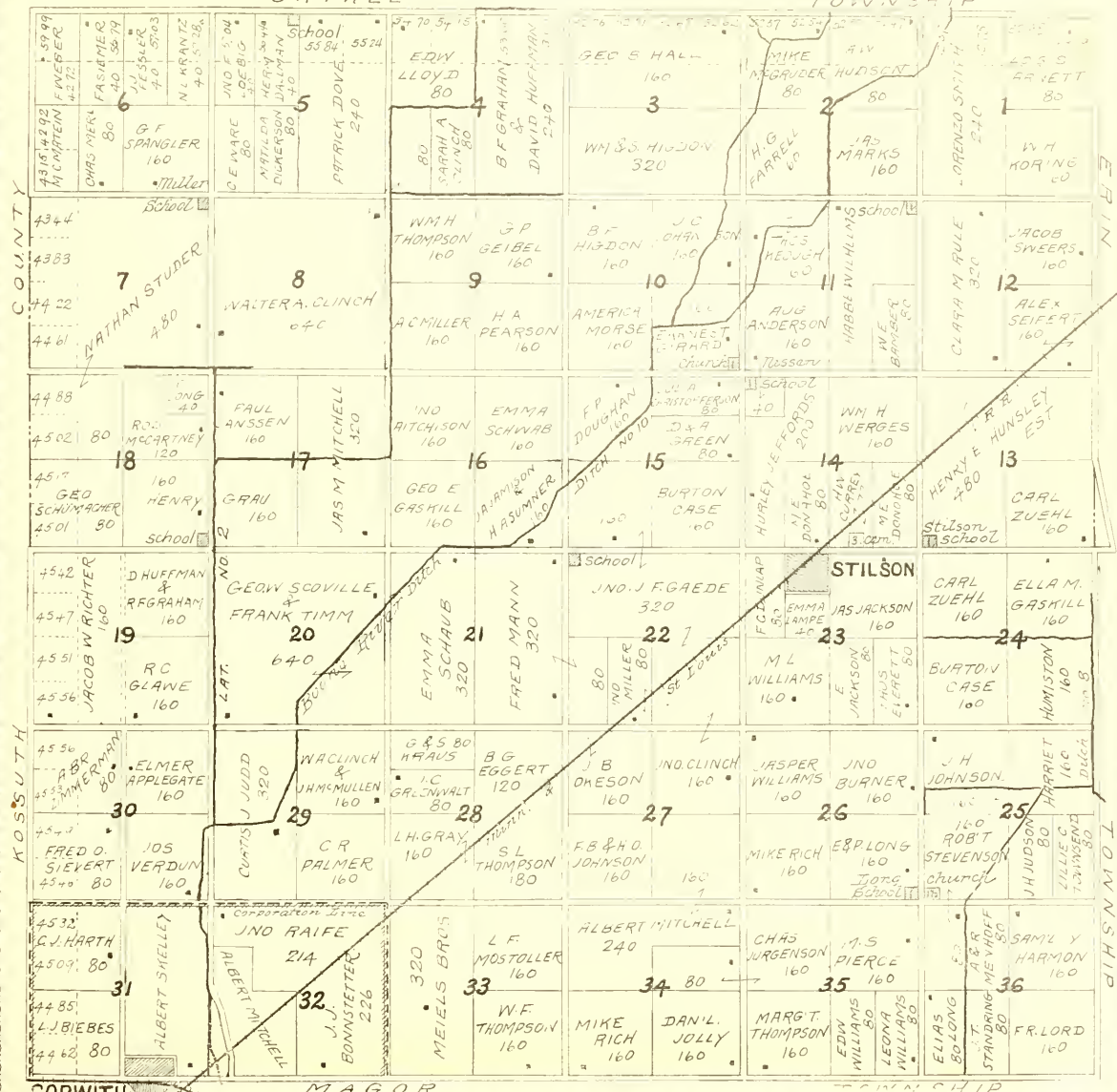

COUNTY

KOSKUTH

ERIN

TOWNSHIP

CORWITH

MAGOR

TOWNSHIP

ERIN

Township 95 North, Range 25 west, of the 5th Principal Meridian

Scale 1/4 Inches to the Mile.

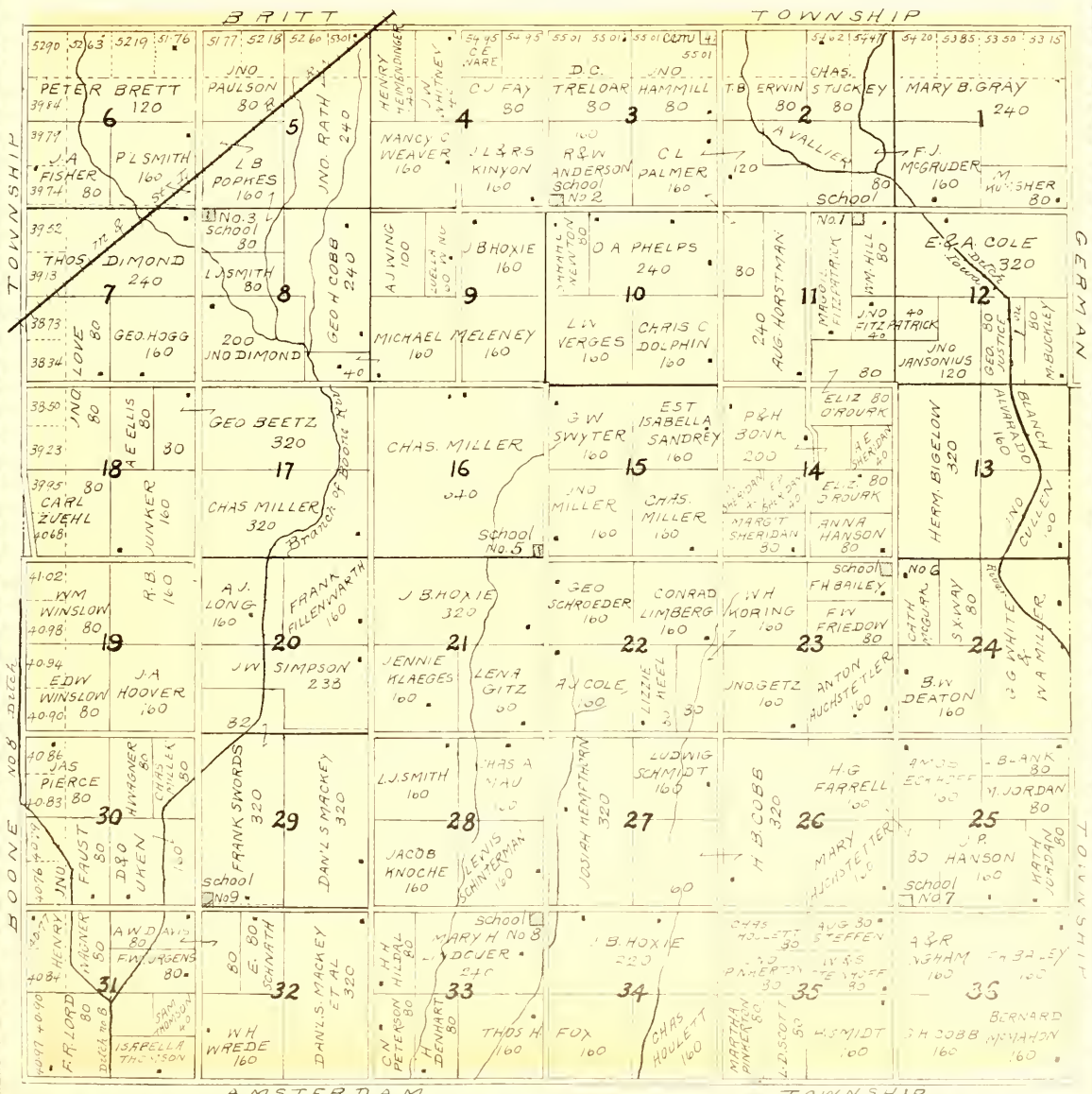

GERMAN

Township 95 North, Range 24 West, of the 5th Principal Meridian.

Scale 1 1/2 Inches to the Mile.

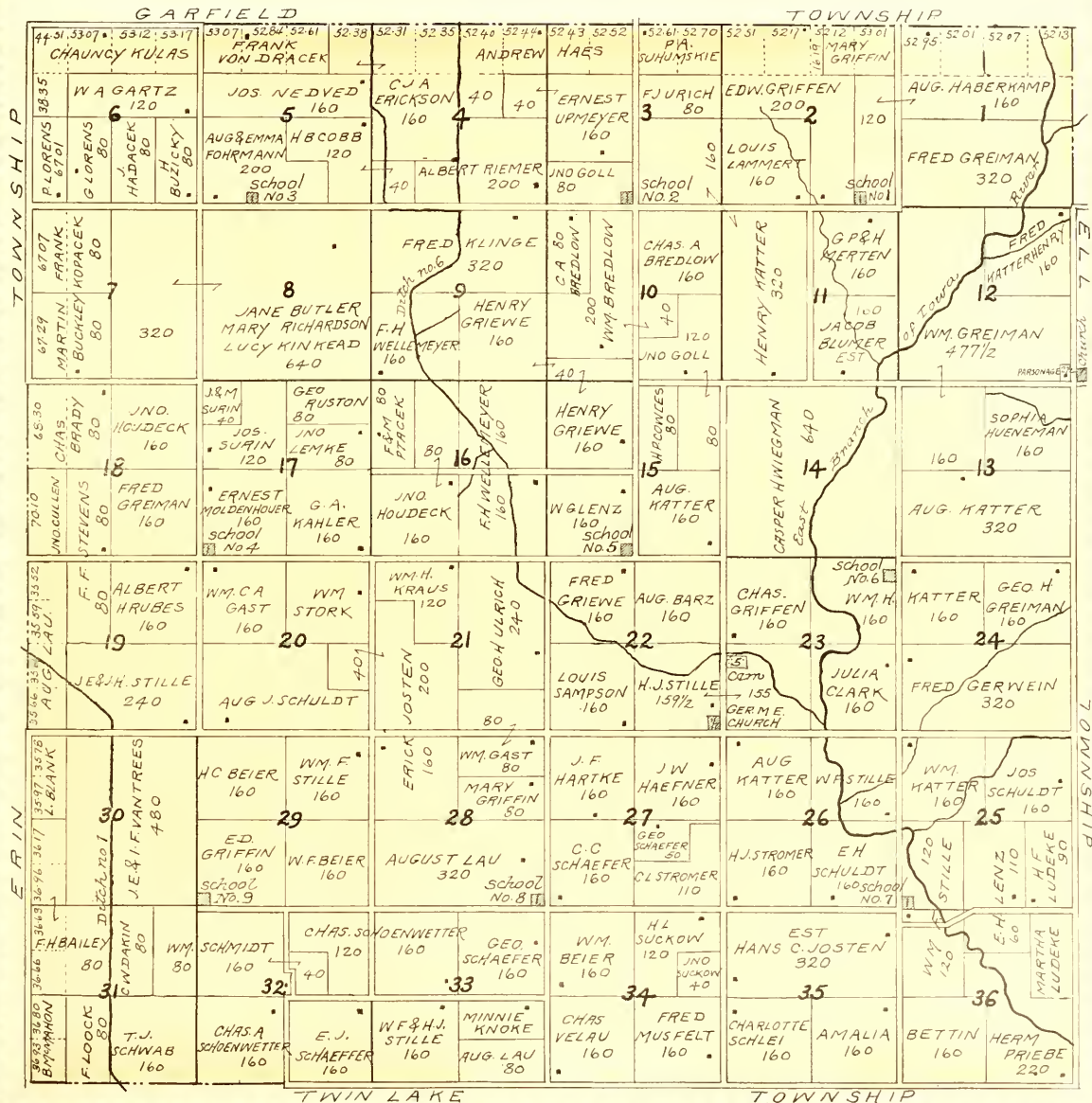

Fred Arnold, Pres

G. H. Wiegmann, V. Pres.

F. A. Arnold, Cashier

FIRST NATIONAL BANK OF KLEMME

BANKING IN ALL ITS BRANCHES

Farm Loans a Specialty

Collections

YOUR BUSINESS SOLICITED

CALL AT THE

STATE SAVINGS BANK OF KLEMME

 We Are Here for Your Convenience

Farm Loans

Collections a Specialty

Safety Deposit Boxes

Interest Paid on Time Deposits

W. F. Bloom, Pres D. D. Foss, 1st V. Pres. Wm. Katter, 2d V. Pres.
P. M. Griesemer, Cashier F. J. Wenck, Asst. Cashier

A FARMER'S FURNACE

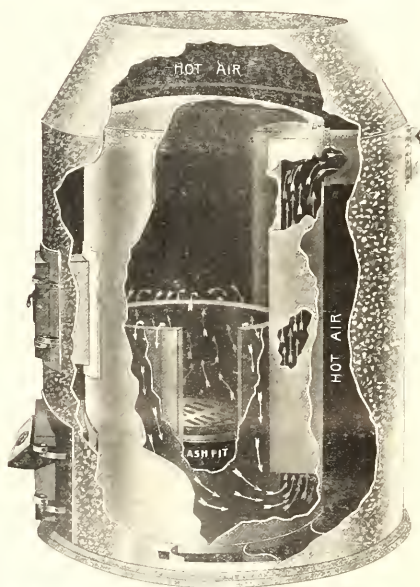

Because with detailed directions from the
Factory a farmer or any tinner
can set it



AS SIMPLE TO OPERATE
AS ANY STOVE

EVERY ROOM IN THE HOUSE
HEATED WITH ONE FIRE



The Equator furnace is a simple, cheap
powerful heater, absolutely gas tight. It
can be installed in an old house or a new
one. Send rough pencil sketch of your
floor plans and get an estimate of cost
from the factory.

Marshalltown Furnace Co. Marshalltown, Iowa

ELL

Township 95 North, Range 23 west, of the 5th Principal Meridian

Scale 14 Inches to the Mile

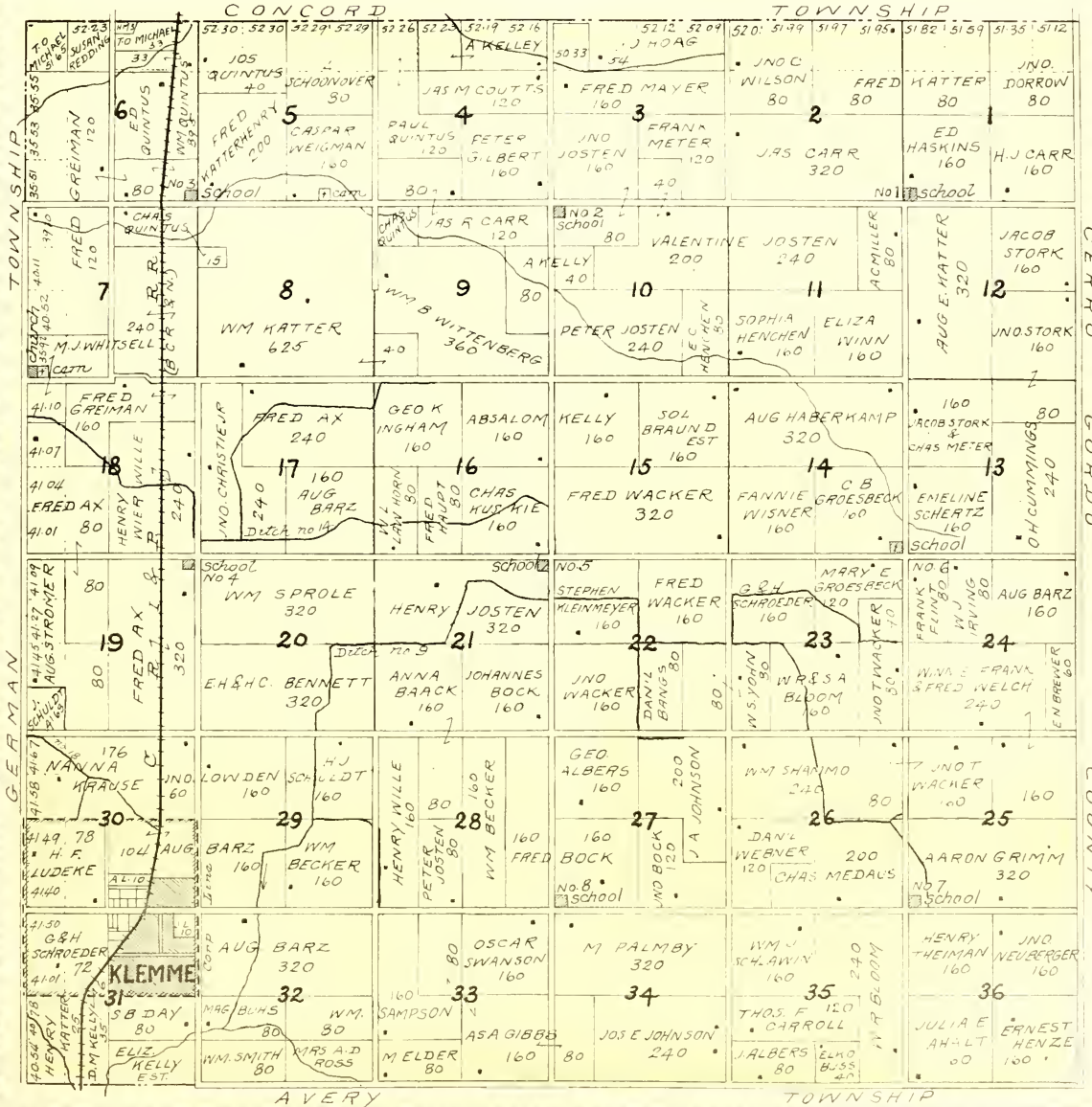

MAGOR

Township 94 North, Range 26 West, of 5th Principal Meridian

Scale 1 1/2 Inches to the Mile.

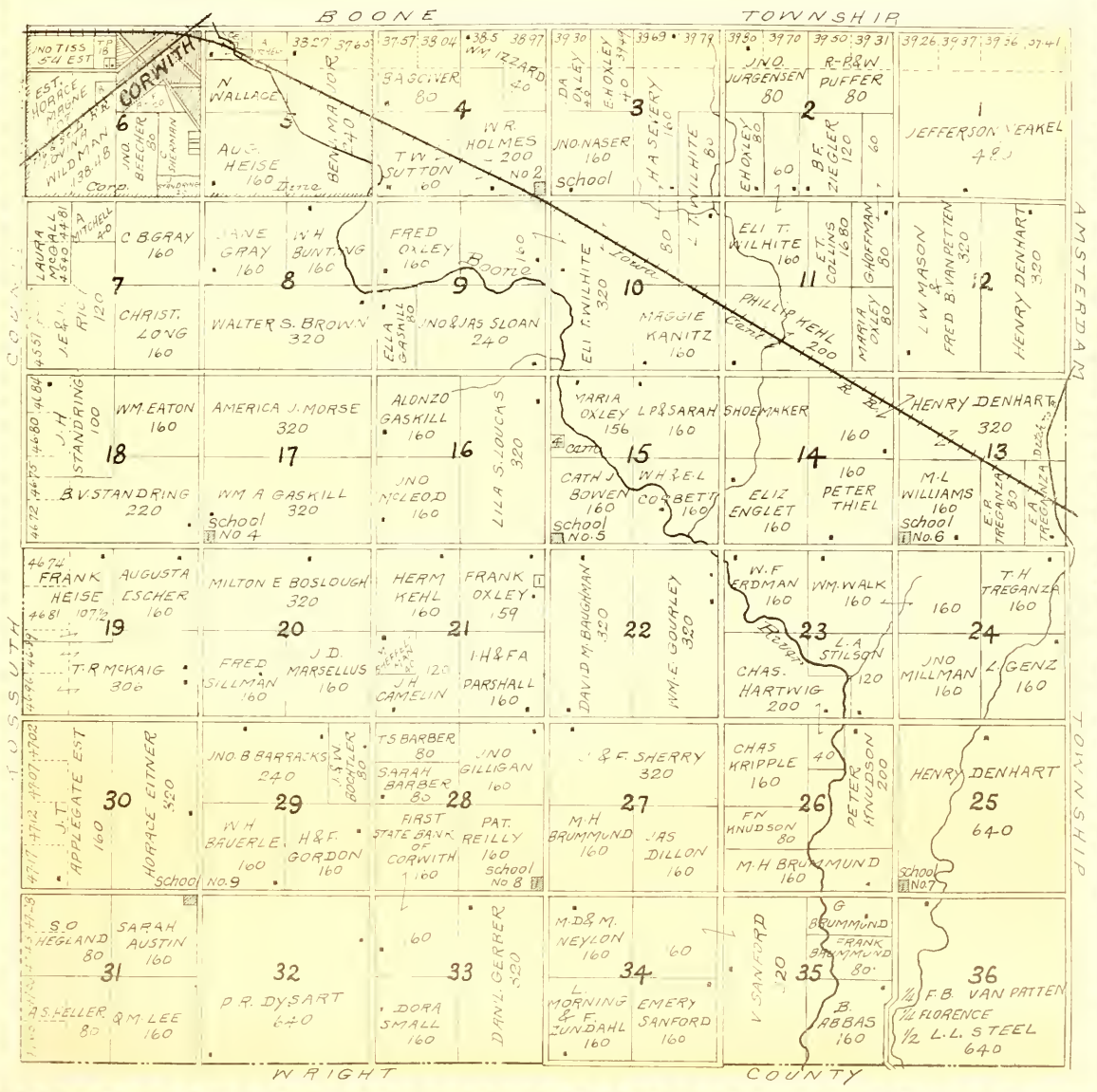

J. E. WICHMAN, Pres.

O. L. T. RIKANSRUD, Vice Pres.
F. L. BUSH, Cashier

STATE SAVINGS BANK

Kanawha, Iowa

Capital \$15,000 Surplus \$4,000

A General Banking Business Transacted
Fire Insurance Written Farm Loans Made
Your Business Solicited

Directors: J. E. Wichman, Wm. Shattuck, F. M. Hanson,
G. F. Richardson, Chas. Gruetzmacher, O. L. T. Rikansrud,
H. E. Eckhoff

E. L. STILSON, Pres.

G. W. MASON, Cashier

O. H. STILSON, Vice-Pres.

A. L. SEVERIN, Asst. Cashier

BANK OF KANAWHA

Responsibility \$100,000.00

General Banking Business Transacted
Real Estate and Farm Loans
Specialties with this Bank

Insurance Written in
Leading Companies

THE RED LIVERY BARN

GUY MARK Proprietor, Kanawha, Iowa

Good Clean Rigs, Fair Prices and Teams that Will Get You There. Call in Person
or by Phone

HANCOCK COUNTY'S FARMS

(FROM THE STATE CENSUS OF 1905)

Number farms 1,657, acres 342,228, value land \$13,649,358 Value buildings \$2,444,508, value implements \$374,682. Total \$18,468,548.
Farms occupied by renters 677, acres 160,519, value land \$6,912,118, value buildings \$827,728, value implements \$146,696.

Farms owned by occupants 980, acres 158,180 land value including acres rented \$8,737,240. Value buildings \$1,616,780, imple-
ments \$237,986.

Number farms owned by native born white 416, owned by foreign born white 503, managed by native born white 30, managed by
foreign born white 11 Farms rented by native born for cash 128, for share rent 159, for cash and share rent 146, by foreign
born white for cash rent 73, for share rent 93, for cash and share rent 78.

Acres improved land in farms in 1905, 291,765; unimproved land in farms in 1905, 64,584.

Grain Yield 1905

Corn—89,315 acres planted to corn, 2,233,190 bushels raised of
value of \$672,249
Wheat—2,121 acres, 31,118 bushels, \$21,778 value
Oats—acres 5,129, bushels 2,554,776, value \$567,027.
Barley—acres 2,054, bushels 36,511, value \$14,122.
Rye—acres 56, bushels 1,121, value \$483
Buckwheat—acres 211, bushels 2,401, value \$1,220
Clover—acres 786, tons 1,306, value 4,878
Timothy—acres 23,911, tons 33,125, value \$115,374.
Millet and Hungarian—acres 358, tons 475, value \$1,657
Alfalfa—acres 2, tons 2, value \$10
Wild hay acres 19,946, tons 21,110, value \$56,665
Other forage crops—value \$10,733
Other farm crops—value \$238.

Produce Yield 1905

Flax seed—acres 419, bushels 4,115, value \$4,144
Clover seed—acres 91, bushels 169, value \$1,125.
Timothy seed—acres 566, bushels 2,227, value \$2,163.
Other grass seeds bushels 846, value \$307.
Irish potatoes bushels 111,100, value \$28,647.
Sweet potatoes bushels 641, value \$195
Sweet corn bushels 5,111, value \$2,109.
Vegetables \$13,413
Apples \$9,231.
Peaches \$55.
Plums \$3,067
Cherries \$83.
Total free fruit \$12,436.
Berries \$5,096

Number and Value of Livestock

Cattle of all kinds	31,321	Value \$616,644	Wool in pounds	4,826	Value \$	916
Horses and mules	10,519	" 675,377	Chickens	177,778	"	54,912
Swine	37,352	" 232,304	Other fowls	16,668	"	10,957
Sheep	1,255	" 4,957	Eggs in dozen	582,385	"	75,717
Goats	98	" 179	Dairy products		"	259,443
Other farm animals	52	" 2,400				

TWIN LAKE

Township 94 North, Range 24 West, of the 5th Principal Meridian.

Scale 1 1/2 Inches to the Mile.

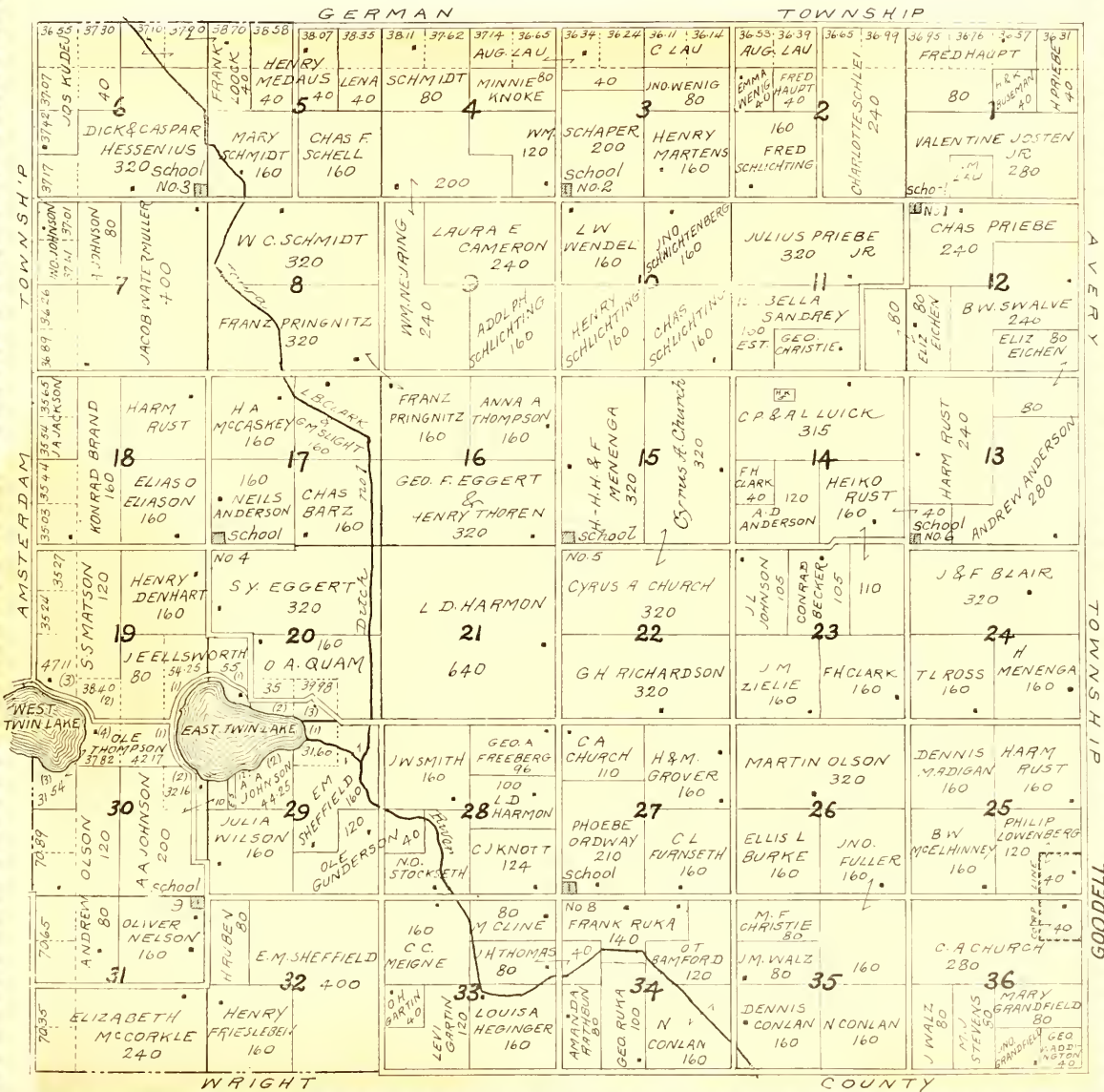

AVERY

1198177

Township 94 North, Range 23 West, of 5th Principal Meridian

Scale 1" = 1 Mile

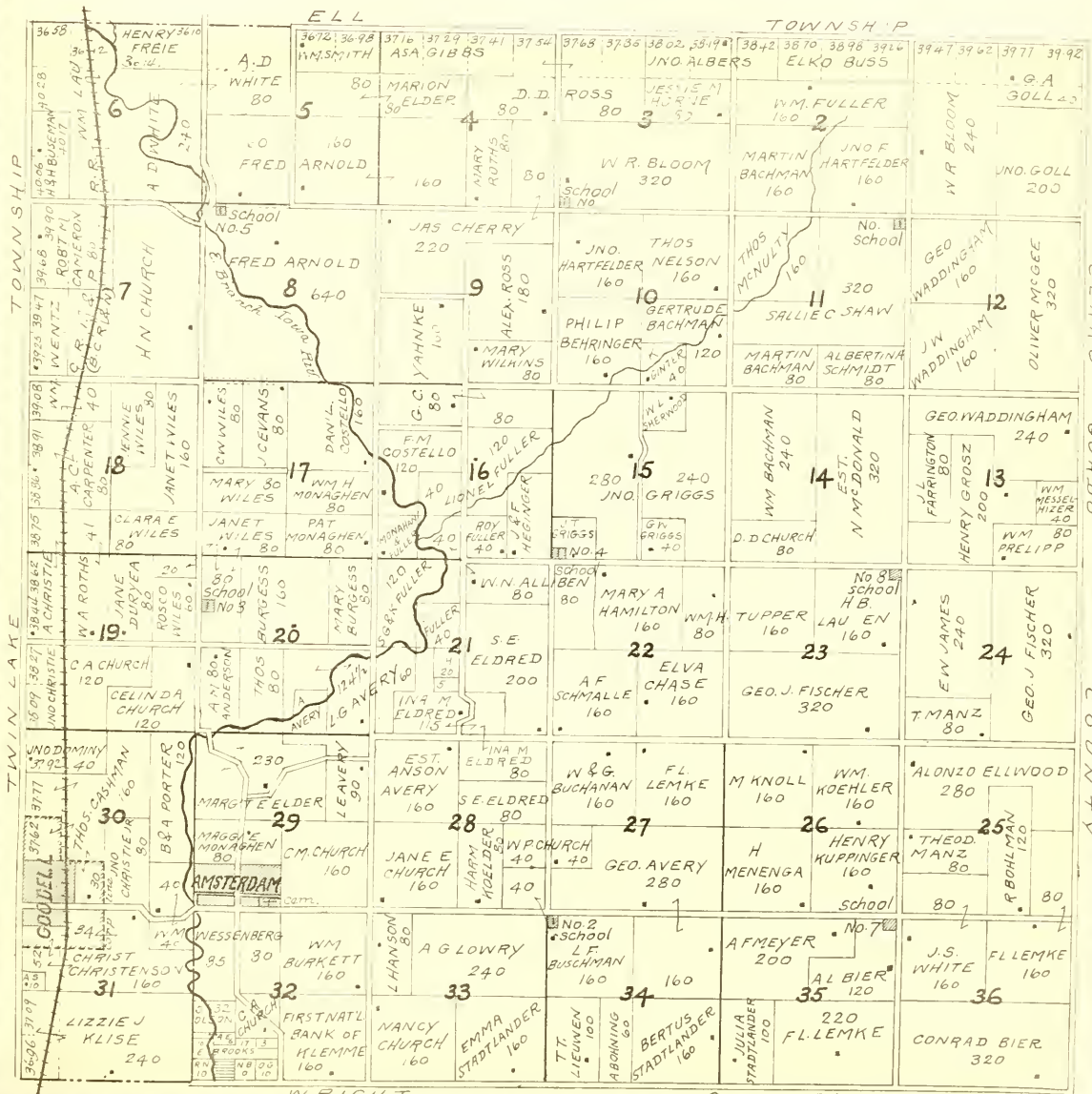

WRIGHT COUNTY

1865

