

## **Historic, Archive Document**

Do not assume content reflects current scientific knowledge, policies, or practices.





62.39

= 1947 =

LIBRARY  
 RECEIVED  
 JAN 17 1947  
 U S Department of Agriculture



"A ROSE FOR EVERY GARDEN"

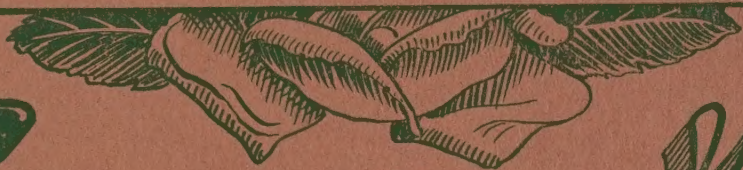

**Van der Pol**

MARINUS  
 VAN DER POL  
 PROPRIETOR

**NURSERY  
 AND LANDSCAPE  
 SERVICE**

ORNAMENTAL TREES,  
 EVERGREENS, SHRUBS,  
 PERENNIALS and  
 ROCK GARDEN PLANTS

Washington St., Route 6  
 Fairhaven, Mass.  
 Tel. New Bedford 2-0330



## GENERAL INDEX

	<i>Page</i>
General Information .....	1
Evergreen Trees .....	2
Evergreen Shrubs and Ground Covers .....	5
Rhododendrons .....	7
Shade Trees .....	7
Deciduous Trees .....	8
Flowering Shrubs .....	10
Berried Shrubs .....	15
Shrubs for Shady Places .....	16
Shrubs for Hedges .....	16
Trees for Hedges .....	17
Vines and Creepers .....	18
Roses .....	19
Fruits .....	20
Perennials .....	21
Bedding Plants .....	28
Landscape Materials .....	28
Garden Shop .....	30



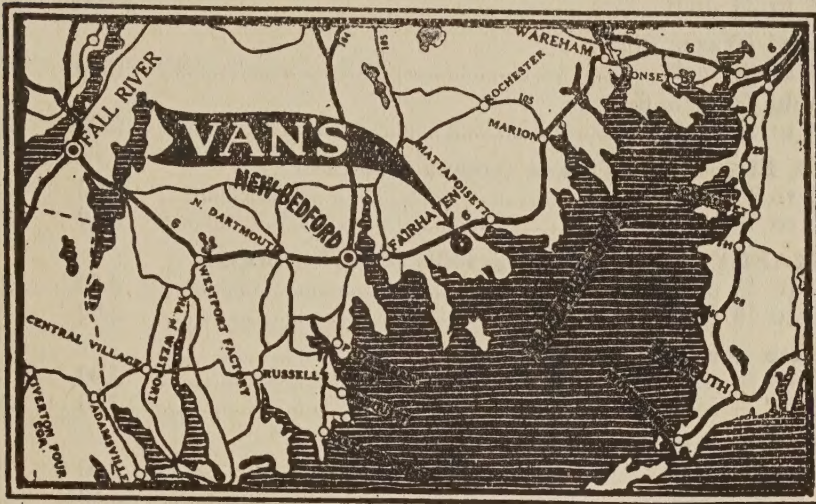

## GENERAL INFORMATION

**Location:**—Retail Salesgrounds are conveniently located on U. S. Route 6 (G. A. R. Highway) about 3 miles East of New Bedford. Main Nursery located at Washington Street and Alden Road, Fairhaven, 1 mile East of New Bedford. Open every day from daylight till dark.

**Shipments:**—Local delivery is made by truck at no additional cost. Truck delivery other than local, as per arrangement. Where shipped by other agencies, purchasers of stock assume all responsibilities including Charges for Carriage. Crating or Boxing charged for at cost.

**Prices:**—Prices in this list are net and subject to change without notice, they may be used as a guidance when ordering and whatever price changes take place, it will strictly conform with the general trend in the East.

The single price applies to from 1 to 4 plants, the ten rate from 5 to 24 plants and the 100 rate applies to from 25 to 250 plants of one kind only. Specimen items and items not listed are charged for at net worth. Your inquiry is invited for items not listed.

**Guarantee:**—All stock is guaranteed to be alive, true to name as Known by "Standardized Plant Names" and guaranteed to be a good representation of its type at the time of sale. All Claims for Errors must be made in writing within 5 days of receipt of goods. No Guarantee is given for its productiveness, growth, height or health after stock has left our care.

**Planting:**—Spring planting is preferred for many items, while others require to be planted in the Fall; when not familiar with the peculiarities of certain plants you may call on us for information without obligation.

**Estimates:**—An estimate of any size planting is Free for the asking. Plans and General Layout can be furnished, including all the necessary material in detail.



## EVERGREEN TREES for Foundation Planting

	Each	Ten
<b>ABIES Concolor</b> (white fir)		
18 to 24 inch .....	\$3.00	\$27.00
<b>Fraseri</b> (fraser fir)		
18 to 24 inch .....	3.00	27.00
<b>Veitchi</b> (veitch fir)		
18 to 24 inch .....	3.00	27.00
<b>BIOTA Elegantissima Nana</b> (compact biota)		
12 to 15 inch .....	2.00	18.00
15 to 18 inch .....	2.50	22.50
<b>CHAMAECYPARIS obtussa gracilis</b> (dwarf cypress)		
12 to 15 inch .....	2.50	23.50
15 to 18 inch .....	3.00	28.00
<b>Pisifera aurea</b> (yellow Sawara cypress)		
15 to 18 inch .....	2.00	18.00
18 to 24 inch .....	2.50	22.50
<b>P. Filifera</b> (thread cypress)		
18 to 24 inch .....	3.00	27.50
2 to 2½ ft. ....	3.50	32.50
<b>P. Filifera Aurea</b> (yellow thread cypress)		
18 to 24 inch .....	3.50	32.50
2 to 2½ ft. ....	4.50	
<b>P. Plumosa</b> (plume cypress)		
18 to 24 inch .....	2.00	18.00
2 to 3 ft. ....	3.00	27.50
3 to 4 ft. ....	3.75	35.00
<b>P. Plumosa Aurea</b> (yellow plume cypress)		
18 to 24 inch .....	2.25	21.00
2 to 3 ft. ....	3.25	30.00
3 to 4 ft. ....	4.00	37.50
<b>P. Plumosa sulphurea</b> (compact golden cypress)		
15 to 18 inch .....	2.50	22.50
<b>Squarosa veitchi</b> (moss cypress)		
12 to 15 inch .....	2.00	18.00
18 to 24 inch .....	3.00	28.00
<b>CRYPTOMERIA Lobbi Compacta</b> (compact cryptomeria)		
15 to 18 inch .....	2.00	18.00
4 to 5 ft. ....	6.00	56.00
<b>JUNIPERUS Chinensis Columnaris</b> (columnar cedar)		
3 to 4 ft. ....	4.50	41.00
4 to 5 ft. ....	6.00	54.00
5 to 6 ft. ....	7.50	67.50
<b>Ch. Pfitseriana</b> (pfitser cedar)		
18 to 24 inch spread .....	3.50	32.00
2 to 2½ ft. spread .....	5.00	45.00
2½ to 3 ft. spread .....	7.50	67.50
<b>Ch. Variegata Alba</b> (white leaf cedar)		
2½ to 3 ft. ....	4.50	
3 to 3½ ft. ....	7.00	
<b>Communis Hibernica</b> (irish cedar)		
15 to 18 inch .....	2.00	10.00
18 to 24 inch .....	2.50	22.50
2 to 3 ft. ....	3.50	32.00
3 to 4 ft. ....	4.50	41.00
<b>Excelsa Stricta</b> (greek cedar)		
12 to 15 inch .....	2.00	18.00
15 to 18 inch .....	2.50	22.50
18 to 24 inch .....	3.50	32.50
2 to 2½ ft. ....	5.00	45.00

5 plants at 10 rate; 25 plants at 100 rate



	Each	Ten
<b>JUNIPERUS Depressa Plumosa</b> (plume cedar)		
15 to 18 inch spread .....	2.00	18.00
<b>Sabina</b> (savin cedar)		
15 to 18 inch .....	2.00	18.00
<b>Squamata Meyer</b> (meyer cedar)		
18 to 24 inch .....	3.50	32.00
2 to 3 ft. ....	5.00	45.00
<b>Virginiana</b> (red cedar)		
2 to 3 ft. ....	2.50	22.50
3 to 4 ft. ....	3.50	32.00
4 to 5 ft. ....	5.00	45.00
5 to 6 ft. ....	6.50	60.00
Specimen up to 20 ft. available.		
<b>V. Cannarti</b> (cannart cedar)		
3 to 4 ft. ....	4.50	42.00
4 to 5 ft. ....	6.00	54.00
<b>Virginalis Globosa</b> (globe cedar)		
15 to 18 inch .....	3.50	32.00
18 to 24 inch .....	5.00	45.00
<b>PICEA Canadensis</b> (white spruce)		
18 to 24 inch .....	2.50	22.50
2 to 3 ft. ....	3.50	32.00
3 to 4 ft. ....	5.00	45.00
<b>Excelsa</b> (norway spruce)		
18 to 24 inch .....	2.50	22.50
2 to 3 ft. ....	3.50	32.00
3 to 4 ft, ....	5.00	45.00
<b>E. Gragoreana</b> (dwarf spruce)		
10 to 12 inch .....	3.50	32.00
12 to 15 inch .....	5.00	45.00
<b>Glauca Conica</b> (alberta spruce)		
9 to 12 inch .....	3.50	32.00
12 to 15 inch .....	4.50	41.00
15 to 18 inch .....	5.50	50.00
<b>Mariana</b> (black-hill spruce)		
18 to 24 inch .....	3.50	32.00
2 to 3 ft .....	4.50	41.00
<b>Pungens</b> (colorado spruce)		
3 to 4 ft. ....	4.50	41.00
4 to 5 ft. ....	6.00	54.00
<b>Pungens Glauca</b> (blue colorado spruce)		
2 to 3 ft. ....	4.50	
3 to 4 ft. ....	6.00	
4 to 5 ft. ....	8.00	
<b>P. Glauca Kosteri</b> (koster blue spruce)		
2 to 3 ft. ....	10.00	
3 to 4 ft. ....	15.00	
4 to 5 ft. ....	20.00	
<b>PINUS Cembra grafted</b> (swiss stone pine)		
2 to 2½ ft. ....	6.00	
2½ to 3 ft. ....	7.50	
<b>Montana mugho</b> (dwarf mugho pine)		
12 to 15 inch .....	2.50	
15 to 18 inch .....	3.50	
18 to 24 inch .....	4.50	
2 to 3 ft. unsheared .....	6.00	
<b>Nigre</b> (austrian pine)		
2 to 3 ft. ....	3.50	32.00
3 to 4 ft. ....	4.50	41.00
4 to 5 ft. ....	6.00	54.00

5 plants at 10 rate; 25 plants at 100 rate



	Each	Ten
<b>PINUS Resinosa</b> (red pine)		
5 to 6 ft. ....	9.00	
6 to 7 ft. ....	12.00	
<b>Thunbergia</b> (japanese black pine)		
2 to 3 ft. ....	3.50	32.00
3 to 4 ft. ....	5.00	45.00
<b>PSEUDOSTUGA Douglassi</b> (douglas fir)		
2 to 3 ft. ....	3.50	32.00
5 to 6 ft. ....	9.00	81.00
<b>SCIADOPITYS Verticillata</b> (umbrella pine)		
10 to 12 inch ....	3.50	32.00
12 to 15 inch ....	4.50	41.00
<b>TAXUS Baccata Repandens</b> (dwarf english yew)		
12 to 15 inch ....	3.50	32.00
15 to 18 inch ....	4.50	41.00
<b>Cuspidata</b> (spreading japanese yew)		
15 to 18 inch ....	3.50	32.00
18 to 24 inch ....	4.50	41.00
2 to 3 ft. ....	6.00	54.00
3 to 4 ft. ....	9.00	81.00
<b>C. Capitata</b> (upright japanese yew)		
18 to 24 inch ....	6.00	54.00
2 to 2½ ft. ....	10.00	90.00
2½ to 3 ft. ....	15.00	135.00
3 to 4 ft. ....	20.00	185.00
<b>C. nana</b> (compact dwarf yew)		
12 to 15 inch ....	3.50	32.00
15 to 18 inch ....	5.00	45.00
18 to 24 inch ....	7.50	68.00
2 to 2½ ft. ....	12.00	110.00
2½ to 3 ft. ....	15.00	135.00
3 to 4 ft. ....	20.00	185.00
<b>C. Hatfieldi</b> (hatfield yew)		
18 to 24 inch ....	4.50	41.00
2 to 2½ ft. ....	6.00	54.00
<b>C. Hicksi</b> (hicks yew)		
18 to 24 inch ....	4.50	41.00
2 to 3 ft. ....	6.00	54.00
<b>THUYA Occidentalis</b> (american arborvitea)		
This is a specialty, you will always find a large stock in many sizes available. This is ideal material for screens and windbreaks.		
2 to 3 ft. ....	2.50	22.50
3 to 4 ft. ....	3.50	32.00
4 to 5 ft. ....	5.00	45.00
5 to 6 ft. ....	6.50	60.00
6 to 8 ft. ....	9.00	81.00
8 to 10 ft. heavy ....	15.00	140.00
<b>Oc. compacta</b> (parson's globe arborvitea)		
12 to 15 inch ....	2.50	22.50
15 to 18 inch ....	3.50	32.00
18 to 24 inch ....	4.50	41.00
<b>Oc. Douglassi</b> (douglas pyramedal)		
2 to 3 ft. ....	4.50	42.00
3 to 4 ft. ....	6.00	54.00
<b>Oc. Globosa</b> (globe arborvitea)		
12 to 15 inch ....	2.50	22.50
15 to 18 inch ....	3.50	32.00
18 to 24 inch ....	5.00	45.00
<b>Oc. Hoveyi</b> (hoveyi arborvitea)		
2 to 3 ft. ....	4.50	

5 plants at 10 rate; 25 plants at 100 rate.



	Each	Ten
<b>THUYA Oc. Pyramidalis</b> (pyramidal arborvitea)		
18 to 24 inch .....	2.50	22.50
2 to 3 ft. ....	3.50	32.00
3 to 4 ft. ....	4.50	41.00
4 to 5 ft. ....	6.00	54.00
5 to 6 ft. ....	8.50	80.00
6 to 7 ft. ....	11.00	100.00
7 to 8 ft. ....	15.00	135.00
<b>Oc. Rosenthalii</b> (rosenthalii arborvitea)		
18 to 24 inch .....	2.50	22.50
2 to 3 ft. ....	3.50	32.00
3 to 4 ft. ....	5.00	45.00
<b>Oc. Umbraculifera</b> (green globe) arborvitea)		
12 to 15 inch .....	2.00	18.00
15 to 18 inch .....	3.50	32.00
18 to 24 inch .....	5.00	45.00
<b>Oc. Verveana</b> (verveaene arborvitea)		
The hardiest of arborviteas, excellent for hedges and screens. Do well in light sandy soils.		
2 to 3 ft. ....	3.50	32.00
3 to 4 ft. ....	5.00	45.00
<b>Oc. Wareana</b> (siberian arborvitea)		
18 to 24 inch .....	3.50	32.00
2 to 3 ft. ....	4.50	41.00
3 to 4 ft. ....	6.00	54.00
<b>Oc. Woodwardi</b> (woodward globe arborvitea)		
12 to 15 inch .....	2.00	18.00
15 to 18 inch .....	3.00	27.00
2 to 1/2 ft. ....	4.50	41.00
<b>TSUGA Canadensis</b> (canadian hemlock)		
18 to 24 inch .....	3.50	32.00
2 to 3 ft. ....	4.50	41.00
3 to 4 ft. ....	6.00	54.00
4 to 5 ft. ....	7.50	68.00
Larger plants available.		
<b>Caroliniana</b> (carolina hemlock)		
2 to 3 ft. ....	4.50	41.00
3 to 4 ft. ....	6.00	54.00
<b>Diversifolia</b> (dwarf hemlock)		
9 to 12 inch .....	2.50	22.50
12 to 15 inch .....	3.50	32.00
15 to 18 inch .....	4.50	41.00
18 to 24 inch .....	6.00	54.00

**EVERGREEN SHRUBS AND GROUND COVERS**

<b>BERBERIS Juliana</b> (evergreen barberry)		
18 to 24 inch .....	2.00	18.00
2 to 3 ft. ....	3.00	27.00
<b>BUXUS Sempervirens</b> (home grown, common boxwood)		
6 to 8 inch (for low hedges) .....	.50	4.50
12 to 15 inch .....	2.50	22.50
15 to 18 inch .....	3.50	32.00
18 to 24 inch .....	5.00	45.00
2 to 2 1/2 ft. round .....	7.50	
2 1/2 to 3 ft. round .....	10.00	
3 to 3 1/2 ft. round .....	15.00	
<b>CALLUNA Vulgaris</b> (red heather)		
6 to 8 inch .....	1.00	9.00
8 to 12 inch .....	1.50	13.50
<b>Vulgaris alba</b> (white heather)		
6 to 8 inch .....	1.00	9.00
8 to 12 inch .....	1.50	13.50

5 plants at 10 rate; 25 plants at 100 rate



	Each	Ten
<b>CALLUNA Vulgaris nana</b> (dwarf heather)		
6 to 8 inch .....	1.00	9.00
Other heathers are available.		
<b>DAPHNE Cneorum maximum</b> (large flowering rose daphne)		
6 to 9 inch .....	2.00	18.00
9 to 12 inch .....	3.00	27.00
12 to 15 inch .....	4.00	36.00
<b>EUONYMUS Radicans</b> (winter creeper)		
Self clinging vines for walls and rocks, evergreen.		
2 yr. old .....	.75	6.00
3 yr. old .....	1.25	10.00
<b>Radicans Varigata</b> (silver edge creeper)		
2 yr. old .....	1.00	9.00
3 yr. old .....	1.25	11.00
<b>R. Colorado</b> (turns red in winter)—(colorado creeper)		
2 yr. old .....	1.00	9.00
<b>R. Minimus</b> (fine rockplant)—(baby wintercreeper)		
2 yr. old, 3 inch pots .....	1.00	9.00
<b>R. Vegetus</b> (bigleaf wintercreeper)		
2 yr. old .....	1.00	9.00
3 yr. old .....	1.25	11.00
<b>HEDERA Helix</b> (english ivy)		
Ideal ground and wall cover for shady places.		
4 inch pots, long vines .....	1.00	9.00
<b>Helix Baltica</b> (baltic ivy)		
4 inch pots, long vines .....	1.00	9.00
<b>ILEX Latifolia</b> (large leaf japanese holly)		
2½ to 3 ft. ....	9.00	81.00
<b>Opaca</b> (fruitbearing) — (native holly)		
18 to 24 inch (grafted) .....	5.00	45.00
<b>KALMIA Latifolia</b> (mountain laurel)		
Laurel with extra large pink flowers. This stock is positively the finest available.		
18 to 24 inch .....	4.50	42.50
2 to 3 ft. ....	6.00	55.00
4 to 5 ft. (clumps) .....	10.00	90.00
<b>LEUCOTHOE Catesbaei</b> (drooping leucothoe)		
15 to 18 inch .....	2.50	22.50
18 to 24 inch .....	3.50	32.00
<b>LONICERA Halleana</b> (hall's honeysuckle)		
2 yr. old .....	.75	6.50
3 yr. old .....	1.00	9.00
<b>Henryi</b> (evergreen honeysuckle)		
3 yr. old .....	1.00	9.00
<b>Sempervirens</b> (trumpet honeysuckle)		
3 yr. old .....	1.00	9.00
5 plants at 10 rate; 25 plants at 100 rate.		
<b>MAHONIA Aquifolia</b> (evergreen mahonia)		
18 to 24 inch .....	3.50	32.00
<b>PACHISTIMA Cambyi</b> (camby pachistima)		
Fine for borders and rock gardens.		
4 to 6 inch, bushy .....	1.00	9.00
<b>PACHYSANDRA Terminalis</b> (japanese spurge)	Each	10
2 yr. field grown .....	.35	2.70
3 inch pot grown .....	.35	2.70
Per 1,000 — \$150.00		
<b>PIERIS Floribunda</b> (lily of the valley)—(mountain andromeda)	Each	Ten
15 to 18 inch shrub .....	3.00	27.00
18 to 24 inch .....	4.50	41.00
5 plants at 10 rate; 25 plants at 100 rate		



<b>PIERIS Japonica</b> (drooping andromeda)	Each	Ten
15 to 18 inch .....	3.00	27.00
18 to 24 inch .....	4.50	41.00
2 to 2½ ft. ....	6.00	54.00
2½ to 3 ft. (specimen plants) .....	9.00	
<b>PYRACANTHA Coccinia Lelandi</b> (fruiting firethorn).		
4 inch pot grown .....	3.50	32.00
<b>VINCA Minor</b> (blue periwinkle)	Each	10
2 yr. field grown .....	.35	2.70
3 inch pot grown .....	.35	2.70
Per 1,000 plants — \$150.00		
<b>M. Bowles Variety</b> (large leaf periwinkle)	Each	Ten
2 yr. field grown .....	.50	4.50

## RHODODENDRONS

<b>RHODODENDRONS Caroliniana</b> (carolina rhododendron)		
12 to 15 inch budded .....	3.00	27.00
15 to 18 inch budded .....	4.50	42.00
18 to 24 inch budded .....	6.00	55.00
2 to 2½ ft. budded .....	9.00	85.00
<b>Catawbiense</b> (catawba rhododendron)		
18 to 24 inch budded .....	4.50	42.00
2 to 3 ft. budded .....	6.00	54.00
<b>Maximum</b> (rosebay rhododendron)		
2 to 3 ft. ....	6.00	54.00
3 to 4 ft. ....	9.00	81.00
<b>Raceamosus</b> (dwarf mayflower rhododendron)		
4 to 6 inch .....	3.00	27.00
6 to 8 inch .....	5.00	45.00
<b>Hybrids Grafted</b>		
15 to 18 inch—each	4.50	
18 to 24 inch—each	6.00	
Album Elegans—White		
Charles Dickens—Scarlet Red		
H. C. Dresselhuys—Dark Red		
Roseum Elegans—Rose Pink		

## SHADE TREES

<b>ACER Dasycarpum</b> (silver maple)		
12 to 14 ft. ....	6.00	54.00
<b>Platanoides</b> (norway maple)		
6 to 8 ft. ....	3.50	32.00
8 to 10 ft. ....	5.00	45.00
10 to 12 ft. ....	7.50	65.00
12 to 14 ft. ....	9.00	80.00
16 to 18 ft. specimen, 2½ inch trunk .....	15.00	130.00
<b>PL. Schwedleri</b> (red schwedler maple)		
10 to 12 ft. ....	9.00	
<b>Rubrum</b> (red swamp maple)		
8 to 10 ft. ....	5.00	45.00
10 to 12 ft. ....	7.50	65.00
<b>Saccharum</b> (sugar maple)		
6 to 8 ft. ....	3.50	32.00
8 to 10 ft. ....	5.00	45.00
10 to 12 ft. ....	7.50	65.00
12 to 14 ft. ....	9.00	81.00
14 to 16 ft. ....	15.00	130.00
18 to 20 ft. specimen .....	35.00	

5 plants at 10 rate; 25 plants at 100 rate



	Each	Ten
<b>FAGUS Sylvatica</b> (european beech)		
6 to 8 ft. B-B .....	12.00	
<b>S. Riversi</b> (purple beech)		
4 to 5 ft. B-B .....	12.00	
5 to 6 ft. B-B .....	15.00	
<b>GINKGO Biloba</b> (maidenhair tree)		
An unusually beautiful tree, free of disease.		
6 to 8 ft. ....	5.00	45.00
8 to 10 ft. ....	7.50	65.00
<b>PLANTANUS Occidentalis</b> (american plane tree)		
6 to 8 ft. ....	3.50	32.00
8 to 10 ft. ....	5.00	45.00
<b>POPULUS Nigra Italica</b> (lombardi poplar)		
6 to 8 ft. ....	2.50	22.50
8 to 10 ft. ....	3.50	32.00
<b>QUERCUS Palustris</b> (pin oak)		
6 to 8 ft. ....	3.50	32.00
10 to 12 ft. ....	8.00	72.00
12 to 14 ft. ....	12.00	110.00
<b>Rubra</b> (red oak)		
6 to 8 ft. ....	3.50	32.00
10 to 12 ft. ....	8.00	72.00
12 to 14 ft. ....	12.00	110.00
<b>TILIA Vulgaris</b> (european linden)		
10 to 12 ft. ....	7.50	65.00
12 to 14 ft. ....	12.00	110.00
<b>ULMUS Americana</b> (american elm)		
10 to 12 ft. ....	5.00	32.00
12 to 14 ft. ....	7.50	65.00
<b>Pumila</b> (chinese elm)		
8 to 10 ft. ....	3.50	32.00
10 to 12 ft. ....	5.00	45.00

## DECIDUOUS TREES

### Ornamental and Flowering Trees for Landscaping the Home Grounds

<b>BETULA Papyrifera</b> (canoe birch)		
6 to 8 ft. ....	3.50	32.00
8 to 10 ft. ....	5.00	45.00
10 to 12 ft. ....	7.50	65.00
Clumps available at net worth.		
<b>Pendula Gracillus</b> (cutleaf weeping birch)		
6 to 8 ft. ....	5.00	45.00
8 to 10 ft. ....	7.50	68.00
<b>CATALPA Bignoides Nana</b> (umbrella tree)		
6 ft. stem, 3 yr. head .....	5.00	45.00
<b>Speciosum</b> (flowering catalpa)		
10 to 12 ft. ....	5.00	45.00
<b>CERCIS Canadensis</b> (red bud or judas tree)		
4 to 5 ft. ....	3.50	32.00
8 to 10 ft. ....	10.00	90.00
5 plants at 10 rate; 25 plants at 100 rate.		
<b>CHIONANTHUS Virginica</b> (white fringe)		
3 to 4 ft. ....	2.50	22.50
4 to 5 ft. ....	3.50	32.00
<b>CORNUS Florida</b> (white flowering dogwood)		
3 to 4 ft. B-B .....	3.50	32.00
4 to 5 ft. B-B .....	4.50	41.00
5 to 6 ft. B-B .....	6.00	54.00
Bare root trees slightly lower in price.		
5 plants at 10 rate; 25 plants at 100 rate		



	Each	Ten
<b>CORNUS Fl. Rubra</b> (red flowering dogwood)		
2 to 3 ft. grafted B-B .....	4.50	41.00
3 to 4 ft. grafted B-B .....	7.50	65.00
4 to 5 ft. grafted B-B .....	9.00	81.00
5 to 6 ft. grafted B-B .....	15.00	135.00
<b>CRATAEGUS Oxycantha Alba Pleno</b> (double white hawthorne)		
4 to 5 ft. ....	5.00	45.00
5 to 6 ft. ....	7.50	65.00
<b>Ox. Rosea Pleno</b> (double pink hawthorne)		
4 to 5 ft. ....	5.00	45.00
5 to 6 ft. ....	7.50	65.00
<b>Ox. Splendens</b> (paul's scarlet hawthorne)		
4 to 5 ft. ....	5.00	45.00
5 to 6 ft. ....	7.50	65.00
<b>LABURNUM Vulgaris</b> (Home grown)—(golden chain tree)		
5 to 6 ft. B-B .....	4.50	41.00
6 to 8 ft. B-B .....	6.00	54.00
<b>V. Vossi</b> (improved golden chain)		
5 to 6 ft. ....	5.00	
6 to 8 ft. ....	7.50	
<b>LARIX Laricina</b> (american larch tree)		
5 to 6 ft. ....	5.00	
<b>MAGNOLIA Soulangeana</b> (saucer magnolia)		
2 to 3 ft. B-B.....	7.50	65.00
3 to 4 ft. B-B.....	10.00	90.00
4 to 5 ft. B-B.....	15.00	135.00
<b>Stellata</b> (star magnolia)		
18 to 24 inch B-B .....	5.00	45.00
2 to 3 ft. B-B .....	7.50	65.00
3 to 4 ft. B-B .....	10.00	90.00
<b>MALUS Arnoldiana</b> (arnold's flowering crab)		
4 to 5 ft. B-B.....	4.50	
<b>Baccata</b> (white flowering crab)		
5 to 6 ft. B-B.....	4.50	
<b>Floribunda</b> (japanese flowering crab)		
4 to 5 ft. B-B.....	4.50	
<b>PRUNUS Cerasifera Pissardi</b> (purple leaf plum)		
6 to 8 ft. ....	5.00	
<b>Subhirtella Pendula</b> (weeping cherry)		
These beautiful flowering trees have 6 ft. stems with single or double pink flowers in May.		
3 year old heads .....	7.50	70.00
5 year old heads .....	10.00	90.00
10 year old heads .....	50.00	

## JAPANESE FLOWERING CHERRIES

<b>BENI Higan</b> (creamy white)		
6 to 8 ft. ....	9.00	80.00
<b>KWANSAN</b> (double pink)		
3 to 4 ft. B-B.....	4.50	41.00
5 to 6 ft. B-B.....	6.00	54.00
6 to 8 ft. B-B.....	9.00	81.00
8 to 10 ft. heavy B-B .....	15.00	135.00
Several other varieties available		
<b>SALIX Babylonica</b> (babylon weeping willow)		
6 to 8 ft. ....	2.50	18.00
8 to 10 ft. ....	3.50	32.00
10 to 12 ft. ....	6.00	50.00
<b>Niobe</b> (yellow weeping willow)		
6 to 8 ft. ....	2.50	22.50
8 to 10 ft. ....	3.50	32.00

5 plants at 10 rate; 25 plants at 100 rate



	Each	Ten
<b>SORBUS Aucuparia</b> (mountain ash)		
6 to 8 ft. ....	3.50	32.00
8 to 10 ft. ....	5.00	45.00
12 to 14 ft. ....	8.00	72.00

These produce large clusters of orange red fruit.

## FLOWERING SHRUBS

Shrubs suitable for Foundation planting, Borders, Screens and Natural landscape purposes. This list is the most complete collection of hardy New England Grown Flowering Shrubs.

<b>AMELANCHIER Canadensis</b> (downy shadblow)			
2 to 3 ft. ....	1.00		
3 to 4 ft. ....	1.50		
<b>ARONIA Arbutifolia</b> —see Berried Shrubs page 12.			
<b>Melanocarpa</b> (black choke berry)			
2 to 3 ft. ....	1.00		
<b>AZALEA Calendulacea</b> (flame azalea)			
12 to 15 inch .....	3.50	32.00	
18 to 24 inch .....	4.50	41.00	
<b>Kaempferi</b> (torch azalea)			
12 to 15 inch.....	3.00	27.00	
15 to 18 inch.....	4.50	41.00	
18 to 24 inch.....	6.00	54.00	
<b>Mollis (mixed colors)</b> —(chinese azaleas)			
15 to 18 inch.....	3.50	32.00	
18 to 24 inch.....	4.50	41.00	
<b>Mucronulata</b> (mongolian azalea)			
15 to 18 inch.....	3.50	32.00	
18 to 24 inch.....	4.50	41.00	
2 to 2½ ft. ....	6.00	54.00	
<b>Poukhanensis</b> (korean azalea)			
9 to 12 inch .....	2.50	22.50	
12 to 15 inch.....	3.50	32.00	
15 to 18 inch.....	5.00	45.00	
18 to 24 inch.....	7.50	65.00	
2 to 2½ ft. ....	9.00	81.00	
<b>Vaseyi</b> (pink shell azalea)			
2 to 2½ ft. ....	6.00		
	Each	10	100
<b>BERBERIS Thunbergia</b> (green japanese barberry)			
12 to 15 inch .....	.35	3.25	25.00
15 to 18 inch .....	.50	4.50	40.00
10 to 24 inch .....	.75	6.50	55.00
<b>Th. Atropurpurea</b> (red japanese barberry)	Each	Ten	
18 to 24 inch .....	1.25	11.00	
3 to 4 ft. heavy .....	3.00	27.00	
<b>Th. Erecta</b> (true hedge barberry)	Each	10	100
(Plant patent No. 110)			
Upright and compact hardy barberry, ideal for borders.			
12 to 15 inch .....	.50	4.50	40.00
15 to 18 inch .....	.75	6.50	60.00
18 to 24 inch .....	1.00	9.00	85.00
	Each	Ten	
<b>BUDDLEIA Davidi Magnifica</b> (butterfly bush lavender)			
3 to 4 ft. ....	1.00	9.00	
<b>Ill de France</b> (purple butterfly bush)			
2 to 3 ft. ....	1.00	9.00	
<b>Pink Charming (NEW)</b> (pink butterfly bush)			
2 to 3 ft. ....	1.00	9.00	

5 plants at 10 rate; 25 plants at 100 rate



	Each	Ten
<b>CALYCANTHUS Floridus</b> (sweet shrub)		
2 to 3 ft. ....	1.00	9.00
3 to 4 ft. ....	1.50	13.50
<b>CARAGANA Arborescens</b> (siberian pea shrub)		
3 to 4 ft. ....	1.00	9.00
<b>CLETHRA Allinifolia</b> (summer sweet)		
2 to 3 ft. ....	1.00	9.00
<b>CORNUS Alba Siberica</b> (red twig dogwood)		
2 to 3 ft. ....	1.00	9.00
3 to 4 ft. ....	1.25	10.00
<b>Stolonifera Fraveriana</b> (golden twig dogwood)		
2 to 3 ft. ....	1.00	9.00
3 to 4 ft. ....	1.25	10.00
<b>COTONEASTER Divaricata</b> (red fruit)		
18 to 24 inch .....	1.00	9.00
2 to 3 ft. ....	1.50	13.50
3 to 4 ft. ....	2.00	18.00
<b>Horizontalis</b> (spreading cotoneaster)		
9 to 12 inch potgrown .....	1.50	13.50
12 to 15 inch B-B .....	2.00	10.00
See list under fruitbearing shrubs.		
<b>CYDONIA Japonica</b> (flowering quince)		
18 to 24 inch.....	1.00	9.00
2 to 3 ft. ....	1.50	13.50
<b>DAPHNE Mezereum</b> (february daphne)		
15 to 18 inch.....	2.50	
<b>DEUTZIA Gracillus</b> (dwarf deutzia)		
12 to 15 inch.....	1.00	9.00
15 to 18 inch.....	1.25	11.00
<b>Lemoine</b> (lemoine deutzia)		
18 to 24 inch.....	1.00	9.00
2 to 3 ft. ....	1.25	11.00
<b>Crenata Rosea</b> (pink deutzia)		
2 to 3 ft. ....	1.00	9.00
3 to 4 ft. ....	1.50	13.50
<b>Pride of Rochester</b> (tall deutzia)		
3 to 4 ft. ....	1.00	9.00
4 to 5 ft. ....	1.50	13.50
<b>EUONYMUS Alatus</b> (winged euonymus)		
2 to 3 ft. ....	1.25	11.00
3 to 4 ft. ....	2.00	18.00
<b>A. Compacta</b> (compact winged euonymus)		
15 to 18 inch.....	1.25	11.00
2 to 2½ ft. ....	2.50	22.00
<b>EXOCHORDA Grandiflora</b> (pearl bush)		
2 to 3 ft. ....	1.25	11.00
3 to 4 ft. ....	2.00	18.00
<b>FORSYTHIA Intermedai Spectabilis</b> (showy border forsythia)		
2 to 3 ft. ....	.90	8.00
3 to 4 ft. ....	1.25	11.00
4 to 5 ft. ....	2.00	18.00
<b>Suspensa</b> (weeping forsythia)		
2 to 3 ft. ....	1.00	9.00
3 to 4 ft. ....	1.50	13.50
<b>S. Fortuni</b> (fortune forsythia)		
2 to 3 ft. ....	1.00	9.00
3 to 4 ft. ....	1.50	13.50
4 to 5 ft. ....	2.00	18.00
<b>S. Spring Glory</b>		
18 to 24 inch.....	1.50	
2 to 3 ft. ....	2.25	

(Available Fall 1946)

5 plants at 10 rate; 25 plants at 100 rate



<b>FOTHERGILLA Major</b> (large fothergilla)	Each	Ten
2 ft. heavy clumps .....	5.00	
<b>HIBISCUS Syriacus (ROSE OF SHARON)</b>		
<b>Ardens</b> (single purple flowers)		
3 to 4 ft. ....	1.25	11.00
<b>Coelestius</b> (extra large single blue)		
18 to 24 inch .....	2.00	18.00
<b>Duch. de Brabant</b> (double dark red)		
3 to 4 ft. ....	1.25	11.00
<b>Jeanne de Arc</b> (double white)		
3 to 4 ft. ....	1.25	11.00
<b>Paeonyflora</b> (white with red center)		
3 to 4 ft. ....	2.00	18.00
<b>Rubis</b> (single red)		
3 to 4 ft. ....	1.25	11.00
<b>Totus Alba</b> (single white)		
3 to 4 ft. ....	1.25	11.00
<b>W. R. Smith</b> (extra large single white)		
18 to 24 inch .....	2.00	18.00
<b>HYDRANGEA Arborescens Grandiflora</b> (hill's of snow)		
2 to 3 ft. ....	1.00	9.00
<b>Paniculata</b> (single tree hydrangea)		
2 to 3 ft. ....	1.25	11.00
3 to 4 ft. ....	2.00	18.00
<b>P. Grandiflora</b> (fall hydrangea)		
2 to 3 ft. ....	1.25	11.00
3 to 4 ft. ....	2.00	18.00
<b>KERRIA Japonica Flora Pleno</b> (double Kerria)		
2 to 3 ft. ....	1.50	13.50
3 to 4 ft. ....	2.00	18.00
<b>KOLKWITSIA Amabilis</b> (Chinese beauty bush)		
2 to 3 ft. ....	1.25	11.00
3 to 4 ft. ....	2.00	18.00
4 to 5 ft. ....	3.00	27.00
<b>LIGUSTRUM Amurense</b> (amur river privet)	Each	10 100
2 to 3 ft. ....	.50	4.50 40.00
3 to 4 ft. ....	.75	6.50 60.00
<b>Ibolium</b> (hardy ibolium privet)		
2 to 3 ft. ....	.45	4.00 35.00
3 to 4 ft. ....	.60	5.50 48.00
	Each	Ten
<b>LONICERA Fragrantissima</b> (fragrant bush honeysuckle)		
2 to 3 ft. ....	1.00	9.00
3 to 4 ft. ....	1.50	13.50
<b>Morrowi</b> (morrow honeysuckle)		
2 to 3 ft. ....	1.00	9.00
<b>Tartarica</b> (pink tartarian honeysuckle)		
2 to 3 ft. ....	1.00	9.00
3 to 4 ft. ....	1.50	13.50
<b>Tart. Alba</b> (white tartarian honeysuckle)		
2 to 3 ft. ....	1.00	9.00
3 to 4 ft. ....	1.50	13.50
<b>PHILADELPHUS Cornarius</b> (sweet scented mockorange)		
2 to 3 ft. ....	.90	8.00
3 to 4 ft. ....	1.25	11.00
<b>Grandiflora</b> (large flowering mockorange)		
2 to 3 ft. ....	.90	8.00
3 to 4 ft. ....	1.25	11.00
4 to 5 ft. ....	1.50	13.50

5 plants at 10 rate; 25 plants at 100 rate



HYBRID VARIETIES OF MOCKORANGE

	Each	Ten
<b>PHILADELPHUS Lemoine</b> (fragrant white flowers)		
18 to 24 inch .....	1.00	9.00
2 to 3 ft. ....	1.50	13.50
<b>Mount Blanc</b> (finest large flowering white)		
18 to 24 inch .....	1.25	11.00
2 to 3 ft. ....	1.50	13.50
<b>Virginalis</b> (very large double white)		
2 to 3 ft. ....	1.25	11.00
3 to 4 ft. ....	1.50	13.50
<b>PHYSOCARPUS Opulifolia</b> (nine-bark)		
4 to 5 ft. ....	1.50	13.50
<b>O. Aurea</b> (yellow nine bark)		
4 to 5 ft. ....	1.50	13.50
<b>PRUNUS Glandulosa Alba</b> (double white almond)		
2 to 3 ft. ....	2.00	18.00
3 to 4 ft. ....	3.00	27.00
<b>Gl. Rosea</b> (double pink Almond)		
2 to 3 ft. ....	2.00	18.00
3 to 4 ft. ....	3.00	27.00
<b>Triloba</b> (double flowering plum)		
2 to 3 ft. ....	2.00	18.00
3 to 4 ft. ....	3.00	27.00
4 to 5 ft. ....	4.00	27.00
<b>Tomentosa</b> (nanking cherry)		
2 to 3 ft. ....	1.25	11.00
3 to 4 ft. ....	1.50	13.50
<b>RHODOTYPHUS Kerrioides</b> (jetbead)		
2 to 3 ft. ....	1.00	9.00
3 to 4 ft. ....	1.25	11.00
<b>ROSA Hugonis</b> (Chinese golden rose)		
2 to 3 ft. ....	1.50	13.50
3 to 4 ft. ....	2.00	18.00
4 to 5 ft. extra heavy .....	3.00	27.00
<b>Multiflora Japonica</b> (japanese rose)	Each	10 100
3 to 4 ft. ....	.50	4.00 35.00
<b>Wicheriana</b> (wichurian rose)		
3 to 4 ft. ....	1.00	9.00 75.00
4 to 5 ft. ....	1.50	13.50 100.00
<b>SPIREA Arguta</b> (garland spirea)	Each	Ten
2 to 3 ft. ....	1.10	10.00
3 to 4 ft. ....	1.50	14.00
<b>B. Anthony Waterer</b> (red flowering spirea)		
18 to 24 inch.....	1.25	11.00
2 to 3 ft. ....	1.75	16.00
<b>Prunifolia</b> (double white spirea)		
2 to 3 ft. ....	1.50	
<b>Thunbergia</b> (thunberg spirea)		
2 to 3 ft. ....	1.95	16.00
<b>Tricocarpa</b> (korean spirea)		
2 to 3 ft. ....	1.25	11.00
3 to 4 ft. ....	1.75	16.00
<b>Van Houtte</b> (van houtte spirea)		
2 to 3 ft. ....	.90	8.00
3 to 4 ft. ....	1.50	13.50
4 to 5 ft. ....	2.50	22.00
<b>STEPHANDRA Flexuosa</b> (cutleaf stephanandra)		
2 to 3 ft. ....	1.50	13.50
3 to 4 ft. ....	2.50	22.00

5 plants at 10 rate; 25 plants at 100 rate

	Each	Ten
<b>SYMPHORICARPUS Chenaulti</b> (improved indian currant)		
2 to 3 ft. ....	1.00	9.00
3 to 4 ft. ....	1.50	13.50
<b>Raceamosus</b> (snow berry)		
2 to 3 ft. ....	1.00	9.00
3 to 4 ft. ....	12.50	11.00
<b>Vulgaris</b> (indian currant)		
2 to 3 ft. ....	1.00	9.00
<b>SYRINGA Chinensis</b> (chinese lilac)		
3 to 4 ft. ....	2.00	18.00
<b>Vulgaris</b> (common lilac)		
2 to 3 ft. ....	1.00	9.00
3 to 4 ft. ....	1.50	13.50
<b>V. Alba</b> (white lilac)		
2 to 3 ft. ....	1.25	12.00
3 to 4 ft. ....	1.75	17.00

## HYBRID LILACS

<b>Congo</b> (dark purple)		
2 to 3 ft. ....	2.50	22.00
<b>Mme. C. Perrier</b> (double white)		
2 to 3 ft. ....	2.50	22.00
<b>Valentina</b> (choice lavender)		
2 to 3 ft. ....	2.50	2.25
We have a stock of Hybrid lilacs from 4 to 6 feet tall, single and double flowering sorts. Select from these when in flower in May.		
<b>VACCINIUM Corymbosum</b> (high bush blue berry)		
2 to 3 ft. ....	1.50	13.50
For hybrid blue berries see Fruit Department, page 21.		
<b>VIBURNUM Carlesi</b> (may flower viburnum)		
18 to 24 inch ....	3.50	32.50
2 to 3 ft. ....	5.00	45.00
<b>Dentatum</b> (arrow wood)		
2 to 3 ft. ....	1.00	9.00
3 to 4 ft. ....	1.25	11.00
<b>Opulus sterile</b> (snowball)		
2 to 3 ft. ....	1.25	11.00
3 to 4 ft. ....	1.75	16.00
<b>Sieboldi</b> (siebold viburnum)		
3 to 4 ft. ....	1.50	13.50
4 to 5 ft. ....	2.00	18.00
<b>Tomentosum</b> (doublefile viburnum)		
2 to 3 ft. ....	1.25	11.00
3 to 4 ft. ....	2.00	18.00
<b>T. Plicatum</b> (japanese snowball)		
18 to 24 inch ....	3.00	
<b>VITEX Macrophylla</b> (chaste tree)		
2 to 3 ft. ....	2.00	
<b>WEIGELIA Candida</b> (white weigelia)		
3 to 4 ft. ....	1.25	11.00
4 to 5 ft. ....	2.00	18.00
<b>Eva Rathka</b> (red weigelia)		
2 to 3 ft. ....	1.10	10.00
3 to 4 ft. ....	1.50	13.50
<b>Floribunda</b> (pink weigelia)		
2 to 3 ft. ....	1.10	10.00
3 to 4 ft. ....	1.50	13.50
4 to 5 ft. ....	2.00	18.00

5 plants at 10 rate; 25 plants at 100 rate



	Each	Ten
<b>WEIGELIA Florbunda Venusta</b> (large pink flowers)		
Most prolific flowering of all weigelia, a honey.		
3 to 4 ft. ....	2.00	18.00
<b>Rosea Variegata</b> (dwarf pink weigelia)		
18 to 24 inch .....	1.25	11.00
2 to 3 ft. ....	1.75	16.00

## BERRIED SHRUBS

These shrubs are desirable for their colored fruit, adding brightness to the Garden and many shrubs attract certain birds which otherwise would not come to your garden to eat. Ask for our list and plan for your Bird Sanctuary. Costs are small, shrubs will last a lifetime.

<b>ARONIA Arbutifolia</b> (red choke berry)		
2 to 3 ft. ....	1.10	9.00
<b>BERBERIS Vulgaris</b> (red fruit barberry)		
3 to 4 ft. ....	1.10	9.00
<b>CELASTRUS Scandense</b> (orange berries)		
2 to 3 ft. ....	1.00	9.00
<b>CALLICARPS Japonica</b> (purple berry)		
2 to 3 ft. ....	1.25	11.00
<b>COTONEASTER Divaricata</b> (red berry cotoneaster)		
18 to 24 inch .....	1.00	9.00
2 to 3 ft. ....	1.50	13.50
3 to 4 ft. ....	2.00	18.00
<b>Horisontalis</b> (red fruit)		
9 to 12 inch B-B .....	1.50	13.50
12 to 18 inch B-B .....	2.00	18.00
<b>ELEAGNUS Angustifolia</b> (olive green fruit)		
3 to 4 ft. ....	1.50	13.50
4 to 5 ft. ....	2.00	18.00
<b>EUONYMUS Bungeana</b> (orange fruit)		
3 to 4 ft. ....	1.25	11.00
<b>Radican Vegetus</b> (orange scarlet fruit)		
12 to 15 inch .....	1.25	11.00
<b>ILEX Verticilata</b> (red winter berry)		
(Guaranteed fruit-bearing plants included)		
2 to 3 ft. ....	1.50	13.50
3 to 4 ft. ....	2.00	18.00
<b>LIGUSTRUM Ibot</b> (ibota privet black fruit)		
2 to 3 ft. ....	.50	4.50
3 to 4 ft. ....	.65	6.00
<b>LONICERA Tartarica</b> (red berries)		
3 to 4 ft. ....	1.50	13.50
<b>PHOTINA-Villosa</b> (reddish fruit)		
This is a beautiful shrub, growing to 15 feet in height, splendid fall foliage and colorful fruit.		
2 to 3 ft. ....	1.25	11.00
3 to 4 ft. ....	1.75	16.00
<b>PRUNUS Maritima</b> (beech plum)		
18 to 24 inch .....	1.25	11.00
2 to 3 ft. ....	1.75	16.00
<b>SYMPLOCUS Paniculata</b> (reddish fruit)		
2 to 3 ft. ....	1.50	13.50
<b>SYMPHORICARPUS Raceamosus</b> (white berries)		
2 to 3 ft. ....	1.00	9.00
<b>Vulgaris</b> (red fruit)		
2 to 3 ft. ....	1.00	9.00

5 plants at 10 rate; 25 plants at 100 rate

	Each	Ten
<b>VACINIUM Corymbosum</b> (blue berries)		
2 to 3 ft. ....	1.50	13.50
<b>VIBURNUM Cassinoides</b> (bluish fruit)		
3 to 4 ft. ....	1.25	10.00
<b>Dilitatum</b> (red fruit)		
3 to 4 ft. ....	2.00	18.00
<b>Lentago</b> (black fruit)		
3 to 4 ft. ....	1.75	16.00
<b>Opulus</b> (red fruit)		
2 to 3 ft. ....	1.00	9.00
3 to 4 ft. ....	1.50	13.50

## SHRUBS FOR SHADY PLACES

The following are recommended for a shady place; some do better in moist, others in dry locations. Ascertain which are most suitable for your particular conditions.

**AZALEAS**, almost all varieties—Page 10

**BENZOIN Eastivale**

**BERBERIS** in variety—Page 10

**CORNUS** in variety—Page 8, 9, 11

**KALMIA Latifolia**—Page 6

**EUONYMUS**, all varieties—Page 6

**LEUCOTHOE Catesbai**—Page 6

**LONICERA**, in variety—Page 6, 12

**LIGUSTRUM**, in variety—Page 12, 16, 17

**PIERIS**, in variety—Page 6, 7

**RHODODENDRONS**, in variety—Page 7

**SYMPHORICARPUS**, in variety—Page 14

**VIBURNUM**, in variety—Page 16

**VACINIUM Corymbosum**—Page 16, 21

Some others are suitable for shady locations, though only recommended when locations are satisfactory.

## SHRUBS FOR HEDGES

	Each	Ten
<b>ACANTHOPANAX Pentaphyllum</b> (five leaf aralia)		
2 to 3 ft. ....	1.00	9.00
	Each	10
		100
<b>BERBERIS Thunbergia</b> (green japanese barberry)		
12 to 15 inch .....	.35	3.25
15 to 18 inch .....	.50	4.50
18 to 24 inch .....	.75	6.50
2 to 2½ ft. ....	1.00	9.00
<b>Th. Atropurpurea</b> (red japanese barberry)		
15 to 18 inch .....	.90	8.00
18 to 24 inch .....	1.25	11.00
<b>Th. Erecta</b> (true hedge barberry)		
Plant patent No. 110		
12 to 15 inch .....	.50	4.50
15 to 18 inch .....	.75	6.50
18 to 24 inch .....	1.00	9.00
<b>CARAGANA Arborescens</b> (pea shrub)		
3 to 4 ft. ....	1.00	9.00
<b>EUONYMUS Alatus Compacta</b> (dwarf winged euonymus)		
15 to 18 inch .....	1.25	11.00
2 to 2½ ft. ....	2.50	22.00
<b>LIGUSTRUM Amurense</b> (armur river privet)		
2 to 3 ft. ....	.50	4.50
3 to 4 ft. ....	.75	6.50

5 plants at 10 rate; 25 plants at 100 rate



	Each	Per 10	100
<b>Ibodium</b> (hardy ibodium privet)			
2 to 3 ft. ....	.45	4.00	35.00
3 to 4 ft. ....	.60	5.50	48.00
<b>Ovalifolium</b> (california privet)			
18 to 24 inch .....	.25	2.20	20.00
2 to 3 ft. ....	.35	3.20	30.00
3 to 4 ft. ....	.45	4.10	38.00
<b>SPIREA Van Houtte</b> (white spirea)			
2 to 3 ft. ....	.90	8.00	65.00
3 to 4 ft. ....	1.50	13.50	100.00
<b>SYRINGA Vulgaris</b> (common lilac)			
2 to 3 ft. ....	1.00	9.00	75.00
3 to 4 ft. ....	1.50	13.50	100.00
<b>VIBURNUM Opulus</b> (high bush cranberry)			
2 to 3 ft. ....	1.00	9.00	80.00
3 to 4 ft. ....	1.25	11.00	100.00

## EVERGREEN TREES FOR HEDGES

Permanent screens, large hedges and wind breaks can be promptly installed from this list of northern grown material.

	Each	Ten
<b>JUNIPERUS Chinensis Columnaris</b> (columnar cedar)		
3 to 4 ft. ....	4.50	41.00
4 to 5 ft. ....	6.00	54.00
5 to 6 ft. ....	7.50	67.50
<b>Virginiana</b> (red cedar)		
2 to 3 ft. ....	2.50	22.50
3 to 4 ft. ....	3.50	32.00
4 to 5 ft. ....	5.00	45.00
5 to 6 ft. ....	6.50	60.00
<b>PICEA Canadensis</b> (white spruce)		
2 to 3 ft. ....	3.50	32.00
3 to 4 ft. ....	5.00	45.00
<b>Excelsa</b> (norway spruce)		
2 to 3 ft. ....	3.50	32.00
3 to 4 ft. ....	5.00	45.00
<b>PINUS Strobus</b> (white pine)		
5 to 6 ft. ....	9.00	81.00
<b>PSEUDOSTUGA Douglassi</b> (douglas fir)		
5 to 6 ft. ....	9.00	81.00
<b>TAXUS Cuspidata Capitata</b> (upright yew)		
2 to 3 ft. Hedge grade .....	10.00	90.00
3 to 4 ft. Hedge grade .....	15.00	135.00
<b>THUYA Occidentalis</b> (american arborvitea)		
2 to 3 ft. ....	2.50	22.50
3 to 4 ft. ....	3.50	32.00
4 to 5 ft. ....	5.00	45.00
5 to 6 ft. ....	6.50	60.00
6 to 8 ft. ....	9.00	82.00
8 to 10 ft. ....	15.00	140.00
<b>TSUGA Canadensis</b> (canadien hemlock)		
2 to 3 ft. ....	4.50	41.00
3 to 4 ft. ....	6.00	54.00
4 to 5 ft. ....	7.50	68.00
8 to 9 ft. ....	25.00	225.00

Several other types of Evergreen Trees can be used for screening and other purposes. We suggest that you see our stock.

5 plants at 10 rate; 25 plants at 100 rate

## VINES AND CREEPERS

	Each	Ten
<b>ACTINIDIA Arguta</b> (Bower actinidia)		
3 yrs. old (heavy) .....	1.25	11.00
<b>AKEBIA Quinata</b> (five leaf akebia)		
3 yrs. old (heavy) .....	1.25	11.00
<b>AMELOPSIS Heterophylla</b> (porcelain vine)		
3 yrs. old .....	1.25	11.00
<b>Quinquefolia Engelmanni</b> (Engleman creeper)		
3 yrs. (pot grown) .....	1.00	9.00
<b>Tricuspidata Veitchi</b> (Boston ivy)		
3 yrs. (pot grown) .....	1.25	11.00
<b>ARISTOLOCHIA Sipho</b> (dutchman's pipe)		
5 yrs. old (potgrown) .....	2.50	22.50
<b>BIGNONIA Radicans</b> (trumpet vine)		
3 yrs. old .....	1.00	9.00
<b>R. Floribunda</b> (large flowering trumpet vine)		
5 yrs. old (heavy) .....	4.50	
<b>CELASTRUS Scandens</b> (american bittersweet)		
3 yrs. old .....	1.00	9.00
<b>CLEMATIS</b>		
<b>Paniculata</b> (sweet autumn clematis)		
3 yrs. old .....	1.25	11.00

## CLEMATIS HYBRIDS

<b>Duchess of Edinburg.</b> Large Double White	2.00	18.00
<b>Henryi.</b> Extremely large single White.		
<b>Jackmanni.</b> The best Velvety Purple.		
<b>Mme. Baron Veillard.</b> Large Silvery Pink.		
<b>Mme. Edward Andre.</b> Crimson Red.		
<b>Ramona.</b> An ineffable shade of Clear Blue.		
<b>HEDERA.</b> English Ivy—4 inch pots .....	1.00	9.00
<b>LONICERA Halleana</b> (hall's honeysuckle)		
2 yrs. old .....	.75	6.50
3 yrs. old .....	1.00	9.00
<b>Sempervirens</b> (trumpet honey suckle)		
3 yrs. old .....	1.00	9.00
<b>LYCIUM Chinensis</b> (matrimony vine)		
3 yr. old .....	.90	8.10
<b>POLYGONUM Auberti</b> (chinese fleece vine)		
2 yrs. old (potgrown) .....	2.00	18.00
<b>WISTERIA Multijuga Rosea</b> (pink japanese wisteria)		
3 yrs. old (grafted) .....	2.50	22.00
<b>Sinensis</b> (chinese wisteria blue)		
3 yrs. old (grafted) potgrown .....	2.50	22.00
5 yrs. old (heavy) .....	4.50	38.00
<b>S. Alba</b> (chinese wisteria white)		
3 yrs. old (grafted) potgrown .....	2.50	22.00

5 plants at 10 rate; 25 plants at 100 rate



## HYBRID TEA ROSES

All potgrown \$1.50 each, \$13.50 per 10

- Ami Quinard.** Crimson red, fragrant.  
**Autum.** Orange red, slightly fragrant.  
**Betty Uprichard.** Copper yellow, fragrant.  
**Columbia.** Deep pink, fragrant.  
**Condessa de Sistago.** Orange and pink.  
**Edith Nelli Perkins.** Salmon orange, fragrant.  
**Editor McFarland.** Bright pink, slightly fragrant.  
**E. G. Hill.** Deep red, very fragrant.  
**Etoile de Hollande.** Deep red, fragrant (one of the best).  
**Golden Dawn.** Yellow, fragrant.  
**Gruss an Teplitz.** Crimson, very fragrant (all summer flowers).  
**Joana Hill.** Sunburst yellow, fragrant.  
**Kaiserin Auguste Victoria.** Creamy white, fragrant (best white).  
**Killarney White.** Fragrant (old favorite).  
**Margaret McGredy.** Carmine rose (very choice).  
**McGredy Scarlet.** Orange scarlet (choice).  
**Mme. Butterfly.** Salmon pink (an old timer).  
**Mrs. Charles Bell.** Salmon pink (very hardy).  
**Mrs. E. P. Thom.** Deey canary yellow (very free flowering).  
**Mrs. Pierre S. Dupont.** Golden yellow, fragrant.  
**Ophelia.** Salmon flesh color, slightly fragrant.  
**Peace.** "New" \$2.50  
**Pink Pearl.** Salmon pink, very fragrant.  
**President Hoover.** Orange, fragrant (very large flowers).  
**Radiance.** Silvery pink (sturdy grower, hardy).  
**Red Radiance.** Same as above, fragrant.  
**Roselyn.** Golden yellow, slightly fragrant.  
**Rouge Mallerin.** Very good red.  
**Sister Therese.** Yellow, fragrant.  
**Talisman.** Yellow, gold and pink.  
**Thomas Edison.** A very good pink.

## HYBRID PERPETUAL ROSES

All potgrown \$1.50 each, \$13.50 per 10

- Frau Karl Druski.** White (old favorite), continuous flowering.  
**Hugonis.** Yellow, very hardy (single flowers).  
**Harrison Yellow.** Double yellow flowers.

## ROSA RUGOSA

- Rugosa Red and White.** Ideal for beech planting.  
 Each \$1.25 \$11.00 per 10

## ROSA RUGOSA HYBRIDS

\$1.25 each, \$12.00 per 10

- F. J. Grootendorst.** Red clusters all summer.  
**Pink Grootendorst.** Pink clusters all summer.  
**Sir Thomas Lipton.** White, fragrant.

5 plants at 10 rate; 25 plants at 100 rate

## FLORIBUNDA AND POLYANTHA ROSES

All potgrown, \$1.50 each, \$13.50 per 10

- Cecil Brunner.** Sweetheart rose, pink.  
**Gloria Mundi.** Orange scarlet.  
**Orleans.** Light pink.  
**Triumph de Orleans.** Cherry red.  
**Betty Prior.** Bright Pink.  
**Donald Prior.** Dark Red.  
**Elsa Poulsen.** Silver Pink.  
**Kirstes Poulsen.** Orange Pink.  
**Permanent Wave.** Salmon Orange.

## CLIMBING ROSES

All potgrown, \$1.50 each, \$13.50 per 10 except as noted.

- Albertine.** Salmon pink, fragrant (very large flowers).  
**American Beauty.** Pink, fragrant (old favorite).  
**American Pillar.** Pink with yellow center.  
**Blaze.** Red, patented. \$2.00 each.  
**Chaplin's Pink.** Soft pink.  
**Christine Wright.** Rose pink (large flowers).  
**Doublooms.** Yellow, patented. \$2.50 each.  
**Dr. Huye.** Darkest of all reds.  
**Dr. Van Fleet.** Flush pink (a favorite).  
**Gardenia.** Light yellow.  
**Jacotte.** Copper yellow.  
**Mary Lovett.** Double white flowers.  
**Mary Wallace.** Pink fragrant.  
**Mme. Gregoire Stachellin.** Light pink (extra large flowers).  
**New Dawn.** Patented, flush pink. \$2.50 each.  
**Paul's Scarlet.** Red (most popular red climbing rose).  
**Primrose.** Canary yellow (double flowers).  
**Roseri.** All shades of pink.  
**Scorcher.** Red, large single flowers.  
**Silvermoon.** Single white flowers (a favorite).  
**White Dorothy Perkins.** Cluster of white flowers.

## A Complete List of Brownell Roses

- Golden Glow.** The best Yellow Climber grown. potted \$2.00 each  
**Mrs. Arthur Curtis James** (Golden Climber)  
 Excellent Golden Yellow Climber. potted \$2.00 each

## FRUIT DEPARTMENT

	Each	Ten
<b>STANDARD APPLES</b>		
2 yr. old, 5 to 7 ft. ....	2.00	18.00
<b>Baldwin — Delicious</b>		
<b>Gravenstein — McIntosh Red</b>		
<b>Red Astrachan — R. I. Greening — Yellow Transparent</b>		
<b>Transcendent Crab Apple</b>		
<b>STANDARD PEARS</b>		
2 yr. old, 5 to 7 ft. ....	2.50	22.00
<b>Bartlett — Beurre Bosc — Clapp's Favorite — Seckle</b>		
<b>DWARF PEARS</b>		
3 to 4 ft. ....	3.50	33.50
<b>Bartlett — Beuree Bosc — Clapp's Favorite</b>		
5 plants at 10 rate; 25 plants at 100 rate		



	Each	Ten
<b>STANDARD CHERRIES</b>		
2 yr. old, 5 to 7 ft. ....	3.00	27.00
<b>Black Tartarian</b> (sweet) — <b>Windsor</b> (sweet)		
<b>Montmorency</b> (sour)		
<b>STANDARD PEACHES</b>		
2 yr. old, 5 to 7 ft. ....	1.75	16.50
<b>Crawford's Early</b> — <b>Elberta</b>		
<b>STANDARD PLUMS</b>		
2 yr. old, 5 to 7 ft. ....	3.25	31.00
<b>Burbank's</b> — <b>Reine Claude</b>		
<b>STANDARD QUINCE</b>		
2 yr. old, 4 to 6 ft. ....	2.25	21.00
<b>Champion</b>		

### SMALL FRUITS

<b>ASPARAGUS</b>	Each	25	100
2 yr. old roots .....	.10	2.00	6.00
<b>Martha Washington</b>			
<b>BLUE BERRIES, Hybrids</b>			
3 yr. old, 18 to 24 inch .....	2.00	40.00	
5 yr. old, 2 to 3 ft. ....	4.50	100.00	
<b>Cabot—Jersey—Pioneer—Rancocas—Rubel—Stanley</b>			
<b>GRAPES</b> —2 yr. old. 80c each.			
<b>Concord</b> (blue) — <b>Worden</b> (blue) — <b>Agawam</b> (red) — <b>Delaware</b> (red) — <b>Moore's Early</b> (white) — <b>Green Mountain</b> (white) — <b>Niagara</b> (white)			
<b>RASPBERRIES</b>			
1 yr. strong roots .....	1.00	2.00	8.00
<b>Latham</b> (red)		Each	25
<b>RHUBARB</b>			
2 yr. old strong roots .....	.40		9.00

### HARDY PERENNIALS

These desirable Hardy Plants give the Garden Picture color. From the early Spring with little tufts of blue and yellow of the Alyssum and dwarf Phloxes the showing continues with bolder masses of breath-taking beauty. Columbines, Bleedinghearts, Doronicums and others are followed up by the dazzling splendor of the newer Oriental Poppies, the Liliams and Hemerocalis, not overlooking the Delphiniums with their stately spikes and infinite tints of lavenders, rose and blues. Anemones, Asters, Chrysanthemums and Aconites are just a few more with which to build the undreamed of vistas with their irresistible appeal and splendor.

The stock offered are all field grown plants, strong, sturdy, healthy plants that will make a fine showing right after planting.

Prices are: all plants 35c each, \$3.20 per 10, \$28.00 per 100, except as noted.

**ACHILLIA The Pearl.** Fine for cutting (double white yarrow).

**ACONITUM Nappelus Sparks.** 4 ft. tall (branchy monkshood).

**AJUGA Genevensis.** Low growing border plant (geneva bugle).

**Reptans.** For rock garden or pool. 6 inches tall.

**ALTHEA.** Tall flowering Hollyhocks ..... 30c each; \$2.80 per 10  
Single white, pink and dark red.

Double, apple blossom pink, red and yellow.

**ALYSSUM Saxitalis Compacta** (pot of gold). Large bunches of flowers.

**ANCHUSA Italica Dropmore** (dropmore buglos). Used for cutting.

**Myosotidiflora** (siberian buglos). Low growing, blue flowers.

5 plants at 10 rate; 25 plants at 100 rate

- ANEMONE Japonica** (japanese anemone). Cutflower, in many shades.  
**Queen Charlotte.** Pink.  
**Whirlwind.** Light pink.
- ANEMONE Pulsatila.** Early lavender anemone.  
**Pulsatila Rubra.** Early red anemone.
- ANTHEMUS Tinctoria.** Cut flower, camomile.  
**Perry's Variety.** This is a choice type.
- AQUILEGIA** (columbine)  
**Bees' Hybrids Long Spurred.** Finest strain. 40c each; \$3.70 per 10  
**Long Spurred Hybrids.** Choice colors.  
**Vulgaris Nivea.** Double white flowers.
- ARABIS Alpina Compacta** (single). Compact rockcress.  
**Alpina Flora Pleno** (double white) ..... 55c each; \$5.00 per 10
- ARMERIA.** A rock garden plant known as thrift.  
**Cephalotus Rubra.** Red flowers.  
**Maritima dwarf type.** Lavender flowers.
- ARTEMESIA Lactiflora.** Cut flower (mugwort).  
**Silver King.** White foliage for cutting.
- ASCLEPIAS Tuberosa.** Orange butterfly weed.

### ASTERS (Hardy Garden Types)

- |   | Each | Ten  |
|---|------|------|
| <b>ASTER Frikarti.</b> Excellent for cutting, blue .....  | .55  | 5.00 |
| <b>Harrington's Pink.</b> The best pink out .....   | .55  | 5.00 |
| <b>King George.</b> Choice dwarf type, large blue .....   | .50  | 4.70 |
| <b>Mount Everest.</b> Late white.   |      |      |
| <b>Peggy Ballard.</b> Late mauve.   |      |      |
| <b>Skylands Queen.</b> Late blue.   |      |      |
| <b>ASTILBE</b> (perennial spirea). A plant with fine foliage and flowers.   |      |      |
| <b>America.</b> Peach pink .....  | .55  | 5.00 |
| <b>Gloria.</b> Deep pink .....  | .55  | 5.00 |
| <b>Margaret van Rechteren.</b> Red .....  | .55  | 5.00 |
| <b>Peach Blossum.</b> Similar to America .....  | .55  | 5.00 |
| <b>W. E. Gladstone.</b> White .....   | .55  | 5.00 |
| <b>AUBRIETIA Deltoides Grandiflora</b> (rockgarden aubrietia).  |      |      |
| <b>BAPTISIA Australis</b> (a legume). Blue indigo.  |      |      |
| <b>BOLTONIA Asteroides</b> (bolton's aster). Aster-like flower, white.<br><b>Latisquama Nana.</b> Lavender flowers.   |      |      |
| <b>CAMPANULA.</b> All these are blue, white or pink bell shaped flowers.<br><b>Carpathica</b> (dwarf carpathican bell flower). Blue and white.<br><b>Lactiflora</b> (tall bell flower). Blue.<br><b>Medium.</b> These are single and double, white, blue and pink.<br><b>Muralis.</b> A very dwarf blue bell flower.<br><b>Persicifolia</b> (peachleaf bell flower). Blue.<br><b>Rotundifolia</b> (hare bell flower). Blue. |      |      |
| <b>CENTAUREA Montana</b> (blue cut flower). Cornflower.   |      |      |
| <b>CERASTIUM Tomentosum</b> (low growing rockgarden plant). Snow in summer.   |      |      |
| <b>CERASTIGMA Plumbagioides</b> (low growing rockgarden plant).<br><b>Plumbago.</b>   |      |      |
| <b>CHELONE Barbatum</b> (native bog plant). Turtle head.<br><b>Lyoni.</b> Blue type of above.   |      |      |
| <b>CHRYSANTHEMUMS (Hardy Garden Types)</b> — Ask for list.  |      |      |
| <b>CHRYSANTHEMUM Max. Dieners.</b> Double white, fine cut flower.<br><b>Max. White Swam.</b> Earliest white, fine cutting.<br><b>Koreanum.</b> Late white, fine for cutting.  |      |      |
| List of Fall Flowering Hybrids for the asking.  |      |      |
| <b>CIMICIFUGA Foetida Simplex.</b> Late flowering bog plant — bugbane.<br>\$1.00 each.<br><b>Racemosus.</b> Early flowering white.—50c each.<br>5 plants at 10 rate; 25 plants at 100 rate  |      |      |



- CONVALARIA Majalis** (Lily of the Valley). Fine flower  
Clumps, 50c each. 1 yr. pips. for picking — 25c each.  
**Maj. Fortin's Giant.** New large white, 1 yr. pips — 30c each.
- COREOPSIS Lanceolata** (coreopsis). Orange cut flower
- CYPREPIDIUM Acaule** (lady slipper). A woodland plant.  
**Pubescens.** Yellow type of above.  
**Spectabilis.** Giant pink type of above.
- DELPHINIUM Belladonna** (larkspur 2 ft.). Soft sky blue flowers.  
**Bellamosum.** Dark blue form of Belladonna.  
**West Coast Hybrids.** Huge florets in lovely colors. 75c each.
- DIANTHUS Barbatus** (sweet william). Colors pink, red and white.  
**Beatrix** (everblooming). Double pink fragrant flowers. 50c each.  
**Caryophyllus** (scented clove pink).  
**C. Grenadin.** Double flowers in many colors.  
**Deltoides** (maiden pink). Fine rockery plant.  
**Mrs. Simpkins.** A double white free flowering type.
- DICENTRA Eximea** (fringed bleeding heart). Pink flowers all summer.  
Fine for shady places. 12 to 15 inch.  
**Spectabilis** (bleeding heart). Graceful racemes of pink heart shaped  
flowers, 2 ft. \$1.00 each; \$8.50 per 10.
- DICTAMNUS Albus** (white gas plant). An unusual and fragrant plant.  
55c each.  
**Albus Rubra.** Red form of above. 55c each.
- DIGITALIS Shirley Hybrids** (foxglove). Separate colors of white,  
pink, purple.
- DODECATHEON Meadia** (shooting star). Cyclamen-like flowers, rock-  
ery plant.
- DORONICUM Plantagineum Excelsum** (leopard bane). Large yellow  
flowers on tall stems early in spring. Fine cut flower. 55c each.
- ECHINACEA Purpurea** (cone flower). Pink flowers suitable for cutting.
- ECHINOPSIS Ritro** (globe thistle). Steel blue flowers in July. 3-4 ft.
- EPIGAEA Repens** (trailing arbutus). Waxy pink owers, like partial  
shade and sloping ground. Large clumps \$1.00 each; \$9.00 per 10.
- EPIMEDIUM Macranthum** (snowy epimedia). Beautiful flowers and  
excellent foliage. Does well in shady places. 50c each, \$4.50 per 10.
- ERIGERON Speciosus Grandiflora** (flea bane). Blue aster-like flowers.
- EUPATORIUM Coelestinum** (hardy ageratum). Masses of blue flowers  
in September.  
**Fraseri.** White form of above, flowers in July-August, 2 ft.
- EUPHORBIA Polycroma** (spurge). Very early yellow flowers, 10  
inches tall.

## FERNS (Hardy)

- ADIANTHUM Pedatum** (American maidenhair fern). Does well in  
shade, 2 ft.
- FESTUGA Glauca** (blue fescue). Tufts of blue grass-like foliage. 1 ft.
- POLYSTICHUM Acrosticoides** (Christmas fern). Most popular of all  
hardy ferns.
- FILIPENDULA Rubra Venusta** (pink meadow sweet). Feathery plumes  
of pink flowers.  
**Ulmaria Flora Pleno** (white meadow sweet). Graceful sprays.
- GAILARDIA Grandiflora** (blanket flower). Fine cut flower all sum-  
mer, 2 ft.  
**Portola Hybrids.** Larger flowers and brighter colors, 2 ft.  
**Tangerine.** New giant orange yellow flowers. 50c each.
- GALAX Aphylla** (shiny galax). White flowers in May. Fine in shade.
- GENTIANA Andrewsii** (closed gentian). Cluster of intense blue flowers  
in September.  
**Acaulis Clussi.** A choice plant with large blue open flowers. \$1.00.  
5 plants at 10 rate; 25 plants at 100 rate

- GYPSOPHYLA *Paniculata*** (baby's breath). Tiny white flowers in masses.
- Pan. Bristol Fairy.** Double white flowers, ideal for cutting. 50c
- Pan. Repens.** A dwarf form for the rock gardens.
- HELINIUM *Autumnale*.** Golden yellow flowers in August. 3 ft.
- A. Riverton Gem.** A bronzy red form of above. 3 ft.
- HELIANTHEMUM** (sun rose). Shade of yellow, orange and red, rockery plant.
- HELIOPSIS *Scabro Zinneaflora*** (double sun flower). Ideal cut flower. 3 ft.
- HEMEROCALIS *Dumortieri*** (day lily). Early bright orange flowers. 1½ ft.
- Flava.** Fine lemon yellow, early, 3 ft.
- Middendorfi.** Dwarf orange yellow lily. Flowers early.
- Thunbergia.** Late clear yellow, 4 ft.
- Named Hybrids** of outstanding quality.
- Bay State.** Large deep yellow. Clumps 80c each, \$7.00 per 10.
- Cressida.** Late rich orange. Clumps 80c each, \$7.00 per 10.
- D. D. Wyman.** Late golden yellow. Clumps 80c each, \$7.00 per 10.
- Goldini.** Medium size, deep golden yellow. Clumps 50c each.
- Mrs. A. H. Austin.** Very large golden yellow clumps. 80c each.
- Mrs. W. H. Wyman.** Lemon yellow, very late. Clumps 80c each.
- Kwanso Flora Pleno.** Double deep orange. 50c each, \$4.50 per 10.
- HEPATICA *Acutiloba*** (early spring flowering Hepatica).
- HEUCHERA *Sanguinia*** (coral bells). Bright crimson bell shaped flowers
- S. Pluie de Feu.** Bright red, same as above.
- S. Rosamundi.** Pink coral bells, summer flowering.
- HIBISCUS *Moscheutos*** (common mallow). Pinkish, flowers all summer.
- M. Marvel Mallow.** Large flowering red, white and pink. Ideal for wet places. Grows 4 feet tall.
- HOSTA (*Funkia*) *Fortuni Robusta*** (blue leaf plantain lily). Fine for shade.
- Lancifolia alba-marginata** (silverleaf plantain lily).
- Plantaginea Grandiflora.** Large white flowering plantain lily. 50c.
- HYPERICUM *Moserianum*** (St. Johnwort). Shrubby plant, large yellow flowers.
- IBERIS *Sempervirens*** (candy tuft). Pure white flowers in May, evergreen.
- S. Little Gem.** Compact masses of white flowers for rock garden.
- IRIS *Germanica*.** We have a list of early flowering German Iris. See our stock in flower during the month of May.
- IRIS *Kaempferi*** (Japanese Iris). All Japanese Iris are 50c each, \$4.50 per 10.
- Blue Bird.** Single deep blue.
- Blue Jay.** Light clear blue, a beauty.
- Gold Bound.** Double white gold veines. The most popular white.
- Kogarbi.** A lavender blue.
- Mandazuru.** Double white veined with blue. An unusual color.
- Mahogany.** Large double mahogany red.
- Purple and Gold.** Deep blue with gold stripes.
- Venus.** Single white, 3 petals.
- IRIS *Cristata*** (crested Iris). Dwarf blue Iris for wet places.
- Pseudocora** (yellow swamp iris). Clear yellow flowers on 3 foot stems.
- Pumila** (dwarf iris). Yellow, purple and white rockgarden iris.
- Siberica** (Siberian iris). Blue flowers, 2 feet tall in June.
- Siberica Alba.** White form of above.
- JASIONE *Perennis*.** Blue flowers in June and July, 5 to 6 inches tall.
- LATHYRUS *Latifloia*** (hardy sweet peas). Pink, white and red flowers.
- LAVENDULA *Officinalis Vera*** (sweet lavender). Aromatic foliage, blue flowers.
- LIATRIS *Pycnostachya*** (gayfeather). Long spikes of rosy purple flowers.
- Pyc. Alba.** White, same as above. 50c each.
- Spicata.** Flowering spikes in August and September, 2 feet tall.

5 plants at 10 rate; 25 plants at 100 rate



- LILIUM Auratum** (goldband lily). Tall stocks with immense flowers in July. \$1.25 potted \$1.50 each.
- Candidum** (Madonna lily). Pure waxy white flowers July 4th. This is an excellent lily with Blue Delphiniums in masses. \$1.00 each.
- Formosanum Philipinensis** (Philippine lily). Late fall lily with very large tubular shaped white flowers. \$1.00 each.
- Hansoni** (Hanson's lily). Fragrant yellow flowers with brown spots. \$1.25 each.
- Henryi** (Henry lily). Rich orange flowers in August. 4 ft. tall. \$1.00 each.
- Regali** (Regal lily). Most popular lily with white inside petals and pinkish outer petals. Extra large bulbs 75c each.
- Speciosum Album** (white form of Rubrum lily). Late summer flowering. \$1.25. 2nd size \$1.00; potted \$1.50 each.
- Sp. Rubrum** (Rubrum lily). Rosy red flowers in late summer. each \$1.25; 2nd size \$1.00; potted \$1.50 each.
- Tenifolium** (coral lily). A fine rockgarden lily. Early red flowers 50c each.
- Tigrinum Gigantica** (giant tiger lily). Orange red flowers in August. 50c each.
- LIMONIUM Latifolia** (sea lavender). Large panicles of blue flowers. 2 feet.
- LINUM Perenne** (flax). Blue flowers on dainty stems all summer. 1 to 2 ft.
- LOBELIA Cardinalis** (cardinal flower). Scarlet red flowers on 3 ft. spikes.
- L. Syphilitica** (blue lobelia). A fine addition in lobelias.
- LUPINUS Polyphyllus** (Washington lupine). Blue, white and pink flowers.
- P. Hybrids**. Imported types of lupine, wider color range. These include orange, apricots, two toned colors, etc. 50c each.
- Russell Hybrids**, 50c each; \$4.50 for 10.
- LYCHNIS Viscaria Splendens** (double campion). 1 foot stem with rose pink flowers in July. Suitable for cutting.
- LYSIMACHIA Nummularia** (money's worth). A creeper with many yellow flowers.
- MAZUS Reptans Rugosa** (creeping plant), with little orchid-like flowers.
- MENTHA Piperita** (peppermint). Aromatic herb, with flowers.
- MERTENSIA Virginica** (Virginia blue bell). Early flowering native plant with spikes of flowers resembling bleeding hearts.
- MONARDA Didyma** (beebalm). Scarlet red flowers in July and August.
- Salmonea**. Salmon colored beebalm. Grows 2 to 3 ft. tall.
- NEPETA Mussini** (catnip). Grey green foliage with bluish flowers from May to September. Fine for borders.
- OENOTHERA Fuiticosa Youngi** (evening primrose). Free flowering from June till October. Yellow, 1 foot height.
- Missouriensis** (Ozark sundrop). Large yellow flowers on short stems. Fine rockgarden plant.
- OPUNCTIA** (hardy cactus). Large green leaves. Yellow flower in August.
- PAEONIA**. Large double flowers. Excellent for cutting.
- Duchesse de Nemourse**. Sulphur white, fragrant. \$1.00 each.
- Edulus Superba**. Bright lilac pink. Early. \$1.00 each.
- Festive Maxima**. Best white, red fleck in center. \$1.00 each.
- Karl Rosenfield**. Best red, very large. \$1.00 each.
- Single Paeonia**
- Areos**. Very light pink shading white. \$1.75 each.
- Clairette**. Large pure white flowers. Fine plants. \$2.00 each.
- Paeonia Species**
- Officinalis**. Single red, \$1.75. Potted plants \$2.00 each.
- Officinalis Rubra**. Double red, \$1.75 each; potted plants \$2.00 each.
- Tenifolia Flora Pleno Rubra**. Fern leaf, very early red flowers. This paeonia is very scarce. \$2.00 each.

5 plants at 10 rate; 25 plants at 100 rate.

**PAPAVER Nudicaula** (iceland poppy). All colors, fine for cutting.

**Orientalis** (oriental poppy). Large red flowers 50c.

**Orientalis Beauty of Livermore**. Very dark red. 50c each.

**Mrs. Perry**. Most popular pink. 50c each.

**Perry's White**. Best known white. 50c each.

**PENSTEMON Barbatus Pink Beauty**. Shell pink, flowers in summer.

## HARDY GARDEN PHLOX

Our Phlox have been tested for mildew resistance, and we offer the following as the best for near shore planting. There are others not as yet tested which we hope to list later.

**Albert Leo Schlageter**. Brilliant red, considered the best. 50c each.

**B. Comte**. Darkest red, very late flowering.

**Blue Hill**. Sturdy grower, light blue.

**Commander in Chief**. Very good scarlet red.

**Count Zeppelin**. Large white, red eye, fine combination.

**Daily Sketch**. Large salmon pink, fine phlox. 50c each, \$4.50 per 10.

**Daybreak**. Delicate pink. Early 2 ft.

**Enchantress**. The best pink phlox we have. 50c each; \$4.50 per 10.

**E. I. Farrington**. Clear pink with darker eye, fine phlox.

**Evelyn**. Delicate silvery pink. A dainty color.

**George Stipp**. Large salmon red. Very late, strong grower.

**Hauptman Koelh**. Very large blood red, strong grower.

**Jules Sandeau**. Large pure pink, medium height.

**Marie Louis**. Finest white, medium height, large flowers. 50c each.

**Mia Ruys**. The best dwarf white, large trusses. 50c each; \$4.50 per 10.

**Morgenrood**. Bright rose, deep eye.

**Mrs. Jenkins**. Tall white, large trusses.

**Mrs. Milly von Hoboken**. Large soft pink flowers.

**Salmon Glow**. Large flowering salmon pink, sturdy grower.

## PHLOX SPECIES

**Divaricata Laphammi**. Blue phlox, early, 6 inches tall.

**Indian Chief**. Lavender pink, 1 ft.

**Ovata** (mountain phlox). Early rosy red. 1 ft.

**Subulata** (moss pink). Masses of pink flowers.

**S. Alba**. White form of above.

**S. Camlaensis**. New, large rose colored flowers, 6 inches tall. 75c ea.

**S. C. F. Wilson**. Lilac blue flowers in masses.

**S. Vivid**. Compact dwarf plants with rose pink flowers.

**Suffruticosa Miss Lingard**. Most popular everblooming white phlox. 2 ft.

**PHYSALIS Francetti** (chinese lantern). Orange seedpods for winter decorations. Grows 2 feet tall.

**PHYSOSTEGIA Virginica** (false dragonhood). Pink flowers in Aug.

**Grandiflora Vivid**. Dwarf pink flowers, 1 ft.

**PLATYCODON Grandiflora** (balloon flower). Blue, 2 ft., showy.

**Grandiflora alba**. White, from June to October.

**Marriesi**. Violet blue, 1 ft., fine for rockgarden.

**Marriesi alba**. White same as above.

**POLEMONIUM Caeruleum** (Greek valerian). Sky blue flowers on tall stems.

**C. Reptans** (creeping polimonium). Early showy blue flowers.

**POTENTILLA Nepalensis** ("Mrs. Wilmott"). Salmon pink, July and August.

**PRIMULA Polyantha, Munstead Strain**. Free flowering, yellow and white.

**P. Kleini**. Extra large orange-yellow flowers in clusters. 55c.

**Vulgaris**. Red shades.

**PULMONARIA Angustifolia** (lungwort). Azure blue flowers in May. 12 inches.

5 plants at 10 rate; 25 plants at 100 rate



- PYRETHRUM Roseum** (painted daisy). One of the most liked cut-flowers in various shades of pink, in June.  
**Buckeye.** A double form, excellent for cutting. Color red. 75c.  
**Miami Queen.** Semi double pink. A fine cut flower. 75c.
- RANUNCULUS Acris fl. pl.** (buttercup). Dwarf double yellow, May and June.
- ROSEMARINUS Officinalis** (rosemary). Aromatic foliage, blue flowers.
- RUDBECKIA Laciniata** (golden glow). Large double yellow flowers in August.
- SALVIA Azure grandiflora** (azure sage). Blue flowers on slim stems.  
**A. Pitcheri.** Dark blue flowers in September.  
**Pratensis** (meadow sage). Blue spikes in June, 2 ft.
- SANGUINARIA Canadensis** (bloodroot). Starry white flowers in April May.
- SANTOLINA Incana** (lavender cotton). Silvery-white foliage, is evergreen.
- SAPONARIA Ocymoides** (soapwort). Bright pink trailing plant.
- SAXIFRAGA Cordifolia** (heartleaf saxifrage). Rose flowers in April.  
**Mcnebiana.** Ideal rockgarden plant with white flowers.
- SCABIOSA Caucasicca.** Beautiful blue cut flowers all summer.  
**C. Isaac House's Hybrids.** Improved type of above. 50c.
- SEDUM Sieboldi** (siebold stone crop). Beautiful silver foliage, pink flowers in August. Fine rockgarden plant.  
**Spectabilis Brilliant.** Bright pink flowers in large heads.
- SEMPERVIVUM in variety.** Potgrown clumps only.
- SIDELCEA Rosy Gem** (prairie mallow). Masses of rosy-pink flowers in mid-summer. Very showy.
- STACHYS Lanata** (wooly betony). Useful for edging, 1 ft.
- STATICE**—see *Armeria*.
- STOKESIA Cyanea** (stokes aster). Large blue cut flowers in summer.
- TEUCREUM Chamaedrys.** Fine little evergreen for edging. 6 inches tall. Pink flowers.
- THALICTRUM Glaucum** (meadow rue). Yellow flowers in June, 3 feet tall.
- THERMOPSIS Caroliniana** (carolina thermopsis). Yellow lupine-like flowers in July.
- THYMUS in variety.** Potted plants only.
- TRILLIUM Grandiflorum** (showy trillium). Excellent plant for shady places where they produce large white flowers in May. 20c each.
- TRITOMA Uvaria** (torch lily). Orange red spikes all summer. 50c each.
- TROLLIUS Asiaticus** (globe flower). Large orange flowers in May.  
**Europaeus.** Bright yellow flowers. Fine for cutting.  
**Ledebouri Golden Queen.** Largest of all buttercups, orange flowers in June and later. 50c
- TUNICA Saxifraga.** Dwarf tufted rockgarden plant with pink flowers.
- VALERIANA Officinalis** (garden heliotrope). Fragrant flowers, white flowers.
- VERBASCUM Harkness Hybrids** (mullein). Spikes of reddish flowers in June.
- VERONICA Incana** (wooly speedwell). Grey foliage, blue flowers in August.  
**Longifolia Subsessilis.** Clumps of the finest blue spikes in July and August. 50c each, \$4.50 per 10.
- VINCA Minor**—3 inch pots 35c.
- VIOLA Arkwright Ruby.** Fragrant terra cotta viola.  
**Chantreyland.** Unusual beautiful apricot color viola.  
**Cornuta.** Tufted pansies, blue and whites.
- VIOLA Cornuta**  
**C. Jersey Gem.** Most popular all summer flowering blue viola.  
**Fragrance.** New, all summer flowering. 50c each.  
**Pappilo.** Unusual all summer flowering, fine for rockgardens.  
**Oderata.** Single russian viola, fragrant blue flowers. 50c  
**O. fl. pl.** Double russian viola, excellent for cutting. 50c each
- YUCCA Filamentosa** (common yucca). Large spikes of creamy white flowers in July. Leaves are green year around. 50c each.  
 5 plants at 10 rate; 25 plants at 100 rate.

## BEDDING PLANTS

(Ready May 20th)

Boxes containing 12 plants .....	50c per box
Boxes of 100 plants .....	\$4.00 per box
2 inch pot grown plants 15c each,	\$12.00 per 100
3 inch pot grown plants 25c each,	\$22.00 per 100

- Ageratum Blue Cap.** Uniform growth, fine blue flowers for edges.  
**Alyssum Dwarf Gem.** Compact little plants for borders and edges.  
**Aster Branching.** Mildew resistant, choice cut flowers.  
**Balsum in colors.** Unusual plant with large flowers.  
**Bachelors Buttons.** Finest cutflower in coarse masses.  
**Calendula Orange and Yellow.** Cutflower, needs attention.  
**Candytuft Dwarf Gem.** Fine rockery plant, flowers all summer.  
**Calliopsis in variety.** For cutting.  
**Cosmos, Anemone Flowering.** Excellent cutflowers, coarse masses.  
**Chrysanthemum Morning Star.** Cut flower, fragrant.  
**Cynoglossum Blue.** Masses of blue color.  
**Dahlia Dwarf.** Cutflowers free from hay fever all summer.  
**Didiscus Blue Lace.** Flowers all summer.  
**Euphorbia.** Variegated foliage plant.  
**Gaillardia.** Most profuse flowering of all annuals for cutting and what colors. Plant some anywhere, in good soil.  
**Lantana.** Gorgeous colorings in this dwarf all summer flowering plant.  
**Lobelia Blue.** Used for edging, window boxes, flowers all summer.  
**White**—same as above.  
**Lupine.** In colors, Fine for cutting.  
**Morning Glory (Ipomoea).** Finest climbing plant with blue flowers.  
**Mary-gold, tall varieties.** Yellow and orange, cutflower.  
**Dwarf Varieties.** All popular colors. Cutflowers all summer.  
**Nicotiana.** Tobacco plant. Comes in white and reds. Colorful.  
**Petunia.** All sorts, for bedding, window boxes and specimen plants.  
**Singles, doubles, dwarfs and the taller growing types.**  
**Phlox Drummondii.** All colors, fine colorful selection.  
**Salpiglossus.** Unusual coloring. Hardest thing to transplant.  
**Salvia Blue.** This is a free flowering cut, showy too.  
**Red.** Both the early and late flowering. Showiest thing on earth.  
**Scabiosa.** All colors, one of the best for cut flowers.  
**Statice.** We dry this stuff for winter decoration.  
**Verbena.** In all colors, very showy bedding plants.  
**Mayflowering Verbena** is the finest pink, a beauty.  
**Zinnia.** Large flowering giants, all colors separate.  
**Lilyput.** Flowering in separate colors.

## LANDSCAPE MATERIALS

<b>Loam</b> —Field run .....	\$2.50 per yard
Screened .....	3.50 per yard
Screened and fertilized .....	5.50 per yard
<b>Cow Manure</b> —Old or new .....	5.00 per yard
<b>Pasture Stone</b> — Price on application.	
<b>Flagging</b> for walks and terrace. all colors .....	35c per square foot
<b>Peatmoss</b> —Large bales .....	\$4.50 per Bale
<b>Sheep Manure (Wizard Brand)</b> .....	\$4.50 per 100 lbs.
<b>Bonemeal (Corenco Brand)</b> .....	\$3.50 per 100 lbs.
<b>Hydrated Lime</b> .....	\$1.00 per 50 lbs.
<b>Sulphate of Ammonia</b> .....	\$2.50 per 100 lbs.
<b>Special Purpose Fertilisers</b>	
Caster Pomace	
Cotton Seed Meal	
Loma	
Milorganite	
N.A.C. 5-8-7 and 5-10-5	
Vigoro for Shrubs, Lawns and Gardens	

Also Some Other Chemical Fertilizers



**Bamboo Cane Stakes for tying flowers, etc.**

Dyed Green—2 feet long .....	\$2.00 per 100
3 feet long .....	3.00 per 100
4 feet long .....	4.00 per 100

**Chinese Tonking Canes (Natural Color)**

These are heavier and sturdier canes for dahlias, tomatoes, etc.

4 feet long, 3/8 inch thick .....	\$8.00 per 100
6 feet long, 5/8 inch thick .....	12.00 per 100
8 feet long, 5/8 inch thick .....	20.00 per 100

**Raffia (Yellow Brand), 1 hank \$1.00—5 hanks \$5.00.**



**GRASS SEED**

**VAN'S THICK TURF.** Our best mixture for a permanent lawn. This mixture can be used under average conditions on the whole plot, where one has sun and partial shade.

1 lb. 75c — 10 lbs. \$7.00 — 100 lbs. \$60.00

**VAN'S ALL PURPOSE.** This mixture is best suited for the lawn that does not have the best of care and is the playground for the youngsters.

1 lb. 65c — 10 lbs. \$6.00 — 100 lbs. \$55.00

**VAN'S SPECIAL SHADE.** This mixture is best suited for the difficult spots where it is hard to grow grass.

1 lb. 75c — 10 lbs. \$7.00 — 100 lbs. \$65.00

No Grass Seed will thrive where thick foliage prevents daylight from penetrating, and with rainy weather the dripping destroys the growth under such conditions. Where grass refuses to grow we have Ground Covering Plants that may do well. Inquire about this.

**Red Top, 98% pure, the best** 1 lb. 50c; 10 lbs. \$4.50; 100 lbs. \$40.00

**Kentucky Blue, 98% pure.....** 1 lb. 80c; 10 lbs. \$7.50; 100 lbs. \$70.00

**White Clover, 95% pure .....** 1 lb. \$2.00; 10 lbs. \$18.00

We Carry Other Seeds. Ask for Prices.

**SPRING FLOWERING BULBS (plant in fall)**

Top size: **Tulips, Daffodils, Hyacinths, Crocus, Chinodoxa, Fritillaria, Grape Hyacinths, Galanthus, Scilla** and many others.

Ask for Special Bulb List any time,

## GARDEN SHOP ITEMS

---

Bird Houses, Feeders, Seed, Etc.  
Garden Row Markers  
Ladies Garden Gloves  
Kneeling Pads for the Garden  
Hot Caps for early plantings  
Garden Tags and Lables  
Plants Supports  
Plant Protectors  
Garden Tools  
Garden Hose and Sprinklers  
Ant Kill  
Black Leaf 40  
Bordeaux Mixture  
Cutworm Killer (Go West)  
Cyano Gas (Powder)  
Lead Arsenate  
Lime — Sulphur  
Rotenone Dust O, 75%  
Sulphur, (dusting Powder)  
Tri-ogen small, medium, large sizes  
Wood Killers  
Ammonium Sulfamate (Amate) Poison Ivy Killer  
Calcium Chloride  
Weedone, an effective weed killer  
Rooting Powder Hormodin No. 2  
Erosion Netting  
Tree Paint  
Tree Tools  
Tree Lables—with wire or without  
Tree Protectors  
Altacide, an effective Spray to kill Poison Ivy,  
ask for details.



Many little items necessary to gardening will be found in our Modern Garden Shoppe. Visitors **welcome** any time.

Our Landscape Service includes submitting Plans and Estimating of all types of Landscape Work.

## PRUNING

## SPRAYING

## FEEDING

## OF TREES

We recommend removal of surplus growth dead wood, timely spraying and feeding to keep your trees healthy and vigorous.

Estimates on such work available.

A Tree Expert (Davey trained) available. We take contracts for removal of large trees, moving and resetting large trees, cavity work, etc.

Emergency calls taken care of.

More than 25 years of Practical Experience  
is yours for the asking.

We supply Small Trees for Reforestation Purposes.



*Van's*

**NURSERY AND LANDSCAPE SERVICE**

WASHINGTON STREET, Route 6

FAIRHAVEN, MASS.

Telephone New Bedford 2-0330

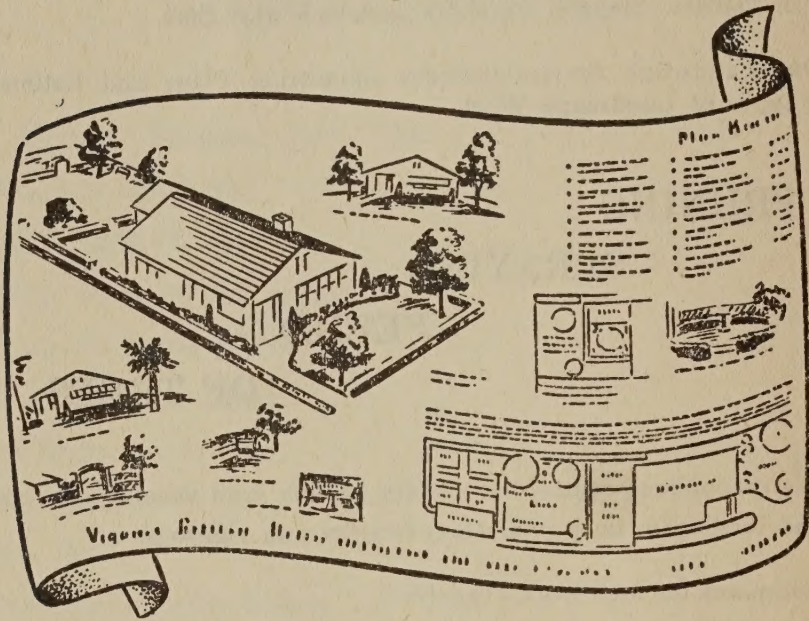

VIGORO

PRICES

1 lb. ....	\$.10
5 lbs. ....	.45
10 lbs. ....	.85
25 lbs. ....	1.35
50 lbs. ....	2.35
100 lbs. ....	4.25

BUELL

PEAT - POULTRY

2-1

50 lb. ....	\$2.00
-------------	--------

Ideal for Azaleas, Rhododendrons, Kalmia, etc.







