

Robert R. Fluct

RRF  
①

May 2 - May 10.

Arrived Honolulu and took one week's leave. Mother arrived for vacation. Loaded ship and reviewed trip plans w/ Fred.

Visited big island and saw Hawaiian Hawk. Saw a Golden Plover in Punchbowl pull out and eat two earthworms. Feeding behavior very similar to Robins.

Visited Mokuaiaunua w/ mother & family - saw paired Wedgetails in burrows, no eggs or chicks.

10 May 1965.

Final loading of ship in AM, moved to West dock at noon and loaded 3" ammo. Cleared FH at 1830. Finished packing & remaining supplies.

11 May 1965

Began bridge watch at 0730, continued until 1700. Saw several Heermann's S., a few Sooty S., numerous Bulwer's P. No Cook's or Bonin's. Most of usual species present. Toward rubber raft at 0930. Birds were appearing regularly and several small flocks.

Robert R. Flint

1965

SIC #8

RRJ

(2)

had been sighted. Moved away from ship in raft and laid oil trail w/ Wesson oil + squid. Flock of Wedgetails immediately flew over to + circled oil trail. We collected 15 WTS + 3 Sooty Tern. Missed a several shots at Newell's S. At least a dozen birds still in area when we secured. This indicating that birds were coming into area while we collected. Squid flock was about 20 birds.

12 May 65 Into raft at 0930; engine not mounted properly + drawn out frequently. Saw 10 birds but got none. Finished skinning + preparing alcoholics.

13 May 65 Broke out new raft, leak in old one. Engine mount raised - runs much better. Saw 8 birds: shot + wounded 1 RTTB, killed Cook's P. - took blood sample from same. Saw Cook's P, White-necked P. for first time today - No more Newell's seen. Oil trail effective only in large cone. of birds is present in area.

14 May 65 Over @ 0830. Saw only 3 birds. Flew kite @ bird painted on it. Attracted + shot WTTB. Blood sample. Bird actually displayed w/ kite. Ran into pod of

1965

SIC #8

small whales, probably Hump-back.  
About 50. Large feeding flock of  
36 ST, 20 WT in late afternoon.  
Collected imm. BFB w band from  
Jawis Is. Most of WTS seen  
now are dark phase. Bird  
sightings are increasing in frequency  
as we near 9° N lat. Present position  
10° N lat @ 1800 hrs.

Finished packing personal  
box, changing batteries for nav.  
lights.

15 May. Bridge water all day. Few birds seen.

16 May. Overcast most of day. Large  
numbers of birds present. Water too  
rough for raft. Increase in #s  
of birds around 10° N.

17 May. Large numbers of Sooty  
Shearwaters seen singly all day.  
Appear to be feeding, not  
migrating as when seen on  
previous trips. Collected 8.  
Saw 2 Pale footed S. - white  
bill & face very distinct.

18 May. Began organizing  
gear for landing on Howland.

1965

SIC #8

USS G. Eastman on radar at 0800. Rendez. at Baker @ Y5 39 at 1000 hrs. Picked up Standen, under way to Howland by 1200. Arrived off Howland at 1500. Landed in calm surf (2 boats) & set up camp by 1600. Began nest count - A counted & banded RTTB.

Rough coral beach w shallow reef area and sharp drop off at edge of reef. Giant clams shells of various sizes (up to 18" long) abundant on beach & live ones in reef.

Small 'fruit-fly' common. Saw many green striped skinks and a few Geckos.

Garden type orb-weaver spiders everywhere between grass clumps. Saw 2 species small moth <sup>that</sup> larvae. Small cockroach seen.

Saw 4 RT. @ N end. Appear to be in breeding plumage. 6 BTC near beach on coral rubble @ N end. 1 W.T. & 3 RT @ edge of surf in same area.

Hermit crabs all over under coral slabs & on beach in shade. Most about size of fist. Some seen inland.

1965

SIC #8

Many BFB w ~~chicks~~ nestlings, eggs.  
Some immatures seen.

Sooty Tern have mostly all flying young. Gray-backed Tern present & nesting in sm. numbers. Fred found 2 w eggs. No young seen.

Blood samples in evening from 76 Sooties, 26 Great Frigs, 31 Lesser Frigs.

Jicks very common in S.T. nesting area. S.T. colony located all around light house.

19 May 65 Up at 0700. Breakfast & out for Berlese samples. Took sample from S.T. area, RTTB nest, BFB nest. Found another RTTB nest bringing total to 14 nests, 1 w chick, plus 1 abandoned egg. 5 bird returns.

Banded 200 Sooty Tern nestlings in afternoon. Many small nestlings inland of light house. Saw several completely downy chicks.

Sixty S.T. blood samples in evening.

20 May 65 Berlese samples from RFB nest in cordia trees 4' off ground., G. Frigate nest in Cordia tree 2' off ground w. nestling. BFB nest scrape, on 1 egg.

1965

SIC#8

Veg. at edge of beach line mostly Lepturus repens (bunch-beach grass about 8 times size of C. whitensis.)

Inland grass, Digitaria sp?, Tribulus, some Boerhaavia, 2 species of Portulaca growing as small bushes.

Saw flock of 30 RT + 10 GP on E side of island.

Lesser Frigate ♂ has white patch under base of wings, ♀'s have sharp dividing line between white of breast & black of throat. 50+ eggs, no chicks - colony just beginning to nest. Nests built primarily on Lepturus & Portulaca, a few on ground. Nests built of Tribulus primarily & some Boerhaavia. Average 3" from ground. Very close to each other - average 24" apart.

Great Frigate's nest exclusively in Cordia trees in center of island. Saw 2 nests & 3 eggs in or just outside of nest - could be relaying? 70% nestlings, largest have scapulars & dorsal feathers well in -

RFB generally nest higher than G-Frigate, i.e. up to 6'. They nest separate from G. Frig. nests.

RTTB nest under coral slabs, where egg is usually in the shade.

1965

SIC #8

RRJ  
⑦

Collected 3 unbanded ad. RTTB. Skinned  
1 RTTB in afternoon.

Rested through next, shot at sharks.  
mostly (all) white-tipped.

Sooty Tern area:

est. 30000 ~~more~~ nestlings.

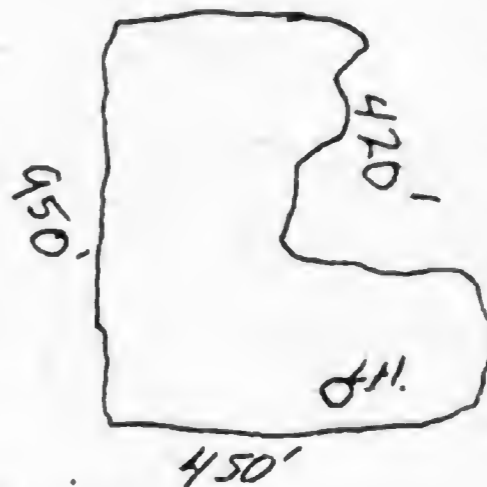

Banded 100N in  
afternoon. Night banding  
A banded 900 S.T. nestlings.

21 May 65 Got up & took Barlow before  
morning boat. One from S.T. colony  
w/ metal rectangle, RTTB nests ~~est~~  
egg. (2).

Nest description of GBT &  
Barlow sample from same. Small  
rock (coral) base, Zygae, at  
base of Portulaca bush. Nesting  
in area of bare coral substrate  
w/ some protection offered by  
leaves Lepturus or Portulaca. Nest  
diameter 6".

Nest description of Ben Foster.  
Only 4 nests present, 1 w/ chick, 1 large  
nestling, 3 eggs. Nests composed  
of Tribulus, Portulaca & Boerhaavia.  
Av. 18" in diameter. Two Barlow

1965

SIC #8

samples taken. Some Frig feathers found incorporated into 1 nest.

Bulwer sample from Great Frigate nest no nestling, RFB nests (2) no egg, samples mostly *Tribulus*.

After supper & heavy rain. Dennis & I walked to N end of island & found 2 Wedgetails, collected one. First record of this species on Howland. Dennis found 3 burrows yesterday. Larry collected a Phoenix Is. Petrel yesterday which was also a b & record.

RTTB just beginning to lay. Counted 16<sup>±</sup> eggs, 1 chick. Other birds on ground in pairs in morning & early afternoon.

Banded 500 S.T. nestlings in evening (total) & got about 50.

Began packing camp.

22 May 65 Up at 0600. Broke camp - packed gear. Off to ship at 0700. Bottle-nosed Dolphins (50) off island & followed ship for several miles.

Moved gear to gun deck, began cleaning, repacking, skinning.

Changed Bulwers.

At 1300 crossed equator & underwent transformation from Pallyway to Shellback!!



1965

SIGHTS

RRJ  
⑩

*Pisonia* the dominant veg. The NE section (windward) is a narrow rock dike (40' wide) between sea & lagoon.

Observed 3 species of butterfly, 1 black w/ white spots (4), 1 small brown, 1 large dark brown w/ white wing bars. A grasshopper, & a skink. Skinks are very common.

Village area palm, pandanus, papaya & Burr grass. Some *Boerhavia*, *Merschmida*, *Sidaevola*, *Pisonia* become dominant as palms end. *Portulaca*, *Tribulus* form understory. Coral rubble.

Saw several dragonflies.

Three separate areas where Gray-backed Terns flying over coral shelf ocean side. Eggs found in these areas at night. Saw 200+ birds during day.

Noddy (both sp.) nest remains common.

Counted 13 WT, 7 RT, 2 GP, 3 BTC, 48 Fairy Terns, 3 L. Frig., 1 Phoenix Is. Petrel, 4 Com Noddies, 50 Haw. Noddies.

Oceanside, on coral rubble, 5000 S. T., maybe 5000 more in funnels over lagoon.

1965

RRJ  
⑪

SIC #8

Took 21 S.T. blood samples  
in evening.

25 May 65 Berlese samples (3) from  
ground litter, around village. Under  
rock, board & pandanus mat.  
Down to Nend to let  
Stander off. Collected 3 F.T.,  
on road to camp, 5 Haw. Noddies  
over lagoon, 1 Com. Noddy, 2 G.P.,  
1 R.T.

Counted 22 Frig-sp. over  
lagoon.

Saw imm. S.T. flying w  
adults.

200+ Haw. Noddies over  
tree tops just N of S.T. colony area,  
roosting on tops of *Pisonia*.  
+100 roosting in old nesting  
area further S.

Took Berlese samples  
from 2 aband. Com. Noddy  
nests, & 1 from aband. Haw. N.  
nest.

Saw 4 BTC.

Took ectoparasites & skinned birds  
in afternoon. Looked for S.T. in  
evening - none on ground.

Shot 2 cats on way back

1965

SIC #8

RRJ  
12

to camp. Saw a total of 4 cats,  
3 dogs. Caught 1 rat!

26 May 65 Up @ 0600, broke camp,  
off island at 0700, under way  
to Phoenix Is. Began repacking  
& cleaning gear, stuffing birds.  
Island in sight at 1530.  
Crew into boats & landed at  
1630. Slippery rock landing  
ledge. Set up camp!

Brief look over island.  
Large nesting colony of Lesser  
Frigates near lagoon. Great  
Frigate colony between camp  
and L. Frig. colony, most  
on small nestlings, a few on  
\* eggs. One nest w 2 nestlings,  
one w down all over, one bare.

RTTB nesting (20+) under  
coral slabs.

X'mas Is. S. compete for  
rock slabs w RTTB, have seen  
20+, 1 nestling.

Gray-backed Terns scattered  
about island, some on eggs.  
most appear to be just roosting.  
Cm. Noddies on eggs on nests  
built of dead *Lepturus* on

1965

RRJ  
13

SIC #3

top of coral slabs and on coarse sand. 2 N seen.

Fairy Terns nesting on top of coral slabs, 1 egg seen.

Blue Gray Noddies common on ground. Found 2 eggs on ground at base of coral chunk. Most appear to be pre-breeding.

Wedge tailed - 1 seen, many burrows started, most u nestlings near fledging.

Large conc. of Sooty Terns on ground at S end of island. Just beginning to lay eggs.

Large conc. of S.T. on ground at N end of island, no eggs.

S.T. all over island in air.

Saw 2 Phoenix A. Petrels,  
2 BTC.

Rabbits Oryzopsis lagotis, auratus very common - saw 50+, probably several hundred on island. Are black, tan & white mixture, about size of cottontail. Run like hell but sometimes stop & look at me. Did not see any but saw several <sup>of them</sup> <sup>with</sup> <sup>eyes</sup> <sup>open</sup>, in hand when caught.

BB scarce, saw 1 ct.  
Saw hippocampids on nesting BB

1965

RRZ

14

SIC # 8

One RTTB club of about 150 birds.

Counted 17 GBT eggs (several hundred on island) on sm coral rubble on talus slope along W side of island. Approx 150 Fairy Terns eggs in this area. All along a side. Blood samples 32 S.T., 50 H.T., 10 H.T.

27 May 65 Nest count of Boobies, Frig., RTTB, banded a few RTTB.

Beside lagoon GBT nesting, most w eggs, saw 1 large N.

2000+ BG Noddies roosting in Seaview at edge of lagoon.

Audubon's S. roosting by lagoon, & by beach coral slabs, found 1 pair w egg.

Found pair of WTSP in burrow in WT S area, no egg. Must be 300+ WTSP on island. Counted 100+ coming in past camp in evening.

Am. Noddies roosting and nesting in large numbers at edge of lagoon.

3 Bulwer samples taken.

Banded 500 S.T. in evening.

28 May 65 Collected 6 Bulwer samples.

1965

RRJ

15

SIC #B

Took nest descriptions from 10  
nests of breeding species (as many  
of 17 breeding sp. as possible)

Banded 200 Fairy Terns,  
band recoveries from L. Frig.  
colony.

Specimens and ectoparasites  
from Xmas A.S., WTS., Cm. N.,  
F.T., BGN., RTTB., WTSP.

Banded 1200 S. Terns in  
evening.

29 May 65 Took dozen plus Bulwer  
samples.

Have observed 3 G. Frig. nests  
w 2 chicks, 1 w both well feathered  
in scapulars, other 2 with one  
beginning to be feathered, other bare  
One nest w one chick w down and  
one egg.

Completed nest descriptions.

Saw Audubon's S. on egg.

Banded 1000 Sooty Terns &  
got 24 returns in evening.

30 May 65 Up at 0700, packed  
gear, took Bulwer from Sooty Tern  
colony - into boats.

Under way 40 miles to  
Enderbury Is - Moved gear to

1965

RRJ  
16

SIGHTS

fantail. Landed at 1330 in easy surf. Moved gear to house.

Began next count around S end of island. Graybacked Terns breeding, most w large nestlings. Brown B, BFB, RTTB w eggs & young.

Observed 2 RTTB nestlings in same nest: one 20 days, one 40 days: sitting side by side, facing opposite directions.

Saw 7 BTC.

Observed 14 to 20 turtle egg pits & tracks out of & into water in sand on E side of island. No eggs found.

Took blood samples at Sibley in PM 40 Sooty Tern, 20 BFB. Worked BFB club for returns. Caught 2 birds we had painted on Phoenix.

Small colony of Sooty Terns near edge of lagoon, no eggs yet.

31 May 65 Finished next count of island. G. Frig. on large N, some sm. N., a few eggs. BFB on most on eggs, some small N. Lesser Frig on sm. young & eggs.

1965

RRJ

17

SIC #3

Observed Fairy Terns (12). One  
and 06 + 1 large nestling in  
grove of trees just N of guano  
heap. 1st breeding record for  
island.

Saw 2 Hawaiian Noddies on eggs  
in same area.

Collected specimens of RTTB,  
G. Frig., Brn Booby. Collected  
Barbee samples from nests (8+)

Banded & returned RTBs in  
evening from area of guano heap.  
Banded 56 birds.

01 June 65 Dep @ 0700, packed remainder  
of gear & moved it to beach.  
Onto ship & underway for  
Canton. 1450 into whaleboat  
towing rubber raft through  
channel @ Canton, past Spam  
Island: ~~Observe~~

Observed 19 Brn B., many  
Common N., some Cassin-backed  
Terns flying.

Spam Is. is about 20 acres of  
coral rubble dredged from lagoon.  
Low grasses!!! on top. Height of is.  
about 30-40'.

Over to Spam Is. after dark,  
collected 3 rats, may be R. exulans.



1965

RRJ

18

SIC#B

Span + two other islets have approx.  
1000 *Lin. N.* nesting pair. Most on eggs. Some  
10% on nestlings of various sizes, largest  
 $\frac{1}{2}$  grown.

About 100 pr. of *GBT* OE.

Collected 3 *GBT*, 2 *Lin. N.*

Found + collected 1 *Audubon's*  
*S.*, 1 partially *Albino Sooty Tern*.  
(Saw 2 *S.T.*)

Found 3 *F.T.* nests, 1 w egg,  
2 w nestlings on rock islet  
near Span.

6 *Burboes* collected. Ectoparasite  
from collected birds

02 Jun 65 Out to ship in A.M. +  
underway for Am. Samoa. Set  
'at sea' watch, skinned birds +  
rats collected on fanton, repacked  
boxes for Votok.

03-05 June 65 'Continued' 'at sea' watch,  
a few birds collected.

06 June 65 Arrived Pago-Pago, Tutuila,  
Samoa at 0900. Left ship at  
1100 for 4 days R + R. Chopped  
*Burboes* each morning. Took one  
trip in truck-bus around island w  
*McCulloughs* + *Seifert*. Climbed up

1965

RRJ  
19

SIC#8

to upper narrow for swim.  
Saw Samoan Starling, Swiftlet, WTB's,  
Noddies, F.T., & both Honeycreepers -  
Made my way through all  
5 bars on island. Observed  
local color, purchased souvenirs  
Under way morning of  
10th for Tongareva.

10 June 65 Set 'at sea' watch and  
began skinning birds collected by  
Huber in Tubulla, Samoa.  
Packed drums w/ shell shells,  
skinning eq., pins, etc. for  
our day in Tongareva.

13 June 65 Landed Tongareva thru  
lagoon @ 1000 following island  
manager's boat (after ship's clearance).  
Stopped at village & picked up  
native guide. Headed S in lagoon  
(Saw ~~2~~ 1 W.T. around ship)  
Over lagoon: How-Noddy 11;  
Frig. sp? 6; Fairy T. 2; WOT. 2.  
Saw 1 BTC.

Landed on island a S end  
of lagoon. Several sm. islands  
interspaced w/ shallow lagoon  
channels (1 foot). Several (3) of these

1965

R.R. 2  
20

## SICP

closely spaced islands have birds.  
Counted 8 L. Frig. nests w eggs  
in Pemphix 6' above ground. Bob  
Long saw 3 more L. Frig, on nests, (probably containing eggs).

Approx. 1000-15000 Haw Noddy  
nests, about 15% w eggs, remainder  
empty.

Saw 3 Cm. Noddy nests (empty)  
but Bob Long found a large Cm.  
Noddy nestling!!

Fairy Terns common, probably  
breeding but no eggs or nest  
found. Our guide told me that  
they do breed here & he described  
egg & lack of nest structure.

Collected Bursera samples  
from 2 L. Frig nests w eggs, 2  
Haw. Noddy nests w eggs, 2 Cm. Noddy  
nests ~~w eggs~~ without eggs.

## Population estimates:

H. Noddy:	3000
Cm. Noddy	100
L. Frig.	70 seen.
R.C.B.	10 "
S.T.	15 "
F.T.	100 "
G. Frig.	1 collected

Our party shot 3 specimens of

1965

RRJ  
21

### SIC#8

all above spine except (1 G. Frig imm.,  
2 H. Noddies, 4 An. Noddies.)

Guide told me that his grandfather  
told him that 2 Frig. used to nest  
on ground near present area.

Stopped twice on way back  
to village to let Bob Long  
make additional plant collections.

We stopped at Runway (WWII)  
& got plant spec., saw 6 G.F.,  
collected 1 Coconut crab!!

Price of copra (principal crop)  
at Tongareva 44 £/ton. So far  
this year island has exported  
100 tons - get a ship about  
every 3 months. Price rises  
in Rarotonga & in New Zealand  
is up to 90 £/ton.

Native trade is custom in  
shell necklaces, fans, wood-  
work (canoes), etc. Sometimes  
have pearls for trade usually  
sm. irregular pearls. These  
people want clothing even  
before money - a T-shirt  
will bring even pearls  
in trade.

1965

RRJ  
22

SIC #8

Other boat joined fish,  
shot additional specimens, caught  
quail + shrike. Back to  
ship at 2000. Under way for  
Vostok.

Skinned birds until 2400.

14 June 65 Skinned and put up  
birds all day. Packed gear  
for Vostok.

15 June 65 Sighted Vostok  
at 0800. Over to fantail. Landed  
at 0930. Set up camp, began  
poisoning fish on reef.

Vostok is sm. island, a  
triangle about 60 yds. per side.  
Only two species of plants;  
Pisonia + Boerhaavia. Pisonia  
forms complete canopy  
about 60' high. No understory  
present. Ground composed of  
humus (black) several feet deep  
& very soft. ~~There~~ Large  
open areas in the interior  
probably caused by salt  
water from waves settling  
in low spots & killing trees.  
Dates ring around Pisonia

1965

RRJ  
23

SIC #8

Large rock & coral rubble.  
 East side has 100yd wide  
 open flat area of *Banbania*, <sup>10 ft.</sup>  
 BFB's nesting here. <sup>150 ft.</sup> *Ben Boobies*  
 nesting here next to *Pisonia*  
 edge. <sup>250 ft.</sup> *Lesser Frigates*, <sup>500 ft.</sup> *Greater Frigates*,  
<sup>500 ft.</sup> *Red-footed Boobies*, <sup>500 ft.</sup> *Lin.* & <sup>2000 ft.</sup> *Hawaiian*  
<sup>500 ft.</sup> *Noddies* & *Fairy terns* nest  
 in *Pisonia* in good numbers  
 (no estimates) *Lesser Frigates*  
 restricted to 5M. area of  
*Pisonia* in center (E) of island.

Coconut crabs, hermit crabs  
 numerous. Mosquitoes present.

Collected several specimens  
 of species present including  
 G.P. & 1 BFC. *Cetoparasites*  
 taken from 1 specimen of each  
 species. Rough skinned birds. *Burles* samples.

Blood samples from BFB (32)

1 *Ben B.*:

Banded & returned BFB  
 in 7M. (299 banded, 6 returns.)

16 June 65 Out to sleep w/  
 extra gear. Ran blood samples,  
 changed *Burleses*, skinned birds,  
 packed gear for Caroline. Under  
 way to Caroline @ 1430.

1965

RRJ

ZH

SIC #8

17 June 65 Arrived off Caroline  
at 0700. Gen to fantail - raining.  
Into boats & thru lagoon boat  
channel 8' wide, heavy surf.  
Landed at 5 Island & set up camp  
in overgrown coconut grove.  
Mangroves very thick.

Dennis and Tony set out  
in rubber boat towards N end  
of lagoon. Stauden walked  
chain of islands on W side of  
lagoon. Huber, Sibley and I  
checked S.T. colony on SE side of  
lagoon and poisoned fish.  
Poisoned on lagoon side & ocean  
side of reef. Sharks & Frigate  
ate many fish. Sharks very  
bold here. 3 reef herons  
collected (dark = 2, white = 1).

Birds nesting mostly on  
E side of lagoon. Sooty Terns  
on eggs & downy nestlings.

Primary veg. Mesochorea -  
Cm. Noddy eggs & nestlings,  
Haw. Noddy eggs, Fairy Terns  
eggs & large nestlings, RFB eggs  
and large & sm. nestlings,  
C. Frig. on eggs. Brn Br.,  
BFB, & L. Frig. breeding reported

1965

SIC#8

RRJ  
25

by Stadel. He estimates 50,000  
C. Frig. and at least 4/5 T.  
colony averaging 10 acres each w/  
1 egg or N per sq. yard. All 3  
common shorebird seen. Reef  
Herons about 20.

Coconut crabs abundant and  
large - good to eat! Another  
sp. of mosquito found at night.

Banded 5000 S.T. in  
p.m. and took 23 S.T. blood  
samples. Banded 1100 S.T. and  
took 3 Berlese samples.

18 JUNE 65 Stadel and I took  
rubber boat down lagoon  
about 1000. Picked up Sibley  
who was collecting Shorebirds  
(16P, 3RT.) On way back to  
camp we collected 1 dark phase  
Reef Heron and a Blue-Gray  
Waddler.

Stadel and I set out  
again in rubber boat in P.M.  
Collected series of 5 ad. RFB,  
1 Fairy Tern, 2 C. Frigate.  
Took 2 Berlese samples.  
Rough skinned all large birds  
(took blood) back at camp.  
Set out for Sooty Tern



1965

RRJ  
26

SIC#8

colony in evening. Motor worked  
out & we had to paddle over.  
Banded 6000 S.T. & banded  
1150 & caught a large Gulls.  
Afterwards we finished blood  
sampling Sooty Terns.  
Paddled back to camp & into  
bed at 0300.

19 June 65 Up at 0530,  
finished packing gear &  
moving it to beach. Boat  
from ship arrived & new  
motor at 0600. Loaded  
boat & to ship. Under  
way to Starbuck by 0700.  
Repacked gear for  
Starbuck and back to  
sleep on fantail at 1000.  
Slept all day.

20 June 65 Changed Belugas  
and skinned birds all day.  
Finished skinning all large  
rough-skinned birds. Packed  
personal boxes. Sighted  
Starbuck at 1430. Looks  
like very rough landing.  
Have to off shore while  
Fred & Bosun took

1965

RR3  
27

SIC#3

a look at survey conditions from rubber boat. They reported possible. Capt. didn't like the idea but ok'd landing.

Landing made relatively easy. Set up camp near strand. Quano works at NW end of island. Set out at 1800 for Sooty Tern colony 3 miles. Took 60 S.T. samples and banded 3000 birds.

Back to camp @ 15 S.T. specimens. Weighed & tagged, went to bed. Up and away for lagoon area. Walked 5+ miles, shot & bled 3 cats. Took 13 S.T. blood samples.

Yubur & I walked back @ 1300. Collected one G. Frig, one L. Frig & 1 BFB. Saw 1 Wandering Tattler. About 10 of each sp. of Frigate. One L. Frig on egg.

Crotch rubbed raw from walking - extremely tender.

We set out at 1900 for S.T. colony but I had to turn back. Cleaned up camp & went to bed.

1965

RRF  
28

SICFB

22 JUNE 65 Went to ship in 0830  
boat. Ran remainder of blood  
(25 S.T., 15 cat), skinned Trig.  
and J.S.T. Dennis on board for  
2nd day treating chapped crotch.  
Mine is improving rapidly!

Back to island on 1530 boat.  
Finished up last of fish  
poisoning. Set out for S.T.  
colony at 1630. Began  
banding before complete darkness.  
The four of us banded 5000  
birds. I banded 1300. Back  
to camp + caught 2 Gulls.  
Went to bed.

23 June 65 Up at 0530, broke  
camp. Off island at 0630.  
Repacked gear for Marden +  
sacked out until island in  
sight at 1600. Ashore on  
Marden at SW end of island  
& set up camp in abandoned  
military camp. Sand beach  
but little coral heads +  
high surf.

Set up cots, ate, set out  
up beach + sampled 36 RFBs  
from Pisonia trees. Came  
back to camp + set out

1965

RRF  
29

SICAB

towards lagoon sampling 64  
BFBs. BFB mostly nesting  
but wide apart. RFB on  
eggs & sm. nestlings.

Saw L. Tern on egg. Back  
to camp & to bed.

24 June 65 Up at 0700 & board  
to ship. Bicycled to Pisonia trees  
& took 3 Berles samples.  
Poissonid fish @ boat  
landing.

Crew getting ready for  
beer party in local bar. We  
helped.

Saw 4 BTC - flying pair.  
Drank a few beers @ shore  
party. Set out @ 1500 w. Nuber  
counting (left side) of lagoon (nest  
count of BFB). Walked 5-7 miles  
up island. After dark banded &  
returned <sup>200+50</sup> RFB in Pisonia trees in  
that area. Counted Sooty Tern colony  
(5000)? Collected Cuckos & banded  
BFB (60) on way back to camp. Arrived  
at camp @ 0300 25 June. <sup>15 W. Tattlers</sup> Saw BG Noddy

25 June 65 Slept until mid-morning,  
~~and left camp~~ & right  
back to bed. Cleaned up around

1965

RRJ  
30

SIC#3

Camp in early afternoon. Set out at 1700 & walked up to buildings at far end of island. Worked RFB in <sup>(90)</sup> Pisonia trees again. Came back banding BFB (200). Collected several Sooty Terns. Worked RFB in Pisonia trees near camp. Collected Hawaiian Noddy - went to bed. ~~the~~

26 June 65 Moved gear to beach & away in boats at first light. Onto ship and underway for Christmas Is. by 0700. Repacked gear for Christmas, catalogued fish, went to bed.

27 June 65 Skinned birds all morning, moved gear to fantail. Christmas Is. in sight at 1330.

Ashore by 1700. Moved gear into Officer's Mess - Royal Air Force. Off in land rovers to Sooty Tern colony. Banded 6000 S.T. but got rained out twice. Took 5 S.T. blood samples. I banded 1100 S.Terns. Collected 3 S.T. wing samples for Bullock

28 June 65 Arose about noon. Stadel, Kieber and I left

1965

SIC#8

RR7

31

for Cook Island in rubber raft.  
We banded 1800 Hawaiian Noddy  
nestlings (X banded 630).

Population Survey - Cook Island:

Hawaiian Noddy eggs 1000  
nestlings 5000

Fairy Tern eggs + nestlings: 500 pairs.

Sooty Tern whole island covered 100000??

Blue Gray Noddy, Wandering Tattler,  
BTC, Phoenix A. Petrel, Christmas Is. Shearwater  
seen, no estimate. Also common Noddys,  
RTTB (less than 100 each). One Brn Booby seen.

G. Frig, RFB, 15 each seen.

We banded 4000 Sooty Terns in  
evening. X banded 1100 S. Terns and  
collected six Bursar samples.

Took rubber boat back to  
camp at 0200. Sibley & Standen  
banded 1000 S. Terns & collected 60+  
blood samples.

We saw many Crested Tern  
immatures, no adults.

29 June 65 Up about mid-morning,  
went to Dudley Cook's house (island  
[district] manager) for lunch. Much  
Quin-Tonic. Left for Sooty Tern  
colony about 1700. Collected

1965

RRJ

32

SIC#3

about 30 Sooty blood samples  
on the way. Collected 4 Berles  
samples. We banded 7000  
Sooty Terns. I banded 1300!  
This is the first night we weren't  
rained out.

30 JUNE 65 Up in late morning.  
Sibley and Standen went out in  
Land Rover and collected  
remainder of blood samples for  
the trip - RTTB, RFB, + G. Frig.  
Huber & I went to ship at 1500 hrs  
and ran blood, weighed  
specimens, changed Berles,  
had dinner and back to shore.  
Out in evening and banded  
5500 Sooty Terns. I banded  
1200. We collected 50 Sooty  
Tern heads for nasal mite  
studies.  
Got to beds by 0100.

01 JULY 65 Up at 0830. Stadel  
loaded min. gear & went to  
ship. Sibley, Standen and I  
took Land Rover to interior  
lagoon and surveyed several  
small islands. Collected down

1965

RRJ

33

SIC#8

Booby, White-throated Storm Petrel,  
and eight Bulese samples.

Population Survey - Blue-Gray Island

Common Noddy eggs 5  
nestlings 7  
Wedgetailed S. eggs 4  
nestling 1  
Blue Gray Noddy eggs 2  
N 1  
adults 100

Population Survey - Little Blue Island

Common Noddy eggs 6  
Blue Gray Noddy eggs 3 adults 45  
nestlings 2  
White-throated Storm Petrel eggs 2

Surveyed East Island, East Island  
and East Island II, banded a few  
WTS and RTTB. Boobies (Brown Red-footed)  
nesting, Phoenix Is. Petrel, RTTB+WTS.  
C. Frig. 125 nests approx.

Surveyed coastal lagoon  
area banding BB. Long saw  
4/BB + BB.

Back to camp at 1530,



1965

RRJ

34

SIC #8

showed passports to Dudley Cook,  
paid bill, loaded gear, to ship.  
Up anchor and under way at 1700.  
Repacked gear, etc.

02 JULY 65 Fanning Island in sight  
at 0530. Idan ashore at 0730.  
Stadel and I remained on  
board to skin, stuff and sort  
gear.

03 JULY 65 Huber, Stadel, ~~and I~~  
went ashore early. Stander &  
Kong remained aboard all  
night. We met Mr. Palmer,  
had a drink & went off  
to picnic spots. We picnicked  
on ocean sill on the far  
side of the channel. Many  
new species found, many  
goatsuckers, small stuff  
mostly lost in coral.

Huber back to ship at 1200.  
Stander collected Cuckos, Stadel  
& I crossed lagoon in  
rubber boat for bird specimens.  
We got 1 Com. Noddy. Saw several  
Hawaiian Noddies & one Blue Gray  
Noddy but couldn't collect.

1965

SIC #8

RRJ  
35

Back to Palmer's residence  
at 1520. A couple more  
drinks & then left. The  
houseboy had a son named  
Fleet & insisted on  
presenting me a pandanus  
mat & grass skirt, etc.  
Very nice.

04 July 65 Under way for  
point X. Skinned, stuffed &  
packed gear all day.

05 July 65 Arrived at point X  
at 0630, into rubber boat  
& began collecting, threw  
garbage, squid, & laid out  
trail. Birds common,  
shot 1 WTS, 1 WTTB, 3 BFB,  
6 JF Petrel, 1 Cook's P., & 1  
Remuda Petrel.

Back to ship at 1100  
& began skinning & stuffing.  
Under way for Pearl Harbor

06 July 65 Finished all  
specimens and most of  
packing today.

07 July 65 Last of packing finished.

1965

SIC#B

RRJ

36

Lab cleaned & washed  
down. Loose or lost gear  
located.

08 Jul 65 Pearl Harbor in  
sight at 0800. Arrival  
time estimated 0930!!!  
Trip OVER —

FLEET, R.  
1965

CATALOG

- 20 MAY HOWLAND ISLAND, PACIFIC OCEAN
- 21 ♂ PHAETHON RUBRICAUDA, TESTES:  $13 \times 6$ ,  $19 \times 7$  mm;  $793.5$  gm.  
USNM# 5474.
- 21 MAY
- 22 ♀ PHAETHON RUBRICAUDA <sup>L. OVUM 4 mm</sup> OVARY  $10 \times 8$  mm:  $670.$  gm.  
USNM# 5479.
- 25 MAY HULL ISLAND, PACIFIC OCEAN.
- 23 ♂ GYGIS ALBA TESTES  $4 \times 3$  mm,  $2 \times 2$  mm.  $82.$  gm.  
USNM# 5507.
- 24 ♂ GYGIS ALBA TESTES  $4 \times 2$  mm.  $77.1$  gm.  
USNM# 5508.
- 27 MAY PHOENIX ISLAND, PACIFIC OCEAN
- 25 ♂ FREGATA MINOR TESTES  $12 \times 8$  mm  $817.$  gm  
USNM# 5523.
- 28 MAY ~~28~~
- 26 STERNA LUNATA  $127.$  gm. ALCOHOLIC  
USNM# 5549
- 27 STERNA LUNATA  $110.$  gm. ALCOHOLIC  
USNM# 5545
- 28 STERNA LUNATA  $124.5$  gm. ALCOHOLIC.  
USNM# 5546
- 29 STERNA LUNATA  $124.$  gm. ALCOHOLIC.  
USNM# 5547.
- 30 STERNA LUNATA  $137.$  gm. ALCOHOLIC  
USNM# 5548.
- 26 MAY
- 31 ♂ STERNA FUSCATA TESTES <sup>R+L</sup>  $2 \times 2$  mm  $143.$  gm.  
USNM# 5521
- 32 ♀ STERNA FUSCATA <sup>L. OVUM  $2 \times 2$  mm</sup> OVARY  $10 \times 5$  mm  $144.5$  gm.  
USNM# 5519

FLEET, R.  
1965

CATALOG

31 MAY ENDERBURY ISLAND, PACIFIC OCEAN

33 ♂ FREGATA MINOR TESTES  $19 \times 15 \text{ mm}$ ,  $18 \times 13 \text{ mm}$  804 gm.  
USNM # 5580.

27 MAY PHOENIX ISLAND, PACIFIC OCEAN

34 ♀ PTERODROMA ALBA  $2 \text{ OVUM } 4 \times 4 \text{ mm}$   
OVARY  $11 \times 8 \text{ mm}$  257 gm.  
USNM # 5529.

28 MAY

35 ♂ GYGIS ALBA TESTES  $6 \times 4 \text{ mm}$ ,  $3 \times 2 \text{ mm}$  106 gm.  
USNM # 5533.

05 JUNE

36 ♀ PHAETHON LEPTURUS  $2 \text{ OVUM } 4 \times 4 \text{ mm}$   
OVARY  $10 \times 10 \text{ mm}$  249 gm.  
USNM # 5600.

08 JUNE TUTUILA, AMERICAN SAMOA

37 ♂ GYGIS ALBA TESTES  $6 \times 4 \text{ mm}$ ,  $4 \times 2 \text{ mm}$  107 gm.  
USNM # 5610

38 ♀ PHAETHON LEPTURUS  $1 \text{ OVUM } 5 \times 5 \text{ mm}$   
OVARY  $10 \times 9 \text{ mm}$  277 gm.  
USNM # 5612

39 ♂ APLONIS ATRIFUSCUS TESTES  $11 \times 5 \text{ mm}$ ,  $7 \times 5 \text{ mm}$  144 gm.  
USNM # 5606

13 JUNE TONGAREVA ATOLL, PACIFIC OCEAN

40 ♀ FREGATA AERIAL OVARY  $15 \times 5 \text{ mm}$  OVUM  $2 \times 2 \text{ mm}$   
USNM # 5622

41 ♂ ANOUS STOLIDUS TESTES  $4 \times 1 \text{ mm}$ ,  $3 \times 1 \text{ mm}$  152 gm.  
USNM # 5633

42 ♂ ANOUS STOLIDUS TESTES  $6 \times 2 \text{ mm}$ ,  $5 \times 2 \text{ mm}$  176 gm.  
USNM # 5624

43 ♂ ANOUS STOLIDUS TESTES  $9 \times 4 \text{ mm}$ ,  $8 \times 5 \text{ mm}$  183 gm.  
USNM # 5630

44 ♂ ANOUS MINOTUS TESTES  $2 \times 2 \text{ mm}$  93 gm.  
USNM # 5629

FLEET, R.  
1965

CATALOG

- 13 JUNE TONGAREVA ATOLL, PACIFIC OCEAN  
45 ♀ STERNA FUSCATA L. OVUM 2x2mm  
OVARY 13x8mm 196.gms.  
USNM# 5670
- 15 JUNE VOSTOK ISLAND, PACIFIC OCEAN  
46 ♀ SULA DALTYLATRA L. OVUM 13x5mm  
OVARY 20x8mm 1660.gms.  
USNM# 5646
- 47 ♂ FREGATA AERIAL TESTES L. 9x11mm, R. 11x4mm 614.gms.  
USNM# 5649
- 48 ♀ SULA SULA L. OVUM 3x3mm  
OVARY 16x8mm 873.gms.  
USNM# 5653
- 49 ♂ GYGIS ALBA TESTES L. 5x3mm, R. 4x2mm 108gms.  
USNM# 5666
- 50 ♂ GYGIS ALBA TESTES R. 5x3mm 118gms.  
USNM# 5664
- 51 ♂ ANOUS MINUTUS TESTES L. 10x8mm 106gms.  
USNM# 5663
- 18 JUNE CAROLINE ATOLL, PACIFIC OCEAN  
52 ♀ FREGATA MINOR L. OVUM 4x4mm  
OVARY 18x10mm 921gms.  
USNM# 5685
- 53 ♂ SULA SULA TESTES L. 10x4mm, R. 9x3mm 726gms.  
USNM# 5688
- 15 JUNE VOSTOK ISLAND, PACIFIC OCEAN  
54 ♀ STERNA FUSCATA L. OVUM 4x4mm  
OVARY 12x7mm 203.gms.  
USNM# 5656
- 55 ♂ STERNA FUSCATA TESTES L. 5x3mm, R. 4x2mm 183gms.  
USNM# 5658
- 21 JUNE STARBUCK ISLAND, PACIFIC OCEAN  
56 ♂ FREGATA AERIAL TESTES L. 26x18mm, R. 24x16mm 703gms.  
USNM# 5707

FLEET, R.  
1965

CATALOG

- 17 JUNE CAROLINE ATOLL, PACIFIC OCEAN
- 57 ♀ STERNA FUSCATA L. OVUM 2x2 mm  
OVARY 11x5 mm 138 gms.  
USNM# 5674
- 58 ♂ STERNA FUSCATA TESTES L R  
3x2 mm 7x5 mm 163 gms.  
USNM# 5676
- 18 JUNE
- 59 ♂ HETEROSCELOUS INCANUM TESTES 3x2 mm 101 gms.  
USNM# 5680
- 19 JUNE
- 60 ♂ EGRETTA SACRA TESTES L R  
6x4 mm 6x7 mm 540 gms.  
USNM# 5672
- 20 JUNE STARBUCK ISLAND, PACIFIC OCEAN
- 61 ♀ STERNA FUSCATA L. OVUM 2x2 mm  
OVARY 10x4 mm 139 gms.  
USNM# 5698
- 62 ♀ STERNA FUSCATA L. OVUM 1x1 mm  
OVARY 10x7 mm 152 gms.  
USNM# 5696
- 63 ♀ STERNA FUSCATA L. OVUM 2x2 mm  
OVARY 15x8 mm 149 gms.
- 23 JUNE MALDEN ISLAND, PACIFIC OCEAN
- 64 ♀ SULA SULA GRANULAR  
OVARY 12x4 mm 763 gms.  
USNM# 5711
- 65 ♀ SULA SULA L. OVUM 2x2 mm  
OVARY 15x9 mm 849 gms.  
USNM# 5708
- 66 ♀ SULA SULA L. OVUM 1x1 mm  
OVARY 15x5 mm 829 gms.  
USNM# 5709
- 67 Imm. SULA SULA GRANULAR  
OVARY 14x3 mm 966 gms.  
USNM# 5710
- 01 JULY CHRISTMAS ISLAND, PACIFIC OCEAN
- 68 ♀ NESOFREGATA ALBISULARIS. L. OVUM 3x3 mm  
OVARY 12x8 mm 58.2 gms.  
USNM# 5733

FLEET, R.  
1965

CATALOG

01 JULY CHRISTMAS ISLAND, PACIFIC OCEAN

69 ♀ ANOUS STOLIDUS GRANULAR  
OVARY 9x5mm 126.9ms.  
USNM# 5734

02 JULY FANNING ISLAND, PACIFIC OCEAN

70 ♂ FREGATA MINOR TESTES 16x12mm<sup>L</sup>, 18x10mm<sup>R</sup> 996gms.  
USNM# 5739

71 ♂ GYGIS ALBA TESTES 5x4mm<sup>L</sup>, 3x3mm<sup>R</sup> 98.9ms.  
USNM# 5740

72 ♀ SULA LEUCOGASTER L. OVUM 3x3mm  
OVARY 24x15mm 1,203.9ms.  
USNM# 5737

73 ♀ ANOUS STOLIDUS L. OVUM 1/2x1/2mm  
OVARY 11x7mm 161.9ms.  
USNM# 5735

74 ♂ GYGIS ALBA TESTES 5x4mm<sup>L</sup>, 3x3mm<sup>R</sup> 114gms.  
USNM# 5741

03 JULY

75 ♀ ANOUS STOLIDUS GRANULAR  
OVARY 5x3mm 164gms.  
USNM 5742

05 JULY 09° N, 155° W, PACIFIC OCEAN

76 ♂ PTERODROMA EXTERNA EXTERNA (BOTH) L&R  
TESTES 1x2mm 437gms.  
USNM 5750

77 ♂ PTERODROMA EXTERNA EXTERNA L&R  
TESTES 2x1/2mm 461gms.  
USNM 5749

78 ♀ PTERODROMA EXTERNA EXTERNA L. OVUM 1x1mm  
OVARY 8x5mm 440gms.  
USNM 5748

79 ♂ PHAETHON LEPTURUS L&R  
TESTES 2x1mm 311gms.  
USNM# 5746



Fleet  
1965

SPECIES ACCOUNT

BLUE-FRIGGED BOOBY

Howland Island

16 Sept Nest count 1 egg, 1 chick = 1  
 1 egg = 1  
 SM. NESTLING = 9  
 LG. NESTLING = 53  
 IMMATURE = 38  
 2 EGGS = 2

16 Sept. Club of about 120 birds on East side of island, about opposite lighthouse.

18 Sept. Clubs (5) totaling 300 birds on NE beach.

McKean Island

21 Sept. Nest count 1e = 23  
 2e = 68  
 S.N. 17  
 L.N. 16

Two clubs around lagoon totaling about 300 individuals.

Hull Island

28 Sept. Saw two flying W over lagoon at 800.

Phoenix Island

30 Sept. Nest count 1e = 44  
 2e = 65 about 100 in club  
 1e, 1N = 17 by lagoon, far side  
 Sm N = 41 from camp  
 L.N. = 11

Enderbury Island

03 Oct. Nest count 1e = 6  
 2e = 4  
 Sm N = 1/2

Fleet  
1965

SPECIES ACCOUNT

BLUE-FRIGGED BOOBY 2

Nest count continued: LN = 15  
 imm. = 4

Island count from lighthouse at dusk = 556 birds. Two clubs formed; one of about 50 birds behind house at N edge of lagoon, another of about 150 birds about middle of the island, on the W side of lagoon, on museum flats.

Howland Island

19 Oct. Since our landing @ 1800 hrs 15 Oct.

I have recorded a small BFB club 300 yds N of Staro Town (on beach edge) and a large club (100 birds) on West beach 100 yds N of South end of island. These are in addition to usual clubs on E beach.

20 Oct Nest count 2e = 2  
 LN = 36

Final estimate of 1000 birds on island.

Baker Island

16-19 Sept. 35 birds, class B. Two nest on 17th w 1 nestling, one w 2 eggs.

16-20 Oct. 25 birds, class B. One nest w nestling.

Christmas Island

28 Oct. Jan sitting on buoy at entrance to lagoon.  
 29 Oct. SW POINT: 15 adults, 6 immatures; 6 nests w L. Nestlings, 1 nest w 1 egg.

Fleet  
1965

SPECIES ACCOUNT

BROWN BOOBY

Howland Island

16 Sept. NEST COUNT 1 egg = 2  
Imm. = 2  
Ad. = 17  
L.N. = 1

18 Sept. (AM) Have handled or seen 25 Brn Boobies to date.

McKean Island

21 Sept. None nesting. 3 ad. and 1 imm. seen.

Hull Island

25 Sept. Counted 13 flying over lagoon at 0630 hrs.

Phoenix Island

30 Sept. Nest count 2e = 1  
L.N. = 2

Endenburg Island

03 Oct. Nest count 1e = 3  
2e = 2  
SN = 1

Flock (roosting) of about 100 ± 5 birds followed us around perimeter of island on nest count.

Howland Island

20 Oct. Nest count: 1e = 3  
2e = 1  
1e, 1SN = 1

Eight empty new nests being built. All nests except one w 1e, 1N are on SW beach crest. One w 1e, 1N in on crest of SE beach at edge of vegetation.

SPECIES ACCOUNT

BROWN BOOBY 2

Dakin Island

16-19 Sept. 12 birds seen, no nests. (Class B)

16-20 Oct. 10 birds seen, no nests (Class B)

Christmas Island

28 Oct. Four sitting on buoy at entrance to lagoon.

29 Oct. Four flying along beach crest at Bay of Whales.

30 Oct. LOST ISLAND: 1 nest w 2 eggs  
FAR ISLAND: 1 large Nestling

Fleet  
1965

R.D. Brown  
1965

Journal

23 Nov. cont.

Howland Island <sup>sooty tern</sup> were  
heard over the island throughout the  
all night survey. None were ever  
seen landing.

No other species were noted.

24 November

Howland Island

Berlese samples were taken  
today. 13 samples total were taken,  
9 of Brown Booby, 4 of Red-footed Booby.  
Shorebirds were in low numbers  
again today (only a few Golden Plovers).  
Collected 106 blood samples with  
accompanying streamer ing, banding  
and return noting when necessary  
on boobies. Broke camp at 0545  
and left ca. 0630<sup>(25 NOV)</sup>. No trouble with  
surf on board ship ca. 0700<sup>25 NOV</sup>

25 Nov.

Run from Howland to Baker  
practically devoid of birds as it  
was n of Howland. During 3 hrs  
of observation only 13 birds seen.  
Only 2 sooty terns.

26 Nov.

Baker Island

Baker was green as was Howland.  
Vegetation all in good shape, flowering.  
Evidently rain has been quite abun-  
dant. The island proper was  
practically devoid of birds except  
for a few shorebirds - mainly  
Golden Plover. Along the rocky

R. S. Crossin  
1965

Journal

GILLO

Baker Island Cont.

25 Nov. cont.

south and east shores, shorebirds were very abundant - mostly Luddy turnstones, few Golden Plovers, numerous wandering tattlers, few Prolia, one Bristle-thighed curlew. All Luddy turnstones that could be glassed were checked for bands - none seen. Two specimens (unbanded) were collected. No red-rumped Aleutian birds were seen, although it is doubtful if the paint would still show.

One pair of Blue-faced Boobies had a full grown fledgling on the west side of the island near the lighthouse. Approximately 300 Common Noddies were seen on the ~~low~~ coral bar in the center of the small lagoon on the east end of the island. These were just starting to settle down to nesting with 49 eggs present, mostly fresh from the clean appearance. One Brown Booby, ca 10 Sooty Terns, ca. 10 Hawaiian Noddies were seen over the island. mice were abundant, no cats seen. Landed at 11:30 - high surf, but caught it right and surfed in at the head of one swell at a very rapid speed (ca. 20 mph.) Kept then went back to ship. - Had no trouble getting out. We finished the survey

R. S. Crossin  
1965

Journal

52C10

Baker Island cont

25 Nov. cont.

at about 1530 and put out a flare for the ship - called the raft back in over Walker's tiddie and put out by 1600. The raft nearly was flipped when Wood + Baker came into the island as a large (ca 10 ft) swell caught them and filled the boat before towing them out. Our first attempt out failed and we brought the raft back to shore and walked it down further south to near where the large vehicle is on the beach. We finally tried it out through the surf without a motor and made it with no difficulty. Surf was up to 10 ft. with little break except for undeterminable calms such as the one we went out on.

SR SS  
0-405; 175-00W - 1-365; 175-56W

Southern Rind - S Baker Is.

26 Nov.

Very few birds (total 62) - rain most of the day. An oil slick was put out and worked from 0946 → 1220 with very little results. Only a few storm petrels came to it - one Leach's collected. Apparently there are migrating as they show little interest on the slicks.

Juan Fernandez Petrels still showing are Black-winged and (Baker Is.)

SPECIES ACCOUNT

Fleet  
1965

RED-TAILED TROPICBIRD

Hawland Island

16 Sept. NEST COUNT LG. NESTLING = 1

17 Sept. Saw 1 ad - fly out to sea from rocky area on NW beach.

McKean Island

21 Sept. NEST COUNT E = 8

N = 16

Hall Island

27 Sept. One seen hovering (flying) over chain of islands on NE side of lagoon.

Phoenix Island

30 Sept. Nest count E = 2

SN = 2

L.N = 12

Enderbury Island

03 Oct. Nest count E = 10

SN = 5

L.N = 68

During nest count on 02 Oct. in grove of trees at N end of island I saw 2 RTTB in same nest. They were about the same age (45 days) showed no hostility towards one another, and there was no evidence of another nest nearby.

Hawland Island

19 Oct. Saw one adult circle our camp several times about 1430 hrs.

Christmas Island

28 Oct. COOK ISLAND: 3 ad. OE, 1 large nestling.

SPECIES ACCOUNT

Fleet  
1965

RED-TAILED TROPICBIRD 2

Baker Island

19 Sept. One seen (class A). No nests. Seen off shore.

19 Oct. Two seen (class A). No nests.

Christmas Island

28 Oct. COOK ISLAND: 3 adults OE, 1 large nestling.

MAIN ISLAND: From London to airfield beyond SW point, 150 counted hovering & flying around, (from sand). At least 2 nests.

30 Oct. LOST ISLAND: 3 L. nestling, 6 ad. OE.

SPECIES ACCOUNT

GREAT FRIGATEBIRD

Flt  
1965

Hawland Island  
16 Sept. NEST COUNT EGG = 3  
L.C. NESTLING = 39  
Imm. = 30

17 Sept. Found only 3 adults in colony at 2200 hrs.

18 Sept. No adults in colony at 2100 hrs.

McKean Island  
21 Sept. sm. N = 16  
e = 1  
L.N = 26

Phoenix Island  
30 Sept. Nest count sm. N = 5  
L.N = ~~47~~ 47

Enderbury Island  
03 Oct. Nest count e = ~~36~~ 47  
SN = ~~173~~ 346  
LN = ~~233~~ 331

Hawland Island  
24 Oct. Nest count = LN = 3. Many imm. sitting around. Counted 8 ad. flew up when I approached.

Baker Island  
19 Oct. One seen (class A).

Christmas Island  
28 Oct. COOK ISLAND: 3 roosting.

29 Oct. UNNAMED ISLAND 1/2 mi E of TURNOFF ON CARVER WAY IN ISLES LAGOON: 50 nests, most w L. nestlings, a few w downy nestlings.

30 Oct. MOTU UPVA: 3 seen roosting, inc. 1 SA.

SPECIES ACCOUNT

LESSER FRIGATEBIRD

Flt  
1965

Hawland Island  
16 Sept. NEST COUNT AD OR EGG = 1  
NESTLING = 36

17 Sept. One ad. ♂ found roosting in dead Cordia near N end of grove. Very thin. TA slipped off of foot.

McKean Island  
22 Sept. W shore colony 150 eggs  
600 N  
E shore colony 125 eggs  
250 N

Hull Island  
25 Sept. Counted 60 sitting over lagoon at 0630.

27 Sept. Counted 700 roosting on individual islands on NE side of lagoon.

Phoenix Island  
30 Sept. Counted 250 eggs, 270 nestlings.

Enderbury Island  
03 Oct. Nest count = 493 N

Hawland Island  
17 Oct. Counted 35 nestlings (good condition)

Baker Island  
16-19 Oct. 175 counted (class C), no nests.

16-20 Oct. 6 counted (class A), no nests.

Fleet  
1965

SPECIES ACCOUNT

SOOTY TERN

Howland Island

15 Sept. A few heard from rubber raft between ship and landing.

16 Sept. Less than 20 heard periodically over island.

17 Sept. Heard an imm. calling over island at night in addition to about 20 ad.

McKean Island

21 Sept. Colony of large locals and flying immatures, max of 10000. Few adults.

Hull Island

28 Sept. Three separate colonies. One of 6000 locals in middle of chain of islands on NE side of lagoon, one of 75000 locals on island NW of blasted channel entrance, one of 25000 locals on island of SE corner of lagoon.

Phoenix Island

30 Sept. Colonies in same places as last visit, (see map) all in late stage with flying immatures. Maximum of 4500 immatures. Some in starving condition. Tits numerous in colony.

Enderbury Island

03 Oct. Remain of colony at N end of lagoon. Almost all flying immatures. Maximum of 4000 immatures. Believe new colony beginning to form at grass pit. 20+ flying over and calling during day.

Fleet  
1965

SPECIES ACCOUNT

SOOTY TERN

Howland Island

19 Oct. A few birds heard every night (15th-18th) calling over island.

Never more than 10 birds and heard singly or in groups of 2, sometimes 3.

Baker Island

16-19 Sept. 50 (class C) heard overhead at night.

16-20 Oct. 20 birds (class C).

Christmas Island

28 Oct. Towards NE point 1) both sides of road, birds in air 10000

2) both sides of road, birds in air 20000. 3000 (just) sitting on ground - no eggs. (seaward side)

site Y 3) 2000 flying or starving immatures.

Carver Way: 4) 10000 on ground plus Swifts (no eggs).

Carver Way & Site M 5) 3000 in air.

Beyond Site M 6) 10000 in 7 spirals. [pop. estimates taken @ 1430 hrs]

Cook Island 7) 10000 just landing, 500 or less starving immatures remain



Fleet  
1965

SPECIES ACCOUNT

GRAY-BACKED TERN

McKean Island

21 Sept. Five colonies of 200+ prs. each ranging from eggs to flying immatures.

Hull Island

25 Sept. Three adults found in Sooty Tern colony roosting.

27 Sept. Two adults seen in chain of islands on NE side of lagoon.

Phoenix Island

29 Sept. May be as many as 2000 total. 100± flying immatures seen around perimeter of island. Mostly roosting adults around lagoon.

Enderbury Island

03 Oct. Total of 50 or less adults seen and heard over flat area on W side of island near RTB houses.

Baker Island

17 Sept. One seen heard? (class B).

Christmas Island

28 Oct. 20+ seen flying over main island.

SPECIES ACCOUNT

Fleet  
1965

BLUE-GRAY NODDY

McKean Island

21 Sept. Most on eggs, saw 3 on nestlings. One large com. of roosting birds near lagoon. Estimate 2000.

Phoenix Island

30 Sept. Maximum of 2000 birds, a few flying immatures seen. Adults appear to be roosting. Many eggs, 10+ nestlings found.

Enderbury Island

03 Oct. Total of few seen flying past house every night at dusk.

Christmas Island

30 Oct. BLUE-GRAY ISLAND: 10 pairs w fresh eggs, 1 w 1/2 grown nestling.  
FAR ISLAND: One roosting.

Fleet  
1965

SPECIES ACCOUNT  
CRESTED TERN

16 Sept

Hawland Island  
One seen flying over surf of East beach at 1630  
by Kepler & Harrington.

24 Sept.

Hull Island  
One seen over ocean, off village in PM.

29 Oct.

Christmas Island  
COOK ISLAND: 30+ seen over raft on way  
to Cook Island.

MAIN ISLAND: 50± seen around ponds  
between London and NE point.

3 collected from group of 15. Most  
birds ad.

Fleet  
1965

SPECIES ACCOUNT  
HAWAIIAN NODDY

16 Sept.

Hawland Island  
One collected from lighthouse, by  
Abraham, at 0630.

17 Sept.

One seen in dead Cordia, in center of  
island, by Arnerman, at 1530 hrs.

One seen roosting in dead Cordia by  
Fleet & Arnerman

21 Sept.

McKean Island  
100+ around rock walls. <sup>one nestling</sup> One one egg.

27 Sept.

Hull Island  
2000 birds counted, about 1/3 on  
nests with eggs on chain of  
islands on NE side of lagoon.

30 Sept.

Phoenix Island  
Counted 200 birds roosting in center  
of lagoon.

03 Oct.

Enderbury Island  
Approximately 8 eggs and 8 nestlings  
present. Many roosting birds. On evening  
of 02 Oct saw concentrated flock of  
2000 birds fly into island from  
Washington and head for guano pile.

19 Oct

Hawland Island  
One ad. captured & skinned. Found  
roosting in Cordia (dead) tree in  
association w RFB & C. Frigatebirds.

16-19 Sept.

Baker Island  
10 birds (class B).

16-20 Oct

20 birds (class B)

Fleet  
1965

21

SPECIES ACCOUNT  
HAWAIIAN NODDY 2

Christmas Island

28 Oct.

COOK ISLAND: Maximum of 500 birds roosting. One SA return, banded in June.  
MOTU UPUR: 1000 ± roosting.

Fleet  
1965

22-

SPECIES ACCOUNT

SLENDER-BILLED SOOTY SHEARWATER

Baker Island

19 Sept.

500 birds (class C) seen offshore.

16-20 Oct

250 birds (class C) seen offshore.

Fleet  
1965

23-

SPECIES ACCOUNT

CHRISTMAS ISLAND SHEARWATER

McKean Island

27 Sept.

One found in band near (on) bare guano mound.

Phoenix Island

29 Sept.

Abundant (300 class C). All stages present. One egg, one sm. nestling, remainder large nestlings.

Christmas Island

28 Oct.

COOK ISLAND: Less than 100 on ground. <sup>one L.N. seen.</sup>  
MOTU UPUR: 15,000 class C. Saw about 25 w eggs and 3 large downy nestlings. One egg hatching. Many pairs without eggs.

30 Oct.

FAR ISLAND: one pr. w egg.

Fleet  
1965

SPECIES ACCOUNT  
HAWAIIAN NODDY 2

Christmas Island

28 Oct.

COOK ISLAND: Maximum of 500 birds  
roosting. One SA return, banded in June.  
MOTU UPUA: 1000 ± roosting.

Fleet  
1965

SPECIES ACCOUNT  
SUBANTARCTIC-BILLED SCOTT SHEARWATER

Baker Island

19 Sept.

500 birds (class C) seen offshore.

16-20 Oct

250 birds (class C) seen offshore.

Fleet  
1965

SPECIES ACCOUNT  
CHRISTMAS ISLAND SHEARWATER

McKean Island

22 Sept.

One found w band near (on)  
bare guano mound.

Phoenix Island

29 Sept.

Abundant (3000 class C). All stages  
present. One egg, one sm. nestling,  
remainder large nestlings.

Christmas Island

28 Oct.

COOK ISLAND: <sup>one L.N. seen</sup> less than 100 on ground.  
MOTU UPUA: 15,000 class C. Saw  
about 25 w eggs and 3 large downy  
nestlings. One egg hatching. Many pairs  
without eggs.

30 Oct.

FAR ISLAND: one pr. w egg.

Fleet  
1965

SPECIES ACCOUNT

WEDGE-TAILED SHEARWATER

McKean Island

22 Sept. About 75 present in burrows  
& on top of low grass mound.

Hull Island

24 Sept One seen and collecting sitting on  
beach at Sooty Tern colony.

Phoenix Island

29 Sept. 1500 (class B) present, sitting about  
in pairs or digging burrows. No  
eggs or young found. Another  
small area found (see map).

Baker Island

16-20 Oct. 20 birds (class C) presumably flying  
(outside)  
off reef.

Christmas Island

29 Oct. Motu Upua: Est. 500 pair: mostly  
fledged or nearly fledged young; saw  
3 large nestlings, contour feathers &  
downy over lay.

3/4 mi. E of turnoff on CARVER WAY, 700 YDS OFF TO  
RIGHT OF ROAD. 15 pair WTS w large  
downy young (contour feathers & downy cover).  
Many cats seen in area. Burrows on  
slight rise.

30 Oct. BLUE-GRAY ISLAND: 3 nestlings, nearly fledged.

Fleet  
1965

SPECIES ACCOUNT

AUDUBON'S SHEARWATER

McKean Island

21 Sept. Common around W shore & interior.  
One egg. 5000'

22 Sept. One large nestling seen

Phoenix Island

29 Sept. Less abundant than on McKean.  
One egg, one nearly fledged  
nestling, one pair seen copulating.

Christmas Island

28 Oct. COOK ISLAND: Less than 15 seen flying  
over and sitting under Lepturus clumps.

29 Oct. MOTU UPUA: 25000? Several pair observed  
copulating, maximum of 25 eggs seen.  
Breeding just beginning; pairs under  
almost every Lepturus clump and side  
bush in interior of island.

28-30 Oct. 100 plus seen flying over main  
island. Birds observed flying  
over 'Lags Lagoon Area'.

SPECIES ACCOUNT

Fleet  
1965

PHOENIX ISLAND PETREL

Phoenix Island

30 Sept. Total of 3 seen. One on top of ground with a newly fledged nestling.

Christmas Island

28 Oct COOK ISLAND: Less than 15 seen flying over and sitting under *Lepturus dumus*.

29 Oct. MOTU UPUA: 25000 class C. Several pairs observed copulating, maximum of 25 eggs seen. Breeding just beginning; pairs under almost every *Lepturus dumus* and *Sida* bush in interior of island.

28-30 Oct. 100+ seen flying over main island. Birds observed flying over 'Isles Lagoon Area'.  
UNNAMED ISLAND 1 1/2 mi. E OF TURN OFF ON CARVER WAY IN ISLES LAGOON: 5 sitting on ground.

SPECIES ACCOUNT

Fleet  
1965

BULLER'S PETREL

McKean Island

21 Sept. Guess at 100 present. Found no eggs.  
22 Sept. Commonly heard calling in rock walls.

Phoenix Island

29 Sept. 10 birds found. Calling from burrows, no eggs or chicks - 3 burrows checked.

Fleet  
1965

SPECIES ACCOUNT

COMMON NOODY

Holland Island

18 Sept One seen in interior of island.

McKean Island

21 Sept. Common nesting. Range from eggs to flying immatures. Mostly on eggs, no small N seen. : 3000 TOTAL; 300 e.

Hull Island

27 Sept 230 count on chain of islands on NE side of lagoon. Four nests, 3 probably incubating (would have been nest.).

Phoenix Island

29 Sept A few (25) eggs seen, some (10) small nestlings seen, mostly (100) flying immatures.

Baker Island

16-19 Sept. 100 birds (class C), no nests.

16-20 Oct. 10 birds (class B), no nests.

Christmas Island

28 Oct. COOK ISLAND: 50 or less roosting.

30 Oct. BLUE-GRAY ISLAND: 10 pair w/ incubated eggs

LITTLE BLUE-GRAY IS: 3 on eggs.

MOTU UPUA: Several hundred roosting, one nest w/ egg seen.

DOT ISLAND: one nest w/ egg.

FAR ISLAND: one nest w/ egg.

Fleet  
1965

SPECIES ACCOUNT

FAIRY TERN

McKean Island

21 Sept. Common, nesting on rock walls and coral rubble. Most on eggs, some sm. nestlings seen.

Hull Island

27 Sept. 100 seen on chain of islands on NE side of lagoon. No eggs or young found.

Phoenix Island

29 Sept. Less than 10 eggs seen, 2 small nestlings. About 1600 adults present.

Enderbury Island

03 Oct. Total of 10 birds seen over island. One pair seen on rock slopes on S end of island, all others in groves of trees.

Christmas Island

28 Oct. COOK ISLAND: 3 seen on E, 34 nestlings; 3-500 birds present.

29 Oct MOTU UPUA: 300± roosting.

30 Oct. LOST ISLAND: flying over

FAR ISLAND: flying over.

SPECIES ACCOUNT

Flux  
1965

RED-FOOTED BOOBY

Howland Island

16 Sept. NEST COUNT EGGS = 6  
 Sm. NESTLING = 3  
 LG. NESTLING = 15  
 IMMATURE = 4

~~22 Sept 300-400 adults on island at night~~

McKean Island

22 Sept 300-400 adults on island at night.  
 Counted 1 Br. egg and 2 nestlings.  
 L.N. = 5

Hull Island

24 Sept. Counted 2 flying over lagoon.

Phoenix Island

30 Sept. Nest count 1c = 9

Enderbury Island

03 Oct. Nest count: e = ~~70~~ 121  
 SN = ~~78~~ 21  
 LN = ~~113~~ 178

One adult RFB returned in PM of 02 Oct. & seen during nest count on 03 Oct. in grass near guano pile; sitting ~~near~~ ~~near~~ ~~near~~ near nest and brooding a small Great Frigatebird nestling. The bird defended the nest when approached / 727-87759.

Howland Island

24 Oct. Nest count: eggs = 2  
 LN = 2

Counted 100± in larder last night.

SPECIES ACCOUNT

Flux  
1965

RED-FOOTED BOOBY 2

~~Baker Island~~

16-19 Sept. One bird seen, no nests. (Class B)

18 Oct. Seven birds seen (Class C). No nests.

Christmas Island

28 Oct. COOK ISLAND: 10 roosting.

29 Oct. ISLES LAGOON AREA, MAIN ISLAND: Max of 2 mi.

of lagoon edge worked: 200 birds, 6 nestlings.

30 Oct. WEST ISLAND: 1 L. nestling, 2 imm.



Fleet  
1965

34.

SPECIES ACCOUNT

GODWIT SP.

McKean Island

21 Sept.

One seen by lagoon.

22 Sept.

All attempts at collection failed.

Baker Island,

16-19 Oct.

One Pin-tailed Godwit collected.

Fleet  
1965

35.

SPECIES ACCOUNT

REEF HERON

McKean Island

21 Sept.

One seen by lagoon. Dark phase.

Fleet  
1965

36.

SPECIES ACCOUNT

SANDERLING

McKean Island

21 Sept.

One seen

22 Sept.

One in shrubland count. Couldn't collect.

## SPECIES ACCOUNT

Fleet  
1965

## SCARLET-BREADED LORIKEET

27

Christmas Island

28 Oct. 2 collected from palm grove 1/2 mi. East of airfield.

30 Oct. 2 seen, 1 heard at same location.

## SPECIES ACCOUNT

## DUCKS

38

Christmas Island

28 Oct. Pintails: 4 ducks seen, 3 Pintails, one slightly smaller. Seen on small ponds towards NE point.

29 Oct. Shoveller: 2 seen and collected from small ponds towards NE point.

30 Oct. Shoveller: One collected from small pond at NE point (P.H.R.).

## SPECIES ACCOUNT

Fleet  
1965

## MAMMALS

51

Baker Island

18 Sept

Four seen in good condition. One Mus. m.

Howland Island

18 Sept.

Seven cats (total separate sightings) seen all in good condition.

Phillips Islands

28 Sept.

Five dogs (3 in S.T. colony on NE shore, and 2 in S.T. colony on SW shore) and two cats in SW colony.

Rattus seen frequently in S.T. colonies and in village.

Phoenix Island

30 Sept.

Approximately 350 rabbits w light to medium fat.

Christmas Island

28-30 Oct.

Cats abundant. 20+ blood samples taken.  
MUS MUS: Mus. musculus size rodent

Fleet  
1965

SPECIES ACCOUNT

MAMMALS

Baker Island

18 Sept. Four seen in good condition. One Mus. m.

Hawland Island

18 Sept. Seven cats (total separate sightings) seen all in good condition.

Hull Island

28 Sept. Five dogs (3 in S.T. colony on NE shore, and 2 in S.T. colony on SW shore) and two cats in SW colony.

Rattus seen frequently in S.T. colonies and in village.

Phoenix Island

30 Sept. Approximately 350 rabbits w light to medium fat.

Christmas Island

28-30 Oct. Cats abundant. 20+ blood samples taken. MOTU UPR: Mus. musculus size rodent seen as well as rats that are size of R. exulans.

30 Oct. LOST ISLAND: 4 rats sp!.

Fleet  
1965

SPECIES ACCOUNT

REPTILES - GREEN SEA TURTLE

Hull Island

25 Sept. Large ♀ turtle (4'x4') found at edge of seaweed on ocean beach at Sooty Tern colony. Remains of 4 turtles found on rock slopes at new S.T. colony.

Phoenix Island

30 Sept. One dead adult (3'x3') in center of the Frigate colony (rotting) and one dead adult (3'x3') in lagoon.

Six hatchling (live) plus one dead one found at top edge of beach near camp.



SPECIES ACCOUNT

Fleet  
1965

RUDDY TURNSTONE

~~16 Sept~~

Howland Island

16 Sept. SHOREBIRD COUNT = 16

McKean Island

22 Sept. SHOREBIRD COUNT = 135

Two seen (closely) with orange  
paint-due on rumps - from Privalofa.

Hull Island

27 Sept. Present. 8 seen 1

Phoenix Island

30 Sept. SHOREBIRD COUNT = 178 one w orange rump.

Enderbury Island

03 Oct. Shorebird count held in two sections  
on 02+03 Oct. = 302

Howland Island

17 Oct. Shorebird count = 7

Baker Island

17 Sept. shorebird count = 250 (class B)  
ONE w ORANGE RUMP SEEN

18-19 Oct. shorebird count = 250 (class B)

Christmas Island

28-30 Oct. 8 counted; many more present.

SPECIES ACCOUNT

Fleet  
1965

GOLDEN PLOVER

Howland Island

16 Sept. SHOREBIRD COUNT = 25

McKean Island

22 Sept. SHOREBIRD COUNT = 278

Hull Island

27 Sept. Present. 5 seen

Phoenix Island

30 Sept. SHOREBIRD COUNT = 133

Enderbury Island

03 Oct. Shorebird count held in two sections on 02+03 Oct. = 89

Howland Island

17 Oct. Shorebird count = 44

Baker Island

17 Sept. shorebird count = 50 (class B)

18-19 Oct. shorebird count = 150 (class C)

Christmas Island

28 Oct. 77 seen no count possible.

Fleet  
1965

SPECIES ACCOUNT

WANDERING TATTLER

Howland Island  
16 Sept. SHOREBIRD COUNT: 7/11

McKean Island  
22 Sept. SHOREBIRD COUNT = 39

Hull Island  
27 Sept. ~~Trust~~ 3 seen

Phoenix Island  
30 Sept. SHOREBIRD COUNT = 13 collected one

Enderbury Island  
03 Oct. shorebird count held in two sections on 02 & 03 Oct. = 10

Howland Island  
17 Oct. shorebird count = 8

Baker Island  
17 Sept. shorebird count = 12 (class B)

18-19 Oct. shorebird count = 30 (class B)

Christmas Island  
28-30 Oct. 15 seen, no count possible.

SPECIES ACCOUNT

SHARP-TAILED SANDPIPER

Fleet  
1965

Howland Island  
16 Sept. SHOREBIRD COUNT = 1

McKean Island  
22 Sept. SHOREBIRD COUNT = 1 collected.

Phoenix Island  
SHOREBIRD COUNT = 2 (B) one may be PECTORAL.

Enderbury Island  
03 Oct. counted 4 individuals. Woodward shot 2 on 02 Oct.

Baker Island  
18 Sept. shorebird count = 5 (class B)

20 Oct. shorebird count = 17 (class B)

Christmas Island  
28-30 Oct. 4 Erolia sp? seen. No count possible.

SPECIES ACCOUNT

Fleet  
1965

WHITE-THROATED STORM PETREL

Phoenix Island

29 Sept. One live and one dead individual seen. No evidence of breeding.

Christmas Island

30 Oct. BLUE-GRAY ISLAND: 100; 10 on fresh eggs, ~~1/2 green~~ Most sitting on empty nests.

MOTU UPUA: One found, no nest.

SPECIES ACCOUNT

Fleet  
1965

BRISTLE-THIGHED CURLEW

Howland Island

16 Sept. SHOREBIRD COUNT = 10

McKean Island

22 Sept. SHOREBIRD COUNT = 90

Hull Island

27 Sept. Present. Four seen.

Phoenix Island

30 Sept. SHOREBIRD COUNT = 98

Cookburn Island

0300 Shorebird count held in 2 sections on 0240-0300 = 64

Howland Island

17 Oct. Shorebird count = 0

Baker Island

17 Sept. Shorebird count: 15 (class B)

20 Oct. Shorebird count: 2 (class A)

Christmas Island

28-30 Oct. 25+ seen, no count possible.