

UNITED STATES  
DEPARTMENT OF THE INTERIOR

---

GEOLOGICAL SURVEY

---

9-138

II.

A. S. Kadd

III

1940

Notes: *Reading, Utahland in red are on off map*  
Reviewed 7/28/42

INDEX

Probable Section	2
Notes on fossils (Butts)	3
" " - locs	4
" " - Fossils - Blue field, 1/4 Va. Ave.	5
" " - Bluefield Mt.	6

Showing distribution in red area on off map  
 Reviewed 7/28/42

INDEX

Probable Section	2
Notes on fossils (Butts)	3
" " - Dec.	4
" " - Fagus woods - Bluefield, Va. Co.	5
" " - Buckhorn Mt.	6
East River Mt.	7
Airport Section - Bluefield, Va.	12
Round Mt.	14
Burke Garden	15
Round Mt. Trav. along crest	19
East River Mt.	27
Round Mt - Bal Trav. along crest	30
Wilderness Creek	34
North Fork Kimberling Cr.	36
Flat Top Mt. - crest	38
Wilderness Branch	41
Warwick Gully	42
Leifer mine (Taylor)	43
Silver Cr. Cr., etc.	44
Silver Cr. at Holly Brook	47
Stage washer	49
Db-trav. Trav. N of Mine. Cr.	52
Correr Hollow	53
Cr. W. of Thompson Hol.	54
Thompson Hol.	55
Dismal Cr.	57
Hol. E of Shiloh Cr.	59
Dismal Basin	60

Probable Section

Db<sub>s</sub>

✓ Blue shale

Don

✓ Onondaga [50' ±] fossils (possibly *Onondaga*)

✓ Oriskany (on slope of dip is about only 5' or less to be expected - *Spirifer* *arenosus*)

Db

✓ Keokuk [75' ±] = 100 ±

St

✓ Tonoloway (or *Fugate*) [50' +] - *Spirifer* *pt.* *del.* *del.*

? *Leptaena* ? [none recognized]

Sct

✓ Clinton [100-155'] - *Spirifer* *329'*

Sch

✓ *Clinton* - *Spirifer* *158'*

Oj

✓ *Clinton* - 158-200' ± - *Spirifer*

Dem

✓ *Clinton* - *Spirifer* *600'*

*Clinton* - 400' ±

OK

*Clinton* - 400' ±

Notes on fossils -

Rhipidomella oblonga - chiefly New Scotland  
Spongia concinna - Boscoph New Scotland  
(not rept. (Australia))

✓ Baculites - in Boscoph - not known in Australia

✓ Aspidoceras scutelliforme (from one of many  
by Smith) - apparently index  
of Europe - usually in partly  
preserved shells in ss.

Stange Mine colls -

- ✓ Strophodonta planulata - Boscoph index, Stange Mine
- Stenoceras formosa
- Puzosia holderbergae
- (a) Rhipidomella oblonga
- Spongia concinna
- Ornamentus abruptus
- Murchella arcuata
- Cyclopterus sp.

In ravine near Holly Brook the  
Tonoloway (or Keyport) ls. occurs at  
just below Buckhorn (522R) - 1st

There is some showing of manganese  
along Buckhorn Mt. - east of Steeple Gap  
- prospected in pits - 1-2 m. deep  
(see Evans re prospecting) - same bed  
as on T-1st top

Outcrop of Clark exposed on SE slope of  
East Hill Mt. - dip ± uniform at 25°  
- also Beaumont + Onondaga, Van Duzer

38 sh. mth. *Schizophoria*, *Stylodonta*  
*Murchisonia*

50 ± = Onondaga

mass of semi-consolidated coarse sand, etc. 100'  
(Beaumont?)

32 in. of sandstone layers, incl. thin white at  
bottom from weathering of sandstone

(Section system)

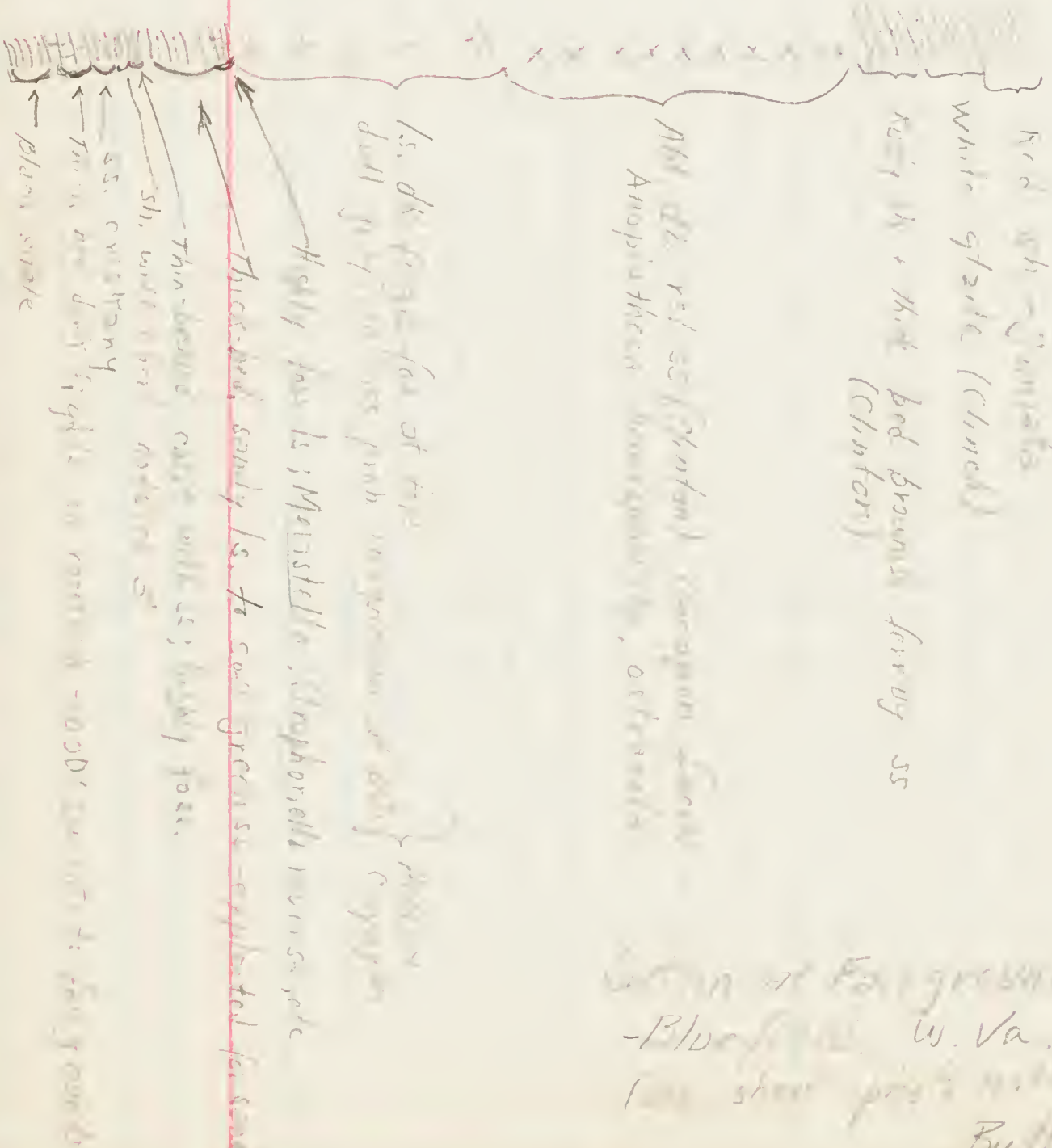

Red sh - Clinton

White shale (Clinton)

Red sh + thin bed brown fony ss (Clinton)

thick bed of ss  
Amplexites, Anopliotheca, orthoceras

ls. dk. fine-grained at top  
dull gray in base magnesian or calciferous

Highly fossiliferous ls. Meristella, Strophomena, Murchisonia

Thick-bedded sandy ls. to calc. greenish-sphered fine sand

Thin-bedded calc. with ss. highly fossiliferous

sh. with thin bedded ss.  
ss. crinoidal  
thin bedded ls. with light to reddish-brown - 1000' thick  
blue shale

Section at Fairgrounds or Belmont - Blue Springs, W. Va.  
See sheet p. 100  
Beullis

Section overlapped

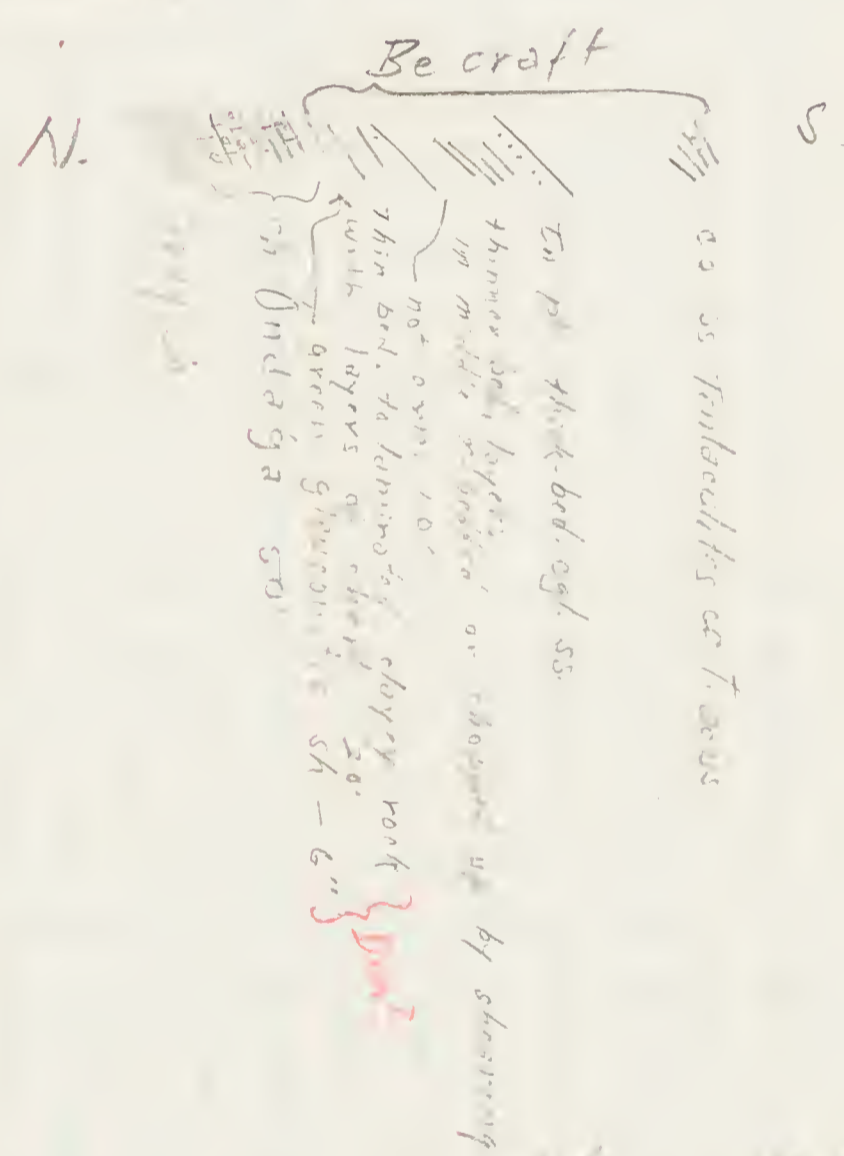

Sec. in gap of Buckhorn Mt about 1 mi  
 N. of Rocky Gap vill. Va on  
 U.S. 21



Sept 15 Wednesday

1940 - pass on East River Mt - contact  
look over Sumate - (Altho. pyrox  
in Sumate - look over also? - on  
to Clinton - no canyon, - fault  
in Clinton - on end - get stuck here  
+ rhyolite etc.

70.9

On to Becraft sand pit, overlying  
chert with fac. over it - good well  
place - is it Onstang? (of Sp. Sumate)  
Becraft sh. over this  
Chert about 50' max?  
Onstang (if present) = ±  
- most many in Becraft sand.

Rocky Gap

- 2  
72.9

- Onstang - Becraft over Onstang  
2 mi. below loc 1 - good but with soft  
+ hard Becraft above - but Becraft may  
not be more than 50-60' - Clinton  
forming - look on rd. below but outcrop  
not seen (loc 1, 3 mi New Rock, Grafton)

74.2  
74.4

Rocky Gap town - cross RR  
Coke Wolf Cr.



- cross by fault into Knox.

- into Sumate (rd) - then chert  
(contact)

76.1

Turn left Highway - Alderson Cr. 7

- 76.9 Quarry in Bl. sh.
- 77.9 ss. - Becraft  $\bar{z}$
- 79.9 Clinton [?] - see return logs - p. 34
- 80.2 chert - mt. bedwts <sup>N.</sup> Kumberling Cr
- 82.0 bl. sh in cr. - good exp.
- 83.3 " " good exp.
- 84.6 " " " "
- 84.8 ~~2000~~ <sup>N. Fork of</sup> Kumberling Cr.
- 85.1 Bl. sh
- 85.2 Rd. fault - bl. sh
- 85.4 } Cross Creek - ~~S. West Cr.~~ - N. fork Kumb +
- 85.5 } Rock Lick
- 85.7 Bl. sh
- 86.1 " " along Rd.
- 86.8 <sup>main</sup> Kumb. Cr. valley <sup>to SW.</sup> Bl. sh - turn toward - house

- 88.4 Turn <sup>R</sup> at Shady Grove Church (School)
- 88.7 Swale - between str. knolls (Gawley Ridge)
- 89.4 School - Holly Brook
- 89.8 Holly Brook - good outcrop flat lying  
Beecraft with disconformity at start  
(soft sand below) - other side across creek  
not visible) E-W, 5 N. at start.
- [note above section ~~is~~ corrected - down  
down N Fork timberline.]
- 90.0 [Tonoloway [90.2] - under long road - and on road 
- 90.7 Turn N. up <sup>hill</sup> Beecraft - Beecraft a sharp flat  
[75E±, 5±S]
- 90.8 Grandage ch - at sharp turn
- 91.1 W. " " - on to Beecraft
- 91.3 heavy ch. floor
- 91.4 Ls. - Tonoloway (probably) - Beecraft  
better outcrop - Beecraft got fine
- 91.5 sharp turn R - Ls. - Tonoloway down  
Ch - 50' ± - nearly flat - few disconformities

91.7 Breakfast -  
 91.8 Omandaga ch. - turn Sh Bl Rdy  
 91.9 Breakfast  
 92.0 Omandaga  
 92.3 Breakfast  
 Turn R  
 93.9 Turn L  
 94.0 " L  
 94.2 Burn property (worked 5000 ft)  
 turn back  
 94.6 Turn R  
 94.7 " R  
 94.9 " " (new route)  
 94.95 Omandaga ch outcrop  
 95.1 Breakfast  
 95.3 "Star Pt?"  
 3) 95.7 Stange Mores  
 Washer  
 97.7 fork below washer  
 98.2 church Wacandona church - to L  
 98.4 Bl. ch - hot ±

11.8

rand pit - loc<sup>77</sup>-1

15.25

H low top mt

an-fall - hangover, south Bluefield

- 4
- 4a
- 5
- 6

Upper Acropolis =  
 " "  
Basal  
Crushing z.

Sept 14 Thawing  
 Section at base of hill at Bluefield  
 Top of exp. is abandoned sand quarry

		Quartzite (p. 100)	27'
		very cherty with fine shaly parting below fine - weathered along - poor fossil	
6	"Section" 98'2"	Crustaceous? sand - exposed 30' up hollow (fossil)	5' ±
		Shale - covered 10' (fossiliferous) clayey shale 22' 6" (Black area is)	21' 6"
		bluish shale	
4		Black shale (fossiliferous) - heavy, thick bedded x-bedded	19' 50' 5"
5	710 - 62' 6"	Green gray ss Gray ss with numerous fossiliferous beds + weathered, see base of road clayey in heavy beds	3'
		reddish shale ss + shaly - lumpy	
		covered	3'
		ss + shaly - lumpy	3'
		ss + shaly - lumpy	22' 6"

7 → 2' 6"  
 4' 11" 6"  
 2' 6" 2'

Today saw some brown sand 9' <sup>shaly</sup>

8 to near top - 20' + below #7

-above section N50E, 75E (River Road)

In afternoon drove to Passaic to see  
Thrust (Middle Knox over Seneca  
Block shot) + section

Sept. 20 Friday

38.5 Station - cross - Hamilton Camp Creek  
( $\swarrow$  Road on trail # 5019)

40.0 $\pm$  Turn River near  $\swarrow$  rd - salt Dew block  
to here - by - salt on road + 0.5

9) 42.8 Rock salt - impure - common -  
- cut on road - not close to summit  
- Oadley's cut on cut on road level

43.1 Red Clinton on cut - Clinton - flat area

43.5  
+3.51 Clouds appear on road on road cut  
- in road beyond appear Clinton's  
- small area first level  
- near Clinton

43.9 on cut to road

44.1-2 Clinton - Barre - Clinton - rolling E

\* 44.8 - rd (ascension) to it -  $\frac{20 \text{ mpc}}{200 \text{ ft}}$  -  
- 5-6 ft deep

45.4-1 - top of road cut { 28.50 - marked - B  
29.00 - " - H

45.7 - upper - { 30.50 - " - B  
lower Barre? { 31.70 - " - H

46.1 Clouds 5 - 6 ft high

46.35 $\pm$  lv car



Bed of CO<sub>2</sub> ...  
 Section at NE end - ...  
 to ...  
 ...  
 N70W-56N - top run from cloud  
 N75W-38N - below top ...  
 - ...  
 - E-W, 23 N, near top of cloud on rd  
 1/2 way, ± can ... to ...

[ CO<sub>2</sub> ...  
 ...  
 end ]

Bed ... to end ...

51.6

Start up Hunting Camp ... rd

52.0

Cross

Up ... valley - good ...

53.4

cross creek

} excellent Dev - up  
into Channing

53.8

54.5

54.8

fall - ... Fire Trail to L - to R

55.15

Fire trail to 5010 (from ... 5010)

55.65

...  
...  
...

56.3

Knox

56.9

Aug. 21 4th rd

57.3 flint 21 & Stat 42 rt on 42 Knox  
63.9 rd f k Ten rt

65.5 Top - Brushy Mts

65.7 Quarry - Dow - Blk. Shale.

71.55 Tapered Co - Island Co lens - south  
Burkes Garden

- N55E 28E on summit along rd, all  
weather

10

On top of hill 71.9

Top of Marysville  
- first small hole at 72.5

74.0 Gray massive along rd - north  
side of road - hole in road on way  
down from top of hill - probably  
locality for

75.2 weathered rock (probably in road  
at 75.2)

77.5 - contact of rock - Knox Mountain

11

N74E, 25N at 78.0m Elev - Marysville

78.5 Summit, close to contact with Clark

78.6 Quarry, probably Clinton

12

Arundelga shell on floor of roadbed  
quarry section - 20' - 25'  
see map - see map.  
Pit on Arundelga - about N75E 20N

Mangrove - Beroff - N70E 10W

13

N75E, vert ± ss. (cracks?) with  
clay at 81.6 - side of road

81.8 - clay N60E 61W

81.15 - top mt. - clench just above

81.3 - mt. summit

82.0 - in Eden

14

N57E, 40 N - Clinton - clay - clay  
cracked - overturned

15

82.3 - 1/2 mi ± W of Cranfield  
School on road - clay - clay  
- gold ore - Clinton & zinc  
Arundelga - ore

70.9 Lv. Hwy

71.45 cross power line

72.65 top

74.65 Tower

77.0 end road = 6.1 mi to base



Traverse along crest of Round Mt. - end of  
 Freshy trail to tower to main rd. - # 21

Sta.	Bearing	Dist	Vert. Angle
1	N 61 W	150	- 3°
(2)			
3	S 78 E	270	+ 4'
(4)	S 73 W	165	+ 1 1/2°
			with ground cover & much of rock
5	N 3 W	150	- 3 1/4°
(6)	S 27 E	210	+ 1° 30'
			on road
7	N 28 E	80	- 3 1/2°
(8)	S 33 W	220	- 1° 45'
			on R. side road into woods
9	N 4 E	350	- 4° 15'
(10)	S 8 W	140	- 3'
			Phone line (over)
11	N 89 E	140	+ 2° 35'
			on East side of road
(12)	N 6 W	502 1/2	- 5° 15'
			30' off rd - on line (E) - 4' below rd at rd. st 25' off rd - on line
13	N 7 E	180	+ 3° 30'
			on road
(14)	S 57 W	190	- 4° 30'
			at rd. on between # 17 & 15 - ± 4' 15'

15	N54E	225	+3'30"	20' roof
(16)	S37W	170	-5°	
17	N50E	140	+2'30"	N180 40' } Clinton rd }
(18)	S33W	350	-4'15"	" " } N400 200 } 115' 40' }
19	N40E	340	+2'30"	1' above rd
(20)	<del>S50E</del> N80W	70	+5.6'	120' above rd } Clinton close to 22 } [on top of building?]
21	S27E	560	+1'30"	
(22)	S63W	250	-4'15"	-30' off rd, W.R. 2' } -20' in ground }
23	N61E	270	+2'30"	on road
(24)	S40W	560	+4'	
25	N40E	800	+3°	Clinton rd on rd gutter } E side }
(26)	S23W	280	-4°	
27	N34E	420	+1'30"	2' above rd on L
(28)	S66W	240	-2'	

- 29 S76E 280 -4'15"
- (30) S51W 220 +3 Chertan 1500 in rd gutter
- 31 N21E 140 -2'50"
- (32) S14E 330 +3°
- 33 N23E 420 -4° Chertan iron floor
- (34) S55W 90 +3°  
 a  
 S. side road -  
 Chertan iron - variable  
 200' to 300' long  
 with - metal bed
- 35 N8E 640 +2'3" Chertan iron corner
- (36) S84W 230 -5°45" R. side rd ↗
- 37 N07E 150 +3° Chertan iron in rd gutter at (36)
- (38) S93W 330 -5°
- 39 N72E 600 +4° Chertan iron ± foot in rd gutter
- (40) S14W 170 -4°40'
- 41 N53E 210 +4'30"
- (42) S19W 230 -5°

43 N10W 280 +2°30'

(44) S20E 150 -1½'

45 (45) N15E 270 level

46 N77W 10 "

Tower side shed

(46) S17W 420 -3½'

47 N37E 340 -1°20'

(48) S41W 350 +4'

49 N63E 220 -4½'

(50) S85W 370 -1°

51 N82E 280 -3°30'

(52) S61W 550 +1°15'

53 N56E 140 -4°15'

(54) W 300 +4°45'

55 S70E 150 -3°

(56) S72W 140 +3°15'

all on - in  
interior  
- for  
boulders -  
- most of all  
all - Clinton



57	S39E	260	-5°
(58)	S68W	170	+4°20'
59	N55E	170	-3°40'
(60)	S81W	330	+3°45'
61	N70E	190	-5°
(62)	N7°	104	+7°30'
63	NW	35	+1°
63	N8W	340	-4.8'
(64)	S9E	210	-1°30'
65	N33E	190	+1°40'
(66)	S10W	420	-3°
67	N28E	330	-3°30'
(68)	S47W	290	+4°30'
69	N59E	430	-7°20'
(70)	S45W	330	+4°30'

No. of groups  
 about 20. That  
 - scattered -  
 probably all  
 scattered  
 2-4 in 10 ft  
 23 ft from center  
 col. from center  
 about 20-6'  
 from 1.1650

- 71 N57E 350 - 7°40' } 3' off rd on E + 2'
- (72) S43W 380 + 4°20' } 4' off rd = 20' off rd  
 20' from 71 + 72 =  
 40' off rd
- 73 N15E 370 - 4°45' } 4' off rd = 20' off rd  
 20' off rd
- (74) S43W 540 + 4° } 30' from 74 to 35 = 20' off rd  
 on rd on E side - 100' off rd  
 3-10' = hor. [N22E = 65°]
- 75 N55E 130 - 5°20' - 20' off rd on E side
- (76) S37W 260 + 4°40' - 10' off rd
- 77 N13E 100 - 2°40' - 20' off rd on E side
- (78) S45W 260 + 4°15' - 20' off rd on E side
- 79 N34E 420 - 2°45' - 20' off rd on E side
- (80) S70W 270 - 5°40' - 20' off rd on E side
- 81 N55E 680 - 8°40' - 20' off rd on E side
- (82) W 540 + 7°45' - 20' off rd on E side
- 83 E 480 - 9°20' - 20' off rd on E side

(84) S70W 180 +5° flat mostly Beer

85 N87E 400 -9° " " "

(86) S87W 170 +10°

87 N67E 564 -10°45' very little flat

(88) S76W 360 +5°40'

89 N72E 100 -7°15' -flat mostly Beer +  
-some big ferny rocks

[Blaze on tree lies  
12' diagonally off  
rd down to L]

[see p. 30 for  
lat. of trav. by  
comp. w. page]

82.9 at US 21.

83.7 Rd at Hicksville (Tay. Rd)

Sept. 26 Thursday

- 0.0 Speedometer at 0.0 at Va. state line  
in East River Mt. on road at  
Rocky Gap
- 0.10 N48E, 32 E - Clinch ss.
- 0.35 N51E, 30 E - Clinton ss
- 0.70 N58E, 30 E - " ferrug. beds
- 0.95 N53E, 27 E - " ss + sh.
- 1.30 N66E, 31 E - " ss
- 1.70 N73E, 29 E - " "
- 2.00 N74E, 31 E - " ferrug. beds
- 2.30 Clinton nearly hor. - ± variable - on pt. - a slip?
- 2.40 N45W, 63W - Clinton ss - local - dip probably
- 2.45 N69E, 30 E - " " - probably OK.
- 2.50 N50E, 66 E - " ferrug. beds - OK?
- 2.55± N69E, 30 E - " sh. " ?
- 2.60 N65E, 85N - small fold and fault involving  
ferrug. beds of Clinton
- 2.60± N45W, 8W - down rd just below fault - ss
- 2.80 N30E, 15 W - Clinton sh. + ss - good section 15'
- 2.90 N40E, 16 W - " " " " " "
- 2.95 N62E, 35 S - Becraft - heavy salt buff ss with  
Manganese

3.00 N65E, 31E - back into Clinton - fairly heavy  
ss - long strike exp.

3.15 N63E, 29E - undoubted Clinton

3.25 N25E, 40E - Becraft - with Many. overlain

3.30 N35E, 60E by Onondaga chert dipping 60°

3.35 N85W, 32S - sand pit in Becraft

(Onondaga is on loop in rd. with  
Becraft on both sides)

3.30+ E-W, 25S = transition bed's between pit  
and short point (on rd. here  
not as regular as supposed)

3.35 N45E, 27E - good Becraft - soft sand and  
many - bearing beds of hard ss.

\* 3.55 N55E, 31E - Becraft overlain by Onondaga  
(mostly chert) & that in turn  
by bl. sh. - Onondaga measures  
23 p. across strike and  
dips 31°. (This good place  
for accurate measure of Onondaga)

4.05 N60E, 55E - bl. sh. - good exp.

5.00 Cross Dry Fork

5.20 Becraft at head of Rocky Gap. (Rocky  
Gap section to be measured later)  
- over poor exp. Clinton (not examined)

6.45 Cross Laurel Cr. in Rocky Gap village

6.65 " Clear Fork

6.75 " Wolf Cr. on to Knox dol. - probably 25

N60E, 27E

crossed major fault some distance back  
(see map) - exposure of Knox in Wolf  
creek below bridge not examined.

5.45 Road to Holly Brook takes off to L.

8.50 Cross Wolf Cr. (flow L to R) rd. heads W.

12.75 Tazewell Rd. up Wolf Cr. takes off to R.

13.55 Fire Tower trail (to crest of Round Mt.  
takes off to R. (use deck railing  
on bridge car OK).

Balance of Round Mt. Traversa  
(see p. 25)

Sta.	Pace	Brunton and Pace (uncert on the) Bearing	Remarks
1)	0	N80E	Apparently still on Bucroft
2)	40	S84E	
3)	110	N75E	Small chest becomes abundant in road but may have been hidden in - only one large - but found in bush - chest in bush - road on bridge
4)	135	"	still in same general direction
5)	210	E	
6)	250	S80E	
7)	375	S70E	
8)	550	S65E	Very steep bit 7-9 - much more countered
9)	620	S65E	
10)	667	"	left in place - road gutter - all here just N20W, 20E ± 90° to 100°
11)	878	"	Under lower line, bend (50 N21W)

12)	720	S81E	} Apparently still on Onondaga chert
13)	790	N70E	
14)	840	"	Shale flattened chert, chert very loose - probably off shale surface
15)	885	N76E	See all but former chert in road
16)	1015	N74E	some chert at foot?
17)	1095	S61E	} Discontinuity of system - 1000 ft
18)	1125	S45E	
19)	1215	S51E	Steeper dip out above
20)	1285	S35E	
21)	1358	"	Cross RR
22)	1425	S19E	Bluish shale littered with near 144.5 mi to 145
23)	1445	S68E	
24)	1530	S73E	Bl. Sh. road in road
25)	1615	John Road 71	



17

- 0.00 at junction Rd. Mt. ... <sup>#21</sup>
- .20 high bank bl. sh., badly slumped, attitude obscure - harder (rot. bl. sh. in road gutter look N 25 E ± 10 E ± springs issue below road & then in distance outcrop of glauconitic, argillaceous ls? with numerous Dev. tracks & some chert. Bedding appears to be N 55 E, 10 E E.
- .30 N 40 W ±, 17 E - bl. sh. - some vertical E greenish clay, striae harder.
- .35 N 5 W, 15 E - fine bedding on gray chert from ~~bl. sh. unit? - does not look like Spangula~~
- .55 over W. Cr. of S 4. - bl. sh. under ledge N 55 E, 45 E; variable due to minor folding. Much of exposure than bl. sh. Targuati 10 - turn L up W. Cr. valley
- 1.10 bl. sh. N 75 E, 20 N variable
- 1.75 over under power line, strike N 39 W
- 2.10 E-W, 35 N - good - bl. sh. - typical (would meet to creek here)
- 2.60 green cliff on Sp. N Mt. opp. low
- 3.20 N 75 E, 20 E - bl. sh. top

3.25 N 43 E, 15 N - probably more representative  
of regional structure than last  
- on chale put along road

[~~to~~ continued at later date]

Sept. 27 Friday

Through Rocky Gap to mouth of Wilderness Creek

0.00 Holly Brook in forest near house US 21.

.70 shale pit - bl. sh. N45E, 30E - typ. thin

1.70 N58E, 14E, thin sh., weathered, iron-stained

2.95 cross Wilderness Cr.; sawmill here.

3.50 Shale pit on L.; thin buff to gray; 45E, 70° variable

3.90 N57E, 5SE, bl. sh. fine similar to last

4.50 N64E, 54S - go sh. along road

4.50 N72E, 30E - water-lim. bedding, good exp. in creek bed, creek flowing east; see just west of road fork

4.85 Road fork - take R. - sawmill at 4.90

4.90+ N60E, 24E - go bl. sh.!

5.35 N55E, 13S - " " " = W. edge of Pulaski sh.

5.55± N63E, 40N - sh. in creek; minor folding

5.65 N52E, 35N - water-lim. - good section sh. in creek

5.75 cross cr. - [house here is just above or below the creek]

6.65 road in lower R. [not shown on Pulaski sh.]

6.75 N60E, 16E - sh. - 15' bluff along with road (R)

6.9 - dip up to 10°

8.3 cross cr. 10K with water tunneling N. Fall Creek. B. 34

Shady Grove

8.7 Wood fork - School - see map

Plot on site on road cut between 2 hills  
east of Shady Grove School

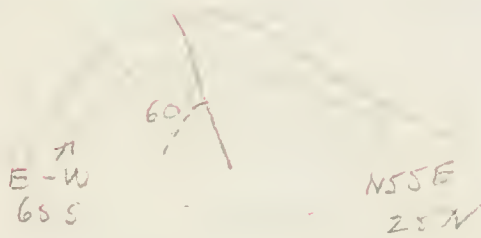

Oct 1 - Tues.

- 0.00 Road down at Park Hill, Kentucky Co. iron road
- 0.05 mile marked, west of W. edge of Putlocker Shale
- 0.15 500 ft. - bearing at N 75E, 20S
- 0.25 saw mill
- 0.45 N 75E, 20S - bearing at outcrop on rd.
- 0.45 sh. in rd. gutter - N 68W, 12S (put to find green shale house & also to W. edge of Putlocker shale)
- 0.50 W. edge Putlocker shale, large outcrop at N 50E, 30W on hill where a creek - to SW of road.
- 0.75 = folded sh. in creek; not necessarily
- 0.80 = outcrop sh. " "
- 0.90 cross creek to its R bank, house here we find house shown on Putlocker sheet - minor fold on shale in creek bed just above house crossing green siltstone & clay

1+ mi N of Holly Springs, Va. - bearing for time on hillside road - the first place to measure thickness of ls - rock red - blue - some shaly layers

at pt. where a very red shaly fine section was exposed in creek - in road cut above. Upper beds all red sh. Clinton (see page 10) ~~at house~~  
 bearing at house to Clinton - N 25E, 12W

3.5 <sup>on rd.</sup> just before crossing ford - B. N 30E, 20S - the opposite of bearing of last str.

- 0.00 at sharp turn up on rd. bearing at N 75E, 50E
- 0.05 road cut - N 50E, 30W (other exp. than last)
- 0.20 " " " " - bearing to NW
- 0.40 contact with Be-rolls, N 35E, 21W

.55 end of Becraft outcrop - Onondaga bed about  
.60 " " " bed flat - both in Becraft  
.75 ls. in road - just exp (Tombstone)  
.8 sharp turn to R to cross creek (red in morning)  
- ~~subsequent~~ Tom ls. in right bank on descent  
N35E, 20 W

Back to rd. fork on Salina Cr. - start near rd. Sand  
stone Washer -  
at 0.3 (at turn) - Dts in road gutter

Oct 2 Wednesday

Note - check dist. on ~~map~~ ~~map~~ ~~map~~ ~~map~~ ~~map~~ ~~map~~ ~~map~~ ~~map~~ ~~map~~ ~~map~~  
Wedge ~~bed~~ ~~bed~~ ~~bed~~ ~~bed~~ ~~bed~~ ~~bed~~ ~~bed~~ ~~bed~~ ~~bed~~ ~~bed~~  
Shady Grove School = 3.45, mile from

200 W. of Holly Brook School ~~contact of Becraft~~  
Onondaga exp. on N. side of road - about  
N35E, 20 W - strike along road about distance  
to West

18

contact of Onondaga chert on ~~road~~ ~~road~~ ~~road~~ ~~road~~ ~~road~~ ~~road~~ ~~road~~ ~~road~~ ~~road~~ ~~road~~  
exp along road beyond Holly Brook School  
when rd. turns N to Holly Brook. ~~Bed~~  
layers of Onondaga are ~~granular~~ ~~granular~~ ~~granular~~ ~~granular~~ ~~granular~~ ~~granular~~ ~~granular~~ ~~granular~~ ~~granular~~ ~~granular~~  
eg. beds appear N 25 W ± 5 W - the  
chert - ss. appear ~~near~~ ~~near~~ ~~near~~ ~~near~~ ~~near~~ ~~near~~ ~~near~~ ~~near~~ ~~near~~ ~~near~~

Onondaga chert

- 18 a' non-glaucous sh ——— 1'6"
- glaucous sh ——— 1'
- ss, probably Beeroff ———

19 - leveled 54' of the same Holy Brook sh.  
N40W, 2W - indicated by ss - fault  
 to the right in 40 feet above road  
 - heavy chert flint above fault to outcrop

2.00 Entrance - road to Stange Wood's Mine  
 1.60 '5' pt - (shot 4' at job above washer)  
 takes fire tract 500 ft here  
 7.5 - road leads to L - column stands which  
 toward Lookout tower

4.15 Lookout tower  
 0.10 ss (clay sh) - see to tower, N57W, 10W - fine  
 flint near tower probably Clinton - outcropping  
 almost a hard layer up to 4' in thickness  
 - small pure white quartz ss

0.05 Heavy Clinton ferrug flint (ferrug ss)  
 .20 " white ss. flint + some ferrug ss  
 .50 " " ± " " + small pieces Clinton ss  
 .60 " " " " " + small pieces to L-take  
 { .6+ narrow massed clard  
 { .7+ - end ss. road of spring - (ss) small  
 flint in ferrug red ss - clay below

- 0.65 - road to R - take it → 0.00 L to R
- 0.70 - passing flood. heavy to 0.8
- 1.20 - road fork - take fire trail 5405  
to L - this junction almost den  
N of Lookout tower
- 3.70 - road W of " " on slope +  
Wolf Creek NW
- 4.9 - are back to Strongy Mountain  
follow river to crest of Wolf Creek NW
- 10.6 - have crossed creek to N side
- 11.25 - see trail to 2009 (now stayed  
on N side on crest of mt)
- 11.70 - passing some AI section Clinton  
Chick + Sumatra?
- 12.10 - into Martindale?
- 13.4 - into old mountain?
- over big saddle older den
- 15.3 - ford Wolf Creek
- 16.9 - cross RR
- 20.7 - Highway (US 21) to Rocky Gap

Oct 3 Thursday

- See Tower on Flat Top Mt. to Strongy Washer
- 0.00 Tower - climb to top of hill to W of tower
- .65 West of mt fire trail take off to R.
- .7+ Heavy Clinton passing flood
- .85 " " " " (some rocks)
- .95 over hill " " " heavy to heavy ahead 39  
to 1.3



Clinton Survey - on 11/17

- 1.8 ~~N 20 E, 20 W~~ - later white ss, some quartz  
some are stained
- 3.2 low point - about above
- 3.35 decalcified gravel (cut about distance to it) - much  
white ss. float - probably lower Clinton
- 3.8 at sharp turn to E. - Becraft sand with Mn. in  
road gutter.
- 3.85 small near sandstone chert near rd.  
- probably still in Becraft, however, - chert was  
more abundant above the Becraft exposure  
almost continuously to 3.85 mi.
- 4.35 Turn right, ascending
- 4.60<sup>±</sup> - 4.75 - Becraft exposed in road gutter to summit  
of small hill - N 30 E, 25 W at 4.75 - no ss  
seen - chert very present?  
Now 4.75 just beyond hill - chert float  
abundant
- 4.8 chert float abundant but appear to be still in  
Becraft - Repulse in ss. float
- 4.85 gate - still in Becraft, but some  
4.9 crest
- 4.95 Becraft ss. outcrop in rd + gutter
- 5.2 N 20 E, 11 W Becraft in rd + gutter, Repulse  
in gutter in large blocks
- 5.2+ N 35 E, 20 W (11-15) cut across summit  
exposed ss - rd here leads SE for short way
- 5.3 NE end of hill on R (see map) - massive  
outcrop Becraft below here + 5.6
- 6.55 low pt. - almost continuous exposure  
Becraft along rd to here + to 6.6

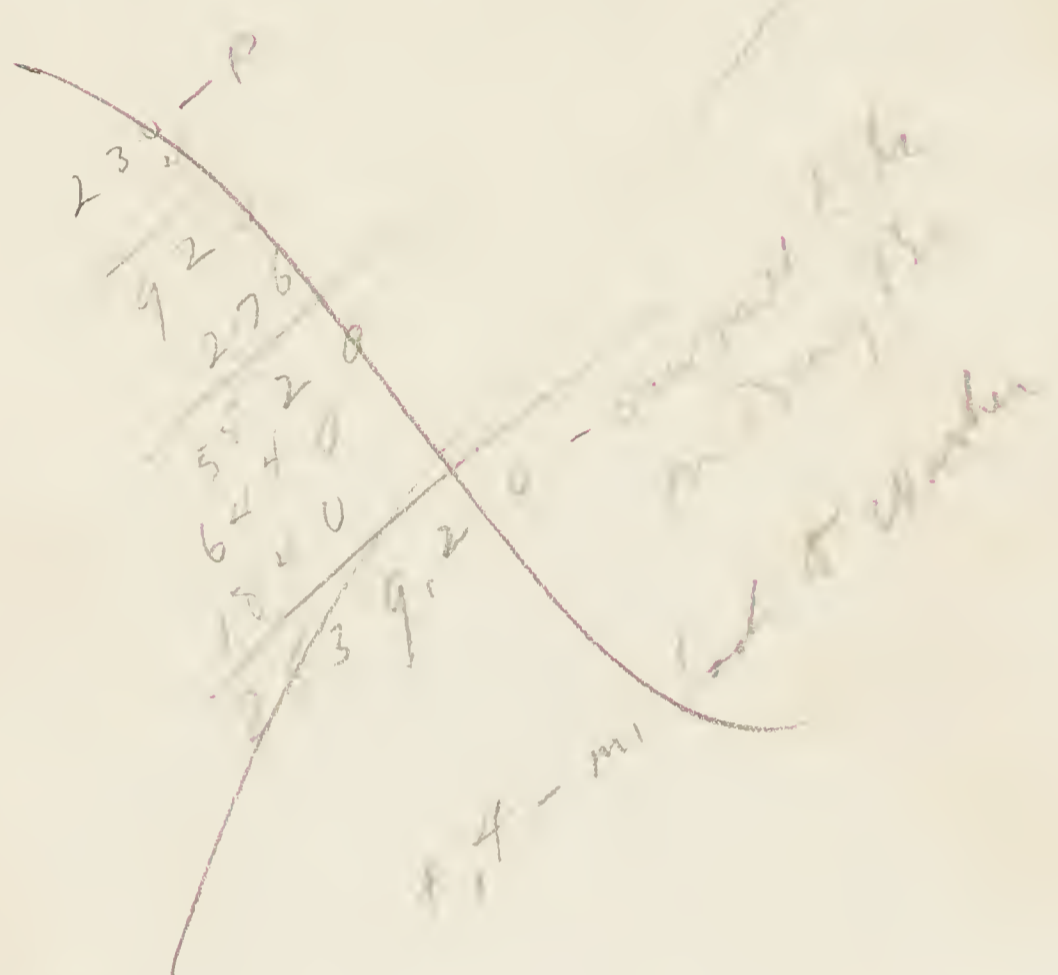

6.65 - 6.95 Recross N.E., 18W  
 7.0 " " + on to 7.25; also at 7.4  
 7.7 = Abs  
 7.5

6.65-6.95 *Basalt* N15E, 18W  
 7.0 " " + on to 7.25; also at 7.4  
 7.7 = Dls  
 7.8 = washer - heavy layer ± hor. glauconite in  
 interstices on W side of washer

7.25  
 SW  
 Loc. on R bank Dwyg Pt (see map)  
 16-28' above stream. (Nearly hor.  
 E-W ± 6, W. to N 25W, 4W).

- glauconite sandstone outcrop close to stream  
 water + along edge of valley on margin  
 of escarp. cf. cemented by iron oxide - note  
 that the ss. contain ss., chert and shale  
 - evidently a comparatively recent terrace deposit  
 or something of the sort - ~~partly breccia~~

October 4 - Sunday  
 Waverly-dome Church to edge of shale - ascending  
 Wadsworth Pt

5.00 Shaded

.25 - Dls - N5W, 6W  
 .40 - " N45E, 2W  
 .65 - " N15E, 9W  
 .90 - " see rd to R takes off here  
 1.20 - " N70E, 10N, same thin here (incl. fault) in E  
 see rd to R takes off  
 1.65 - " fault section on road cut  
 2.35 - " N45E, 35E  
 2.70 - " N60E, 70E in yellow layer, etc.

21.4  
 4  
 ---  
 868  
 276  
 ---  
 5208  
 6076  
 1736  
 ---  
 2398.68  
 2089  
 ---  
 208.6

28  
 12  
 ---  
 276  
 672  
 768  
 ---  
 22  
 308

to an unworked gully

28 x 4p = 208' SE, rd.

below main line

1655 N - in mt. back creek

at 59 x 4p - 208' = one - mostly bedded

8' heavy bedded gravel - 18' on left bank

$$\begin{array}{r} 2396 \\ 2309 \\ \hline 2086 \end{array}$$

to Warrenton gully

= 2056' SE of rd.

28 x 4 p. below main line

- V65 = 5 N - li. on rd. back creek

- at 59 x 4 p. - more or less - mostly bedded

- 8' heavy bedded grey ss. on left bank  
 ' above creek - layers up to 6" - small  
 con. below most filled - spring formerly  
 close to entrance  
 - spring comes out just into  
 contact of li. + ss.

17 - 42 li.

20 7-17 ss. - Clinton? (corrupt sample -

0-7 - covered

- creek

- The locality 2345' SE of road

N 1430 1/2 p. - lower main pit - 25-30 con

shipped - opened 1926 + worked off on

until 1937 - discovery of the Warrenton ss.

- low grade - must not

N 65 E, dip up to 25 N - on apparently

related to bed

N 157 1/4 = 3rd group

N 217 1/4 - rd

N55E, 55 W - Rediff corner on main Meridian  
 - old in right direction + a small 'successful'  
 (and) shot in success - a corner of 2' on the  
 that from low ridge & 1' curb

(now being opened by Laffer)  
 Old Taylor mine, - shipped 7-8 car loads  
 after work - 3-4 times more being opened - in  
 building a house & log cabin house

Pace	Direction	Remarks
0	N 40 W	Pit #1
50 (178)	N 60 W	" #2
200 (414)	N 70 W	" #3
355 (428)	"	" #4 - Small pit - 100' esp. in road low to E?
390 (497)	N 75 W	edge #4 - steps down
435 (544)	N 40 W	
513 (215)	N 10 E	Pit #5 small pit - in road - steps down
570 (157)	N 30 W	

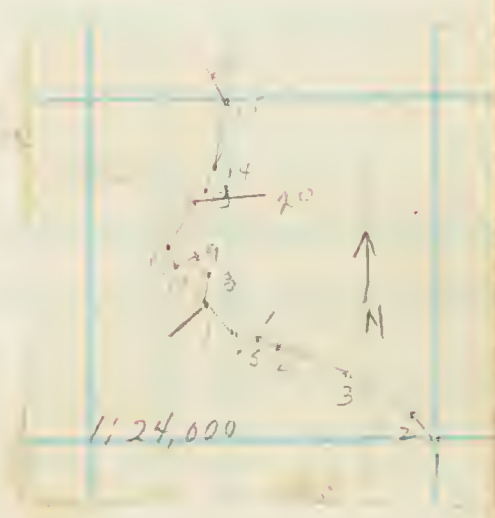

9) 615 (24) 270W

10) 665 (130) N30W

11) 708 (119) N85E

12) 720 (308) "

from N27W. see sketch  
or see of N85E SWN.  
~~probably Do Clinton~~

13) 850 (93) N25E

14) 900 (138) N10E

15) 1040 (37) N30W

16) 1100 (165) Ord - look at  $\pm$  road to house

10300 SWW at H - N of (Wilmington?)

Oct 2 - Estacion

21

Very good indication by pits at <sup>(2)</sup> on east of hill. of sand on lower level. It certainly indicates that most like B. 2nd floor - it contains some small pebbles but mostly sh. - it is fairly rounded with some. Some of the pebbles are definitely rounded or by stream action - this, therefore, must be a fairly young deposit - the remainder on former stream bed. There are boulders on the east of hill

Quartzite about 5' thick or a little  
of sh. little later summit - about 10'  
or 12' up hill - with sh. below it  
sh. at top. Not sure about the  
quartzite.

At point <sup>500'</sup> up hill <sup>North</sup> of Morris <sup>High</sup> sh. is  
cut (vertical face) from west of hill to be  
strongly disturbed - on point reads  
N 65° E 35° E but smooth just above the  
quartzite in on floor - here again  
holding up much of hill.

22 Quartzite a sandy + glaucous. If a  
part close to sh. slung in soft + very  
glaucous (22) This is somewhat  
at least 1 1/2' of less glaucous sand  
23 rock. N 40° E 20° W on quartzite has  
thin sh. in it and cut quartzite to some  
extent to SW - the hill cut simply a  
about hogback.

N 40° E, 20° W - Duffett sand within 2' of quartzite  
near end hill 1/2 between Morris here -  
in to SW - this probably is sand right  
down the water.

Quartzite layers are cherty beds this may or  
may not be Don. - grade directly into type Db. #5





24

~~2~~ on ground opp. above here  
 see actually Db on it east above *Leptocarpus*  
 - *Spirifer* fine layers beneath " "  
 - rock cyclic, X-bedded, fine-grained, many.  
 - judging, sharp change in dip  
 rock is faulted down valley - possibly  
 X-faulted through gaps where road runs

Massive part

Ex 14 N 85 W, 35 S Db - part - also fine  
 - fault - opening of *Leptocarpus* zone  
 - *Spirifer* part of *Leptocarpus* - water trough

3 mi above bridge NE of Mass. line. In a hill -  
 good exp - N 15 E, 30 E - may not be in place

at Mt. Pleasant. *Leptocarpus* zone still in  
 middle - mostly north, in part dip

25

25' of shaly ls (all early *Oriskany* zone - *Oriskany*)  
 exposed on Mt. Pleasant creek below hill -  
 some of this is *Oriskany* with *Oriskany*. *Oriskany*  
 end always weathered to clay - N 75 E, 30 N -  
 downstream further north at creek level  
 lies N 75 E, 30 N (good reading)

0.2 *Oriskany* sand long cut - path

0.5 near Blankenship road at

276  
 120  
 ---  
 5520  
 276  
 ---  
 331.20

Oct. 8

Tuesday

Note: lowest of Onondaga sections on NW  
 side of East River Mt. in last run to date  
 + should be measured bed-by-bed. Can find  
 no evidence of glauconitic layers in this  
 section but it does contain ss. + shaly  
 layers in addition to chert. Chert is somewhat  
 spotty in lower part. Rock has highly ferrug.  
 + seems to contain a little Mn. Exact contact

Oct. 8

Tuesday

Note: Several of Onondaga sections on NW  
 side of East Side Lake in last run to date  
 + would be measured today. We can find  
 no evidence of glauconitic layers in the  
 section but it does contain some shaly  
 layers in addition to chert. Chert is somewhat  
 spotty in some parts. Rock has highly porous  
 + some it contains a little Mn. Good contact  
 between Onondaga + Berap had to show in  
 some places in some of them. Onondaga  
 suggests Berap. But to limit Berap  
 to thick fossiliferous layers - all chert +  
 some ss. in Onondaga. Glauconitic  
 layers less close to base of Onondaga but  
 not actually at contact.

Oct 9

Wednesday

26 } Wm O. Wright - 1 coll. Aspidoceras  
 from Berap, flock near  
 house.

Trench up west of shaly Berap

5 - Berap top, left side of lake

60 - " in L. bank, massive layers of ss  
 with (Asp. decurva) - 3° up slope of rise  
 to south end, above stream - 1/2 mi. distant  
 just above here - 1/2 mi. above - see below

85 = Db in stream, N 55 E, 7 N ←

120 Db " " N 34 W. 21 E

276  
 130  
 5280  
 276  
 358.80

280  
 276  
 1650  
 1960  
 200  
 792.80

23.6  
 2.76  
 1108  
 1638  
 468  
 645.52

185  
 276  
 110  
 1195  
 290  
 590.60



Face  
 130 Dk soil near N75E, 12 N x 5 1/2  
 (=360'  
 150 ~~150~~ 3' above stream on L bank, ~~just below~~ 14' upst.  
 185 45 on left side of small stream ~~from~~

2.00  
14  
16  
6  
3  
4  
5  
0.00

1.0  
19  
12  
3  
10  
5  
1  
2  
6  
0



Face

{ 130  
= 360'

Dr. in stream N75E, 12 N x 50 to 125

163

Top 3' dip down - L bank, ~~at base of~~ ~~ridge~~

{ 150  
= 100'

Dr. on left side of small quarry ~~at base of~~  
N78E, 96 S ~~at base of~~

{ 237  
= 645'

Clinton ss. in <sup>4'</sup> ripple-forming ledge across stream  
N68E, 94 S

{ 250  
= 700'

Good exp. ripple marked Clinton in stream  
N35E 8N. Can see the top of ~~the~~ quarry  
come in exp. over the Clinton

{ 280  
= 775'

top exp. ~~the~~ quarry

exp. - top of ~~the~~ ~~quarry~~ of hills

[at about 350 ft. back from road  
reversed in dip - probably due to slump. The  
Clinton section which is back of road  
is off - N5E, 10 W]

high with  
11 ft. ✓

3 mi. N. of Holly Grove Clinton - Tom. contact  
exposed in bank 3' above Clinton in  
creek bed just below ford N20E, 15 W  
- down to top of quarry in left bank creek  
below Ford - for 40' above creek - exp.  
primary in contact

276  
 6  
 16  
 6  
 18.2

6.5  
 St. ~~Green~~ ~~Don~~ at about 1/2 N of Honey Creek  
 rec N10W, 35°

Db at 2.0 mi. from top of ~~Flint~~ ~~top~~

N10W 21W  
 2.05 = road junction

2.45 = 5 pits

St. (partly) Don at about 1/2 N of Hwy 200  
near N10W, 35W

Db at 2.0 m. Top of Fld. top  
N10W, 20W  
2.05 = road junction  
2.45 = spits  
Thru.

Don (of. 20) - head, ± hor at stage marker  
- D = below water + main Db area

Turn up Ding B. for Bl. road. Below house

Db N45W, 20W - thin sand sh. in creek

at just below marker

At stage marker (i.e. creek to loading platform) Db with Asperdocum in exp ± hor (at loading plat. Don - gl. in exp) - about 25' exp.

In creek at house there is Don N15W, 25W. which shows in sparsely faulted for hill summit south. On the hill Becraft outcrop 25' above (S10E of house) creek (N20E, 35W) + Dnd sh. at level 45' above creek (N40W, 15W) - outcrop S10E of house

N 22 E  
12 NW

\*  
N 43 E  
12 NW

0.00 Lv. rd  
.25 washer  
.40 sand R (Dbe)  
.50 " " L (2)  
1.15  
1.55 5 pl



0,00 - road  
 .25 washer  
 .40 road - R (Db)  
 .50 " " L (2)  
 1.00 road  
 1.55 5 plz

✓ 150 road 5 plz on line of Db N 50-20 W (low  
 in most places) - attitude var. due to minor  
 folding or fracturing.

Sat  
 Distal  
 1958

✓ 150 from 5 plz - road to washer - Db  
 N25W, 20W

- ✓ .25 Db N15E, 15W
- ✓ .30 " N15W, 10N? - good along
- ✓ .40 " N25W, 20N? - " "
- ✓ .45 dip up to 35-40 + Don contact  
 - on Don for 50p then back to  
 Db
- ✓ N25W, 20W at 45+ plz
- ✓ N25W, 35N " 5 "

✓ .55 Db N10W, 15W for 30p then Don  
 at for 20p

✓ .60 N25W, 20W - Db

- ✓ { .75 look - check for 70p + beginning
- ✓ { 7 + - ends N-S ± 15W ±
- ✓ .95 side to R - fresh Db in rd gutter
- 1,00 Dbs N70E, 50S

276  
 290  
 118  
 32  
 802.0

276  
 260  
 6.6  
 5.2  
 74.8

276  
 20  
 10.43

1.05 Dbc high 6-5+ but var. (has front fork, taking 4)

1.2 washer - loading platform

Don <sup>N22E</sup> N22E, 2 1/2 W. 1/2 NW 1/4 Sec 10, T12N, R10W

1.05 lbs high to 5th hole near (from ground  
fork, taking 4)

1.2 washer loading platform

---

		* N22E
Don	N43E	12 NW, 10 NW, 10 NW
0		S25W
10		S70W
30	50	S78W (to center)
40	310	S72W (to center)
50	610	cm

276  
 140  
 ---  
 110  
 20

120  
 180  
 ---  
 300

216  
 100  
 ---  
 116

50  
 100  
 ---  
 150

160  
 100  
 ---  
 260

100  
 100  
 ---  
 200

200  
 100  
 ---  
 300

200  
 100  
 ---  
 300

Oct. 11

Friday

Trav. near D6 & Don. N. of Wausau, Wis.

- 0 N65W Small piece D6 - flat
- 50 N85W " " " - flat - Don -
- 100 N50W D6 has become heavier in gully
- 140 N70W Heavy D6

Oct 11 Sunday

Transect 16 - Don NW of Woodland Ch

0 N65W Small piece Db - lost

50 N85W " " " - note Don -

100 N50W Db has become heavier as gully

140 N70W Naming Db

260 N45W Mostly smaller Db - some Don

280 " Edge Don belt

300 N65W

335 " (note: 50-100) - before gully  
up the hill to steeper slope  
- no sand/silt apparent here  
Don belt under here

340 N65W

365 S60W

+ 800 car

← E-W transect at pt south of Faulkner Hollow

0 S70W Don N55W ± 10 ± 5 - 15' ±  
in 1/2 mile radius

120 S75W

✓ 140 W Don N10E, 15 ± W - good crop  
on hill gully

192 " Don N30E, 20 W

270  
270

53  
108  
46

1380  
23450

270  
186  
270  
270

55  
55  
55  
55

1380  
23450

215	575W
315	55W
360	540W
115	

210 575W  
 370 555W  
 360 540W  
 413 car

0.00 Lv. main Rd.  
 0.25 Washer  
 0.35 Dls. (where upper Red zone is)  
 0.45 " (double cut to L to car valley)  
 45' of road cut ~~-----~~

Oct. 12

Saturday  
 Thursday - Correr Hole

- ✓ 0 Don in L bank N70W, 25
- ✓ 50 " " R " - 15' above st.
- ✓ 126 " " " " " " " N80W, 25
- ✓ 163 Db with Asp. <sup>to 8' above</sup>  
 This hole <sup>L bank</sup> <sub>at</sub> <sup>15'</sup> <sub>above creek</sub> <sup>N70W</sup> <sub>at</sub> <sup>75'</sup> <sub>above creek</sub> <sup>15'</sup> <sub>above creek</sub> <sup>15'</sup> <sub>above creek</sub>
- ✓ 199 Db like last but N70W, 7N - L bank  
 15' above cr.
- ✓ 230 Db in Rbk - 5-75' above N75W, 10S - no quartz  
 as to this being in place 53

$$\begin{array}{r} 276 \\ 1010 \\ \hline 2760 \\ 2760 \\ \hline 2987.60 \end{array}$$

$$\begin{array}{r} 276 \\ 1010 \\ \hline 2760 \\ 2760 \\ \hline 2987.60 \end{array}$$

$$\begin{array}{r} 276 \\ 137 \\ \hline 1732 \end{array}$$

276  
 1010  
 2760  
 2760  
 2987.60

$$\begin{array}{r} 276 \\ 1010 \\ \hline 2760 \\ 2760 \\ \hline 2987.60 \end{array}$$

- 280 - Db apps in pt. att. similar to last month only 3 items
- 308 - Db on left bank of St. Louis
- 342 - Db



280 - Db app. in place, att. similar  
to last more only 3' or so up

308 - Db in left bank at st. level

342 - Db " " " " " "

348 - Spring issue - little less SW

✓ 712 Don SE 20-30' 6' 1/2 - good cap. clay  
5' or so thick

✓ 514 Don N50W 1/2 low to 3' 1/2 in cl

720 Ca. to St. [more on Dbs]

11/2 - recorded Ca W of Thompson hollow -  
on Dbs. Don Db to St. level. This creek  
has several gaps in rocky bottom  
flow is augmented by numerous small  
springs giving large areas of soggy  
ground

	<u>Pace.</u>	<u>Dir</u>	<u>Remarks</u>
27 ✓	0	S30E	Towardly to NSW, 7W (into steep valley with - 0.5' - well bedded - unconformable in blue - having layers 1' + thick - no for. (could this be [?]) up Db hill Db - 20' above Cr - att. [?] N50W, S30E [?]
	112		
	137		

$$\begin{array}{r} 1010 \\ 220 \\ \hline 220 \end{array}$$

$$\begin{array}{r} 210 \\ 210 \\ \hline 420 \end{array}$$

$$\begin{array}{r} 1010 \\ 520 \\ \hline 256 \end{array}$$

$$\begin{array}{r} 276 \\ 520 \\ \hline 1102 \end{array}$$

$$\begin{array}{r} 1010 \\ 520 \\ \hline 256 \\ 406 \\ \hline 1656 \\ 220 \\ \hline 1104 \\ 1104 \\ \hline 2208 \end{array}$$

$$\begin{array}{r} 276 \\ 520 \\ \hline 1102 \\ 552 \\ \hline 1380 \\ 462 \\ \hline 1380 \end{array}$$

$$\begin{array}{r} 276 \\ 520 \\ \hline 1102 \\ 552 \\ \hline 1380 \\ 462 \\ \hline 1380 \end{array}$$

$$\begin{array}{r} 276 \\ 520 \\ \hline 1102 \\ 552 \\ \hline 1380 \\ 462 \\ \hline 1380 \end{array}$$

163 By blocks to the stream  
 314 Heavy to rock  
 342 Spring  
 435 to (to) probably a place under  
 water in pool  
 480 Large blocks to - no chert flat

21  
 22  
 23  
 24  
 25  
 26  
 27  
 28  
 29  
 30  
 31  
 32  
 33  
 34  
 35  
 36  
 37  
 38  
 39  
 40  
 41  
 42  
 43  
 44  
 45  
 46  
 47  
 48  
 49  
 50  
 51  
 52  
 53  
 54  
 55  
 56  
 57  
 58  
 59  
 60  
 61  
 62  
 63  
 64  
 65  
 66  
 67  
 68  
 69  
 70  
 71  
 72  
 73  
 74  
 75  
 76  
 77  
 78  
 79  
 80  
 81  
 82  
 83  
 84  
 85  
 86  
 87  
 88  
 89  
 90  
 91  
 92  
 93  
 94  
 95  
 96  
 97  
 98  
 99  
 100

163 In bluffs high of stream  
 314 Heavy db floor  
 342 Spring  
 435 In (SS) probably in place under  
 water in pool  
 480 Large blocks db - no chert floor  
 524 chert floor appears  
 720 Don N45E, 45S L. Hk  
 1010 SS

✓ 71 Monday Thompson Mt. road  
 C J - Clinton N42W, 25 - in creek  
 slightly ferrug - in place N65W, 5S  
 ✓ 148 db - ~~floor~~, in place N65W, 5S  
 ✓ 378 Tuesday to N75E 20S  
 783 upper basin - late db - 200 - Don  
 floor has chert

Handwritten notes and calculations, including numbers like 1.96, 2.20, 2.10, 2.00, 1.80, 1.70, 1.60, 1.50, 1.40, 1.30, 1.20, 1.10, 1.00, 0.90, 0.80, 0.70, 0.60, 0.50, 0.40, 0.30, 0.20, 0.10, 0.00, and various mathematical symbols and lines.

Traverse ridge at 4 Thompson Rd  
1 - Db flat (near) with Alpedocum  
4) Don n. long - probably in Don

Traverse ridge at Thompson Hill

5 - Db flat (new) with Alpedococcus

60 Don in large - probably on Don

62 " - in place?

200 " - " - abundant flat trees

233 " - over with heavy shrub

✓ 275 " " " " " - turn ~~over~~

300 " - turn S 25 W

390 Don in place?

✓ 460 " turn S 10 E

- 562 present at Don where say + Db about 1000  
turn S 5 W

✓ 785 RA

275  
 370  
 248.75  
 228

276  
 420  
 276  
 144

276  
 276  
 276  
 276

276  
 138  
 276  
 138

276  
 276  
 276

276  
 276  
 276  
 276

276  
 580  
 2280  
 1380  
 1608.00

276  
 138  
 276  
 138

276  
 276  
 276  
 276

276  
 276  
 276

276  
 276  
 276  
 276

Diameter of stone bridge at .8

Dist	Dist	Station	Notes
0	E	Station	<u>N20E 56</u>
15	360E	"	<u>N33E 146</u>
150	520W	"	<u>N55E 56</u>
200	"	"	good rough marker
250	"	"	<u>N40W 103</u>
300	560E	"	<u>E-W, 251</u>
350	800E	"	<u>N70E - 5 - 1 - 22</u>

X

321  
 215  
 358

Dipmat Cr above bridge st. 8

Dist	Dir	Notes	Dip
0	E	Chert	<u>N21E 5W</u>
75	S60E	"	<u>N35E 14W</u>
150	S20W	"	<u>N15E 5W</u>
200	"	"	-good ripple marks
250	"	"	<u>N40W 10W</u>
300	S40E	"	<u>E-W 25</u> (ripple marks)
350	S55E	"	<u>N70E 5S</u> in 2 1/2' zone
425	S35E	"	<u>E-W 10S</u> (ripple marks)
490	S	"	<u>N85E 13S</u>
542	"	"	" 235 ripple marks
565	"	"	<u>" 60S</u>
580	- Bridge		

360	130	<u>N80E 10S</u> - ripple marks Fe Mn? Db #
SW	187	<u>N65E 21S</u>
1070	390	<u>St. E-W 14S</u>
	616	(see page)
	830	- turning SW
	840	- St. <u>N75E 19S</u>
	900	all to 930±
	1000	
	1105	Db <u>N55E 20S</u>

135  
 4  
 18  
 5  
 6  
 4  
 3  
 2  
 276  
 138  
 8  
 2  
 11  
 12  
 0  
 6  
 0

1170 N65W 118 Db

1220 Db (app. to corner) N15W, 13W  
 one explain variable

1230 Bump. Db same corner  
 check on in separate direction



1170 N65W, 22E Db

1220 Db. Aspidotheca N15W, 13W  
no explain variable

1230 Budge - Db from under  
chert on a spite of irregularity

Oct 45 Tuesday

Returned to base of Duane Cr - 200  
exp 200 to 100 ft below chert - beds then  
covered mostly for 197 ft - then beds on  
each bed bed shown - N-S, 10W

- 1 - 100 - Don

100 - 297 - covered

297 - 300 - Dbs N-S, 10W

308 - cut from R. (Thompson Ho.)

387 - Dbs N60E, 70S

431 Budge

200 ft } 0.00 to 100 ft  
no } 0.80 on Aspidotheca to 4. back (quartz, coal)  
irregularity } 1.10 Aspidotheca level  
1.40 high level  
(for bed below - return)

N70W, 27S, 0.5 mi above Budge

N70W, 11S - Aspidotheca - Lower - D. small

420  
 1131  
 226  
 176  
 126  
 98  
 76  
 54  
 32  
 10  
 270  
 210  
 200  
 190  
 180  
 170  
 160  
 150  
 140  
 130  
 120  
 110  
 100  
 90  
 80  
 70  
 60  
 50  
 40  
 30  
 20  
 10  
 0

corrected  
 on map  
 page  
 less  
 than  
 2.76

near below E of Skatoh Street, (C.M.E.)

- 0 - 5100, Probably on Alt - heavy floor
  - 50 - " " " " " "
  - 100 - " " " " " "
  - 120 - " " " " " "
  - 133 - " " " " " "
- Db N-S 325W - JK?

corrected  
on map  
page 276

From bottom E of Skotch Creek, (31M E)

- 0 - G1000 Probably on Alb - heavy flint
- 50 - " - with shaly - just on top
- 100 - S
- 120 - " - 20' roughly - place with
- 133 - " - D6 N55W - SK?
- 160 S140W
- 210 - heavy Bed level
- 230 G1000
- 305 " - D6 N70W, 55 - 05
- 330 S30W
- 370 S
- 420 S D6 N70W, 55 - 155
- 500 S25W
- 578 S10E
- 590 " - D6 N70E 55
- 650 S18E
- 737 " - D6 N50W 100
- 820 Rd

$$\begin{array}{r} 206 \\ 217 \\ \hline 113 \\ 21 \\ \hline 252 \\ 299 \end{array}$$

$$\begin{array}{r} 3.7 \\ 10.5 \\ \hline 14.2 \end{array}$$

$$\begin{array}{r} 125 \\ 100 \\ \hline 25 \end{array}$$

5500 2000

- NSR 204 - Db on hill above Holly Brook falls  
 - Db near stream to east of hill

Oct '17 Thursday Second River Terrace

2000 2000

- N55E 20% = Db on hill above Holly Brook lake  
Db near summit to crest of hill

Oct 17 Thursday Dismal Basin Traverse

- 0.00 Lv. Summit
- 0.80 cross summit Cr
- 0.90 Sd. N80E 27S
- 1.10 top steep descent
- 1.30 begin descent
- 1.40 low pt
- 1.55 cross trib. on tundra to R. side
- 1.85 cross Dismal Cr. to R. side
- 1.90 rd fork - take L
- 2.10 - " do from R
- 2.10 - cross tundra
- 2.10+ SS, E-SE, 65 (Clinton?) ~~to R. side~~
- 2.20 - high pt
- 2.30 - cross small stream begin steep descent
- 2.65 - abandoned house
- 2.80 - cross trib. - steep descent - high pt
- 3.20 - high pt
- 3.6 - cross mill, cross trib. - N30W, SE - on path to S
- 3.7 - rd fork - take R
- 3.8 - cross Dismal Cr. to L side
- Clinton N70W, SS just beyond Xing - in cut  
- quite a bit remaining both sides cr. here
- 4.35 high pt

4.4 road fork - take L + R - on to  
5.1 on L - no outcrop on  
either road - the area probably  
all chert  $\pm$  hor.  
- Road to 3.7 + take rd north  
? cross on  
0.45 high at

4.4 road fork - take L + R - on to  
5.4 on L - no outcrop on  
either road - the area probably  
all Clinton ± hor.  
- South to 3.7 + take rd north  
7 cross on

0.45 high pt.  
60 - take road as Ct. probably  
looks to take - turn W

50 - Take rd to about spring S  
of rd N45E ±, SW  
Trail E to upper road [trail continues to  
west end of road  
1000 NW Stargel Mine]

0.0 = bc  
0.2 = Db (2 in place)  
0.45 - high pt. - probably Db. - in place?  
0.70 + cross Xing [OK]  
0.8 - all (mostly ss.) in rd ± hor.  
1.0 - junction with Dismal rd.

Oct 18

Friday  
At but E Dismal from W above falls -  
good Clinton section N35E, 12 S

29

- look to Falls to right - noted Clinton  
- climbed hill to S of falls + noted Clinton  
ostracodes, etc. in manganese-iron stained  
Clinton floor 20' below crest of hill + 55'  
below main highest part. (the occurrence is  
in Clinton section in *Geology*, as published)

Handwritten text at the top of the page, possibly a title or header, which is mostly illegible due to fading and bleed-through.

Main body of handwritten text, organized into several columns. The text is extremely faint and difficult to decipher, appearing to be a list or a series of entries.



Bottom section of the page, possibly a separate sheet or a continuation of the text above. It contains faint, illegible markings and appears to be a continuation of the document's content.





