

7530-00-286-6207

FEDERAL SUPPLY SERVICE

(GPO)

1 large tent = 125 MM } 170 ocular
 1 small tent = 125 MM } 475 objective
 Cde vi - 64
 68497 - 64472

Andre: Where can he start the
 application to extend his visa?

Al Newton & wife → to get Staphylinids
 → Field museum

Al Knowles - LSU - Stink Bugs

Scott Miller: 357-2107

Physical Therapy - Thurs. Oct 23
 Mrs. O'Dwyer 2:00PM

Plans for San Pedro Sula

(Wanna to go TACA)

& SACA - TAN

(How) get answer please for

Tel. on bus way

to go to Sanpetula

to find out guidelines

Antonomologist - U.S. N.M.

working on ...

get name

Kathy Schmidt

518 - 325 7265

2008
 1000
 2000

GUATEMALA

Get elevation of Hotel Posada

June 19 to Guatemala City 6:55 AM -

1) altitude - 1510 m. (Unwindy valley)

2) 83 km. 350 meters alt.

2nd Stop - Cactus, Agave & great pasture -

insects: *Amittome* (?) under a stone

Acroplitis in soil fields

+ under HARD-WOOD at camp

Beetles: Under bark of cactus and under large stone

Stop 3 - Stone

Helicoverpa & *Opotenus*
beetles, about 1000

Stop 4 - Pines - ~~at~~ *mercurialis*,
ambrosia & acacia, etc.

Altitude - km. 1000

Stop 5 - 1,905 M - *Liquidambar*

first insect. 1 Termite

① *Laminilla* log - in large pile

Single bottle in large bottle
Barbier's Soln; Stop # (under tail)?

Rio June 21

stop 1. Nm. Sevotaw
alt. 950 m

stop 2
Col. 1 - me
Col. 2 - student
Col. 3 - me

stop 3 - near ~~to~~ Telencan
stung ~~to~~ in pepper field
M. 30. 160 m alt.

Rio Cahabon site alt. 240 m
Many colonies in trap

Rio Cahabon = Int. Junction between Rio Oxec and
Rio Cahabon - Road.

Alejandro May

Images

Im 21 ♀ (N)

K ♀

1st Form Reproductive

Neotenic

Stop -
Stu

Alvarado for
preparation

El Bosque
Tall Bushes
Forest beyond bridge

on right

1 1/2 hrs. north of

Catmaná

Get Empidonax

Biology of Termites
vol. 1 + 2

Edited by Krishna
and Weesner
(Fechleitner)

A

SERRITERMITIDAE

18 feet

to for
of lead

92

from

to

1 1/2

0

12.1

1.00 US = 187 pesos

Mexico

1600 pesos - Airport Tax

39.40 - Plane fare - dollars

2030 pesos - Food, Inc. to Brown
U. Nando

$\Sigma = 3630 \text{ pesos} = 19.41$

12

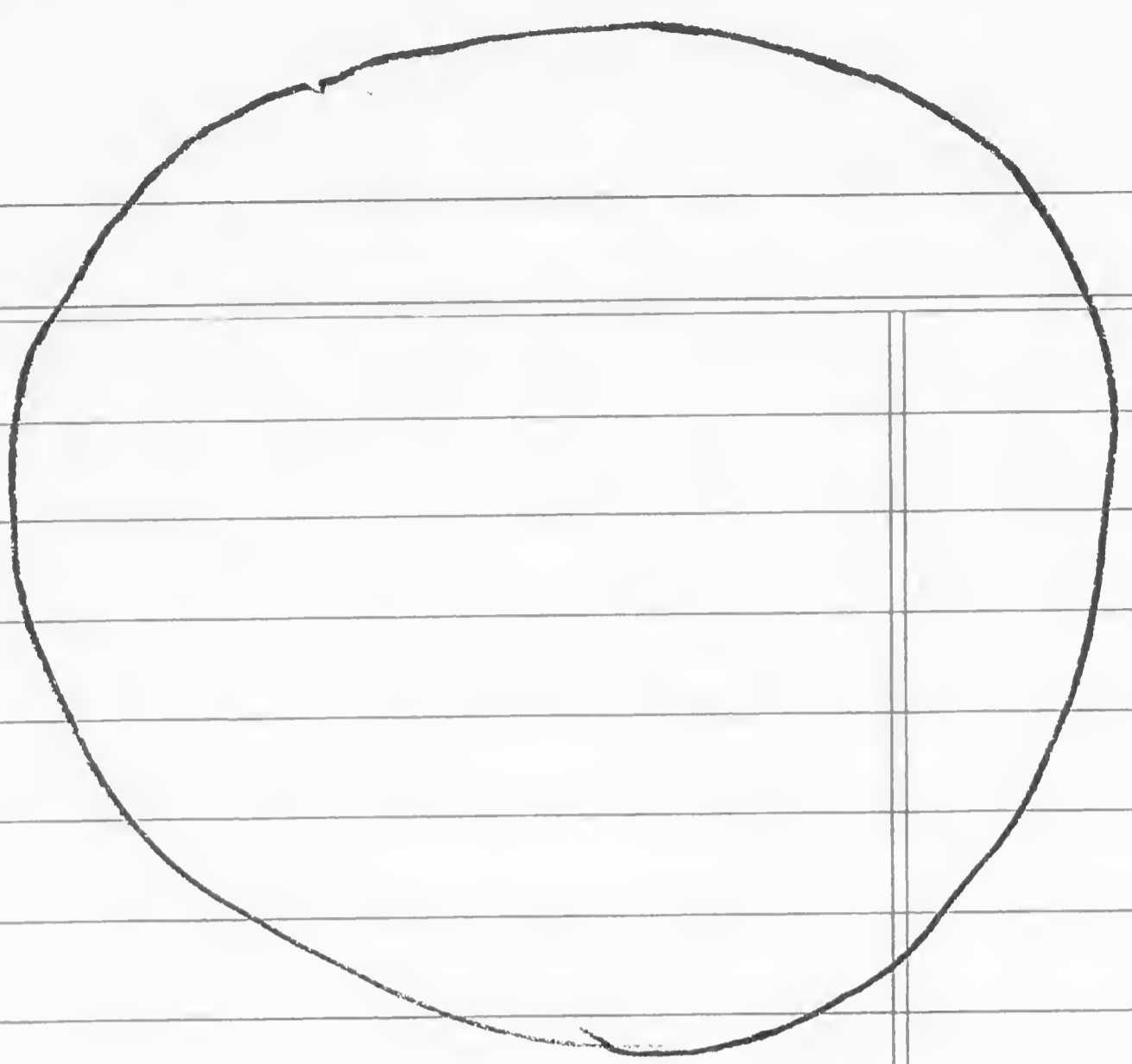

3 m

12

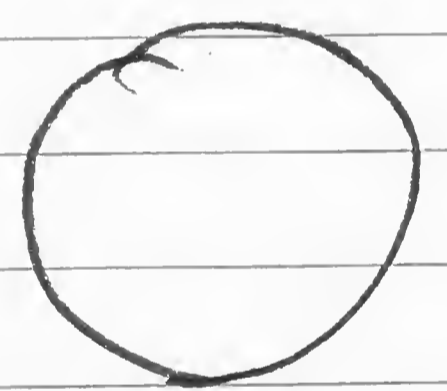

3 m'

Tray

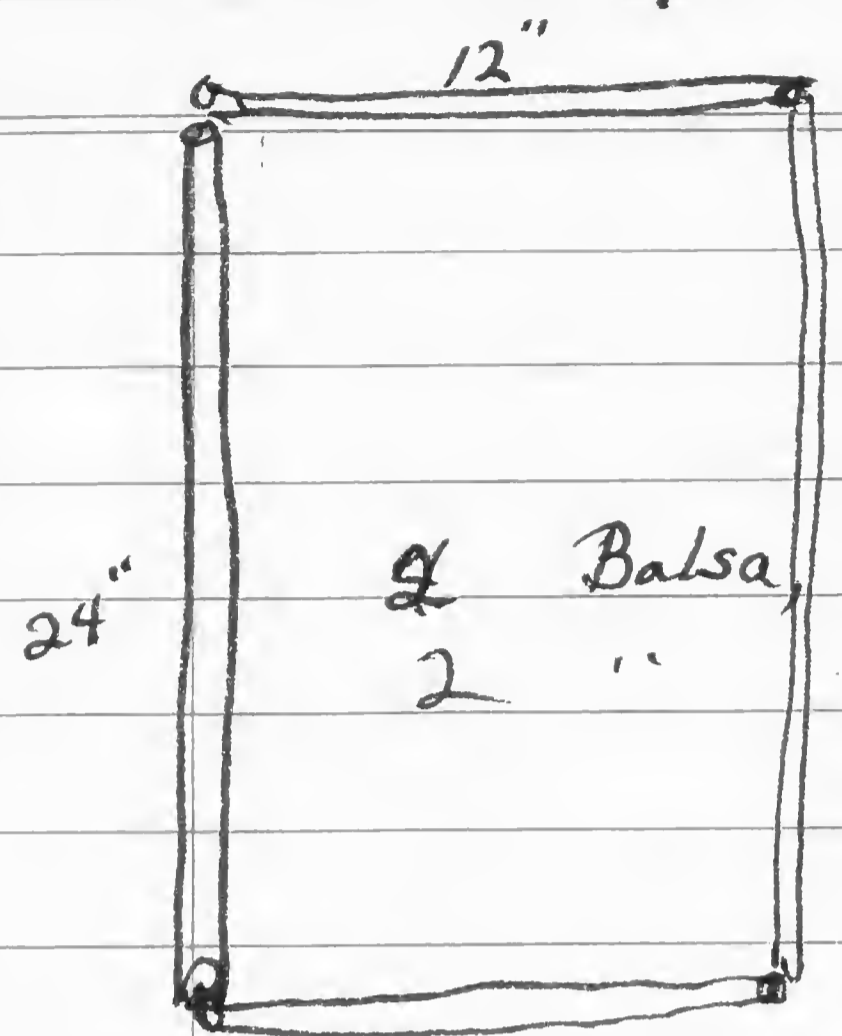

12"

24"

4 Balsa per tray (24")
2 " " " (12")

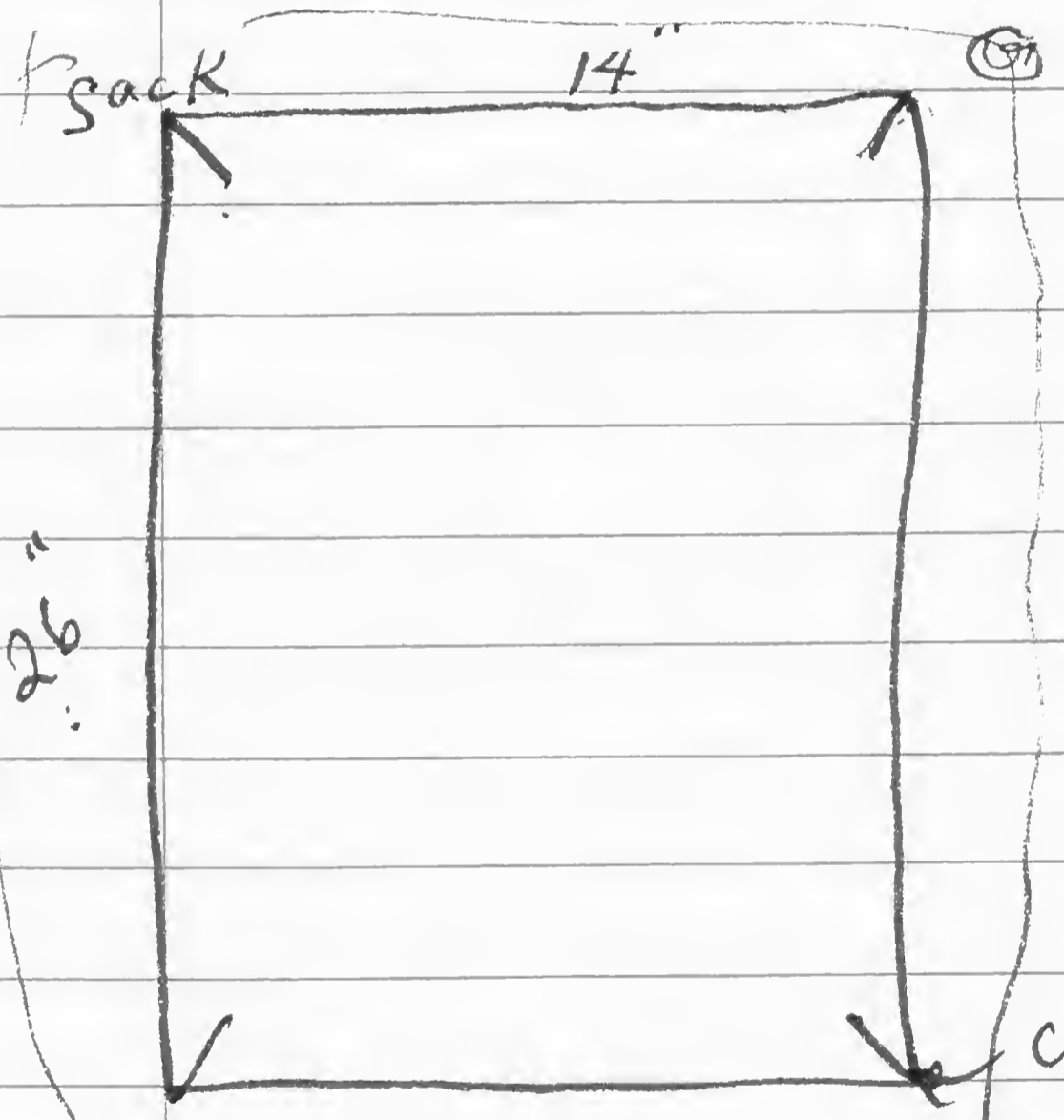

Sack

14"

26"

cut - Roll on balsa sticks - Tack firmly
Leave a well in the center (some slack)

Covers 30" x 18" - sew rocks in the corners - use screen, mosquito netting, curtain material.

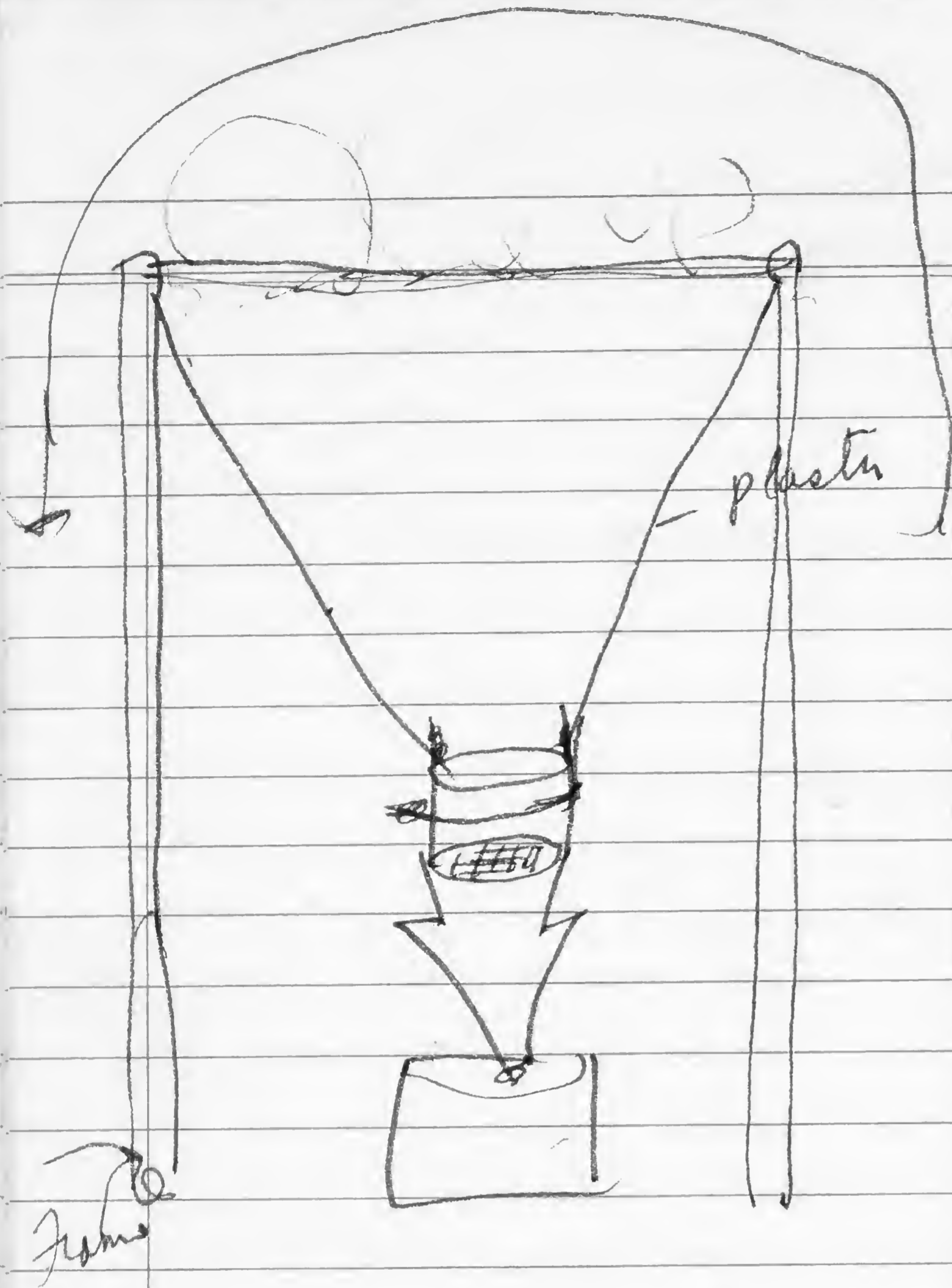

Fund 29462.4
 Start - 26778.0
 2684.4 mi. mileage

Gas, cash & ymb.	Food, Cash	Tolls
10.46	1.65	.75
5.00	12.00	
10.63		
9.23		
10.30		

Tall: .25
 .25
 .10 / In va. going down
 night - Richmond
 Visa 28.55

Florida Trip #3
 Dr. D.C. @ 26778

Gas - Va. Foodmart 26968.0 - 8.868 gal
 Gas @ Saddle Creek - charged to Mastercard
 yogurt + apples - n. Calorie - 1.65

Gas - S.C. Carolina @ 27222.5 mi.
 → 8.4 gal. 10.46 pd. cash

Gas - Brunswick, Ga. - @ 27432.1
 9.86 gal → 11.52

Dec. 7 Lodging - 28⁰⁰ (?) - charged, Mastercard
 Food - 8.95 + Tax + 1.00 Tip - Receipt kept
 Telephone call: 2.00 (on bill, receipt obtained)

Gas - Sebastian Lake, Fla. @ 27696.65
 12 gal. 5⁰⁰ worth (3.9 gal.)
 (1.28 / gal !!!)

Gas south of Ft. Pierce @ 27742.55
 9.20 gal. @ \$10.63

Bernd Gables - 27945.5
 \$9.23 7.765 gal.

Indian River 28211.3
 9.25 gal. \$10.30

Jamestown 28408.15

10 gal. \$12.52

Live Oak Fla - 28650.4
10.7 gal 13.22

Savannah, Ga. 28855.6
9.75 gal. 11.30

Jayhawk, N.C. 7.322 gal
1.23 gal. \$9.00
29136.5

Strong Ridge, Va.
29300.6

\$11.44 9.31 gal \$3.82

Toll 15.5

1.10

2.5

1.25

Breakfast \$3.82

29462.4

Hyperaspis colony - from gullies on
pole in front of hotel ⁵⁰⁰⁰
October

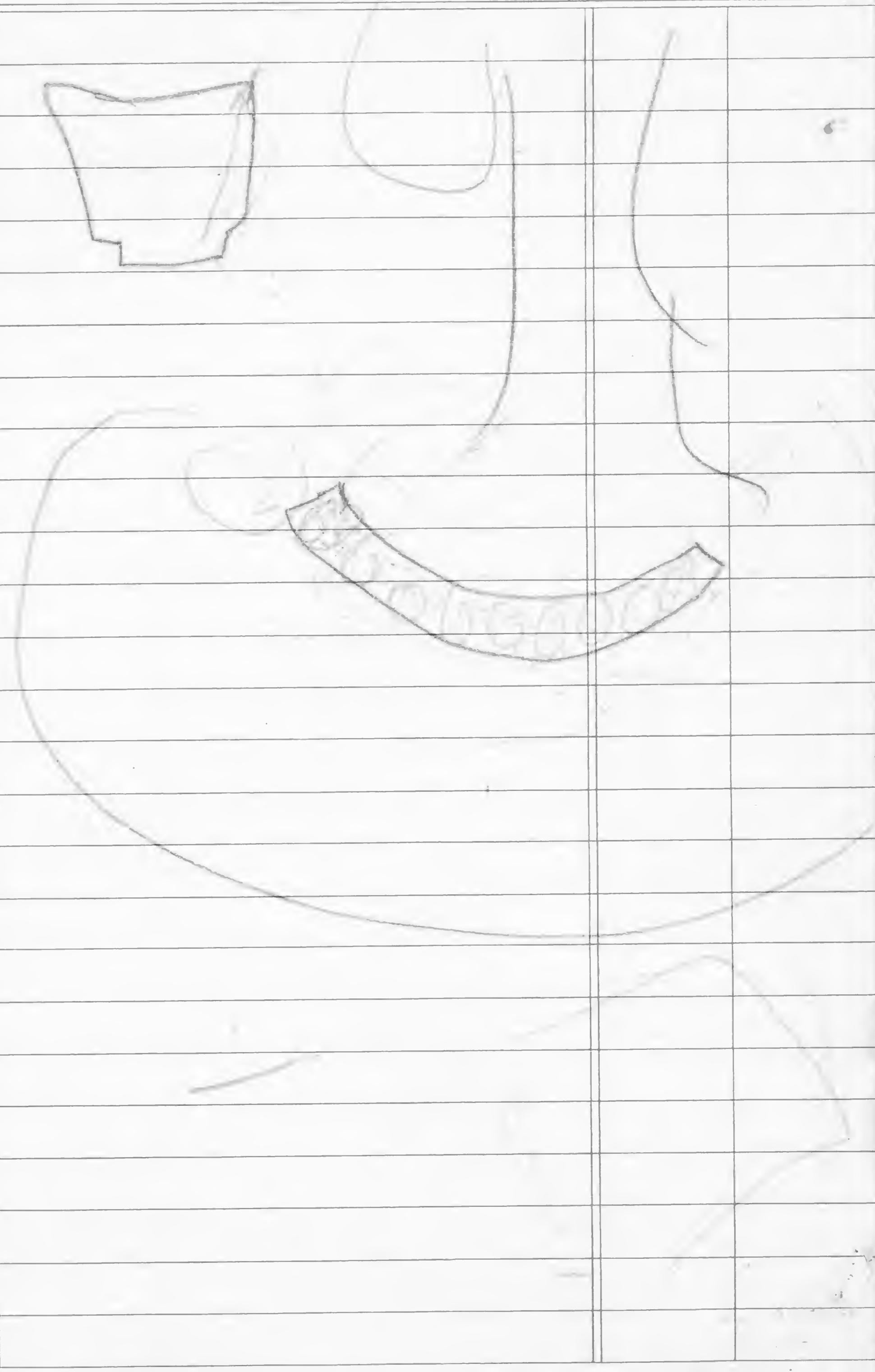
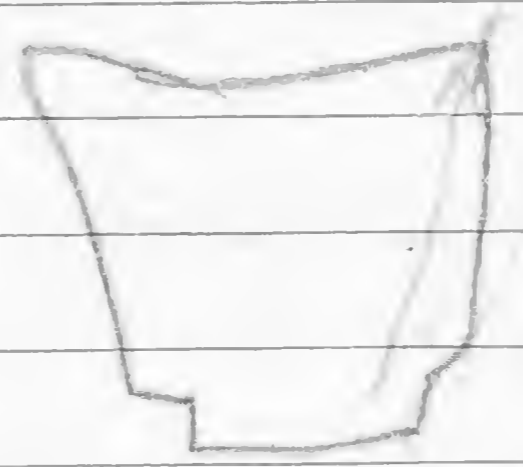

PER-2
rather *Nexastoma* colony - from galleries on
pole in front of stable October
Luis P. ... - 1985

Palmerville (70 km 29)

ca. 1000 - 101. 101.

Saw dead large wasps

nest - 100000 approx.

Nexastoma from fence

Pass - ↓

RB-1

2 large
7 in
interior

in nest on tree trunk
of *Nexastoma* (MSL)

abandoned nest on branch

on side of large tree - 1st trail -

Alates present

(1 advertisement each nasute of queen)

PER-6 - 23 Oct. Large colony nest on
ground approx 2 feet - many
abandoned nests.

PER-7 - Heavy with wasps at base
of tall dead tree - leaf
present - MSL

PER-8 - Nestlings up, attached from wood
and for walls of most around ground
Large cavity nest in tree trunk. Saw
MSL

PER-2
 another *Heterosternus* colony - from galleries on
 pole in front of Hotel ^{Quinta} ~~Hotel~~ ^{October}
 Peru Termita - 1985

made di aliro

Per-1 Oct. 22, 1985 - Partly dead stump on
 grounds of Hotel Termita - Quarta road -
 donada. Ants & termites living in same
 stump. Prot. *Heterosternus*

PER-3 - Oct. 22 - grounds of Explorer Hotel,
 Tambopata - from galleries of dead nest

PER-4 - Oct. 22 - from galleries below large
 damaged but repaired *Eucalyptus* nest on
 tree, grounds, Explorer Hotel, Tambopata
 2, ♀

PER-4A - Oct. 22 - Carton nest on tree, grounds
 of Explorer Hotel, Tambopata

PER-5 - Oct. 23 - Rounded nest on branch
 on side of large tree - 1st trail -
 Alates present
 (1 advertisement each inside of gallery)

PER-6 - 23 Oct. Long carton nest on
 ground up to 2 feet - many
 alates in nest.

PER-7 - Heavy with mound at base
 of buttressed tree - kept
 fresh - MSC

PER-8 - Moundless up, attached to wood
 wall for walls of great mound -
 Long carton nest in Tall mounds
 MSC

PER-12

made di
 aliro

PER-9

PER-10 Oct. 27 1985 Tree nest near garden site, next to walk - Nest harvested for *Leptotyphlops* Im, 2, ♀♀

PER-11 - Carton nest collected from processing - T. Linn - Oct. 30 - Near garden site Tambopata 50' 2/4, many ♀♀, larvae, ♂ Oct. 30, 1985

PER-12 - Carton nest & definite culture shell trail near Exp. Inn - MSC - Nest separated harvested - Prob. *N. surinamensis* 50' 2/4, ♀♀

PER-13 - *Acroplecterus*? sp. - from clay galleon between roots of terminal tree - T. Linn Im, N, 1/2, ♀? up main trail near lodge - Expl. Inn 1 Nov. 1985

PER-14 - *Heterosternus* sp. - from dead wood - small v. section of forest - up main trail near PER-13 1 Nov

PER-15 *Microcerotoma* (?) sp. - thin typical nest on tree beside main trail, near lodge @ Tambopata 1 Nov 1985 MSC - Queen damaged

PER-16 - *Heterosternus* - on small stick or ground - 1 Nov. main trail close to lodge - MSC -

PER-17 - Small nests of *Termitophila* beetle - in ~~some~~ rotting branch beside main trail near lodge - Tambopata - 1 Nov. MSC

PER-18 *Diadema* showing tandem behavior plus two albs. from work tables morning (6:30) of Nov. 2 - Tambopata Nov. 2 - MSC

PER-19 - *Heterosternus* sp. (?) from dead branch beside main trail near lodge @ Tambopata

PER-20 - *Nasutitermes* sp. from dead ~~branch~~ ^{branch} beside main trail near lodge @ Tambopata -

PER-21 - Nasutitermes sp. from dead
palm stump - beside main trail
near lodge, Tambora

PER-22 Soldanella sp. - small
dead stump near main trail near
lodge, Tambora

PER-23 Armitermes sp. - from mud nest in
fence of decaying palm stem with
2 or 3 nests: 1 female shown, which
was empty, but 1st female had
an ant. head - up main trail
near lodge, Tambora
Nest thickly intergrown with roots.
Same?

PER-24 Same as PER-23, further
up - no, no 2/24

PER-25 Phyrgonotus sp. near NN -
hard to see like PER-15 - small
specimens, fine colony present
Tambora

PER-26 Glyptotermes? Alates, no 21 seen -
in rd. damp wood beside main
trail ca. .5 km from lodge
River south to Peta

PER-27 - Small nasute from rotten
log beside main trail - ca. 4 km.
from lodge - Nov. 2

PER-28 Heavy earthen nest in ^{fallen} tree
TINK nasute - up trail .5 km.
from lodge
Nov. 2

Nov. 3 - Sunday - ~~Sunday~~ - RAIN!!

PER-29 - 3 Rest of PER-26? 21, 22, 23, 24
Large perhaps to be taken to
Peta -

PER-30 Neotermes (?) up 21, 22, 23
Main trail towards lake, Tambora
on ground

PER-31 - Mound nest in dry forest
@ Tambora - Armitermes sp. -
Inflated & red: clear photos

PER-32 Snappers - dead stump by
main trail in low forest, Tambora

PER-33 Acronycterus? N, Y, S, Ter
within stump beside main trail
Tambora about sample kept

PER 34a *Lobistoma labialis* - typical
nest on tree, low forest

PER 34b - *Armitia* sp - *Armitia* in
34a? ~~Armitia~~ nest for

PER-35 - Tiny *Kalsternia* ^{same} kept
alive for Peter, some preserved
fairly sound during war

PER-36 TINY *Troglodytes* - under bark
of down tree - main trail

PER-37 - *Coniophanes* *caudatus*
main trail - old under *Calyptra*

in
Flying
erred -
at low
level
near

PER 34 a ♂
nest as

PER 34 b - Am
39 a ? as

PER 35 - Tiny
almost gone
fairly new

PER 36 TINY
down time

PER 37 - Down

Prehens & Preserved

5a

5b 7

9

10

11

12 13a

13b 13c

14a

14b

GT 86-1

↓

Jan. Jan Tinche Airport
second within tree -

Monday - Tinche Airport
Metallic Blue Chrysomelid - Flying -
Cpt. Sandhu
Dried out - None preserved -

GT 86-2 - Mon. - Scraped from
Telephone pole at Tinche
surrounding pole

GT 86-3 - Nest on tree near
Tinche Airport - whole
nest collected

Camp Iguaçu

GT 86-4 - Groppers from partly
cut branch stump beside planted
field, post near compound
(Soldiers all gone by time of picking)

GT 86-5 - ~~None~~ from big branch
No label tree beside tank
in bar - Bay 5, blue
DW

GT 86-6 - ~~None~~
from dead stump beside tank

7 - Camp Jaquar - D.W.

GT86-7 - Rhinotermitid from
leaf branch on live tree

Depth forest: 2nd, 3rd, 4th on
tree, 1st, 2nd, 3rd, 4th
Prob. *Nesocryptus*

GT86-8 - *Doramea* with *capitulum*
pale, a dead stump -
Rhinotermitid

GT86-9 - *D. Wilkesii* - *Capitulum*
live stump

Soldier starts release glue; fought
ant, released glue after contact - *Rhynch.*

GT86-10 Small *Doramea* nest in
tree trunk - D.W. *Muricelema* sp.

GT86-11 - dead branch by live tree
Rhinotermitid - M.C.

GT86-12 - Yellow-headed *Nesocryptus*
in rotten tree - D.W. Coll

GT86-13 a - *Capitulum* sp. - *part. m. m.*
in a bag in tree

13 b - *Sulobitermes* sp. (?) - probably
found with *capitulum* nest heavily
infested with *capitulum* -

13 c - *Capitulum* sp. - *part. m. m.*
also some *capitulum* ants

CR-1 Oct. 25, 1985 - 11:45 AM

Flodplain Termitid sample: 1 colony or
several?

5:30 PM from large nest opposite Lodge Bar
mixed *E. termitid* from Plot 2, Flod
Plain - Tree # 253 - *capitulum*
1) Hostile & aggressive behavior seen
between the two samples
∴ The Flod Plain Termitid can show
aggressive response

2) 253 + 242 = No Fighting
Group + 258 = " "
+ Colony 2 - No fighting

∴ All 3 samples from the Flodplain
Plot 2 came from the single
large nest on tree #

GT86-5 @ Nantux - as original
listing

GT86-6 - ~~Yucca~~

Sat. Jul 1 (or 2?)

Sp. Site / Insects / Coast
colony

G86-14 a Carton nest
on tree - brown-headed
nantes - prob. attacking
building in complex.
Imm. 2, ♀, NN

G86-14 b - Second carton
nest - on tree - spn
site

13b
14
13c - ~~Carton~~ nest
also a few small eggs

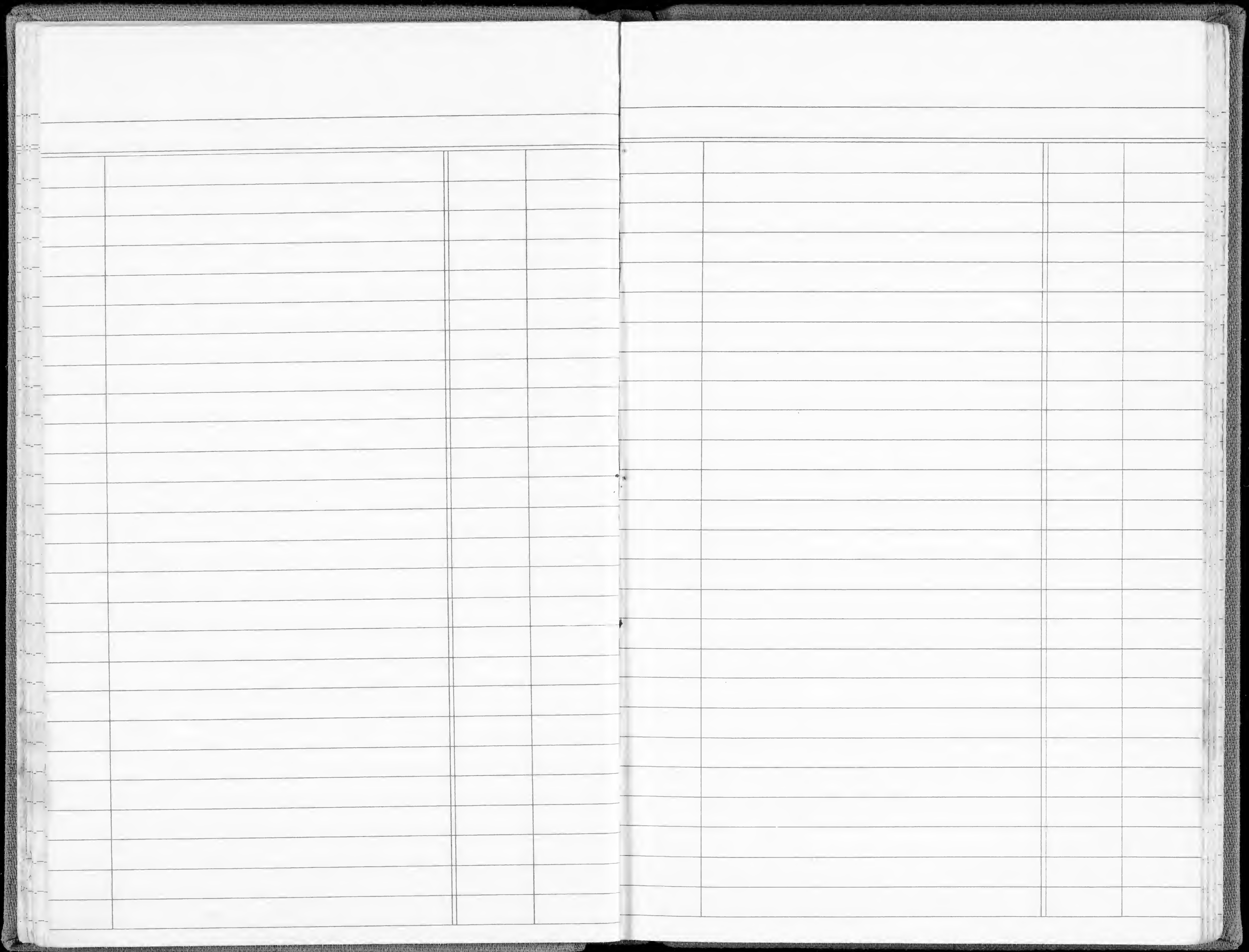



Guyana Basin
1986

To do

To Make - 10 Aug

- | | | |
|---------------------------------------|---------------|-----------------------------|
| Renew area | Numbered lids | Film |
| Back collecting equipment | | mosquito netting |
| Get Advant | | " Repellents |
| Get long blunt sticks | | Matches |
| Get rubber/acetone/sprayer | | Batteries |
| Flashlight | | Siggy carrier |
| Cell cord | | Vitamin |
| | | Face cream |
| | | Plastic bags |
| | | Fels Napha Soap |

Blue Liner



Sides can be lowered

2 m² Hardware cloth

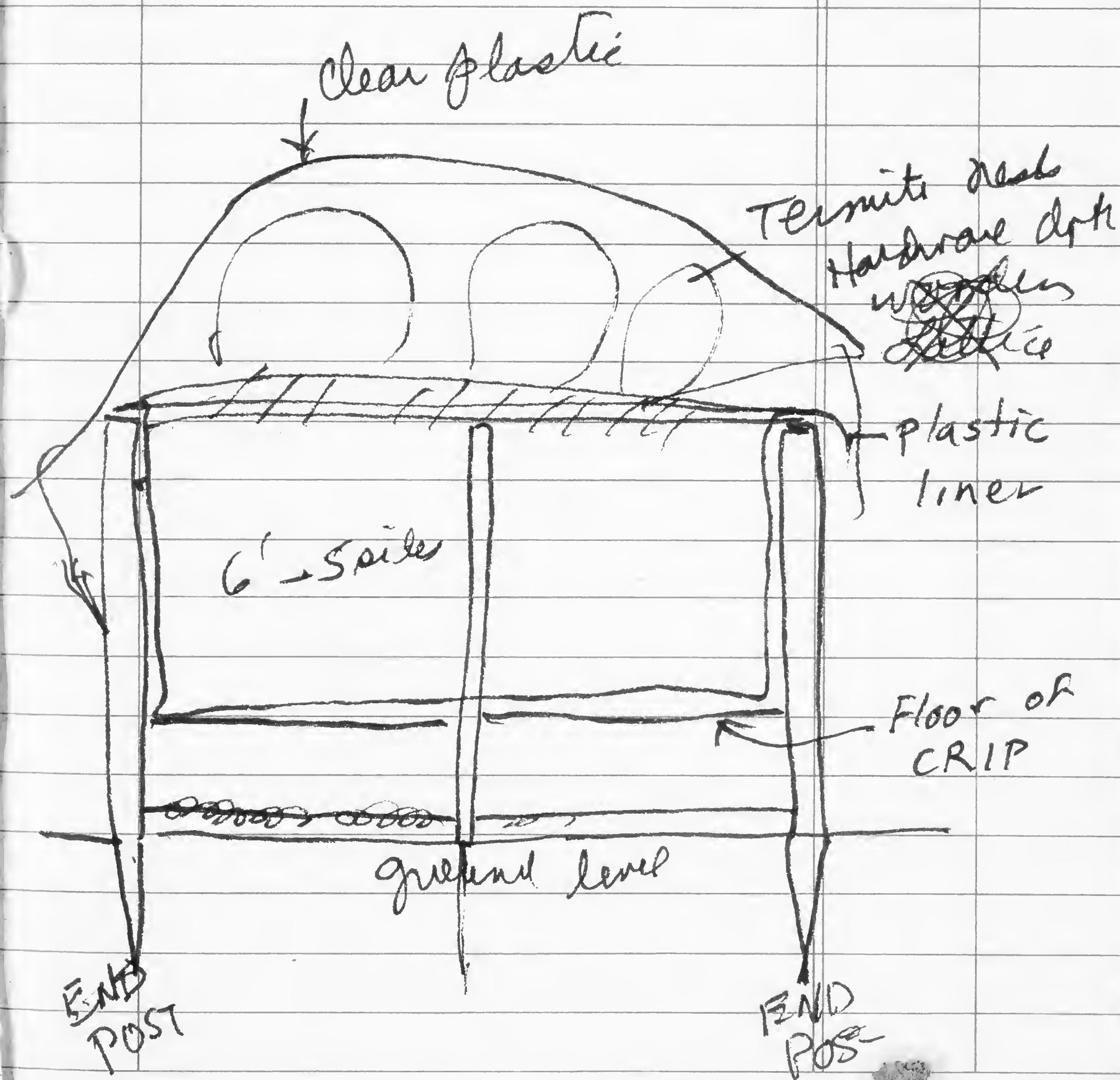



GUANA

July 6, 1986

1) GUA 86-1: meisitermes sp. T.M., 2, N -
plus ants living in same small dead
branch - near top of hill, hotel
grounds, Guana - coll. N.S.C.

2) GUA 86-2 - subulitermes (?) sp. -
in dead branch near summit @ hotel
site - TINY!

Seed Request

SEEDS FOR THE WORLD

PAK CHOY Page 42

#5618 1/2 oz. \$3.50 - 2 OUNCES

RED GIANT MUSTARD - PAGE 42

#5617 ONE OZ. \$2.50 - 2 OUNCES

GARLIC PAGE 40

PREMIUM WHITE GARLIC

#9050 - 5 lbs - \$14.00 5 POUNDS

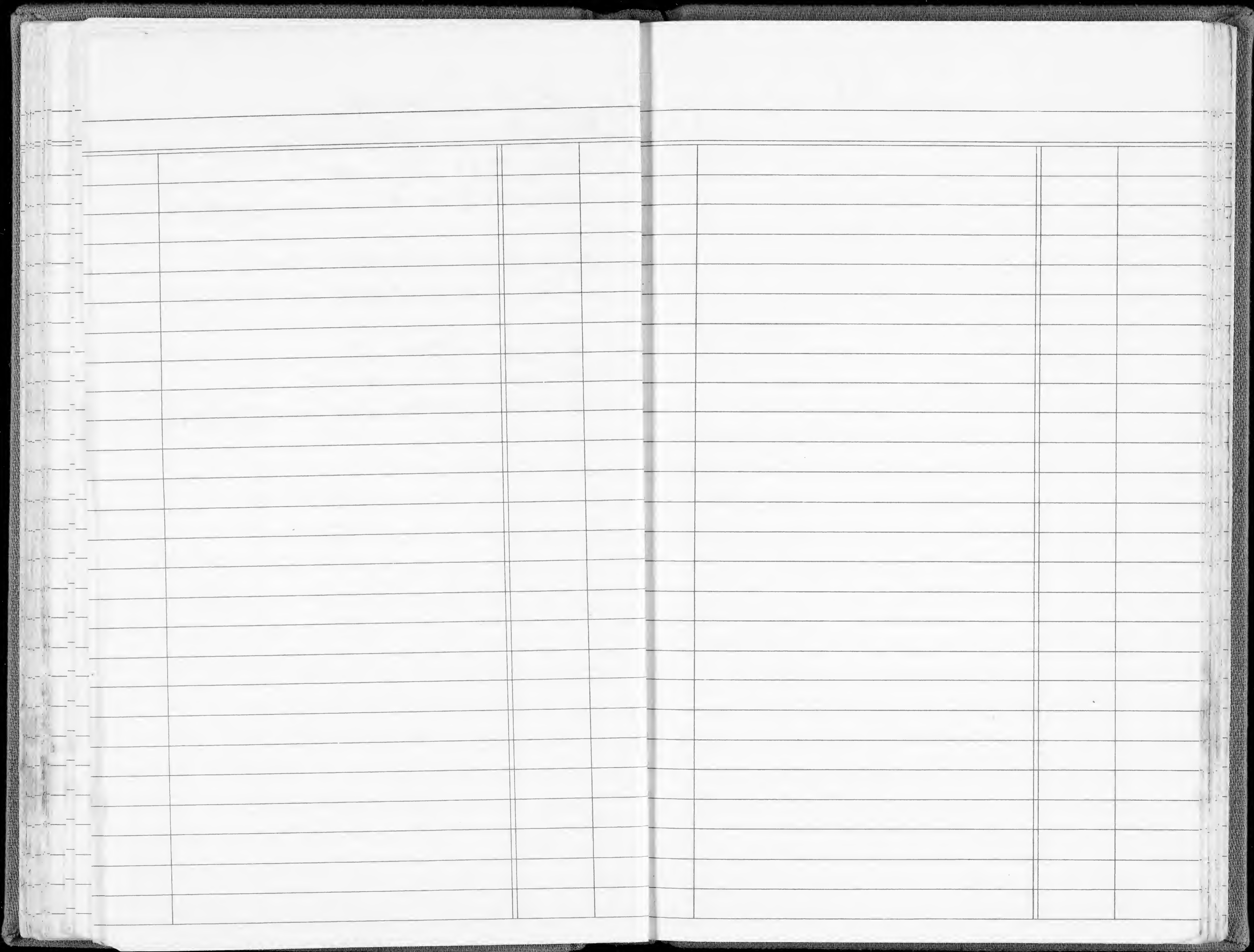

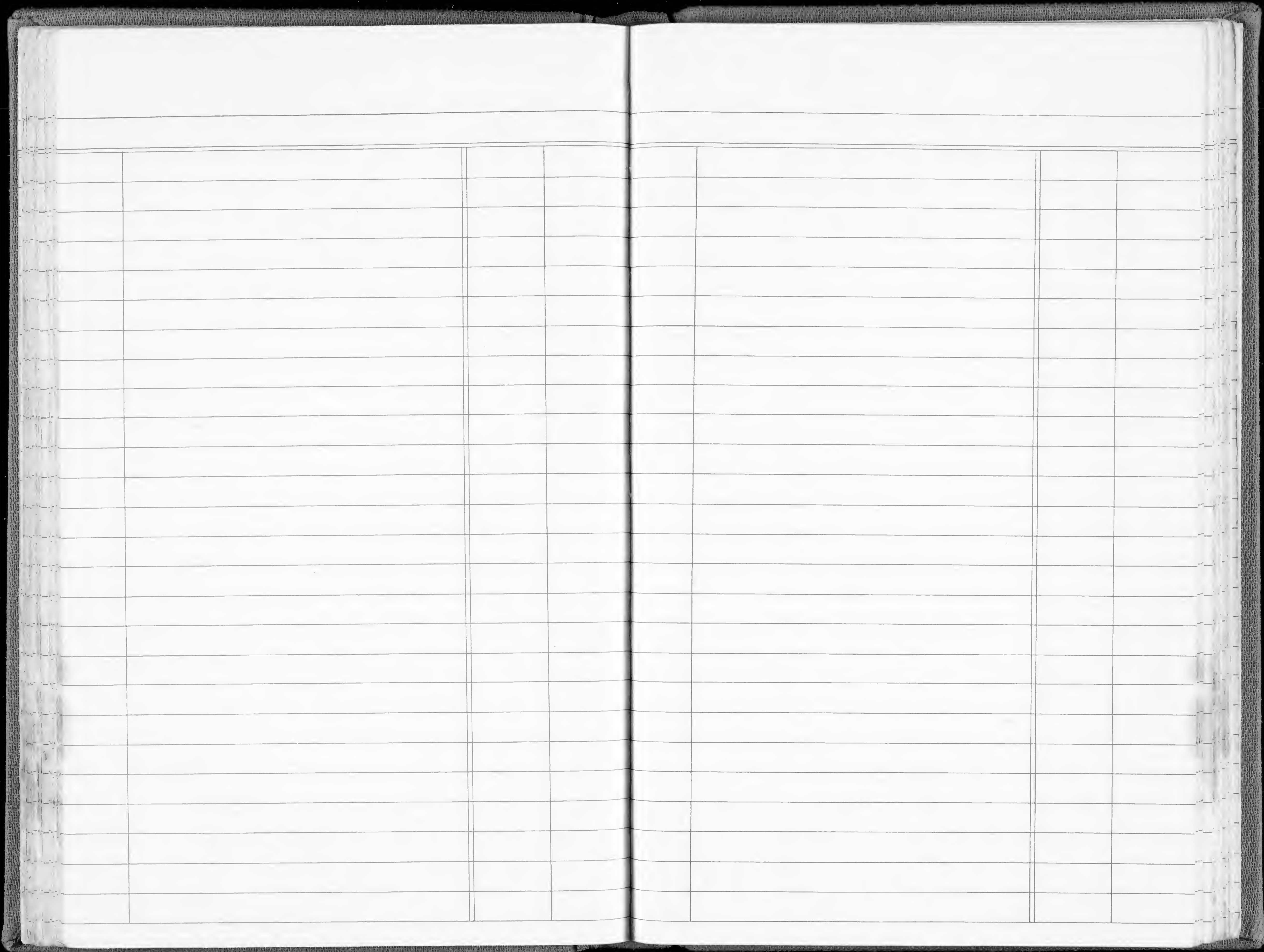

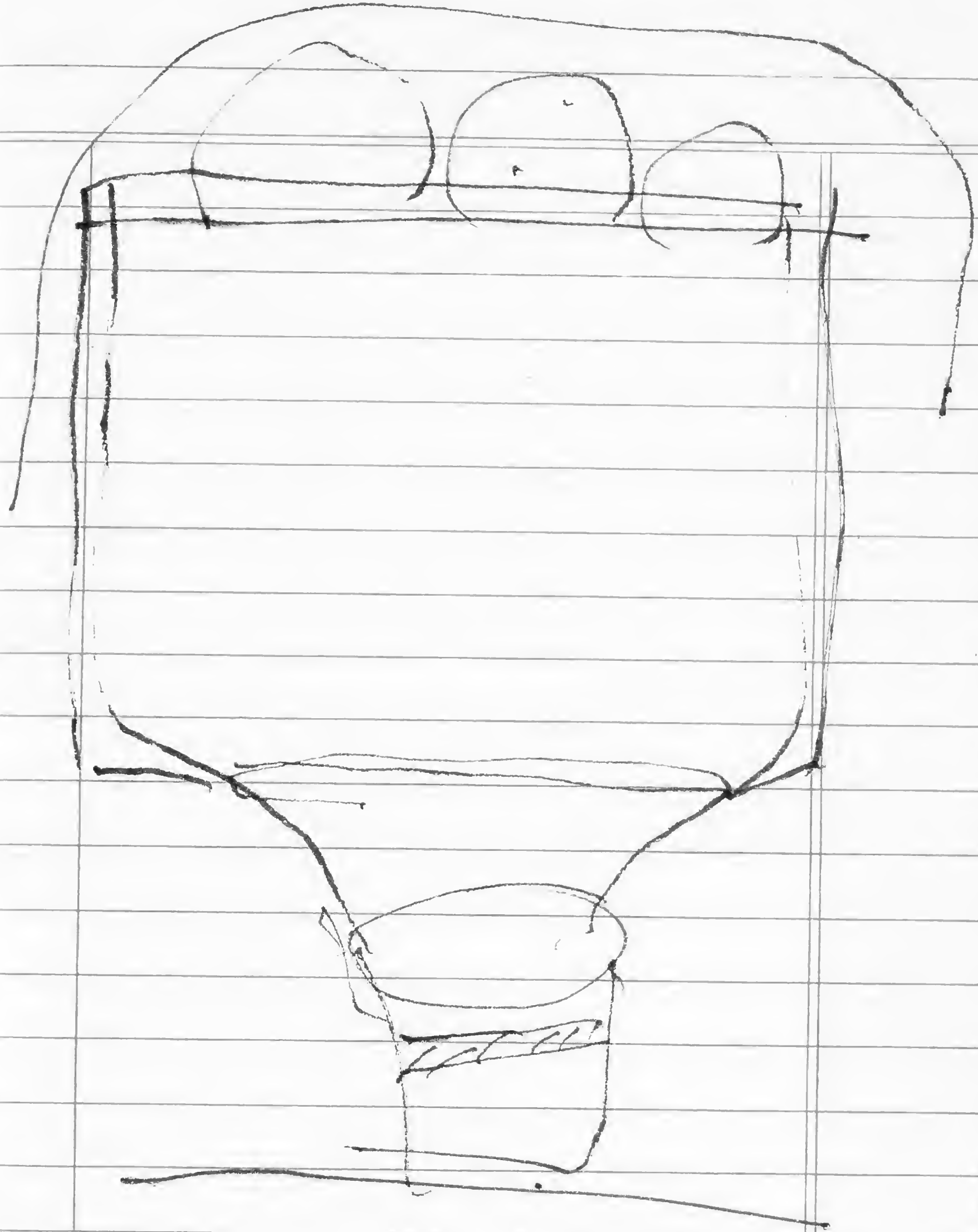
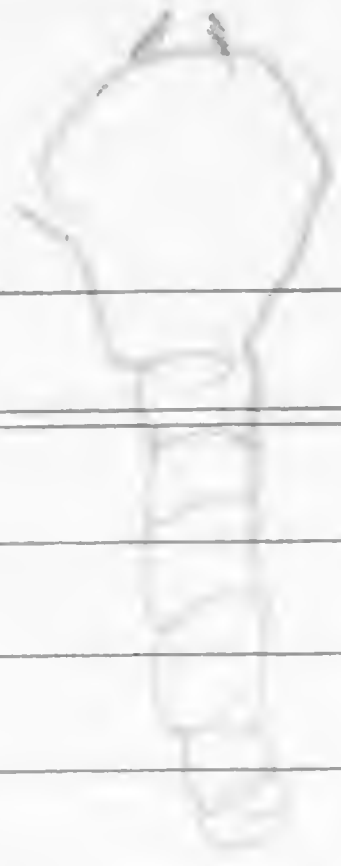

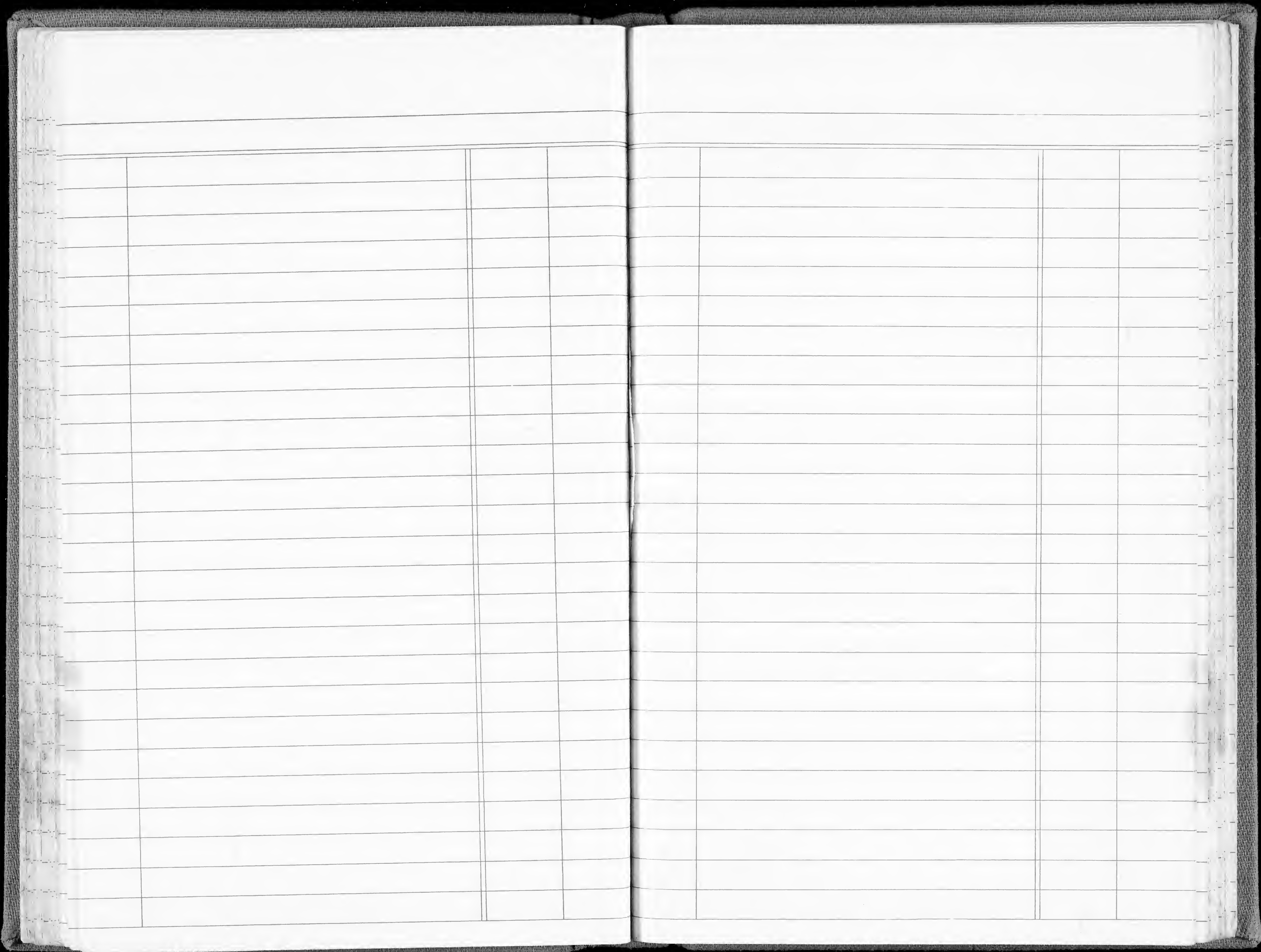

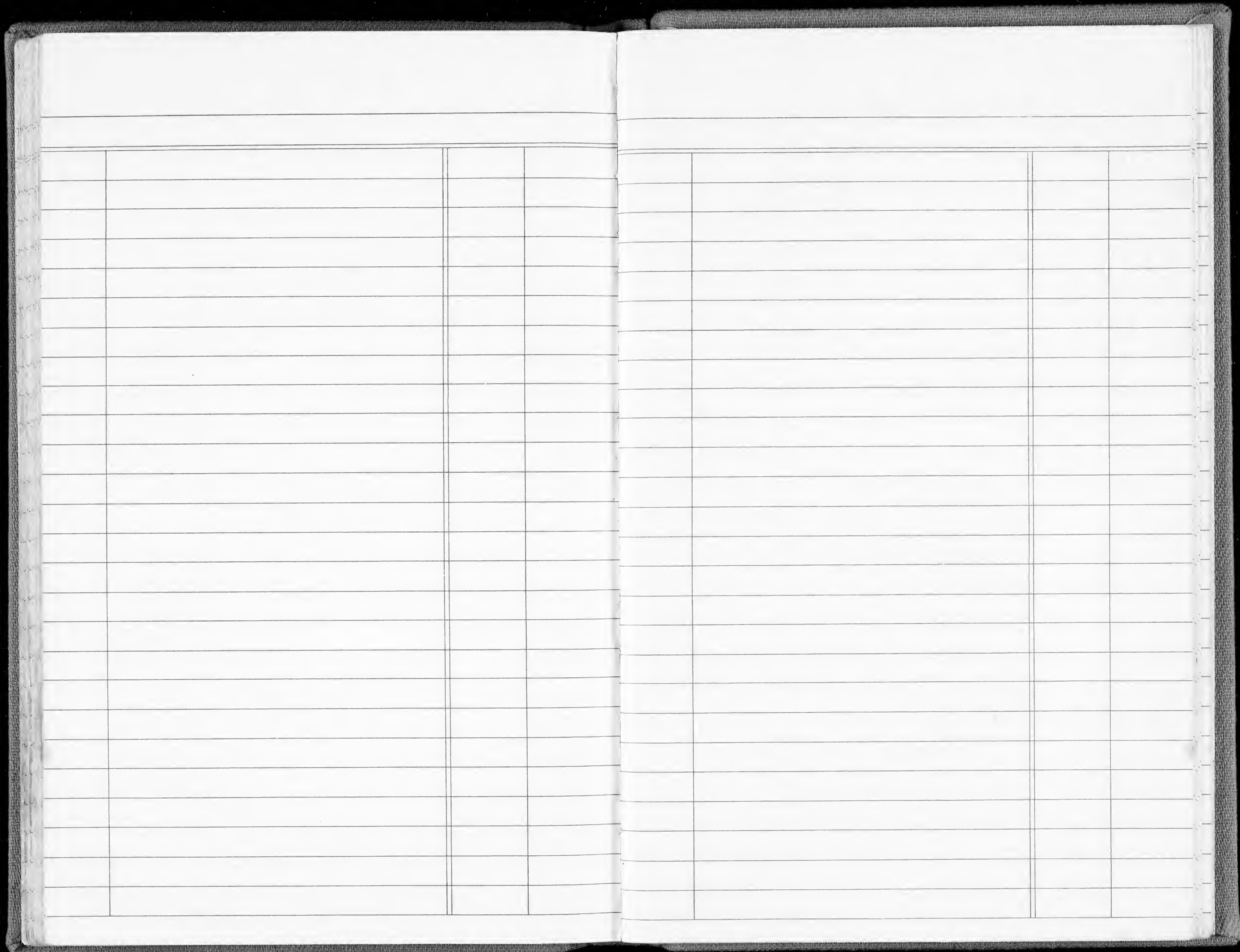

IN FULL SUN 130°

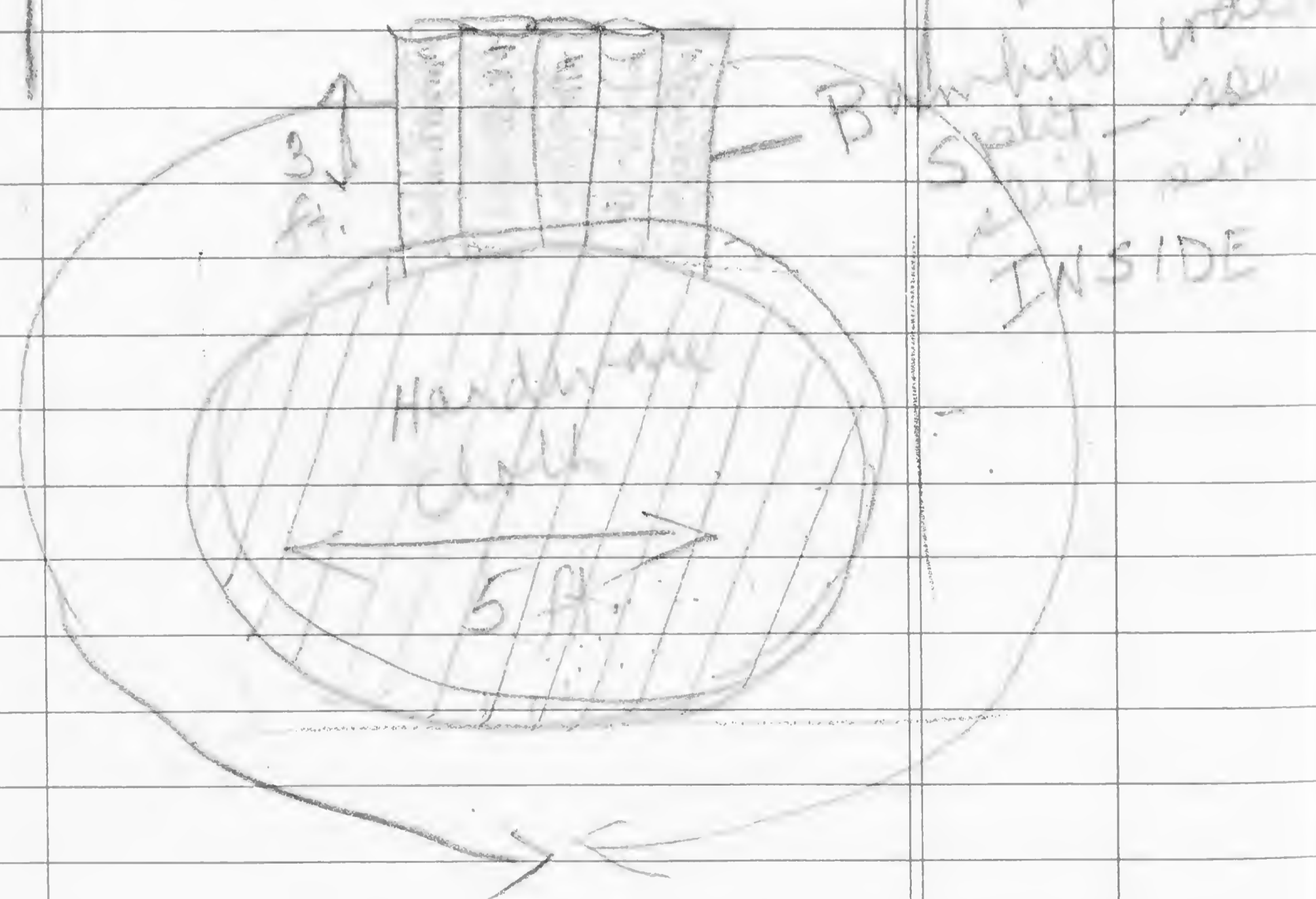
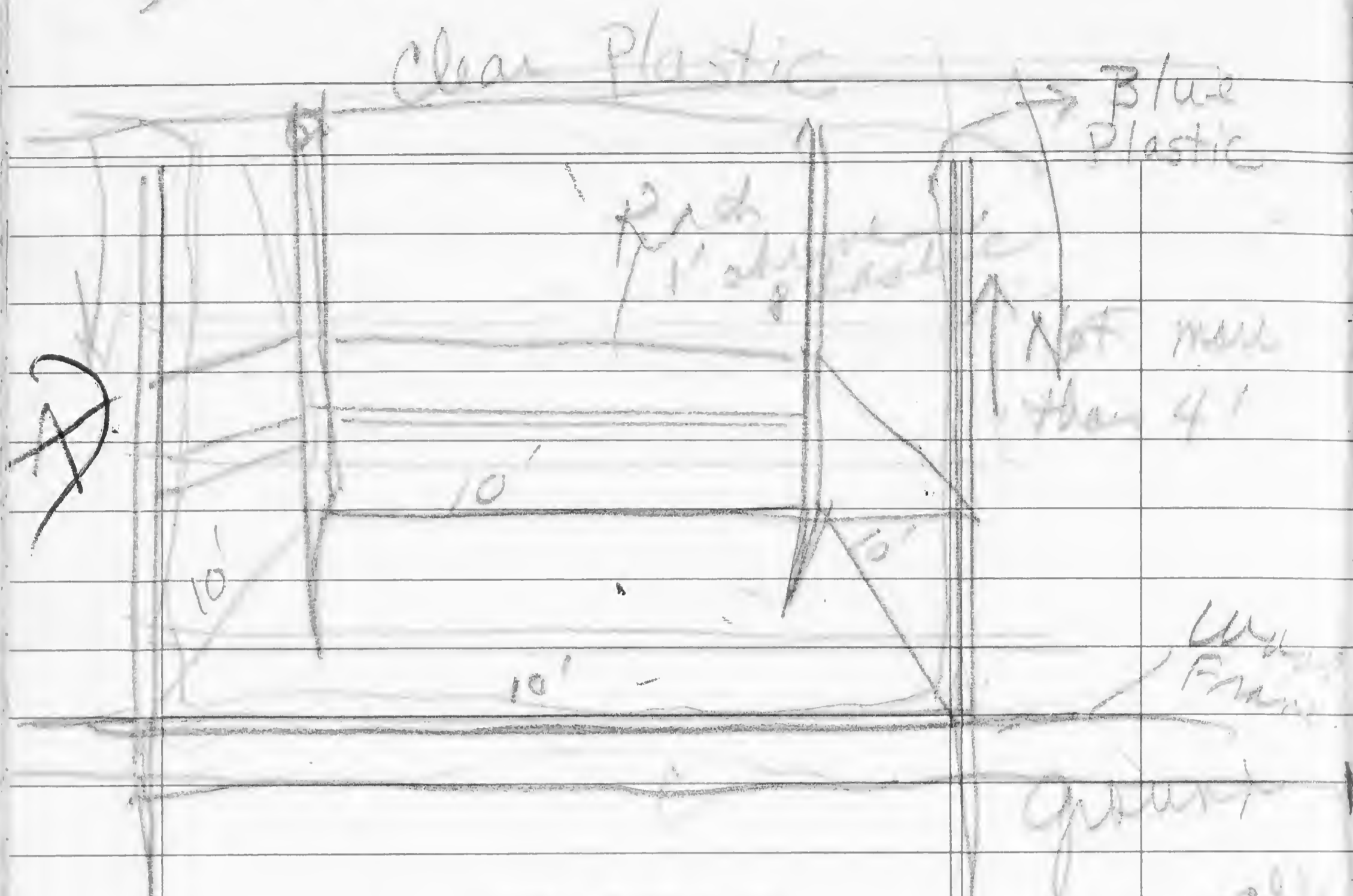

2 meters wide

$$2\pi r = C$$

$$\pi r^2 = A$$

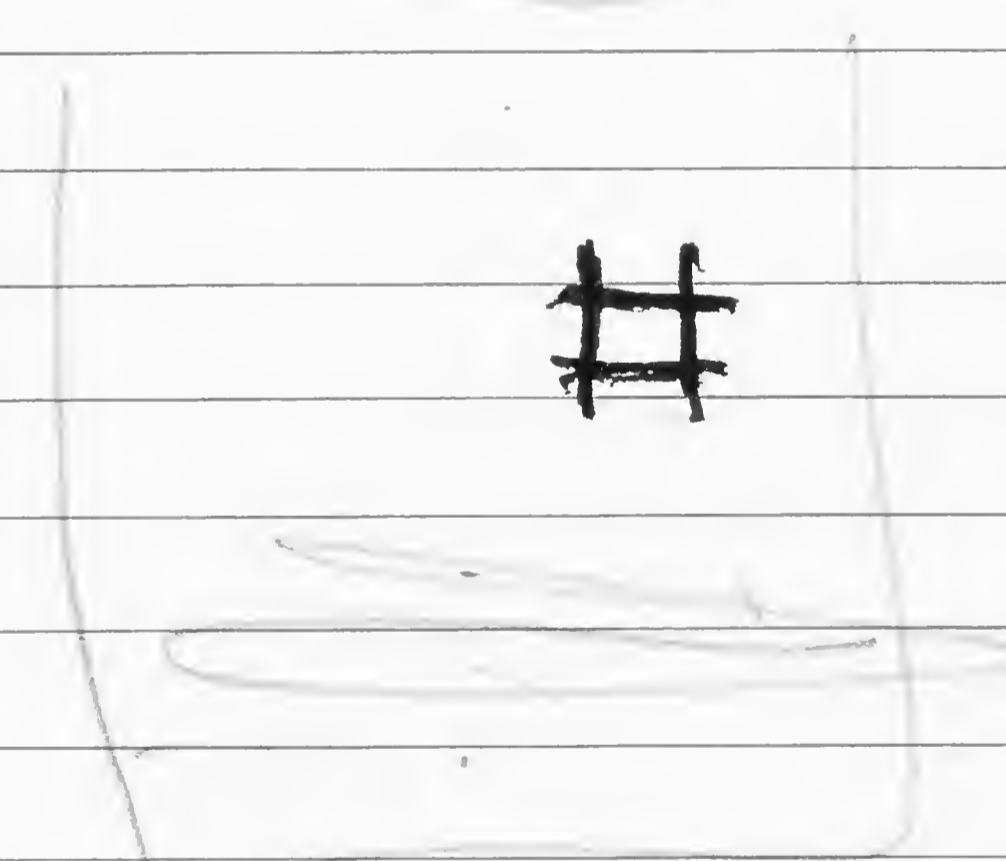
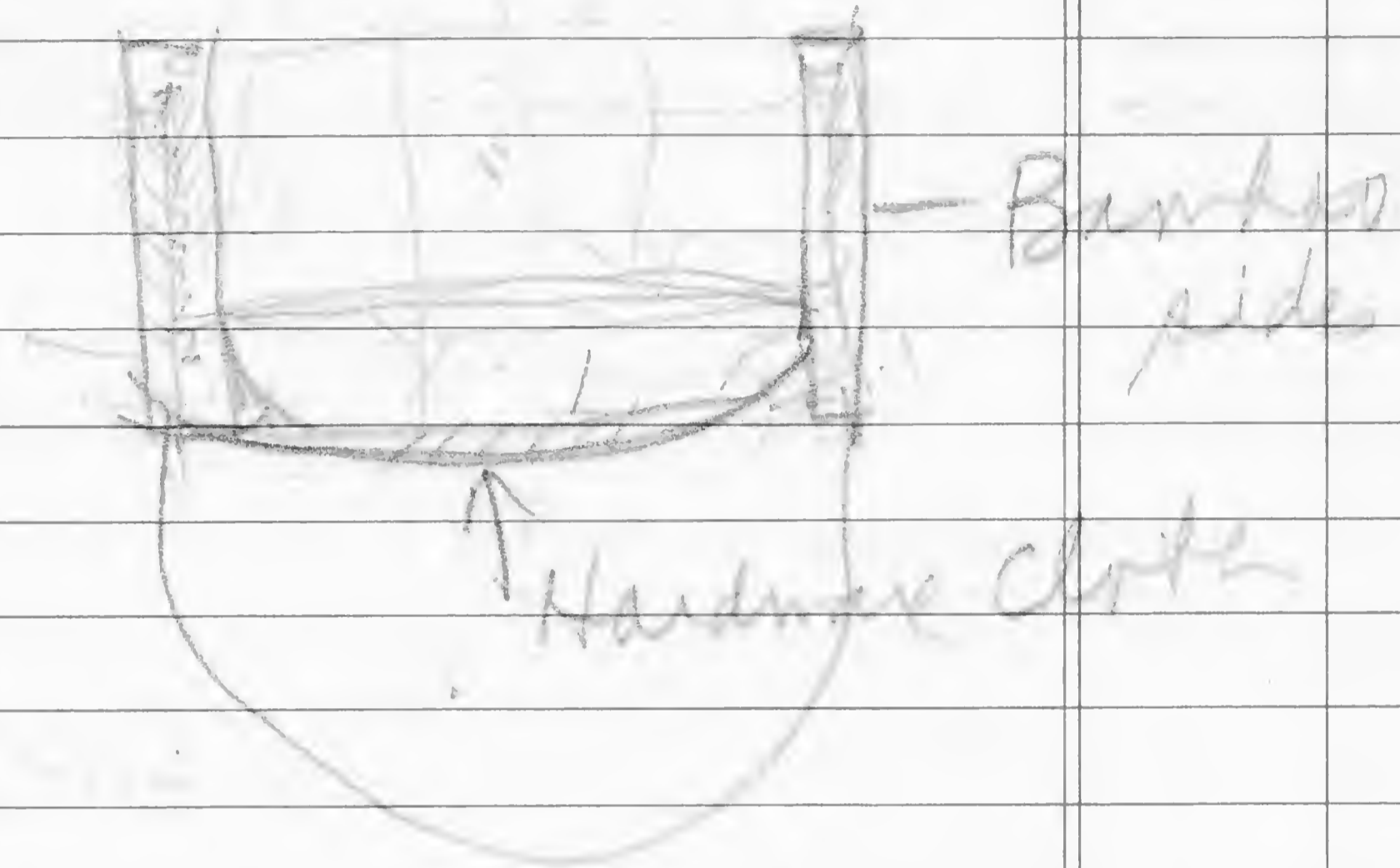

- A) 5 x 10 x 10 blue + = 500 ft²
- B) 12 x 12 x 12 clear
- 500 ÷ width = # ft in L

$$\# \text{ sides} \times L' \times W' = \text{Area}$$

5 x 10 x some multiple of
 the available width which
 when multiplied approximates 10' x the
 width available

~~1 x 10'~~

1 x 14' x same as above

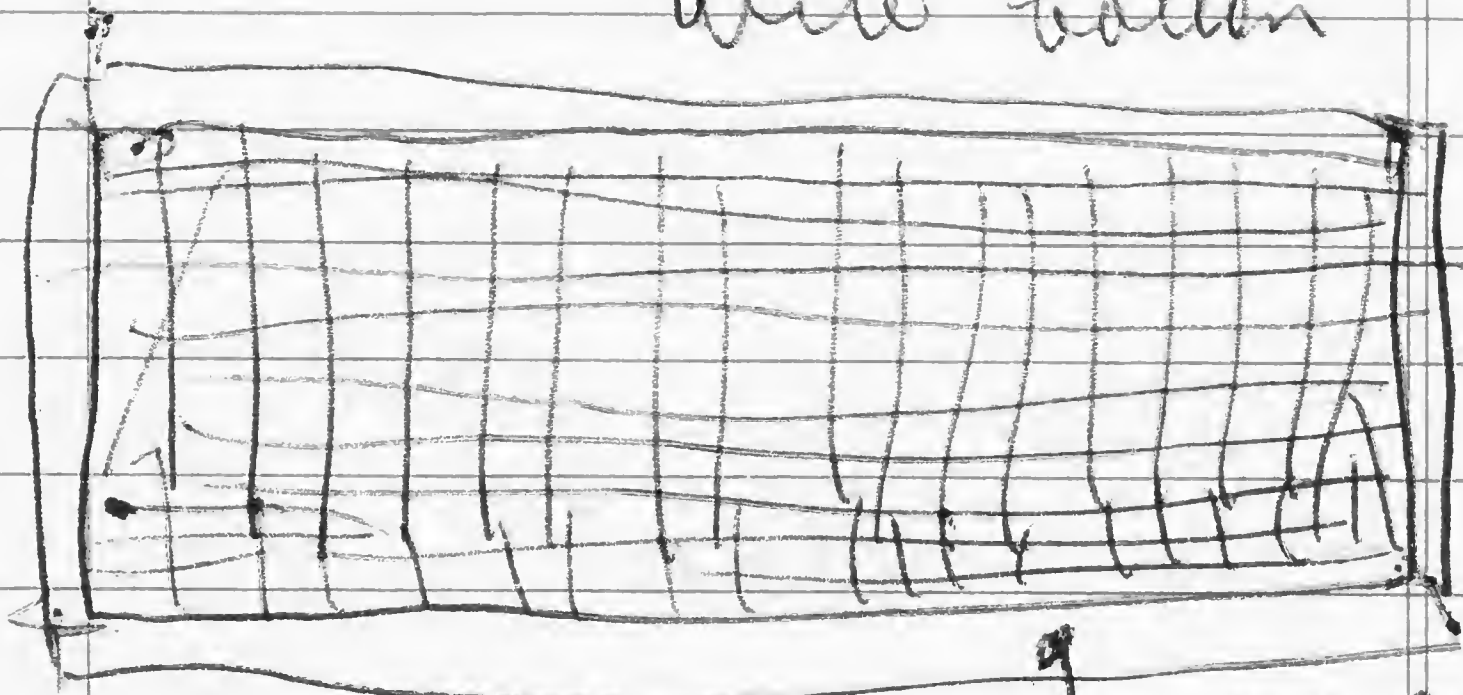
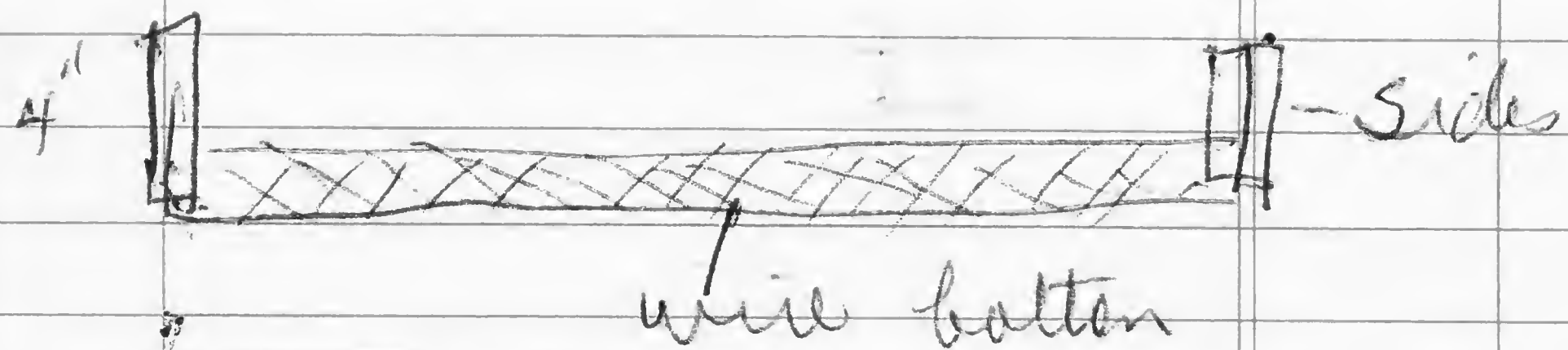

wall: material to
 be determined

$$5 \times 6' \times 6' = 180'$$

$$\begin{array}{r} 36 \\ 5 \\ \hline 180 \end{array}$$

$$5 \times 6 \times 2 = 60' \text{ long } 6 \text{ meters wide}$$

$$60 \times 5 = 300$$

$$\frac{180}{2} = 90 \text{ m}$$

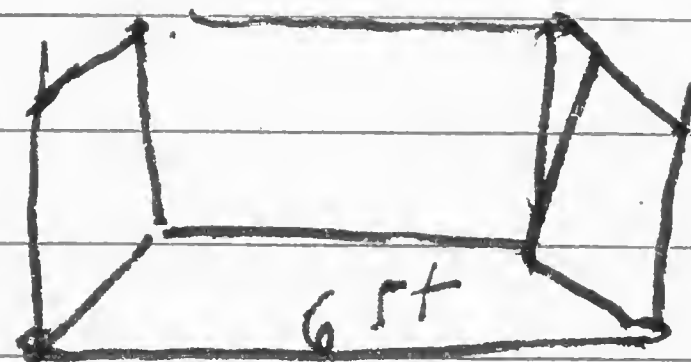

one side 2 meters high

$$5 \times 2 \times 2 = 20 \text{ m}^2 - \text{Blue}$$

$$1 \times 12 \times 12 - \text{Clear}$$

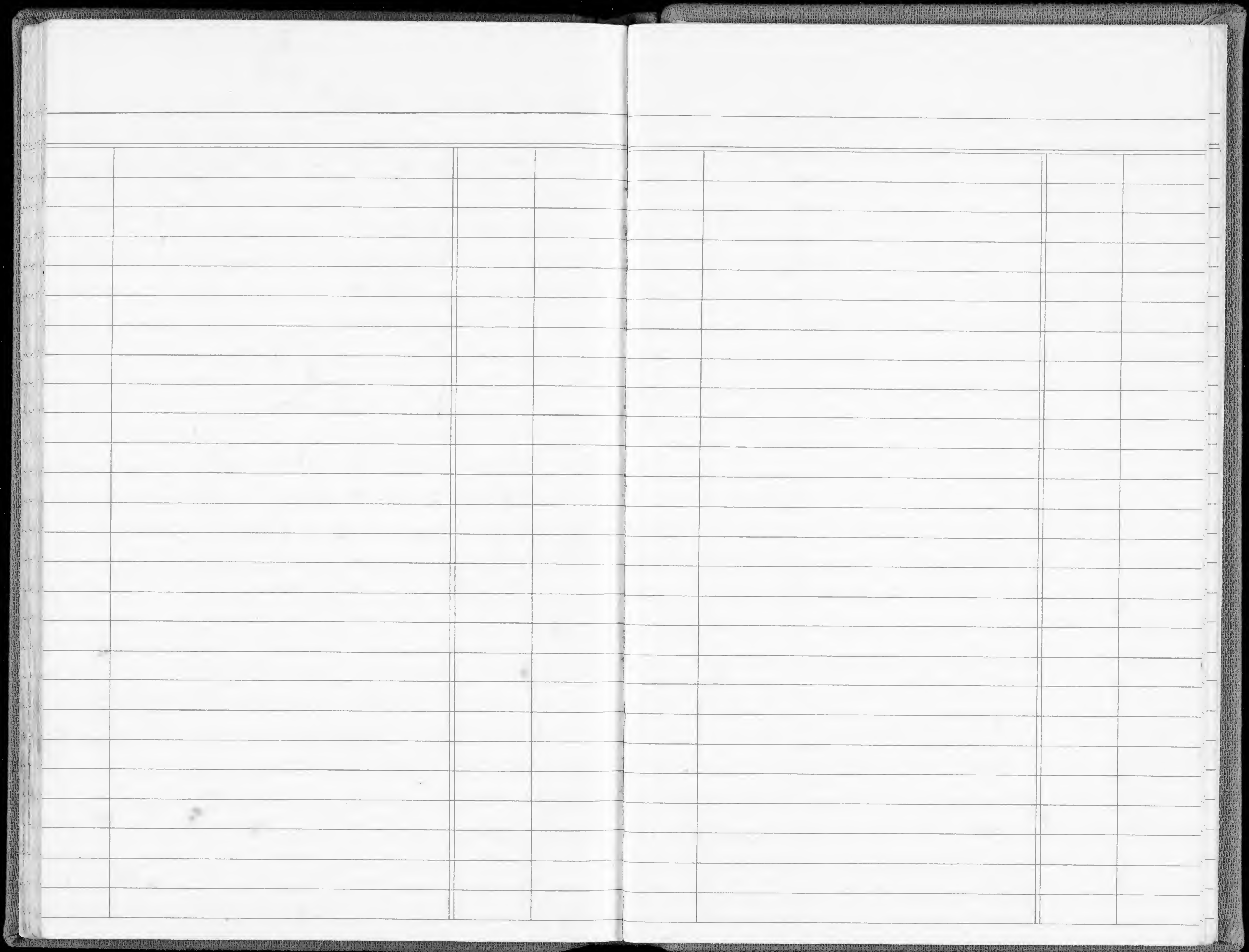

CONSULTANT TO:

- Industry
- Government

MEMBER OF:

- Entomological Society of America
- American Registry of Professional Entomologists

URBAN BIOSYSTEMS, INC.

Richard V. Carr, Ph.D., R.P.E.

URBAN PEST MANAGEMENT SCIENTIST

P.O. Box 3313
McLean, VA 22103

(703) 734-2923

CONSULTANT TO:

- Industry
- Government

MEMBER OF:

- Entomological Society of America
- American Registry of Professional Entomologists

URBAN BIOSYSTEMS, INC.

Richard V. Carr, Ph.D., R.P.E.

URBAN PEST MANAGEMENT SCIENTIST

P.O. Box 3313

McLean, VA 22103

(703) 734-2923

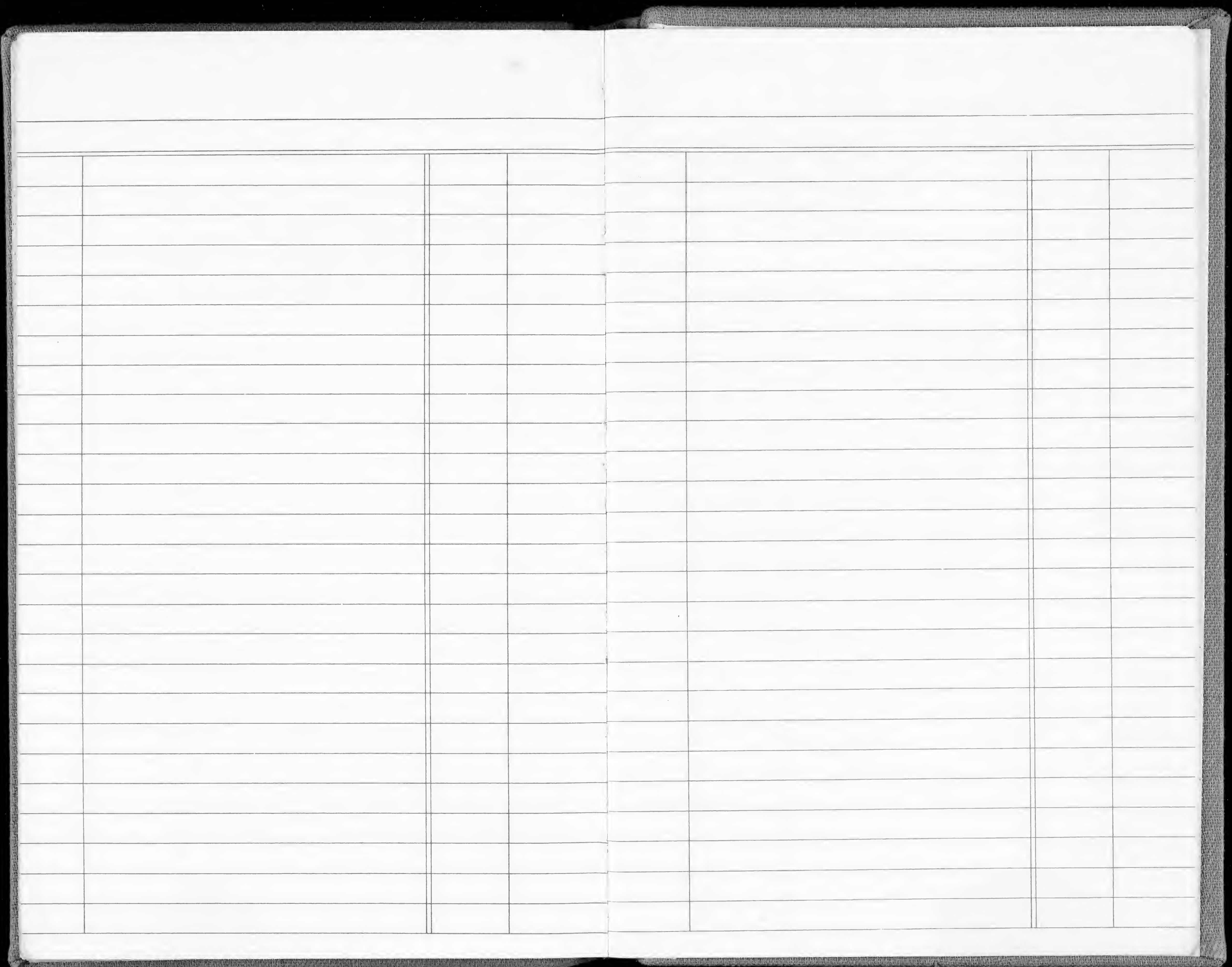

Cde viola # © Bellfield
71574

Bullman & other Rep.

Proc. of a workshop on the determination of
tropical woods: Chemical basis for

natural Resins

Apr. 1977 (2nd Print)

NRL, DC.

1) Carter, F. J., Beal & Bullman - wood Sci. J.,
#1, 406-410 (1975)

2) Beal, Carter & Southwell For. Print. J.
29, #8, 44-48 (1974)

3) Southwell & Bullman, NRL Report
7546, 1973

4) Southwell, Humma, Ferguson, Price,
Sweeney & Alexander, NRL
Report 5673, 1962



* * #

~~XXXX~~
~~XXXX~~
~~XXXX~~
~~XXXX~~
~~XXXX~~
~~XXXX~~
~~XXXX~~
~~XXXX~~
~~XXXX~~
~~XXXX~~

Perm Records	Should be	
3	21	
4	24	
5	23 ← 23	
6	22	
13	16	
6	7	
<hr/> 37	<hr/> 113	113
		37
	Possibly	<hr/> 150 ^{AP}

Possey
 Darryl Possey
 Natl Univ. Serv
 Parking Lot A
 Adm Bldg
 2nd

21st St. between E+F
 16th St. ←
 North on 16th St.

