



AMERICAN PAD & PAPER CO./HOLYOKE, MASS. 01040

Thomas H. Zanon

Permanent Herbarium Notes

1970-1971

Sites 1-187

NJ, R.I., Indiana, Delaware, Va., Maryland, Pa.

NO. 2066

**EFFICIENCY® NOTE BOOK**

60 LEAVES/10X7 $\frac{1}{8}$

11

FLORA NOVAE CAESAREAE  
THOMAS A. ZANONI

FLORA OF RHODE ISLAND  
Thomas A. Zanoni

fl = flowering  
fr = fruiting, or fertile frond  
st = sterile frond or plant

1, 2 Floodplain of Raritan River, Johnson Park  
Piscataway Twp., Middlesex Co., N.J. Fri. 2 May, 1969

- 1-1. *Alliaria officinalis*  
2-1 *Mertensia virginica*

3. Behind Wessels Hall, Rutgers University,  
New Brunswick, Middlesex Co., N.J. 7 May 1970

- 3-1 male flowers of *Thorus alba*

4, 5, 7, 8, In cleared forest area, on Indian Trail,  
Narragansett, Washington Co., R.I.

June 11, 1969

8-1 *Woodwardia areolata*

4-1 *Kalmia angustifolia*

~~5-1~~ *Sisyrinchium*

7-1 *Osmondia regalis*

6. Along edge of road, Rts 138, East of Rt. 1  
South Kingstown, Washington Co., R.I.

11 June 1969

6-1 *Viburnum dentatum recognitum*

9, 11 Swamp at Rt. 1A and Indian Trail,  
Narragansett, Washington Co., R.I.

11 June 1969

9-1 *Osmunda regalis*

11-1 *Croceia atrovirens*

10, 12 Woods, east of Pettaquamscutt River, Rt. 1A  
at Town Lines of N. Kingston - Narragansett, Washington Co., R.I.

11 June 1969

10-1 *Polytrichum*

12-1 *Pyrola rotundifolia* var. *americana*

13

1/2 mi. East of Clove Road, on Deckertown Turnpike,  
Sussex County, New Jersey  
Under hemlock forest under limestone cliff

Sun. Sept. 6, 1970

13-1 *Camptosorus rhizophyllus*

13-3 *Botrychium virginianum*

w/ J. O. Sisi

13-2 *Dryopteris* sp.

14A

at Lawrence Twp - Hamilton Twp Townline on Rt. 533  
near Assumpink Creek, Mercer Co., New Jersey

Sept. 10, 1970

14A-1 *Lespedeza*

(also *Hibiscus palustris* present)

14B

3/4 mi. East of Rt. 535 on first major crossroad  
north of Paxson Avenue  
Hamilton Twp., Mercer Co., N.J.

Ferns.

10 Sept. 1970

14B-1 *Osunda cinnamomea*

14B-2 *Athyrium filix femina*

14B-3

- 15 East of Pettaquamscutt R., at town lines of  
Narragansett - N. Kingstown, Washington Co., Rhode Island  
in Black & white Oak forest  
15-1 *Lycopodium complanatum* 17 May 1970  
15-2 *Cypripedium acaule*

- 16 1,000 ft. South of N. Kingstown - Narragansett Town lines  
on Rt. 1A, Narragansett, Washington Co., R.I.  
at edge of road & swamp  
16-1 *Equisetum arvense* 17 May 1970

- 17 1/2 mi. north of Otisum Lake, on Rt. 206,  
Burlington Co., New Jersey.  
at edge of road in ditch.  
17-1 *Woodsia (Lorinseria) areolata* 16 August 1970

18 Pettaquamscutt Rock, 1 1/2 mi. S. of  
Bridgetown Road, on Middlebridge Rd.  
Wakefield, Washington Co., R.I.

18-1 *Athyrium filix femina* 4 July 1970  
16 July 1970

19 William Hutcheson Memorial Forest, Amwell Rd.  
E. Millstone, Somerset Co., New Jersey  
Section 13 of forest, near R.R. tracks.

Sat. 18 July 1970

19-1 *Athyrium filix femina*

19-2 *Asplenium platyneuron*

20 Across the road from Allaire State  
Park Nature Center, off Rt. 549  
Farmingdale, Monmouth Co., N.J.

In woods on floodplain Sun. 19 July 1970

20-1 *Athyrium filix femina*

20-2 *Dryopteris*



21

On Stanhope Road at Cherry Tree Lane,  
Sparta, Sussex Co., N.J.  
In woods at edge of Pond.

Sun. 25 July 1970

21-1 *Athyrium filix femina*

(w/R. Zaroni)

22

On Long Hill Road, 1/5 mi. East Jct. of  
Hollow Rd - Zion Westville Rd - Long Hill Road.  
Zion, Somerset Co., N.J.

(Pine Oak Rd.  
&  
Dutchtown Zion Rd.)

Sat. 8 August 1970

22-1 *Athyrium filix femina*

22-2

22-3

23

(site 1) North and (site 2) South of Jct. of Great Rd, on Rosedale Road,  
North of Rosedale, New Jersey Mercer Co., (near Princeton)  
(near Boych Affair)

Sun. 9 August 1970

23-1 *Athyrium filix femina* (site 1)

(w/Pf. Orsi)

23-2 *Athyrium filix femina* (site 2 - green stipe)

23-3 *Athyrium filix femina* (site 2 - red stipe)

24 1/8 mi. NE of Jct. Rt. 206 + Quaker Bridge Road.  
at Atsion Lake, Wharton A Forest, Burlington Co., N.J.  
In Ailanthus + Acer rubrum woods (Jun. August 16, 1970)  
on a tributary flood plain.

24-1 *Dryopteris*

24-2 *Athyrium filix-femina* (red stipe)

25. William Hutcheson Memorial Forest (Rt. 514 = Howell Rd.)  
East Millstone, Somerset Co., N.J.  
site B-7

9 August 1970

*Athyrium filix-femina* - no specimen taken

26 Apprx. 1,000 ft. from Delaware River, along Delaware Avenue  
Fieldsboro, Burlington Co., N.J.  
in moist shaded woods

15 August 1970

26-1 *Equisetum arvense*

27. Rd. from Rt. 130 to Hedding, opposite 3rd St.  
Hedding Burlington Co., N.J.

15 August 1970

*Lythrum salicaria*  
*Eupatorium peyfoliatum*  
*Vernonia*

28A On Road from Hedding to Mt. Holly,  
before first N.J. Turnpike bridge.  
Hedding, Burlington Co., New Jersey.

15 August 1970

28A-1 *Pteridium aquilinum*

28-B On Road from Hedding to Mt. Holly, between  
the 2 N.J. TPK bridges, along edge of pasture  
Hedding, Burlington Co., N.J.

28B-1 *Pteridium aquilinum*

15 August 1970

29 On road from Hedding to Mount Holly,  
just south of 2nd N.J. TPK. overpass,  
Hedding, Burlington Co., N.J.

15 August 1970

at edge of road at bridge over stream

29-1 *Pteridium aquilinum* (curly)

29-2 *Pteridium aquilinum* (normal)

30 1/4 mi. W of Rt. 543, on Road from Hedding to Mt. Holly,  
at edge of road.

Jacksonville, Burlington Co., N.J.

15 August 1970

30-1 *Equisetum arvense*

30-2 *Anolea sensibilis*

30-3 *Dennstaedtia punctilobula*

30-4 *Anolea sensibilis* var. *obtusilobata* (one found only)

31- NOT USED on a side

32

North east corner, of Rt. 206 + Quaker Bridge Rd.  
Atsion, Burlington Co., N.J.

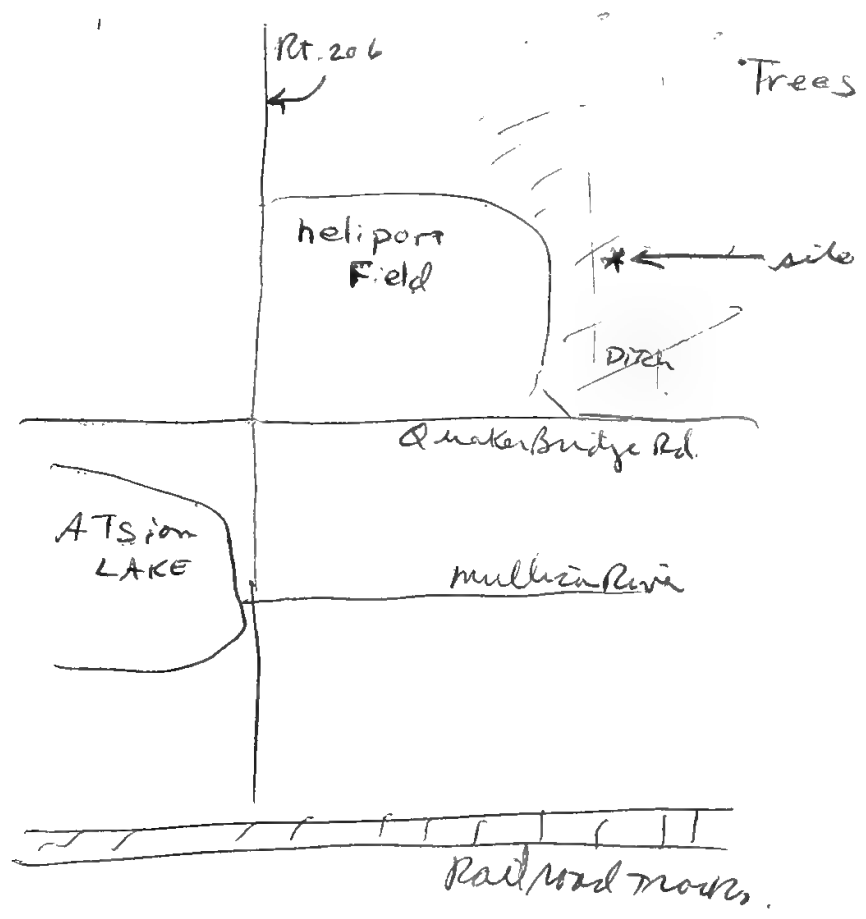

*Lygodium palmatum*  
site of Dr. Buell,  
but not yet seen  
here.

33 In a Black and white OAK-Hickory forest  
at the Town lines of N. Kingstown - Narragansett,  
East of Pettaquamscutt River,  
Washington County, Rhode Island

13 September 1970

34 In a cleared out woods (red maple, oak-hickory)  
on Indian Trail,  $\frac{1}{4}$  mi. West of Rt. 1A,  
Narragansett, Washington Co., Rhode Island.

13 September 1970

34-1 *Thelypteris noveboracensis*  
*Athyrium filix-femina*  
*Dennstaedtia punctilobula*

35 Along Middlebridge road,  $\frac{1}{4}$  mi. north of Pettaquamscutt  
Road, at Old Graphite Mine site.  
Waterfield, Washington Co., R.I.

12 September 1970

*Eupatorium dubium*

36

Along Middlebridge Road, between  
Pettquamscutt Rock and Terry Road,  
Wakefield, Washington Co., Rhode Island

12 Sept. 1970

- 36-1 *Eupatorium dubium*
- 36-2 *Tanacetum vulgare*
- 36-3 *Athyrium filix-femina*
- 36-4 *Thelypteris noveboracensis* (L.) Newell
- 36-5 *Solidago*
- 36-6 *Aster*

37.

On Terry Road, near Middlebridge Road, at Edge of Road,  
Wakefield, Washington Co., Rhode Island

12 Sept. 1970

- Clematis virginiana*
- Athyrium filix-femina*
- Viburnum recognitum*
- Myrica pennsylvanica*
- Spartina pectinata* - rare

38

Around Wessuage Pond, Bonnett Shores,  
Washington Co., Rhode Island.

12 Sept. 1970

- Spartina pectinata* - common

39. On Route 543,  $\frac{3}{4}$ -1 mile from Rt. 68 EAST,  
in woods at left side of road,  
Georgetown, Burlington County, ~~Rhode Island~~ New Jersey  
19 September 1970

39-1 *Athyrium filix-femina*

39-2 *Onoclea sensibilis*

40. On the flood plain of the North Branch of Rancocas Creek,  
just east of Rt. 206, damp, moist soil.  
Burlington County, New Jersey

19 Sept. 1970

*Chelone glabra*

*Eupatorium*

*Polygonum sagittatum*



41. On Red Lion Road,  $\frac{1}{8}$  mile East of Red Lion Airport.  
Along stream & Road,  
Red Lion (East Vincenton), Burlington Co., N.J.  
19 Sept. 1970

*Saxonaria officinalis*  
*Sporenia hederacea*

41-3 *Pteridium aquilinum*

42. In a Beech-gray Birch-Chestnut Oak-Sassafras Woods,  
 $\frac{1}{3}$  mile West of U.S. Rt. 1 on New Road,  
Kendall Park, Somerset County, New Jersey

42-1

20 Sept. 1970

42-2 *Pteridium aquilinum*

42-3 *Pennstacdia punctiloba* (no spores)

42-4 *Thelypteris noveboracensis* (spores)

43. In moist woods at New Road & U.S. Rt. 1,  
N.W. corner, along New Road,

Kendall Park, Somerset County, New Jersey

43-1 *Viburnum acerifolium* (fruit) 20 Sept. 1970

43-2 *Pennstacdia punctiloba* (no spores)

43-3

43-4 *Thelypteris noveboracensis* (spores)

43-5 *Polypodium vulgare* (dried up)

44. 1/4 mile past Pa. RR. overpass, East of  
Monmouth Junction, Mercer County, New Jersey

20 Sept. 1970

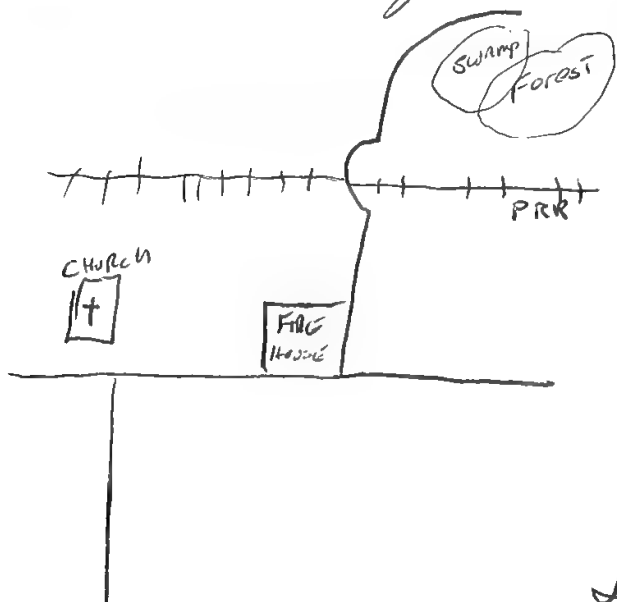

In swamp.

44-1 *Woodwardia virginica*

44-2 *Polygonum argyfolium*

44-3 *Polygonum sagittatum*

In *Nyssa-Liquidambar* woods.

*Lorinseria areolata*

44-4 *Onoclea sensibilis*

45. On floodplain of river, 2 miles south of Maple Mead,  
on Rt. 130 (under bridge, east side of road.

Maple Mead, Middlesex(?) Co., New Jersey

20 Sept. 1970

45-1 *Athyrium filix-femina* (2 or 3 plants)

45-2 *Lorinseria areolata*

45-3 *Onoclea*

45-4 *Thelypteris noveboracensis*

45-5 *Arctiaceae* *Scheuchzeria cylindrica*

45-6 *Dryopteris marginalis*

46 . On the road from Fairview to Sewell,  
on the flood plain of the South branch of Mantua Creek,  
just south of the town of Sewell, Gloucester Co., N.J.

20 Sept. 1970

46-1 *Eupatorium*

46-2 *Cornus florida* infruct

46-3 *Boehmeria cylindrica* (L) Sw.

(w. A. J. Ossi)

46-~~5~~ *Onoclea sensibilis* L.

46-~~4~~ *Dryopteris*

46-6 *Louisevia areolata*

46-7 *Botrychium*

46-8 *Asplenium ~~opense~~ platyneuron* (L) Plant only

47 Pt. 47 at Mantua Creek, NE bank of Creek, (1 mi. E of Pt. 47)  
North of Glassboro, Gloucester Co., N.J.

in Pine woods, along trail to river

(w. A. J. Ossi)

47-1 *Eupatorium dubium*

47-2 *Pteridium aquilinum*, curly cut

47-3 *Pteridium aquilinum*, normal

48. Palmerton, Carbon Co., Pennsylvania  
Behind east plant of New Jersey Zinc plant,  
on dry slope near railroad tracks  
3 September, 1970  
(w. Jeff Lappin)  
48-1 *Equisetum arvense*
49. In a disturbed field, off. Old Boston Neck Road,  
Narragansett, Washington Co., Rhode Island  
4 July 1970  
49-1 *Polygala polygama*
50. On trail to Pettaquamscutt Rock, from  
Middlebridge Road, /  
South Kingstown, Washington Co., Rhode Island  
10 July 1970  
50-1 *Polygala polygama*
51. In 3 year old field on Indian Trail  
Narragansett, Washington County, Rhode Island  
10 July 1970  
51-1 *Spiraea tomentosa*  
51-2 *Verbena*

52 NW corner of <sup>North</sup> South Shore Road + Rt. 206  
on Rocky slope, between Netcong + Andover  
Sussex Co. (?), New Jersey

4 August 1970

- 52-1 *Dennstaedtia punctilobula*
- 52-2 *Polypodium vulgare* var. *virginianum* (w/ Ray Zanoni)
- 52-3 *Dryopteris marginalis*
- 52-4 *Thelypteris noveboracensis*

53. NW corner of <sup>North</sup> South Shore Road + Rt. 206  
behind swamp + around swamp.  
between Andover + Netcong, Sussex Co., New Jersey

4 August 1970

- 53-1 *Polystichum acrostichoides*
- 53-2 *Athyrium filix-femina* (w/ Ray Zanoni)
- 53-3 *Dryopteris spinulosa*

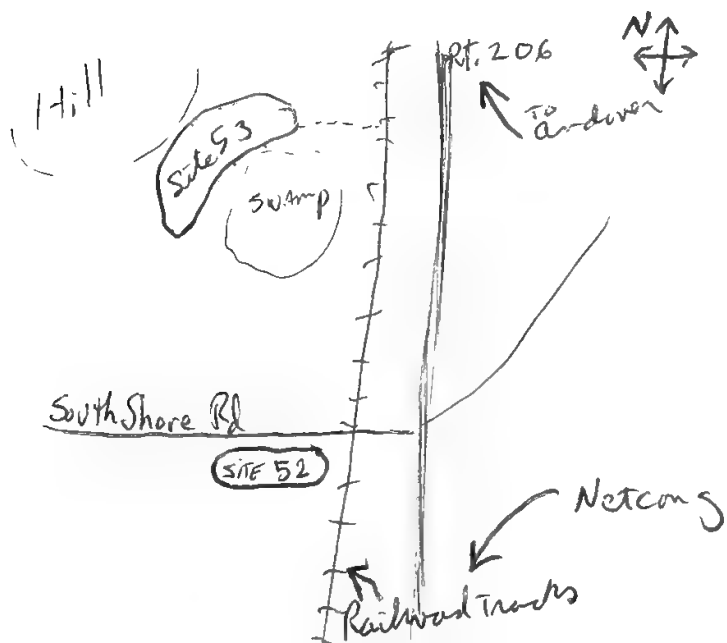

54. 7 miles east of jct. Rts. 522 + 208,  
on Rt. 208, Sandy soil along road.  
Louisa, Virginia (Louisa Co.)

20-21 June 1970

54-1 *Solanum virginicum*

(with J.R. Gray)

55. WHMF, 8-7.

Hutchinson Memorial Forest,

Rt. 514, Amwell Road, East Millstone, Somerset Co., N.J.

9 August 1970

- Nothing Collected -

BUT *Athyrium filix-femina* site established

56 along stream floodplain

near Post Oak,

Spotsylvania Co., Virginia

56-1 *Sambucus canadensis*

20 June 1970

56-2 *Phytolacca americana* (along road)

56-3 } Sedges + *Sparganium*

56-4 }

56-5 }

56-6 }

(with J.R. Gray)

see note 66

57. In Forked River Bog,  
Forked River, N.J.

(see Dr. J. A. Quinn for  
location)  
(w. L.L. Lindauer)  
24 June 1970

57-1 *Polygala lutea*

58. Martha Bog, on Oswego River, off Rt. 563 Spur  
Burlington Co., N.J.

58 A-1 → 25 June 1970 → *Calypso ophioglossoides* (w. L.L. Lindauer)

58 B-1 → 16 June 1970 → *Cerastium* (?) (w. L.L. Lindauer)

59. Along RR Tracks, off Rt. 72, next to edge of  
Lebanon State Forest, Wheatland New Jersey

30 June 1970

59-1 *Tephrosia virginiana*

(w. L.L. Lindauer)

60. At Junction of Rts 539 + 532,  
(Pines)

New Jersey

30 June 1970

60-1 *Pteridium aquilinum*

(w. L.L. Lindauer)

61 On Rt. 28, 6 miles east of Rt. 13,  
Laurel, Delaware

19 June, 1970

61-1 *Asclepias tuberosa*

(with J. R. Gray)

62. On edge of road under *Pinus* sp.,  
Rt. 64, 1 mile west of Williamsburg, James City County,  
Virginia

19 June, 1970

62-1 *Polystichum acrostechoides*

(w/ J. R. Gray)

63 On Rt. 618, 3 miles south of Franktown, Northampton Co,  
Virginia, near woods.

(19 June 1970)

63-1 *Campsis radicans* (L.) Kl.

(w/ J. R. Gray)

64. On Rt. 64, 2.1 miles East of James City County line,  
along roadside.

James City County, Virginia

(w/ J. R. Gray)

19 June 1970

64-1 *Plantago cristata*



65. At Martha Furnace, on Oswego River at edge of  
Wharton State Forest, Burlington Co., N.J. (on Rt. 563 spur)  
16 June 1970

*Asplenium platyneuron*

*Calopogon*

*Northcium americanum* (w/ L.L. Lindauer)

66. On stream banks. - Same as site No. 56.

But Numbers 66-etc. are used (Not 56)

20 June, 1970

(w/ J. P. Gray)

66-1 *Sambucus canadensis*

66-2 *Phytolacca americana*

66-3 *Sparzanium androcladum*

66-4 *Carex lupulina*

66-5 sedge

66-6 sedge

67 7/10 mile from Rt. 72 on Rt. 534 near  
Brookville, Ocean County, New Jersey

67A- *Kalmia latifolia*

67A- *Jepsonia virginiana*

16 June, 1970

(w/ L.L. Lindauer)

67B- 21 July 1970 - 67-B1 *Panicum virgatum*

(w/ L.L. Lindauer)

68. 3.1 miles from Rt. 72, at edge of Lebanon St. Food,  
- between road & Railroad Tracks  
Wheatland, New Jersey. (w/ L.L. Lindauer)  
68-1 *Dephrosia virginica* 22 June 1970

69. At Oswego Lake on Rt. 563 Spur  
Burlington Co, New Jersey (w/ J.R. Gray & L.L. Lindauer)  
69-1 *Bromus tectorum* 22 June 1970

70.  $\frac{3}{10}$  mi. West of Chatsworth, on Rt. 532, at  
Bridge along Trail  
Chatsworth, New Jersey W  
22 June 1970  
70- *Pteridium aquilinum* (w/ L.L. Lindauer)

71. 1 mi. N of Jenkins, Rt 563, SW side of road,  
Burlington County, New Jersey 3ft x 10ft Pop.  
71-1 *Trisacum dactyloides* (w/ L.L. Lindauer)  
see Dr. Quinn for site  
(w/ L.L. Lindauer)

72. In woods (OAK-Buck-Hickory) at Rt. 1A and  
N. Kingstown, Narragansett Townline, Narragansett,  
Washington Co, R.I.

Friday May 15, 1970

- 72-1 *Trientalis borealis*
- 72-2 *Viola lanceolata*
- 72-3 *Maianthemum canadense*
- 72-4 *Ericaceae* shrub *Vaccinium*
- 72-5 *Viola* ,
- 72-6 *Ericaceae* shrub
- 72-7 *Ericaceae* shrub.
- 72-8 *Ericaceae* shrub *Vaccinium*
- 72-9 *Ericaceae* shrub.
- 72-10 *Oronia arbutifolia*

73. In swamp at Rt. 1A and Indian Trail,  
Narragansett Townline, Narragansett, Washington Co, R.I.

73-1 *Grisebana triphyllum*

Friday 15 May, 1970

74. 1/10 mile south of Atsion Lake,  
 at Rt. 206 + Railroad Tracks.  
 Atsion, Burlington Co, New Jersey  
 Saturday 30 Oct. 1970

- 74-1 *Clethra alnifolia*
- 74-2 *Eupatorium rotundifolium*
- 74-3 *Conanthes occidentalis*
- 74-4 *Chamaecyparis thyoides*
- 74-5 *Eupatorium leucolepis* (?)
- 74-6 *Spiranthes cernua*
- 74-7 *Scutellaria autumnalis* (polyphylo)
- 74-8 *Gerardia purpurea*

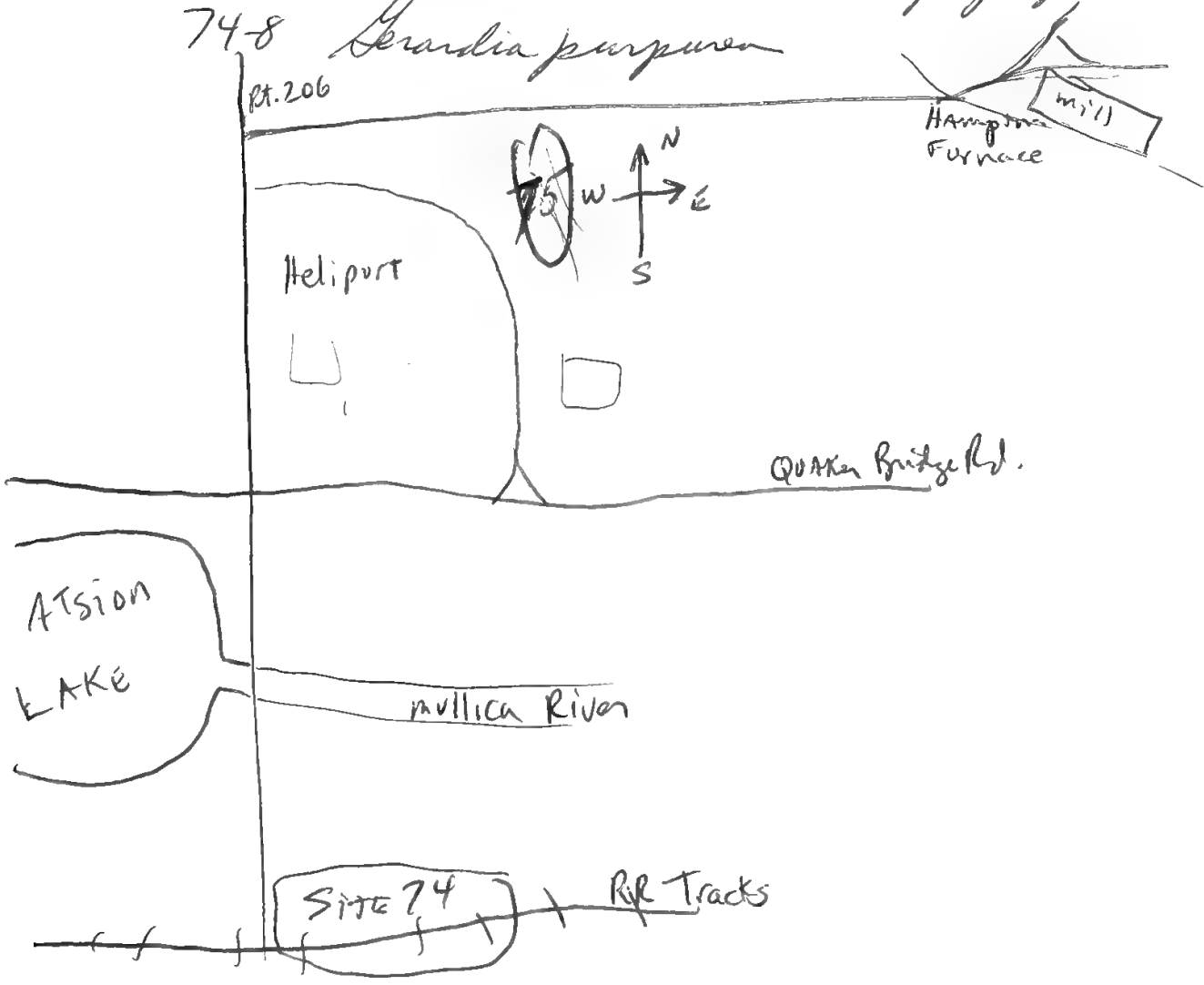

75. On Rt. 206, NE Corner of Jct w/ Quaker Bridge Rd,  
Atsion, Burlington Co, N.J.

Sat. 3 Oct. 1970

75-1 *Dryopteris spinulosa*

76. Hempton Furrow, along stream,  
Atsion area, Burlington Co, New Jersey

Sat. 3 October 1970

76-1 *Alnus*

77. Raccoon Creek, across road from lake in Ewan,  
Gloucester Co, N.J.

On Flood Plain - banks & banks of Creek

Sat. 3 Oct. 1970

77-1 *Urticaceae*

77-2 *Alnus*

77-3 *Anoda perulifolia*

77-4 *Asclepias purpurascens*

77-5 *Asarum canadense*

77-6 *Polygonum flexifolium*

77-7 *Thelypteris noveboracensis*

77-8 *Corydalis rigida*

77-9 *Epipactis atrorubra*

77-10 *Berberis thunbergii* → *Phoradendron virginicum*

77-11 *Dryopteris spinulosa*

77-12

78

off. rt. 77, Indian Run Creek  
floodplain  
Elmer-Shirley, Salem Co, New Jersey  
Sat. 3 October 1970

- 78-1 *Polygonum sagittatum*
- 78-2 *Athyrium filix femina* (var. *asplenoides*?)
- 78-3 *Pilea pumila*
- 78-4 *Onoclea sensibilis* - normal  
*Onoclea sensibilis* -  $\frac{1}{2}$  fertile -  $\frac{1}{2}$  sterile frond

79

1 mile north of Centerton, On Rt. 540, in farmers fields  
Centerton, Cumberland Co, New Jersey  
Salem  
Sat. 3 Oct. 1970

- 79-1 *Sorghum vulgare*

80

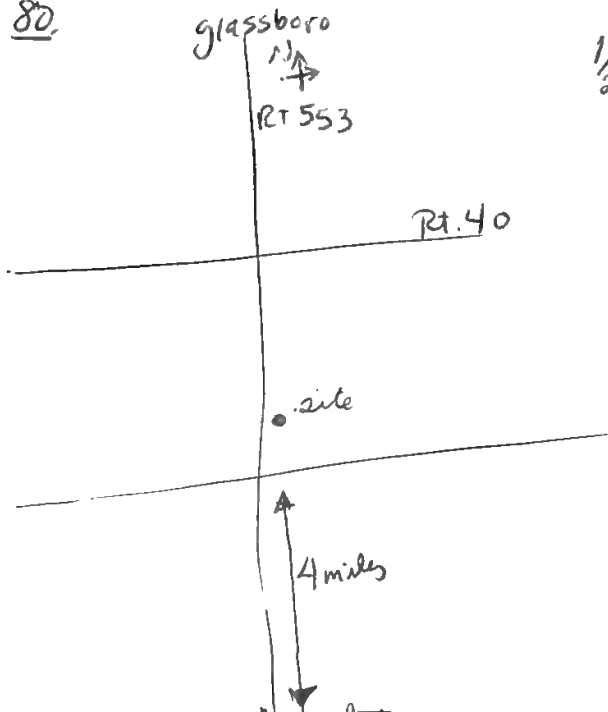

$\frac{1}{2}$  mile south of Jct. Rt. 553 x Rt. 553,  
in moist swampy woods,  
Centerton, ~~Gloucester~~ <sup>Salem</sup> Co, N.J.  
80-1 *Viburnum dentatum*  
80-2 *Woodwardia areolata*

81. 1/2 mile east of Rt. 295 on road to (N side of road in woods)  
Auburn, Gloucester Co, N.J.

Sun. Oct. 4, 1970

- 81-1 *Ilex opaca* Ait.
- 81-2 *Viburnum dentatum*
- 81-3 *Urtica alniifolia* 3
- 81-4 *Thelypteris noveboracensis* 1
- 81-5 *Dennstaedtia punctilobula*
- 81-6 *Eupatorium* 1

82 3/4 mile east of Rt. 295 on road to Auburn,  
In woods on south side of road,  
Auburn, Gloucester Co, N.J.

Sun. Oct. 4, 1970

- 82-1 *Quercus velutina*
- 82-2 *Smilax* in fruit
- 82-3 *Grapholium obtusifolium* } at edge of *Asperagus* field
- 82-4 *Anemone patens* }  
in seed.

83 On flood plain of Old Man's Creek, at Rt. 551 overpass  
NE of Auburn, Gloucester Co, N.J.  
Sun. Oct. 4, 1970

- 83-1 *Verbascum thapsus* rosette
- 83-2 *Achillea millefolium*
- 83-3 *Eupatorium perfoliatum*
- 83-4 nettle - *Laportea canadensis* (L.) Gaud.
- 83-5 8ft. shrub = *Populus alba* sprout
- 83-6 *Oroclen serotilis*
- 83-7 vine (herb) *Humulus japonicus*
- 83-8 *Ilex opaca*
- 83-9 *Verbascum thapsus* plant
- 83-10

84. Rt. 551, on first rise after bridge  
over Old Man's Creek, opposite small  
pond on east side of road.  
1/2 mi. N. of Auburn, Gloucester Co, N.J.  
Sun. Oct. 4, 1970

- 84-1 *Tripsacum dactyloides*  
(pop. size . 5-10ft X 30-40ft)



85. On road to Piedmont, off Rt. 551 ( $\frac{1}{2}$  to  $\frac{3}{4}$  mile from Rt. 551)  
Auburn, Gloucester Co., N.J.  
Moist dip w/ Beech slope

Sun. Oct. 4, 1970

- 85-1 *Athyrium filix-femina*      85-5 *Strobilium azuulinum*  
85-2 *Thelypteris noveboracensis*  
85-3 *Epipogon virginicum*  
85-4 *Asplenium cinnamomeum*

86 On the flood plain of Edwards Run,  
Rt. 45, South of Mantua, Gloucester Co., N.J.  
Sun, Oct 4, 1970

- 86-1 *Onoclea sensibilis*  
86-2 *Pilea fontana*

87. Along Rocktown Westville Road  
East Amwell Twp, Hunterdon Co., N.J.

Sat. 26 Sept. 1970

- 87-1 *Adiantum pedatum*  
87-2 a - *Athyrium filix-femina* Green Stipe      87-2b - Red stipe      87-2c - Near average  
87-3 *Polystichum acrostichoides*  
87-4 *Thelypteris noveboracensis*  
87-A-1 *Athyrium filix-femina* in Lafort Drive way

(w/ E. Lafort)

88 Lake View Drive, (Rocktown)  
West Amwell Twp. Hunterdon Co, N.J.

Sept 26, 1970

88-1 *Dryopteris spinulosa*

88-2 *Polystichum acrostichoides*

(w/ E. Laport)

89 near Rock Road

West Amwell Twp, Hunterdon Co, N.J.

Sept. 26, 1970

89-1 *Athyrium filix-femina*

(w/ E. Laport)

90 Delaware Township line, Hunterdon Co, N.J.  
(in old moist field)

Sat. Sept. 26, 1970

90-1 *Lenticona crinita*

(w/ E. Laport)

91 Along Bailey Hollow Road, 1/2 mile from Rt. 202,  
Morristown, Morris Co, New Jersey

Sat. 10 Oct. 1970

91-1 *Thelypteris noveboracensis*

91-7 *Demissa punctiloba*

91-2 *Osunda cinnamomea*

91-3 *Athyrium* sp. red stipe

91-4 *Athyrium* sp. green stipe

91-5 *Viburnum acerifolium* fruit

91-6 *Pteridium aquilinum*

92 On edge of abandoned field, on Tempelwick Road,  
E.  $\frac{1}{2}$  mile from Rt. 202,  
Morristown, Morris Co, N.J. 10 Oct. 1970

92-1 *Aster novae-belgii* in flower

92-2. *Conus floridanus* in fruit

93. At edge of bog along Rt. 206,  $\frac{1}{2}$  mile north of  
Mullica River, Atsion, Burlington Co, N.J.  
Sun. Oct. 11, 1970.

93-1 *Woodwardia virginiana*

94. On road to Hampton Furnace (3 mi from Rt 206,  
 $\frac{1}{4}$  mile N. of Atsion, Burlington Co, N.J.  
Sun 11 Oct. 1970

along stream floodplain

94-1 *Lyzodium palustre*

94-2 *Polygonella articulata*

↑  
in pine soil w/ *Hudsonia tomentosa*

95. In old cranberry bog, Hampton Furnace,  
Atsion, Burlington Co, N.J. Sun. 11 Oct. 1970

95-1 *Vaccinium macrocarpon* in fruit

96. Along R.R. tracks, south of Mullica River on Rt. 206  
Olson, Burlington Co., N.J.

Sun, 11 Oct. 1970

96-1 *Polygala lutea*

97. SW. corner, Jct. Rts. 532 and 206,  
Burlington County, New Jersey

Sun, 11 Oct. 1970

97-1 *Oenoclea sensibilis*

97-2 *Eupatorium rotundifolium* var. *ovatum*

97-3 *Eupatorium pilulosum* (*E. rotundifolium* var. *laundersonii*)

98. SE. Corner of Rt. 130 and Budgeboro Rd.,  
along Rancocas Creek,  
Delran, Burlington Co., N.J.

Sun 11 Oct. 1970

98-1 *Catalpa speciosa* in fruit

99. along Clay Street, (SE. corner Rt. 130 + Budgeboro Rd.)  
Delran Twp., Burlington Co., N.J.

Sun 11 Oct. 1970

99-1 *Eupatorium rugosum*

100. 1/2 mile south of South Bridge Road.  
Delran Twp., Burlington County, N.J.

Sun Oct. 11, 1970

100-1 *Eupatorium rugosum*.

101 1/2 mi north of Moorestown - Centertown Road,  
on Creek Road (1/4 mi. SW, in woods near stream)  
Moorestown Twp., Burlington Co., N.J.

Sun. Oct. 11, 1970

101-1 *Lycopodium obscurum*

101-2 *Lycopodium complanatum*

102 Rt. 542, 9/10 mi. N. of Batsto, Behind  
Batsto - Pleasant Hill United Methodist Church,  
Batsto, Atlantic Co., N.J.

Mon Oct. 12, 1970

Oct. 12, 1970

Monday

102-1 *Polygonella articulata*

(w/ Arthur O. Tucker  
& Sharon Smith)

102-2 *Alex glabra* infruit

102-3 *Chamaecyparis* infruit

102-4 *Alex opaca* infruit (orange)

102-5 *Pellia epiphyllum* (Linn.)

Oct 22, 1970

Thursday

102B-1 *Lerophyllum brevifolium* infruit

102-3b Sedge *Rhynchospora*

103 Martha Bog, off Rt. 563 spur (w A. O. Tucker  
Burlington Co., N.J. + Sharon Smith)

Mon 12 Oct. 1970

- 103-1 *Lycopodium inundatum biglovii*
- 103-2 *Lycopodium alopecuroides*
- 103-3 *Schizaea pusilla*

104. On Hunee Hollow Road (along road + in woods)  
1/2 mile North of Boulder Hill Road,  
South E. of Califon, Hunterdon Co., N.J.

Sat. Oct. 17, 1970

- 104-1 *Allyrium filix femina*
- 104-2 *Equisetum arvense* (w. A. J. Ossi)
- 104-3 *Thelypteris noveboracensis*
- 104-4 *Dryopteris marginalis*
- 104-5 *Polypodium acrostichoides*
- 104-6 *Eupatorium*

105. On Boulder Hill Road,  $\frac{1}{5}$  mile off Fenner Hollow Road,  
SE of Califon, Hunterdon Co, N.J.

Sat. 17 Oct. 1970

- 105-1 *Botrychium virginianum*  
105-2 *Botrychium dissectum dissectum*  
105-3 *Athyrium filix-femina*  
105-4 *Dryopteris marginalis*  
105-5 *Dennstaedtia punctilobula*  
105-6 *Epifagus virginiana*  
105-7 *Polystichum acrostichoides*

(w/A. J. Ossi.)

106, A. On Boulder Hill Road,  $\frac{1}{2}$  mile from Sutton Road,  
SE of Califon, Hunterdon Co, N.J.

Sat. 17 Oct. 1970

(w/A. J. Ossi.)

- 106A-1 *Athyrium filix-femina*

106B at jet of Boulder Hill Road, on Sutton Road, (edge of pasture)  
SE of Califon, Hunterdon Co, N.J.

Sat. 17 Oct. 1970

(w/ A. J. Ossi.)

- 106B-1 *Cornus racemosa*

107.  $\frac{1}{4}$  mile east of Rt. 517 on Rt. 512,  
East of Fairmont Methodist Church. (w/ A. J. Ossi)  
Fairmont, Hunterdon Co..

Sat. 17 Oct. 1970

107-1 *Polygonum cuspidatum* - At edge of lawn of house  
with potato fence.

108.A  $\frac{3}{4}$  mile East of Rt. 517 on Rt. 512  
near Lemington River, Fairmont, Hunterdon Co, N.J.

Sat. 17 Oct. 1970

108 A-1 *Dryopteris marginalis* (w. A. J. Ossi)

108B 2 miles from Rt. 517 on Rt. 512, edge of road  
Fairmont, Hunterdon Co, N.J.

Sat. 17 Oct. 1970

108B-1 *Sorghum halpense* (L.) Pers. (w/ A. J. Ossi)



109. In cemetery on Morris Street, between Livingston Ave.  
and George Street  
New Brunswick, Middlesex Co., N.J.

Sat. 17 Oct. 1970

- 109-1 *Coccoloba platanoidea* in fruit
- 109-2 *Linaria vulgaris*
- 109-3 *Leprosia officinalis*
- 109-4 *Solanum dulcamara* in fruit
- 109-5 *Eupatorium dulcissimum* (?)
- 109-6 *Lycopodium americanum*
- 109-7 *Phytolacca americana*
- 109-8 *Asparagus officinalis*

110. 1/2 mile East of Pt. 1A on Wampanoag Road,  
Bonneth Shores (Narragansett), Washington Co., R.I.

Sun. Oct. 25, 1970

Climbing over trees & shrubs

- 110-1 *Celastrus orbiculata*

111. At end of Capt. Freebody Road, on beach of  
Narragansett Bay, Narragansett (south of Narragansett Pier)  
Washington Co., Rhode Island.

Sunday Oct. 25, 1970

- 111-1 *Spartina*
- 111-2 *Rudbeckia hirta*
- 111-3 *Achillea millefolium*
- 111-4 *Lycopus americanus*
- 111-5 *Daucus carota*
- 111-6 *Myrica pennsylvanica*
- 111-7 *Solidago serotina*
- 111-8 algae
- 111-9 algae
- 111-10 ~~*Aster novi-belgii*~~ Kelp.
- 111-11 kelp
- 111-12 algae
- 111-13 algae
- 111-14 algae
- 111-15 *Aster novi-belgii*

112 Near Lighthouse, around Phragmites swamp,  
Point Judith, Washington Co., Rhode Island.

- 112-1 *Phragmites communis*
- 112-2 *Juncus vulgaris*
- 112-3 *Myrica pennsylvanica*

SUN - OCT. 25, 1970

113A at State Boat landing on Warden Pond, On Warden Pond Road.  
Tuckertown, Washington County, Rhode Island.

- 113A-1 *Osmunda cinnamomea* Sun 25 Oct. 1970  
113A-2 *Clethra alnifolia*  
113A-3 *Myrica gale*  
113A-4 *Betula populifolia*

113B across road from site 113A

Sun. Oct. 25, 1970

- 113B-1 *Lycopodium obscurum*

114 1 mile south of Larken Pond, on Ministerial Road (edge of <sup>BOG</sup> swamp)  
Kingston, Washington County, Rhode Island.

- 114-1 *Spiraea tomentosa* in fruit Sun. Oct. 25, 1970  
114-2 *Rhododendron maximum*  
114-3 *Chamaecyparis thyoides*

115 Shrub planted at Hickman Hall, Douglas College,  
New Brunswick, Middlesex Co, New Jersey

Sat. Oct. 24, 1970

- 115-1 *Berberis julianae* in fruit

116 Rhode Island Historical Cemetery #95,  
on U.S. Rt. 1, South Kingstown, Washington Co., R.I.  
Monday 26 Oct. 1970

- 116-1 *Athyrium filix-femina*  
116-2 *Eupatorium perfoliatum*  
116-

117. In Channel under Wickford Bridge, Rt. 1A (Brantash Water)  
in heart of Wickford, Washington Co., R.I.  
-On rocks at water level. Mon. 26 Oct. 1970

- 117-1 Algae - *Ascophyllum nodosum*

118 At the south edge of Old Mountain field,  
Old Mt. Road + Rt. 108,  
South Kingstown, Washington Co., R.I.  
Mon. Oct. 26, 1970

- 118-2 *Athyrium filix-femina*  
118-3 *Thelypteris noveboracensis*

119 Rt. 1A, on south side of Narrow River Inlet,  
Narragansett, Rhode Island.  
tree 3-4 ft. dbh Mon. 26 Oct. 1970

- 119-1 *Populus cordicans* (*P. gileadensis*) Twig

120 South of Nanagansett - N. Kingstown Town lines,  
Nanagansett, Washington Co, R.I. Wed. Oct. 28, 1970

No collections

122 Hoosier Highlands - Ravine, etc.  
Hoosier Highlands, Washington Twp, Putnam County,  
Indiana.

AIBS - Amer Bryological & Lichenological Society Foray. (Winona Welch leader)

Sunday, 23 August 1970

- |        |                             |        |                               |
|--------|-----------------------------|--------|-------------------------------|
| 122-1  | <i>Polytrichum ohioense</i> | 122-15 | Fissidens                     |
| 122-2  |                             | 122-16 | <i>Conocymbium crum</i>       |
| 122-3  | <i>Atrichum angustatum</i>  | 122-17 |                               |
| 122-4  | <i>Atrichum angustatum</i>  | 122-18 | <i>Basidium pleurozoum</i>    |
| 122-5  |                             | 122-19 | <i>Reboulia hemisphaerica</i> |
| 122-6  |                             | 122-20 | <i>Parmelia bolleana</i>      |
| 122-7  | lichen                      | 122-21 | <i>Pyrenopeziza</i>           |
| 122-8  | <i>Parmelia puberula</i>    | 122-22 | Fissidens                     |
| 122-9  | <i>Parmelia</i>             | 122-23 | <i>Parmelia</i>               |
| 122-10 |                             | 122-24 | <i>Rhodoglyphum</i>           |
| 122-11 | <i>Cladonia</i>             | 122-25 | <i>Clinocum dendroica</i>     |
| 122-12 | liverwort                   | 122-26 | <i>Cladonia furcata</i>       |
| 122-13 | <i>Junonia</i>              | 122-27 | <i>Ptilodermis</i> ?          |
| 122-14 |                             | 122-28 | <i>Leurocladon attenuata</i>  |

- |        |                             |        |              |
|--------|-----------------------------|--------|--------------|
| 122-29 | <i>Leucobryum glaucum</i>   | 122-36 | <i>unisa</i> |
| 122-30 | lclm                        | 122-37 | <i>Mnium</i> |
| 122-31 | <i>Arctium angustatum</i>   | 122-38 | lichen       |
| 122-32 | <i>Pectanema pomiformis</i> | 122-39 | lichen       |
| 122-33 | <i>Bosidia</i>              | 122-40 | grass        |
| 122-34 | <i>Buxidia schweingeri</i>  | 122-41 | grass        |
| 122-35 | <i>Cladonia</i>             |        |              |

W/ *Utricularia* Welch, } a few I.D. ed.  
 I.W. Broder  
 Tom Nash  
 et al. of Bryol. Lichen. Group

121 Narragansett Bay, at Captain Freebody Street, South  
 of Narragansett Pier, Washington County, Rhode Island.  
 Washed onto beach. Temp. = 2°C

Thursday 24 Dec. 1970

121-... Algae in A.O. Tucker's Herbarium + Chrysler Herbarium  
 (Rutgers U.)

123 Narragansett Bay, at Colonel John Gardner Road,  
 Bonnet Shores, North of Narragansett Pier,  
 Washington Co., R.I. Washed on shore

Temp. = 2½°C

Friday Dec. 25, 1970

123-... Series in A.O. Tucker's Herbarium and  
 Chrysler Herbarium at Rutgers U.

124 Rutgers University, Dept. Botany Greenhouse.

Piscataway Twp., Middlesex Co., New Jersey

10 January 1971

124-1 *Impatiens SULTANII* Hooker f. *Oxalis rubra* M. Hill.

124-2, 124-7 - *Codiaeum variegatum* var. *PICTUM*

124-3

124-4 *PACHIRA INSIGNIS*

124-5 *SPATHIPHYLLUM PATINII* N.E. Br.

124-6 *CHORISIA SPECIOSA*

124-8 *FITTONIA VERSCHAFFELII*

124-9 *RAUWOLFIA VERTICILLATA*

124-10 *BEGONIA MACULATA*

124-11 *Begonia heracleifolia* Champ

124-12 *MYRTUS COMMUNIS* microphylla

124-13 *EUPHOBIA TIRUCALLI*

124-14 *BRACHYCHITON POPULNEUM?*

124-15 *CASUARINA EQUisetifolia*

124-16 *BERRYA CARDIFOLIA*

125- at edge of Intertown-Zion road, 1.5 miles east of  
get north on Oak Road. Skillman, Morristown Twp.,  
Somerset County, New Jersey.

Saturday 8 May 1970

125-1 *Cyperus* sp.

125-2 *Phyllanthus hexaganglion*

125-3 *Polygonum* sp.

125-4 *Heliconia filifera* var. *inflorunda* (?)

~~(See #27)~~  
(See #27?)

126 - On bank of Pettaquamscutt River, at end of  
Indian Trail, Narragansett, Washington Co., R.I.

Sat. 10 April 1971

126-1 *Kalmia angustifolia* var. *montana*

124-17 *BRACHYCHITON POPULNEUM?*

124-21

*Bombax ceiba*

124-18 *Polocarpus macrophylla*

124-22

*ARAUCARIA CUNNINGHAMII*

124-19 *SOLANDRA GUTTATA*

124-23

*ARAUCARIA BIDWELLII*

124-20 *ANTHURIUM?*

#127 In a depression with other trees of same species, on  
Bow Run Rd. off Indian Trail. Nonogansett, Washington Co,  
Rhode Island. 30-40ft. tall trees  
127-1 *Pinus resinosa* 10 April 1971

#128 Formerly cultivated in Kelgrant Boy Scout Reservation,  
off Rt. 1A, Saunterstown, Washington Co, Rhode Island.  
10 April 1971  
#128-1 *Picea glauca* 10-15ft. trees

#129 Along Buell Brook, Kilmer Woods, near Bunkers, near  
Livingston College, Rutgers Univ.  
Piscataway Twp., Middlesex Co, N.J.  
129-1 *Erythronium americanum* 17 April 1971  
129-2 *Podophyllum peltatum*

#130 along Road (at Livingston College) in Kilmer Woods.  
Rutgers Univ. Piscataway Twp. N.J.  
17 April 1971  
130-1 *Acer Rubrum*



#131 The Horticulture display Gardens of Rutgers University  
Rt. 1 and Ryders Lane, New Brunswick, New Jersey

Thursday 22 April 1971

- |        |                                 |        |  |
|--------|---------------------------------|--------|--|
| 131-1  | <i>Pieris japonica</i>          | 131-11 | <i>Spiraea thunbergii</i>                            |
| 131-2  | <i>Rhododendron reticulatum</i> | 131-12 | <i>Taxus media</i> 'Hickii'                          |
| 131-3  | <i>Lindera benzoin</i>          | 131-13 | <i>Taxus cuspidata</i>                               |
| 131-4  | <i>Rhododendron Kosteri</i>     | 131-14 | <i>Pinus strobus fastigiata</i>                      |
| 131-5  | <i>Corylopsis spicata</i>       | 131-15 | <i>Pinus thunbergii</i>                              |
| 131-6  | <i>Forsythia viridissima</i>    | 131-16 | <i>Pinus sylvestris</i>                              |
| 131-7  | <i>Hamamelis serralis</i>       | 131-17 | <i>Chamaecyparis pisifera</i><br><i>plumosa var.</i> |
| 131-8  | <i>Cornus mas</i>               | 131-18 | <i>Chamaecyparis obtusa compacta</i>                 |
| 131-9  | <i>Magnolia kobus borealis</i>  | 131-19 | <i>Larix decidua</i>                                 |
| 131-10 | <i>Spiraea arcata</i>           | 131-20 | <i>Betula virginiana</i>                             |
|        |                                 | 131-21 | <i>Betula davurica</i>                               |
|        |                                 | 131-22 | <i>Betula mandshurica</i>                            |
|        |                                 | 131-23 | <i>Lonicera fragra. hirsuta</i>                      |

#132 Rutgers University Botany Greenhouse  
University Heights, (Rutgers), Piscataway, N.J.

27 April 1971

- |       |  |       |                                |
|-------|--|-------|--------------------------------|
| 132-1 | <i>Clerodendrum thomsoniae</i> Salisb. | 132-6 | <i>Ruellia ciliosa</i> Pursh.  |
| 132-2 | <i>Scaevola verticillata</i>           | 132-7 | <i>Episcia cupreata</i> Horst. |
| 132-3 | <i>Fibrisia rosa-sinensis</i> L. (2)   | 132-8 | <i>Rhoeo discolor</i> Stance   |
| 132-4 | <i>Fuchsia hybrida</i> Voss            | 132-9 | <i>Tacca chantrieri</i>        |
| 132-5 | <i>Jacobinia obtusior</i> Bailey       |       |                                |

#133 front lawn of Nelson Biological Laboratories, University Heights (Rutgers),  
Piscataway, Middlesex Co., New Jersey 29 April 1971.

133-1 *Juncus effusus*

133-2 *Barbarea vulgaris*

133-3 *Il.*

Cruciferae yellow

Cruciferae wt.

} common  
weeds in  
lawn

#134 at front of Douglas Coop Store, Douglas College,  
Nichol Ave. New Brunswick, New Jersey

8 Feb. 1971

134-1 *Pseudotsuga menziesii* (Mill.) Franco.  
cultivated

#135 in cultivation at NE corner of Lipman Drive and  
Greenhouse Lane, near Blake Hall,  
College of Ag. & Environ. Sci., Rutgers Univ.  
New Brunswick, Middlesex Co., New Jersey

8 Feb 1971

#135-1 *Pinus sylvestris* L.

#136 cultivated, at corner of Brett Road near  
Physics accelerator,

Rutgers Univ., University Heights, Piscataway,  
Middlesex Co., New Jersey

30 Jan., 1971

#136-1 *Pinus nigra* Arnold

#137 in oak woods near - Math - Statistics Bldg + College  
of Engineering Bldg. on Frelinghuysen Rd., Rutgers Univ.  
New Brunswick, New Jersey (Univ. Heights.)

2 May 1971

137-1 *Claytonia virginica*

137-2 *Amelanchier canadensis*

#138 Kilmer Woods, near Livingston College.  
Rutgers University, Piscataway, Middlesex Co., N.J.  
Tues. 4 May 1971.

138-1 *Dentaria laciniata* Muhl. along Suell Brook

138-2 *Acer rubrum* L. on roadside

138-3 *Cornus florida* L. on road side.

138-4 *Setula populifolia* <sup>Morsh</sup> on road side of woods near Livingston College

138-5 *Fragaria virginiana* <sup>Duchesne</sup> on dry bank near ditch, edge of field.

#139 in Woods next to Davidson Hall, Davidson Road, Univ. Heights,  
Rutgers University, Piscataway Twp., Middlesex Co., N.J.

7 May 1971

139-1 *Bromus tectorum* several plants at edge of woods

139-2 *Acer rubrum* several plants at edge of woods

139-3 *Claytonia virginica* extremely common in woods

147 - on flood plain, slope of river, north of  
Dean Rhode Hall Rd., on Rt. 130  
South Brunswick Twp., Middlesex County, N.J.

29 May 1971

- 147-1 *Crataegus trichyllus* v. *trichyllus*  
147-2 *Maianthemum canadense*  
147-3 *Sambucus racemosa*  
147-4 *Osunda cinnamomea*

148 - at edge of road and farmer's field.  
on Skilling's Rd. at So. Middlebush Rd.  
2 miles south of Middlebush, Somerset Co., N.J.

29 May 1971

- 148-1 *Euphorbia esula* L.

149 - In woods along stream bed -  
Davidson Rd. at Metlars Lane, Piscataway Twp.,  
Middlesex County, New Jersey

- 149-1 *Crataegus trichyllus* v. *trichyllus*

26 May 1971

150 - On New Road, 1/2 mile west of Rt. 1  
 Kendall Park, Middlesex Co., New Jersey. 6 June, 1971  
 on north side of road, at edge of cleared area, sandy.

- |     |   |  |                  |        |                |
|-----|---|--|------------------|--------|----------------|
| 150 | 1 | <i>Robinia pseudo-acacia</i> L.                      | 3 (8" DBH) trees | (Leg)  |                |
| 150 | 2 | <i>Melilotus officinalis</i> (L.) Desr.              | 3 ft. tall clump | (Leg.) |                |
| 150 | 3 | <i>Bromus tectorum</i> L.                            | (Grain.)         |        | } on Sand Pile |
| 150 | 4 | <i>Rosa multiflora</i> Thunb.                        | (Rosa)           |        |                |
| 150 | 5 | <i>Solanum dulcamara</i> L.                          | (Solan.)         |        |                |
| 150 | 6 | <i>Linaria canadensis</i> (L.) Dum.                  | (Scroph.)        |        |                |
| 150 | 7 | <i>Silene cucubatus</i> Wibel.<br><i>Lycnis alba</i> | (Caryophyll.)    |        |                |

151 - on New Road, at NW corner of Rt. 1,  
 cleared swampy area.  
 Kendall Park, Middlesex Co., New Jersey 6 June 1971

- |     |   |  |  |
|-----|---|--|--|
| 151 | 1 | <i>Osmunda cinnamomea</i> L.                   |  |
| 151 | 2 | <i>Osmunda pycnostachya</i> L.                 |  |
| 151 | 3 | <i>Denostachya pycnostachya</i> (Michx.) Moore |  |
| 151 | 4 | <i>Medeola virginiana</i> L.                   |  |
| 151 | 5 | <i>Viburnum acerifolium</i> L.                 |  |

152- along bank at railroad tracks on  
Curtis Corner Road.

Peace Dale, Washington Co, RI

20 May 1971

152-1 *Comandra Claytonia* L.

152-2 *Equisetum arvense* L.

153 in old field in Kilmer Woods, Rutgers Univ.  
Piscataway Twp, Middlesex Co, N.J.

13 May 1971

153-1 *Myrica pa. Level*.

153-2

154. along ridge near Suell Brook in Kilmer  
woods, Rutgers Univ.

Piscataway Twp, Middlesex Co., New Jersey

15 May 1971

154-1 *Serenoa Humbertii* DC

155 along Suell Brook in Kilmer Woods, Rutgers U.  
Piscataway Twp, Middlesex Co, New Jersey, 15 May

155-1 *Alliaria officinalis* Andrz.

155-2 *Euphorbia hirsuta* L.

155-3 *Verbena pringlei*

156- on disturbed soil on edge of Wyndsworth Rd  
at Old Boston Neck Rd. (off Rt. 1A)  
Newagansett, Washington Co., R.I. 20 May 1971

156-1 *Barbarea vulgaris* R. Br.

157- along swamp at edge of Curtis Corner Rd near  
Rt. 108.

Peace Dale, Washington Co., R.I. 20 May 1971

157-1 *Acer rubrum* L. ang fruit

158 at edge of trail in Kilmer Woods, Rutgers Univ  
Piscataway Twp., New Brunswick, New Jersey

15 May 1971

158-1 *Cornus florida* L.

159 East side of East Middle Brook at Stillada Road,  
North of Chimney Rock, Somerset County, N.J.

159-1 *Geranium maculatum* L. (Geranium) (fruit)

159-2 *Lycopodium obscurum* L. (Lycopodium)

159-3 *Myosotis sicipioides* L. (forget me not)

159-4 *Ornithogalum umbellatum* L. (Lily of the valley)

159-5 *Simplicium album* (?) (Lily of the valley)

159-6 *Equisetum arvense* L. (Equisetum)

159-7 *Trifolium repens* L. (Trifolium)

160 . at edge of Route 70 , in Pine plains,  
appr. 2 miles ~~southwest~~ <sup>North, West of</sup> jct. with Rt 539.  
Cedar Bridge, Ocean County, New Jersey

160-1 Xerophyllum asphodeloides (L.) Nutt.

160-2 Lyonia mariana (L.) D. Don

161- along Road , at edge of field , Kilmer Woods.  
Rutgers Univ., Piscataway Twp., Middlesex Co., N.J.

16 June 1971

161-1 Echium vulgatum (Boraginaceae)

162- along damp ditch at edge of Road .  
Black Point Road, 1/5 mile south of Woodfern Road.  
Neahanic Station Somerset Co., N.J.

19 June 1971

162-1 *Aerolium* (maximil.)

162-2 *Polygonatum commutatum*



163 along banks of dry (damp) stream junction into  
The south side of Mechanic River at  
Black Point Road, Mechanic Station, Somerset Co., N.J.  
19 June 1971

- 163-1 *Pryopteris*  
163-2 *Athyrium filix-femina* Michxauxii  
163-3 *Equisetum arvense*  
163-4 *Polystichum acrostichoides*  
163-5 *Oxoclea pensilvanica*

164 in deep woods off Linvale Rd.  
2 mi. from Rt. 31, Linvale, Hunterdon Co., N.J.  
19 June 1971

- 164-1 *Podophyllum peltatum* in fruit

165 on steep, dry road bank on rd to Woodville Rd,  
3/4 mi. SE of Linvale (Rt 31), Hunterdon Co., N.J.  
19 June 1971

- 165-1 *Pentstemon digitalis* - abundant on road banks

166

at the foot of Delaware Avenue,  
(near Delaware River), Fieldboro,  
Surlington County, New Jersey

20 June 1971

Along the Railroad tracks

166-1 *Amorpha fruticosa* L. <sup>Legumin</sup> (false Indigo bush)  
3-7 ft. tall, common

Along road parallel to tracks

166-2 *Heracleum maximum* - <sup>in fruit</sup> common 20-30 plants

166-3 *Alliaria officinalis* <sup>in fruit</sup>

166-4 *Bromus tectorum* L. <sup>in fruit</sup>, drying out

166-5 *Achillea millefolium* <sup>in flower</sup>

166-6 *Rubus phoenicolasia* Maxim - <sup>not common</sup>  
<sup>young plants.</sup>

also growing in area *Morus rubra* + *Morus alba* (<sup>in fruit</sup>  
<sup>ripe</sup>)

*Rhus radicans*, *Rhus* sp., *Eugenia* sp.,

167

along edge of road behind College of Engineering  
Rutgers Univ., Piscataway Twp., Middlesex Co., New Jersey

14 June 1971

167-1 *Cornus racemosa*

167-2 *Tragopogon*

167-3 *Vicia cracca*

#168 at the end of Capt. Freebody Rd, Along Narragansett  
Bay. Narragansett, Washington Co, R.I.

12 June 1971

168-1 Ranunculus

168-2 Equisetum arvense L.

#169 on beach of Narragansett Bay, at end of So Ferry Rd.  
Narragansett, R.I.

12 June 1971

169-1 Lathyrus japonicus

170-~~(#169)~~ common  
on Beach of Narragansett Bay, at end of  
So. Ferry Rd, Narragansett, Washington Co, RI  
12 June 1971

170-1 *Lathyrus japonicus*

171~~(#168)~~ at the end of Capt. Freebody St., along Narragansett  
Bay, Narragansett, Washington Co, RI  
(north of Pt. Judith)  
12 June 1971

171-1 *Ranunculus*

171-2 *Equisetum arvense* L.

172- along edge of road to Pettaquamscutt Rock,  
near Mitchell Rd (8 plants)  
So. Kingstown, Washington Co., RI  
13 June 1971

172-1 *Heracleum maximum*

173-1 along edge of pond at Pt. Judith Coast Guard  
Station, Pt. Judith, Washington Co, RI  
12 June 1971

173-1 *Equisetum arvense* L.

174 Ministerial Road. 2 mi. S. of RR Tracks formerly cultivated  
 Kingston, Washington Co, RI

174-1 *Leucochoe racemosa* editorum Fern. & Schub 12 June 1971

175 At the southern shore of Worden Pond  
 near boat launch on Worden Pond Road,  
 Suckertown, Washington County, Rhode Island. 25 July, 1971

floating plants

175-1 *Nymphaea odorata* <sup>265</sup> fl *Nymphaea odorata* Nymphaeaceae

erect aquatic plants

175-2 *Portulaca cordata* L. <sup>172</sup> fl fr *Portulaca cordata* Portulacaceae

175-3 *Juncus mitis* ? <sup>175</sup> fl-fr Juncaceae

plants in *Juncus* mud areas closer to shore

175-4 *Hydrocotyl umbellata* (L.) <sup>416</sup> rhizome in mud *Hydrocotyl umbellata* Umbellif. st.

175-5 *Sparganium angustifolium* Michx. <sup>482</sup> mud rhizome in mud. *Sparganium angustifolium* Sparganiaceae fl.

175-6 *Sagittaria graminea* Michx. <sup>51</sup> *Sagittaria graminea* Alismaceae fl.

175-7 *Utricularia vulgaris* (L.) <sup>418</sup> *Utricularia vulgaris* Utriculariaceae fl.

175-8 ? rhizome in mud. st.

176 Kelgrant Boy Scout Reservation,  
 townline of Narragansett and No. Kingstown  
 (Saunderstown, Washington Co, R.I.)

along flood plain of stream

34

Woodwardia

25 July 1971

areolata (L.) Moore

Bigfoot.

176-1 *Lorinseria areolata*

fr + st.

in dry Oak-Beech woods

176-2 *Maianthemum Canadense* Pursh

185

fr

Liliaceae

176-3 *Smilacina racemosa* (L.) Desf.

185

4:4

fr.

Liliaceae

176-4 *Chimaphila maculata* (L.) Pursh

192

fl

Ericaceae

176-5 *Cypripedium acaule* Aiton.

17

fr

Orchidaceae

176-6 *Lycopodium complanatum* L.

17

fr

Lycopodiaceae

along road in woods

176-7 *Melampyrum lineare* Desr.

488

fl.

Scroph.

Prunellaceae

176-8 *Lysimachia quadrifolia* L.

436

fr.

†

176-9 *Rumex acetosella* L.

234

fr.

Polygonaceae

176-10 *Prunella borealis* Raf.

438

fr.

Prunellaceae

176-11

177 on west edge of major body of Wessquage Pond,  
 at road edge. (tidal ponds) Bonnet Point Road,  
 Bonnet Shore, Narragansett, Washington Co, R.I.

26 July 1971

In shallow water edge

- 177-1 ~~Najas flexilis (Willd.) Rostk & Schmidt~~ <sup>happi - major fixa</sup> or <sup>N. gracillima</sup> <sup>A. B. S. Magnus</sup>  
 177-2 Potamogeton perfoliatus L. or P. Richardsonii (Gunn.) Rydberg.

In Typha at edge of Pond

- 177-3 Asclepias purpureus L. (Osclep.) ll

On road edge

- 177-4 Linaria vulgaris <sup>(Scroph.)</sup> canadensis (L.) Dumort.  
 177-5 Plantago major L. ll  
 177-6 Cephalanthus occidentalis L. (Rubiaceae)  
 177-7 Sambucus canadensis L. (Caprif)  
 177-8 Apis americana Medicus (Legum.)  
 177-9 Lychnis coronaria (L.) Dosa. <sup>251</sup> (Caryophyl.)  
 177-10 Verbena hastata v. hastata L. (Verbenaceae)  
 177-11 Rumex acetosella L. (Polygonaceae)  
 177-12 Scleranthus <sup>(Perennis L.)</sup> (annuus) L. <sup>perennis?</sup> (Caryophyll.)  
 177-13 - ? white fl. tony plant.

At edge of pond

- 177-14 Lycopodium americanum Michx Solrabe  
 177-15 Boehmeria cylindrica (L.) Sw

179 On beach of Narragansett Bay, at the end of  
South Ferry Road, Univ RI Oceanography Institute  
Narragansett, Washington Co, RI

26 July 1971

179-1 in rocks above waterline

*Callile edentula* (Bigel) Hook (fr-fl)

179-2 *Salsola Kali* L.

(st, to fr)

along road in sand

179-3 *Trifolium arvense* L.

(fl.)

Leguminosae

180 Sand  
on bay edge of land, above shore at  
Edge of Capt. Freedy Rd

Narragansett Bay, north of Point Judith,  
Washington Co, R.I.

27 July 1971

few plants at edge of grassy area

180-1 *Callile edentula* (Bigel) Hook (fr) Cirsaceae

180-2 *Anagallis arvensis* f. *arvensis* L. (fl-fr) Primulaceae  
few, scattered plants, nested in between rocks.



181- along edge of Fairview Road, off  
Bonnet Shores Road.

Bonnet Shores Fire District, Narragansett,  
Washington County, Rhode Island

3 AUGUST, 1971

181-1 *Onoclea sensibilis* var. *sensibilis*

181-2 *Onoclea sensibilis* var. *obtusilobata*  
var. *obtusilobata* apparently due to  
plants being cut down earlier in season

181- In <sup>among</sup> Rocks along Bayside 19 August, 1971  
of Col. John Gardner Road. at King Philip Road.  
Bonnet Shores Fire Dist. NARRAGANSETT, RI

181-B succulent.

~~181-5 - succulent type~~

in weeds + *Rosa multiflora* along edge of  
Col. John Gardner Rd. - near Bonnet Shores Road  
Bonnet Shores Fire Dist., NARRAGANSETT, RI

10 AUG. 1971

181-4. ~~M. k...~~ *Cynanchum nigrum* L. fr.

182 In swampy area on SW corner of jet.

Indian Trail and Boston Neck Rd (Rt 1A)

Narragansett, Washington County, Rhode Island

- 182-1 *Woodwardia virginica* (L.) Sm. fr. + st. 19 Aug. 1971
- 182-2 *Sporogonium americanum* Nutt. fl. + fr. Sparganiaceae
- 182-3 *Impatiens Capensis* Meerb. fl. + fr. Balsaminaceae
- 182-4 *Crisaema triphyllum* (L.) Schott fr. Araceae
- 182-5 *Oxocba sensibilia* L. fl. + fr.
- 182-6 *Clethra alnifolia* L. fl. + fr. of previous yr. Clethraceae
- 182-7 *Rhexia virginica* L. fl. + fr. Melastomaceae
- 182-8 *Rhus glabra* L. fr. Anacardiaceae
- 182-9 fl. blue Labiales
- 182-10 *Sambucus canadensis* L. fr. Caprifoliaceae
- 182-11 *Athyrium filix-femina* v. *Nicholsonii* forma *pubellum* (Gilbert) Fernald
- 182-12 *Eupatorium perfoliatum* L. fl. + root Compositae
- 182-13 *Hypericum virginicum* L. fl. + fr. Guttiferae
- 182-14 *Eupatorium pilosum* Walter fl. Compositae
- 182-15 *Spiraea tomentosa* L. fl. + fr. Rosaceae
- 182-16 *Lycopus virginicus* L. fl. + fr. Labiales
- 182-17 *Phelypteris palustris* v. *pubescens* (Lamour) Fernald
- 182-18 ?
- 182-19 *Phytolacca americana* fl. + fr.

Conifer - Rhododendron woods & nearby locations  
 Meckesville, Carbon County, Pennsylvania

7 July 1971

Jucker & Janone

- 1 *Aralia hispida* fl-fr.
- 2 *Lygodium palmatum* fl-fr
- 3 *Oxera rotundifolia* bud.
- 4 *Veronica officinalis* fr
- 5 *Lycopodium clavatum* fr
- 6 *Lycopodium obscurum* fr.
- 7 *Antitella repens* fl
- 8 *Houstonia caerulea* fr
- 9 *Lygodium annotinum* st.
- 10 *Lycopodium complanatum* st.
- 11 *Rhododendron maximum* fl.
- 12 *Sambucus canadensis* fl
- 13 *Lycopodium lucidulum* st
- 14 *Linaria vulgaris* fl
- 15 *Viburnum prunifolium* fr
- 16 *Ilex verticillata* fl
- 17 *Maianthemum canadense* fr
- 18 *Rhododendron viscosum* fl
- 19 *Osmoderma cinnamomea* sporeling (5")

184-

In weeds at the Farm Bureau  
Tatamy, Northampton County, Pennsylvania

8 July, 1971

Judson Zanoni

-1 Nepeta cataria

-2 Thistle - ?

-3 - ?

185-

Copper Mine Farm

Copper Mine Rd., Griggstown, Middlesex Co., New Jersey

21 July, 1971

-1 Paulownia tomentosa in fr.

Scroph.

-2 Sassafras albidum in fr.

(molly)  
destroyed

186

186-1 Dryopt. Spinulosa

13 AUG. 1971

186-2 Dennetaedtia punctilobula (L.) (Michx.) Moore

186-3 " (narrowford)

187-1 climbing on *Viburnum dentatum* in ditch at side of road  
South of Rt. 138, Jamestown, Conanicut Island, Newport Co, RI  
*Mikania scandens* (L) Willd. Compositae

25 Aug 1971



New York Botanical Garden Library



3 5185 00334 8206

